



HOT & BOTHERED

Coming Together Without Falling Apart

APRIL 6-10, 2016

WESTIN HOTEL • ATLANTA, GEORGIA

DIVISION OF PSYCHOANALYSIS (39) • 36TH ANNUAL SPRING MEETING

2016 Division 39 Board of Directors

President

Marilyn Charles, PhD, ABPP

Past President

Frank L. Summers, PhD, ABPP

President-Elect

Dennis Debiak, PsyD

Secretary

Dana Charatan, PsyD

Treasurer

Arlene "Lu" Steinberg, PsyD

APA Council Reps

Norman Abeles, PhD

Laura Barbanel, EdD, ABPP

Mary Beth Cresci, PhD, ABPP

David Downing, PsyD, ABPP

Marsha D. McCary, PhD

Steven Reisner, PhD

Members-at-Large

Galit Atlas, PhD

Jaine Darwin, PsyD, ABPP

Diana Diamond, PhD

Jonathan Eger, PsyD

Colin Ennis, PsyD

Devon King, PhD

Scott Pytluk, PhD

Kris Yi, Ph.D., PsyD

Usha Tummala-Narra, PhD

Section Representatives

Section I: Albert J. Brok, PhD

Section II: Toni Heineman, DMH

Section III: Marilyn N. Metzl, PhD, ABPP

Section IV: Joseph Schaller, PsyD

Section V: Michael Jones, PsyD

Section VIII: Maurine Kelly, PhD

Section IX: Alice Shaw, PhD

Parliamentarian

Laurel Bass Wagner, PhD

2016 SPRING MEETING

Co-Chairs

William A. MacGillivray, PhD, ABPP
Stefanie L. Speanburg, PhD, LCSW

Steering Committee

Joyce M. Cartor, PhD
Susan Chance, PhD
Nancy D. Chase, PhD, LCSW
Karen M. Schwartz, PhD

Ad Hoc Committee

Jared DeFife, PhD
Yudit Jung, PhD, LCSW
Kareen Malone, PhD
Morgun Custer, BA

Proposal Reviewers

Daphny Dominguez Ainslie, PsyD	William Fried, PhD
Laura Barbanel, EdD, ABPP	Elliot Jurist, PhD, PhD
Jill Bellinson, PhD	Judy Logue, PhD
Al Brok, PhD	Kareen Malone, PhD
Brian Brown, PsyD	John Paddock, PhD
Juliet Buckwalter, PhD	Scott Pytluk, PhD
Susan Chance, PhD	Nadia Sawicki, MD
Nancy D. Chase, PhD, LCSW	Henry M. Seiden, PhD, ABPP
Marilyn Charles, PhD, ABPP	Arlene (Lu) Steinberg, PsyD
Dana Charatan, PsyD	Frank Summers, PhD, ABPP
Leilani Crane, PsyD	Amy Taylor, PhD
Mary Beth Cresci, PhD, ABPP	Jane Tillman, MDiv, PhD, ABPP
Jaine Darwin, PsyD, ABPP	Usha Tummala-Narra, PhD
Barry Dauphin, PhD	Woody Waldron, PhD
Dennis Debiak, PsyD	Laura Westen, PhD
Jack Foehl, PhD	Kris Yi, PhD. PsyD
	Jane Yates, PhD

Conference Coordinators

Natalie Shear Associates

TABLE OF CONTENTS

Spring Meeting Committee and Proposal Reviewers	1
Welcome	3
Poster Presentations	4
General Conference Information	5
Registration Hours	7
Book Exhibitor Hours	7
Continuing Education Credits	8
Pre Conference Continuing Education Master Classes	10
Keynote Speakers	14
Steering Committee Invited Panels	15
Conference Special Events	18
Division 39 Events and Meetings	19
Division 39 Section Events	21
Section I	21
Section II	21
Section III	21
Section IV	22
Section V	22
Section VIII	22
Section IX	23
Division 39 Committee Events	24
Conference Program	
Wednesday, April 6	31
Thursday, April 7	33
Friday, April 8	47
Saturday, April 9	59
Sunday, April 10	73
Index of Presenters	77–92
Hotel Floor Plans	93–94
Registration Form	95–96

WELCOME

Dear Colleagues:

Welcome to Atlanta! By now we assume you have been committed enough to Division 39, intrigued enough by our theme, and eager enough to hear our keynote speakers that you have been willing to commit time and money to participate with us in our ongoing task to make Division 39 your intellectual and emotional home. We do intend to get you “hot and bothered” or at least engaged in exploring how psychoanalytic thought, theory and practice is an essential part of an examined and engaged life.

Two stories. First, there is a passage in Elizabeth Danto's *Freud's Free Clinics* that is compelling. In it, she relates the story of Wilhelm Reich standing out on a street corner in Vienna teaching psychoanalytic understanding of sexuality to the crowd as his girlfriend hands out condoms on the sidelines. As the police arrive to arrest them, Reich admonishes the crowd to not react with violence for the police, too, are their brothers and sisters.

Second story. At the Spring Meeting in Philadelphia years ago, a prestigious panel of women analysts debated the status of feminism and psychoanalysis. When Hedda Bolgar was called upon to speak, however, she noted that our time might be more productively spent out on the streets raising hell about the continued inequality of women in our society rather than debating whether we were in the Second or Third Wave of Feminism.

While we hope that you will attend our sessions rather than take to the streets of Buckhead, we do hope that we all can get a little “hot and bothered” about how to engage our passion for our work and better communicate that passion to the larger society. Our opening coffee hour on Thursday is designed to help new and longtime members greet each other and begin conversations that will span the meeting. From Friday to Sunday we will have a morning plenary session that will hopefully fuel you with coffee but also ideas from our keynote speakers that will further these ongoing conversations.

Through our coffee hours, our afternoon breaks, and our evening receptions we hope to place the emphasis of the meeting on you and to build, however briefly, a community that will come together to experience the challenge and excitement of the psychoanalytic project. The Steering Committee's task is done. We hope you will take up our challenge to make this meeting yours.

William A. MacGillivray, PhD, ABPP
Co-Chair

Stefanie L. Speanburg, PhD, LCSW
Co-Chair

POSTER PRESENTATIONS

(Note: The Posters will be presented on **THURSDAY EVENING, APRIL 7** at 7 pm at the Opening Reception in the Grand Ballroom. The abstracts for these posters will be available on the Division 39 website and at the conference in Atlanta, GA)

“Brand Name” Psychotherapies or Overlapping Techniques: Does Purity of “Ingredients” Exist?

Alexandra Mattern-Roggelin, MS, DMin, The George Washington University., Washington, DC

A Phenomenological Study of Transition to First-Time Motherhood

Helena Vissing, MS, The Saturday Center for Psychotherapy, Santa Monica, CA

Effects of Supervision on Graduate Trainees in Regulation Focused Psychotherapy for Children

Emma Gaines, MA, MS, and Tracy A. Prout, PhD, Yeshiva University Ferkauf Graduate School of Psychology, New York, NY

Gender, Attachment, and Primary Process Affect

Maria Christoff, BA, Haley Lotter, MA, Barry Dauphin, PhD, University of Detroit Mercy, Detroit, MI

Learning Psychodynamically: Film, Psychoanalysis, & Learning Psychodynamic Theory

Albert Pace, MA, Cynthia Song, MA, JD, Nathan Haskell, MA, Roger Bufford, PhD, George Fox University Graduate Department of Clinical Psychology, Newberg, OR

Transition and Identity Development in Trans Women: The Return to One’s Body

Alvaro D. Moreira, MA, Karen Lombardi, PhD, Joseph Newirth, PhD, Derner Institute, Adelphi University, Garden City, NY

Exploring Relationships Between Patient Attachment Style and Therapist Countertransference in Psychodynamic Psychotherapy

Thomas Wessterling III, PhD, Helen Stevens, PsyD, David Goodman, PhD, Shelby Ortega, PhD, Jack Beinashowitz, PhD, Rebecca Drill, PhD, Cambridge Health Alliance/Harvard Medical School, Cambridge, MA

Patient Narratives of Most Helpful Psychodynamic Treatment Factors: A Qualitative Analysis

Hannah Richardson, PhD, Asli Bayka, PhD, LCSW, Laura Werner-Larsen, PhD, LCSW, Chrysa Prestia, DMA, LCSW, Jessica Somers, LCSW, Thomas Westerling, PhD, Yi Yang, PhD, Rebecca Drill, PhD, Jack Beinashowitz, PhD, Cambridge Health Alliance, Cambridge, MA

Posture and Its Effect on Affective State

Laura DeRubeis, Derner Institute, Adelphi University, Garden City, NY

Self-Disclosure: In-Session and Coming Out

Sara Lynn Richardson, BA, Joseph Newirth, PhD, Derner Institute, Adelphi University, Garden City, NY

Case Report: Combining Process-Focused and Skills-Based Interventions for Central Sensitivity Syndromes: Specific Applications to Interstitial Cystitis/Painful Bladder Syndrome

Lindsey C. McKernan, PhD, Vanderbilt University School of Medicine, Nashville, TN, Erika Carr, Yale University School of Medicine, New Haven, CT, Michael R. Nash, PhD, University of Tennessee, Knoxville, TN

An Empirical Investigation of the Effect of Personality Style on Transference

Kathryn E. Gallagher, PhD, and Andrew Gerberg, MD, PhD, Austen Riggs Center, Stockbridge, MA, Katie Surrence, MA, and Jacquelyn Shinall, MA, Columbia University Center for Psychoanalytic Training and Research, New York, NY

Leadership Preferences and the Disappearance of the Alpha Male: An Asian American Perspective

Arthur Roh, MS, Jean Lau Chin, EdD, Adelphi University, Garden City, NY

I’ll Call You Mom: Navigating Relationship with a Mentally Unstable Mother, A Listening Guide Analysis of One Woman’s Experience

Jessica Eddy, BA, Karen Lombardi, PhD, Joseph Newirth, PhD, Derner Institute, Adelphi University, Garden City, NY

Maternal Dependency and Self-Criticism Embodied in Infant Sequential Shape Flow Facial Patterns

Yelena Bromberg, PsyD, Robin Herbst-Papane, MSEd, K. Mark Sossin, PhD, Alfred Ward, PhD, Pace University, New York, NY, Beatrice Beebe, PhD, Columbia University Medical Center, New York, NY

Patient Perception of Interventions Used in Therapy and Patient Outcomes in a Psychodynamic Training Clinic

Casey Terzian, Rhiannon Wiley, Mengchun Chiang, PhD, Jonathan Carroll, PsyD, Kimberly Leary, PhD, MPA, Cambridge Health Alliance/Harvard Medical School, Cambridge, MA

CONFERENCE INFORMATION

HOTEL

The Westin, 3391 Peachtree Road, NE, Atlanta, GA, is in the heart of Buckhead, a chic in-spot popular with foodies...near restaurants and shopping. Recently renovated, the hotel, known for its southern hospitality, offers flexible meeting space in a completely smoke-free facility. Take a break and sit outside networking with friends and colleagues, go for a swim in the indoor pool or workout in the fitness studio. Come a day or two early or stay on after the Spring Meeting to enjoy some of the sights of the city like the Georgia Aquarium, CNN, Center for Civil and Human Rights, Georgia Dome and, for kids of all ages, there is Legoland. Enjoy the Spring Meeting and the surrounding area.

A special room rate is available for conference attendees from April 3 to April 11, 2016 at \$189 single/double for a traditional room and \$219 single/double for a corner king plus tax. All reservations must be made no later than **March 15** to obtain these rates. After that date, any rooms, if available, will be subject to the hotel’s prevailing rate. To book your room, go to <http://bit.ly/1XTuba7>.

REGISTRATION

If you are using a credit card, you may register online at the Division 39 website (www.division39.org), or you may fax your registration to 202-446-2965.

If you are paying by check, please mail your registration form with your check. We do not accept registrations by telephone, or those unaccompanied by full payment.

Note: All conference participants, including presenters, must register and pay the fee. There are no exceptions. There are no partial or day rate registrations.

When an online form is fully completed and “submitted,” the screen changes to a message thanking you for submitting the registration. When the credit card associated with the registration has been successfully charged, a formal confirmation of registration is emailed to the registrant. All questions regarding registration are to be directed to Natalie Shear Associates at 1-800-833-1354 or by email to hanklewis@natalieshear.com.

ADDITIONAL FEES

There is a \$25 processing fee for credit cards and checks that are declined, and, a \$50 on-site registration fee that is applied to everyone who has not registered in advance.

GRADUATE STUDENTS

All students MUST submit proof of current full-time student status WITH registration. Without this proof, a student registration cannot be processed. "Proof" is an official document that has the school logo and/or letterhead that specifically states that a student is enrolled full-time for the current semester or provides information (i.e., a paid bill or transcript, a letter from the registrar, etc.) that supports that enrollment. **A student ID is NOT "proof."**

INSTITUTE CANDIDATES

Candidates in analytic institutes who wish to register at the special fee MUST include WITH their registration form a letter from an administrator at their institute stipulating that they are a candidate in good standing in the first five years of their training.

If you are mailing or faxing your registration as a student or candidate, please submit the required "proof" or "letter" with it. If you are submitting your registration online, please submit the "proof" or "letter" by fax to 301-986-8647 or by email attachment to HankLewis@natalieshear.com.

EARLY CAREER PROFESSIONALS (ECP)

The Division offers a special registration fee to professionals who have received their doctoral degree in April 2006 or later. Fees are listed on the Registration Form.

REGISTRATION DEADLINE

Registrations postmarked or electronically submitted after midnight (EDT) **March 28, 2016** will not be accepted. DO NOT MAIL or fax registrations after March 28. Registration after March 28 will only be available on-site, at the conference hotel, beginning **Wednesday, April 6**.

ON-SITE REGISTRATION

Anyone who has not registered prior to midnight (EDT) March 28, may do so at the on-site Registration Desk at the conference. There are no exceptions. Registration will be open at the Westin Hotel beginning Wednesday morning, April 6.

REFUND POLICY

Refund requests must be received in writing by midnight (EDT) March 15. Fees will be refunded less a \$75 processing fee. There will be no refunds after March 15. Please email refund requests to Division39ATL@natalieshear.com or fax to 202-446-2965.

ACCESSIBLE ACCOMMODATIONS

Assistive Listening Devices, sign language interpreters, and materials in alternative formats will be provided upon request for conference sessions. Please indicate your request on the Registration Form. All requests must be received no later than March 1, 2016.

ON-SITE CHECK-IN

Please pick up your credentials and Continuing Education materials at the Check-In desk before attending any sessions. You will need these materials for entry to sessions, and to receive CE credits.

Wednesday Master Classes and Conference Registration Hours

Wednesday, April 6	8 am–5 pm
Thursday, April 7	7 am–6 pm
Friday, April 8	7 am–5 pm
Saturday, April 9	7 am–4 pm
Sunday, April 10	7:30 am–Noon

Book Exhibitor Area

Book exhibitors will be located in the Ballroom Pre-Function space on the 4th Floor of the Westin Hotel. This open area, near most of the meeting space, will also include registration and networking breaks of various kinds. At press time exhibitors include Association Book Exhibit, Austen Riggs Center, Roman & Littlefield, Routledge and Taylor and Francis.

Wednesday, April 6	Move In
Thursday, April 7	8:30 am–5:30 pm
Friday, April 8	10 am–6 pm
Saturday, April 9	10 am–6 pm
Sunday, April 10	10 am–Noon

Mark Your Calendars Now

FUTURE DIVISION 39 SPRING MEETINGS

2017 New York, NY
April 26–30, 2017
Sheraton Times Square Hotel

2018 New Orleans, LA
April 18–22, 2018
Intercontinental Hotel

2019 Philadelphia, PA
April 3–7, 2019
Loews Philadelphia Hotel

CONTINUING EDUCATION CREDITS

The Division of Psychoanalysis is approved by the American Psychological Association (APA) to sponsor continuing education (CE) for psychologists. Division 39 maintains responsibility for these programs and their content. Wednesday Master Classes and Spring Meeting programs are open to all mental health professionals, and participants may receive CE credit for attending these programs. Participants from professions other than psychology should consult with their respective licensing boards regarding the acceptance of APA-approved Certificates of Attendance as documentation of CE. For programs sixty minutes in duration or longer, one credit is awarded for each hour of CE activity, with additional quarter-increments of CE credit awarded beyond one hour; for example, attending a one-hour-and-fifty-minute program will yield 1.75 CE credits. **50-minute programs are not available for CE credit.**

Wednesday Master Classes require registration separate from general registration for the Spring Meeting and are offered for additional fees. At the conclusion of Master Classes, participants will receive a paper certificate of attendance upon completing a paper evaluation form.

Complete descriptions of each Wednesday Master Class and other CE-eligible programs (title, presenter(s), learning objectives, instructional level) can be found on the Division 39 website: www.division39.org. **The website will be the most complete source of information about CE-eligible programs;** participants are encouraged to check this site regularly for updates and/or additional information when making decisions about attending the Wednesday Master Classes and/or Spring Meeting programs offered from Thursday through Sunday.

Each CE-eligible Spring Meeting program is identified by a letter/number code (e.g. TH-1, FR-3, SA-5, SU-2) indicating the day of the presentation and its order in that day's schedule. **For all CE-eligible programs, there is no partial credit for attending only a portion of an eligible program.** Attendance of CE-eligible Spring Meeting programs will be confirmed using a scanning system. Participants will be required to have the barcode on their badges scanned both at the **start of the program session** and **as they leave at the conclusion** of the session. To receive a Certificate of Attendance for any CE-eligible program, it is necessary to (1) register for the Spring Meeting, (2) attend the entire presentation, and (3) submit a completed evaluation form through Express Evaluations, the Division's online evaluation and certificate service. **Please note our transition away from paper evaluations to online evaluations!** Instructions about using Express Evaluations

or any additional procedures will be posted on the Division 39 website (www.division39.org) and will be available at the Registration Desk. Instructions will also be sent out via email, so ensure the email you use to register for the Spring Meeting is accurate.

Division 39 is committed to accessibility and non-discrimination in its CE activities and will conduct these in conformity with the American Psychological Association's Ethical Principles for Psychologists. There is no commercial support for any of the Wednesday Master Classes or Spring Meeting CE programs. All presenters have denied the existence of any relationships (i.e. based on program content, research, grants or other funding/support) that could be construed as conflicts of interest. Presenters of CE-eligible programs will address, whether during the program or via a list of references, the utility of the presentation content and the basis for their statements about this utility as well as the limitations and risks (common and most severe) associated with the program content. Presenters and participants are asked to honor the need for privacy and confidentiality throughout these programs. If program content becomes emotionally distressing, participants are encouraged to process these feelings during discussion periods. If participants have special needs, we will make reasonable attempts to accommodate them. Please contact Natalie Shear Lewis (natalie@natalieshear.com) with requests for accommodation. **Please contact Paul Martin (Chair of Division 39's Continuing Education Committee) at div39ce@gmail.com—email is preferred—or by phone at (773) 981-7242 for additional information about presenters, questions and/or complaints.**

DON'T MISS KEYNOTES AND COFFEE
Friday, Saturday and
Sunday Mornings
at 8 am

PRE-CONFERENCE CONTINUING EDUCATION MASTER CLASSES

WEDNESDAY, APRIL 6, 2016 • ADVANCE REGISTRATION REQUIRED

Workshops are open to all mental health professionals. Participants may receive continuing education credit for these events. The Division of Psychoanalysis is approved by the American Psychological Association to offer continuing education for psychologists. Division 39 maintains responsibility for the program. Upon completing an evaluation form, participants will receive certificates of attendance for each class completed. Participants may register for one or more CE master classes, independent of registering for the Spring Meeting itself. This information is also available on the Division 39 website, www.division39.org. A full description of every master class along with learning objectives and biographical information on the presenters can also be found on the Division website. **Please indicate on the registration form which sessions you will attend.**

9 am–12 pm

3 CE Credits, Fee: \$60

Perversion—To Die in Order to Live?

This intermediate continuing education workshop offers a dialogue about the constructive twinning of pain and pleasure as the “Pleasure to bust the limits” of conventional and inter-generationally transmitted cultural norms. We will look at perversion, and Sado-Masochism in particular, as an integral part of aggression, with the potential to serve as agent of “de-linking” and thus “re-linking” and as an essential component of our phylogenetic and ontogenetic development. Perversions, when experienced by a non-psychotic adult, offer new survival experiences for the “bonded Self” by challenging the body’s limits and thus tap into the uncontained, undefined, non-psychotic reverie that is the core of childhood and adult creativity and sexuality.

Yudit Jung, PhD, LCSW is a practicing psychoanalyst in Atlanta, Georgia. With over 30 years of clinical experience, Dr. Jung is an APsA-certified Training and Supervising Analyst and faculty of the Emory University Psychoanalytic Institute.

9 am–12 pm

3 CE Credits, Fee: \$60

The Integrative Treatment of Complex Dissociative Disorders

This workshop will offer an overview of the current standard of care with complex dissociative disorders. Recent naturalistic treatment outcome studies indicate these patients do best when the therapist directly and consistently addresses dissociation, while also attending to the many other complex issues endemic to developmental trauma and profound attachment disruptions. We will briefly explore the intertwined psychological and biological foundations of these disorders and their impact on sense of self, reflective functioning, regulatory capacities, and attachment. We will discuss treatment that is embedded in a modified psychodynamic frame and case formulation, and that integrates a wide variety of other approaches that have shown to be effective with this challenging population.

Kathy Steele, MN, CS, APRN is an internationally recognized trauma specialist, author, psychotherapist, and consultant. She has practiced in Atlanta, Georgia for over 30 years. Kathy has co-authored numerous book chapters, journal articles, and two award winning books on trauma and dissociation: *The Haunted Self: Structural Dissociation of the Personality and Treatment of Chronic Traumatization* (2006; Norton Press) and *Coping with Trauma-Related Dissociation: Skills Training for Patients and Therapists* (2011; Norton Press).

1–3 pm

2 CE Credits, Fee: \$40

A Therapist’s Guide to New Media: How to Promote Your Practice and Expertise Through Websites, Blogging, and Social Media

Blogging, Tweeting, Facebooking—a decade ago these verbs didn’t exist and therapists were dependent on offline social networks for referrals. Now, it’s a brave new world, filled with brave new ways to reach clients, network with other therapists, and promote your expertise. This workshop offers practical, hands-on strategies for promoting your practice in the 21st century, including free steps you can take today to implement and interconnect a webpage, blog, and social media—the basic building blocks of a respectable online presence. This workshop assumes basic computer literacy of word processing and web surfing (email, Google, etc.), but requires no prior experience with webpages or any esoteric computer-ish stuff beyond the English language.

Kristi Pikiewicz, PhD earned her doctorate in Clinical Psychology from Pacifica Graduate Institute and specializes in working with mothers of chronically ill children. She is the editor of the Division 39 monthly publication, *InSight*, managing editor of the Division 39 *DIVISION/Review*, and editor of the Division 39 blog “Meaningful You” at PsychologyToday.com. Kristi has published curriculum books with the Corwin Press, Shell Education, and Teacher Created Materials.

1–4 pm

3 CE Credits, Fee: \$60

Psychoanalytic Dreamwork: The Bridge Between I and Thou

Since dream interpretation deals directly with the unconscious, a consciously psychoanalytic approach to this work is particularly important. Based on the premise that it is essential to keep the patient's experience of the dream central to the interpretive process, the workshop will focus on ways to minimize contamination by the therapist's projections, countertransference reactions, and theoretical orientation. At the same time effective dream work occurs primarily within a collaborative relationship. Therefore, we will examine the role of the therapist as one of helping the patient freely engage with dream material as the true expert of the dream using a relational perspective as a frame for psychoanalytic technique.

Kendle Hassinger, LPC is a psychoanalyst and has practiced psychotherapy in Atlanta, Georgia for 24 years. She has led dream process groups and workshops for nearly 20 years.

1–5 pm

4 CE Credits, Fee: \$80

The DSM-V and the Psychodynamic Diagnostic Manual—Revised

This workshop will compare and contrast the Psychodynamic Diagnostic Manual, Revised (PDM2) with the revised Diagnostic and Statistical Manual (DSM-V). The DSM-V diagnostic system has little to do with how actual clinicians think and work. The PDM2 was developed with an explicit focus on how diagnosis can guide actual clinical work taking into account the patient's personality patterns, as well as cognitive, affective, and psychosocial resources, before considering the symptomatic patterns that led the patient to seek change. Grounded in psychoanalytic and attachment research, the PDM2 provides a useful tool for all clinicians.

Robert M. Gordon, PhD, ABPP is an expert in the use of the Minnesota Multiphasic Personality Inventory (MMPI) with extensive clinical and research experience on the value of personality assessment in diagnosis and treatment. He is associate editor of the PDM2.

3–5 pm

2 CE Credits, Fee: \$40

Starting a Practice: Let's Talk About Money (Practical Tips and Theoretical Considerations)

This introductory presentation is designed to be applicable to clinicians at all stages of their career, with a particular emphasis on graduate students, early career professionals and analytic candidates. The goal is to introduce and discuss both practical issues related to the decision to open a private practice as well as issues of identity development in relationship to the transactional aspects of collecting a fee. Panelists will guide participants through discussions on the costs of practice, potential impacts of insurance in the consulting room, thinking about fees, psychodynamic aspects of billing and collecting, the therapist's anxieties around worth, and sundry topics related to money that beginning (and seasonal) therapists find themselves dealing with in private practice.

Tanya Hess, PhD, Chair; Benjamin Rubin, PsyD; Brian Brown, PsyD; Michael C. Klein, PhD; Michael R. Donnell, PsyD; Kathryn G. White, PhD; Marilyn Charles, PhD, ABPP, discussant.

ROWMAN & LITTLEFIELD

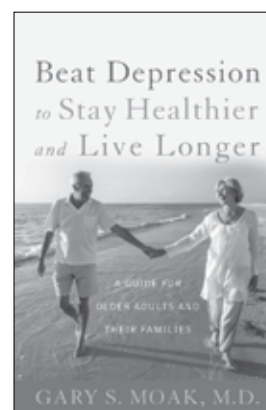

2016 • 280 pages
978-1-4422-4661-4 • \$36.00 • Cloth
978-1-4422-4662-1 • \$35.99 • eBook

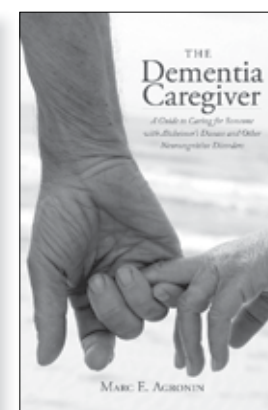

2015 • 298 pages
978-1-4422-3191-7 • \$36.00 • Cloth
978-1-4422-3192-4 • \$35.99 • eBook

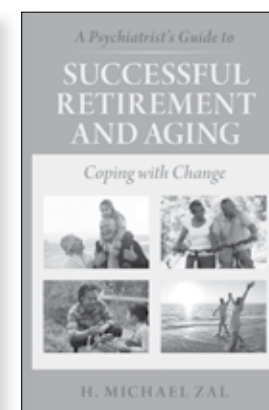

2016 • 240 pages
978-1-4422-5123-6 • \$38.00 • Cloth
978-1-4422-5124-3 • \$37.99 • eBook

WWW.ROWMAN.COM | 800-462-6420



KEYNOTE SPEAKERS

FRIDAY, APRIL 8 • 8–9:50 AM • BALLROOM A & B

Françoise Davoine, PhD



The Failure of Memory: War, Psychosis, Racism, Sex

This presentation, introduced by Claire Nouvet, PhD, will address how the troubled individual, the psychotic, the war traumatized, etc., “carry” cultural memory repressed by the wider society and (re)present the failure of the social link. The therapist’s task is to accompany the troubled person to a confrontation with and a restoration of history.

SATURDAY, APRIL 9 • 8–9:50 AM • BALLROOM C,D,E

Gideon Yago, writer and reporter



Hearts and Minds: The Mechanics of Contemporary Psychoanalytic and Popular Culture

This keynote will be a bi-directional conversation between contemporary psychoanalysis and popular culture. Mr. Yago pulls back the curtain to expose the role psychoanalytic consultation plays in making broadcast media. In turn, he will consult to psychoanalysts about the intrapsychic and sociocultural concerns most relevant to contemporary American audiences.

SUNDAY, APRIL 10 • 8–9:50 AM • BALLROOM C,D,E

Nancy McWilliams, PhD, ABPP



Psychoanalytic Reflections on Limitation: Aging, Dying, Generativity, and Renewal

Limits—and the limit of mortality in particular—make us hot and bothered. Despite the fact that American culture is fueled by fantasies of inexhaustible resources and limitless possibility, psychoanalysis has engaged with the issue of natural limitation ever since Freud emphasized the inevitable tension between bottomless human desire and the demands of civilized life. Dr. McWilliams will explore a dilemma central to the human condition: although limitation evokes primal frustration, it also creates the conditions of Balint’s “area of creativity.”

STEERING COMMITTEE INVITED PANELS

THURSDAY, APRIL 7 • 8:30–10:20 AM • CHASTAIN

How the APA Became the Torturer’s Apprentice: Ethical and Clinical Issues

Three senior members of Division 39 discuss APA’s role in torture including the history and the current status of the issue. Extensive attention is also paid to the specific organizational and clinical issues that led to do what many have described as the greatest ethical scandal in psychology’s history.

Bryant Welch, JD, PhD

Stephen Soldz, PhD

Steven Reisner, PhD

William A. MacGillivray, PhD, ABPP, *moderator*

THURSDAY, APRIL 7 • 10:30 AM–12:20 PM • BUCKHEAD II

Contemplative Practices and Psychoanalytic Process

The panel will address the challenges arising when contemplative practices are introduced to clinical or highly distressed populations (battered women, incarcerated populations, suicidal populations, etc). Drawing from their work, the panel will present data and discuss the challenges faced when non-clinicians teach contemplative or mindfulness practices to at-risk populations. The intersections of contemplative practice, trauma and psychotherapy will be discussed.

Brendan Ozawa-de Silva, PhD

Chikako Ozawa-de Silva, PhD.

Nadine Kaslow, PhD, ABPP

Bobbi Patterson, PhD

Nancy D. Chase, PhD, LCSW, *chair*

THURSDAY, APRIL 7 • 3:30–5:20 PM • BUCKHEAD II

Sex and the Couch

This panel discussion will address the question, “What Role Does Sex Play In Contemporary Psychoanalysis?” Presenters will explore the ways in which leaving sex “off the table” in our clinical conversations poses risks for patients, clinicians, and the analytic endeavor generally. This dynamic panel will productively complicate and expand participants’ understanding of erotic material.

Andrea Celenza, PhD
Vittorio Lingiardi, MD
Elizabeth Wilson, PhD
Stefanie L. Speanburg, PhD, LCSW, *chair*

FRIDAY, APRIL 8 • 10–11:50 AM • BUCKHEAD II

Creativity and the Human Spirit: Trauma and the Healing Power of Art

Our presenters will discuss their clinical, research, and/or personal experience with artwork, their own (poetry, dance, painting) and that of others, as a potential avenue for transforming traumatic experience and for articulating inchoate meanings. Clinical experience and research on the function and meanings of art as intervention in contexts ranging from psychotherapeutic to a preschool setting in New South Wales will be brought to bear on understanding creativity as a resource for addressing various degrees of personal disruption and self depletion, including trauma, loss, and burn out.

George Hagman, MSW, LCSW
Marilyn Charles, PhD, ABPP
Carol M. Press, EdD
Karen M. Schwartz, PhD, *chair*

FRIDAY, APRIL 8 • 1–2:50 PM • BUCKHEAD II

Strength and Tenderness: The Challenges of Masculinity in the Modern Era

This presentation will look at current psychoanalytic and neurobehavioral thinking and research on notions of maleness, masculinity, and male gender identity, with special attention paid to the social construction of male identity and depictions of fatherhood in different sub-cultures. Biological correlates of human paternal behavior related to caregiving will be surveyed. Especially pertinent to the presentations will be the contradictory messages, images, and demands with which modern males must struggle.

Mark O’Connell, PhD
James Rilling, PhD
Kirkland Vaughans, PhD
Joyce M. Cartor, PhD, *chair*

SATURDAY, APRIL 9 • 10–11:50 AM • BUCKHEAD II

Passing the Torch: Present Challenges and Future Opportunities for Psychoanalytic Education and Training

Psychoanalytic learning, in the classroom or on the couch, has always been an intensely personal experience. This panel will bring together psychoanalytic scholars with many years’ experience in training and education. Describing their experiences of teaching and training in diverse educational settings, the panelists will discuss with the participants and each other the goals and challenges of transmitting psychoanalytic knowledge in the 21st century.

Jack M. Barlow, PhD
Rebecca Drill, PhD
M. Gerard Fromm, PhD, ABPP
Claire Nouvet, PhD
Joyce M. Cartor, PhD, *chair*

SATURDAY, APRIL 9 • 1–2:50 PM • EAST PAGES

Crashing the Network: Psychoanalysis and Cyberspaces

This intermediate panel presentation will explore the co-evolution of technology, psychoanalytic theory and clinical practice. When psychoanalytic psychotherapy moves online, aspects of the object’s internalization take a different course than they might in in-person therapy, because of the representational qualities of time and body online. This panel will discuss perspectives on the felt sense of the cyberobject’s embodiment, and compare that to the presumed sense of the object’s embodiment in in-person psychotherapy.

Todd Essig, PhD
Stephen Hartman, PhD
Gillian Isaacs Russell, PhD
Ave Schwartz, LCSW
Stefanie L. Speanburg, PhD, LCSW, *chair*

CONFERENCE SPECIAL EVENTS

WEDNESDAY, APRIL 6

An Evening with Nancy McWilliams, PhD, ABPP

followed by a reception co-sponsored by the Atlanta Psychoanalytic Society
6–8 pm • Ballroom C,D,E

THURSDAY, APRIL 7

The Georgia Innocence Project (GIP)

Featuring performer, producer and activist, Melanie Hammet
7:45 pm • Tuxedo

FRIDAY, APRIL 8

Film Screening and Discussion

Beasts of the Southern Wild (2012)

Director: Benh Zeitlin

Screen Play: Lucy Alibar and Benh Zeitlin

Discussant: Catherine Meeks, PhD, MSW

7–10 pm • Tuxedo

Psychoanalytic Fair

Join colleagues to network and learn about new programs and projects

3–3:50 pm • Ballroom Pre Function Area

SATURDAY, APRIL 9

Two Films and Two Discussions

The Mark of War, a documentary film, by Ricardo Ainslie, PhD, ABPP

Discussants: David Rosenblatt, PhD, Neil Altman, PhD

Ethics and Trauma in Hannah Arendt by Margarethe Von Trotta

Discussants: Diana Diamond, PhD, Elliot Jurist, PhD, PhD, Françoise Davoine, PhD

7–10 pm • East Paces

DIVISION 39 EVENTS AND MEETINGS

WEDNESDAY, APRIL 6

An Evening with Nancy McWilliams, PhD, ABPP

followed by a reception co-sponsored by the Atlanta Psychoanalytic Society
6–8 pm • Ballroom C,D,E

THURSDAY, APRIL 7

Coffee and Networking

7:30–8:20 am • Ballroom Pre Function Area

Board of Directors Meeting

8:30 am–4:30 pm • Woodruff

Scholarship Award Symposium

Award Recipient: Melanie Suchet, PhD

10:30 am–12:20 pm • East Paces

President's Address and Awards Ceremony

5:30–7 pm • Grand Ballroom

President: Marilyn Charles, PhD, ABPP, *presiding*

Awards Chair: Dennis Debiak, PsyD

Award Recipients

Leadership Award: Mary-Joan Gerson, PhD

Diversity Award: David Ramirez, PhD, ABPP

Past President's Address:

Is There a Psychoanalytic Contribution to the Problem of Mass Violence?

Frank Summers, PhD, ABPP

Welcome Reception

Music by The Gary Busey Quartet (Emory Jazz Ensemble)

Poster Presentations

7–8:30 pm • Grand Ballroom

FRIDAY, APRIL 8

Keynote Address and Coffee

Françoise Davoine, PhD

The Failure of Memory: War, Psychosis, Racism, Sex

8–9:50 am • Grand Ballroom

Scholars Reception

Noon–1:20 pm • Buckhead I

Psychoanalytic Fair

3–3:50 pm • Ballroom Pre Function Area

Film Screening and Discussion

Beasts of the Southern Wild (2012)

7–10 pm • Tuxedo

SATURDAY, APRIL 9

Keynote Address and Coffee

Gideon Yago, writer and reporter

Hearts and Minds: The Mechanics of Contemporary Psychoanalytic and Popular Culture

8–9:50am • Grand Ballroom

Two Films and Two Discussions

The Mark of War and

Ethics and Trauma in Margarethe Von Trotta's Hannah Arendt

7–10 pm • East Paces

SUNDAY, APRIL 10

Keynote Address and Coffee

Nancy McWilliams, PhD, ABPP

Psychoanalytic Reflections on Limitation: Aging, Dying, Generativity, and Renewal

8–9:50 am • Grand Ballroom

Research Award Symposium

Award Recipient: Miriam Steele, PhD

10–11:50 am • Chastain

Rap Up

Join Division leaders and conference co chairs to talk about the Atlanta experience with an eye to the future

12–1 pm • Peachtree

DIVISION 39 SECTION EVENTS

Section I: Psychologist Psychoanalyst Practitioners Panel

Analyzing Psychoanalysts Today: Challenges in Training, Theory, Practice and Politics

Friday, April 8 • 10–11:50 am • Habersham

Board Meeting

Friday, April 8 • 8 pm • Habersham

Presidential Conversation Hour and Reception: An Open Conversation on Psychoanalytic Training

Sponsored by Section I and the Candidates Committees of Division 39. The event is open to anyone interested in psychoanalytic institutes and psychoanalytic training

Saturday, April 9 • 6–7:30 pm • Woodruff

Section II: Childhood and Adolescence Joint Panel Sections II and IV

The Use and Overuse of Medications in Treatment of Children and Teens:
Alternatives to Psychopharmacology

Sunday, April 10 • 10–11:50 am • Buckhead II

Joint Reception

Co-Sponsored by Sections II, III, V, IX and the Committees on Multicultural Concerns, Sexualities and Gender Identities, Early Career Professionals and Psychoanalysis and the Community

Saturday, April 9 • 6–8 pm • Ballroom Pre Function

Section III: Women, Gender and Psychoanalysis

Joint Panel with Committees on Multicultural Concerns and Sexualities and Gender Identities

Intersectionality: Gender, Sexuality and Race—the Trifecta. Part I—Theory

Friday, April 8 • 1–2:50 pm • East Paces

Intersectionality: Gender, Sexuality and Race—the Trifecta.

Part II—Clinical Applications

Friday, April 8 • 4–5:50 pm • Habersham

Board Meeting

Friday, April 8 • Noon–12:50 pm • Peachtree

Joint Reception

Co-Sponsored by Sections II, III, V, IX and the Committees on Multicultural Concerns, Sexualities and Gender Identities, Early Career Professionals and Psychoanalysis and the Community

Saturday, April 9 • 6–8 pm • Ballroom Pre Function

Section IV: Local Chapters

Joint Panel Sections IV and II

The Use and Overuse of Medications in Treatment of Children and Teens:
Alternatives to Psychopharmacology

Sunday, April 10 • 10–11:50 am • Buckhead II

Senate Meeting

Friday, April 8 • 10–10:50 am • Buckhead I

Open Meeting

Saturday, April 9 • 10–11:50 am • Ballroom D

Section V: Applied Clinical Psychoanalysis

Panel

Questions Concerning Manualization: A Watershed or Waterloo?

Thursday, April 7 • 1:30–3:20 pm • Habersham

Board meeting

Friday, April 8 • 1–2:50 pm • Peachtree

Joint Reception

Co-Sponsored by Sections II, III, V, IX and the Committees on Multicultural Concerns, Sexualities and Gender Identities, Early Career Professionals and Psychoanalysis and the Community

Saturday, April 9 • 6–8 pm • Ballroom Pre Function

Section VIII: Couple and Family Therapy and Psychoanalysis

Panel

To Tell the Truth? the Whole Truth? And Nothing But?: Secrets and Couple Psychotherapy

Thursday, April 7 • 3:30–5:20 pm • Buckhead II

Board Meeting

Saturday, April 9 • Noon–12:50 pm • Ballroom C

Reception

Friday, April 8 • 6–8 pm • East Paces

Section IX: Social Responsibility

Panel

Being Othered in the U.S.A.: Psychoanalytic Voices

Thursday, April 7 • 3:30–5:20 pm • East Paces

Board Meeting

Saturday, April 9 • Noon–1:50 pm • Buckhead I

Joint Reception

Co-Sponsored by Sections II, III, V, IX and the Committees on Multicultural Concerns, Sexualities and Gender Identities, Early Career Professionals and Psychoanalysis and the Community

Saturday, April 9 • 6–8 pm • Ballroom Pre Function

ADVERTISEMENT

SAVE THE DATE

The Association for Psychoanalytic Medicine
The Society affiliated with Columbia University
Invites you to attend a symposium

ON THE BODY

May 6-7, 2016

Throughout Freud's writings, the intertwining of body and psyche was elemental. This APM Symposium addresses the imperative to bring the body back to center stage and to consider the challenges it poses to our current ways of understanding our patients. *This 2-day multidisciplinary International Symposium in NYC with guest speakers from around the world including Julia Kristeva, Juliet Mitchell, Paul Verhaeghe, Patricia Gherovici, Jessica Benjamin, Christine Anzieu-Premereur, Robert Paul, Panagiotis Aloupis, Marina Papageorgiou, Rosemary Balsam, Jonathan House, Dominique Scarfone, Lila Kalinich and George Sagi will address singularly important topics in contemporary psychoanalysis such as:*

- The Speaking Body, the Sick Body, the Sexual Body
- Sex, Gender and Infantile Sexuality
- The 21st Century Body and the Drives

For more information, follow our Facebook page *APM Symposium on the Body in NYC* and website *theapm.org*

DIVISION 39 COMMITTEE EVENTS

American Board and Academy of Psychoanalysis (ABAPsa)

Board Meeting

Saturday, April 9 • 10 am–5 pm • Peachtree

Sunday, April 10 • 10–11:50 am • Peachtree

Awards Committee

Saturday, April 9 • 1–2 pm • Morningside Boardroom

Candidate Outreach Committee

President's Reception for Graduate Students, Candidates and Early Career Professionals

Friday, April 8 • 6–8 pm • Buckhead I

Presidential Conversation Hour and Reception: An Open Conversation on Psychoanalytic Training

Sponsored by Section I and the Candidates Committees of Division 39. The event is open to anyone interested in psychoanalytic institutes and psychoanalytic training

Saturday, April 9 • 6–7:30 pm • Woodruff

Committee on Education and Clinical Training Roundtable

Fitting the Well-Rounded Program into the Square World of Accreditation

Saturday, April 9 • 1–2:50 pm • Habersham

Board Meeting

Friday, April 8 • 4–5:50 pm • Peachtree

Committee on Humanities and Psychoanalysis Panel

Psychoanalysis and the Blues: Discourses on Loss, and Resilience

Friday, April 8 • 4–5:50 pm • East Paces

Committee on International Relations in Psychoanalytic Psychology Panel

Psychoanalysis During Argentina's Dirty War: Torture, Collusion, Resistance and Their Resonance for Today

Saturday, April 9 • 4–5:50 pm • Chastain

Board Meeting

Thursday, April 7 • 12:30–1:20 pm • West Paces

Committee on Multicultural Concerns

Joint Panel with Committee on Sexualities and Gender Identities and Section III

Intersectionality: Gender, Sexuality and Race—the Trifecta. Part I—Theory

Friday, April 8 • 1–2:50 pm • East Paces

Intersectionality: Gender, Sexuality and Race—the Trifecta.

Part II—Clinical Applications

Friday, April 8 • 4–5:50 pm • Habersham

Board Meeting

Saturday, April 9 • 3–4:50 pm • Woodruff

Joint Reception

Co-Sponsored by Sections II, III, V, IX and the Committees on Multicultural Concerns, Sexualities and Gender Identities, Early Career Professionals and Psychoanalysis and the Community

Saturday, April 9 • 6–8 pm • Ballroom Pre Function

Committee on Psychoanalysis and the Community Panel

Conversations in Applied Psychoanalysis: Working with Populations in Crisis

Thursday, April 7 • 8:30–10:20 am • Habersham

Board Meeting

Friday, April 8 • 10–11:50 am • Peachtree

Joint Reception

Co-Sponsored by Sections II, III, V, IX and the Committees on Multicultural Concerns, Sexualities and Gender Identities, Early Career Professionals and Psychoanalysis and the Community

Saturday, April 9 • 6–8 pm • Ballroom Pre Function

Committee on Psychoanalysis and Health Care Panel

The Mind and Body in Pain: Two Responses to a Case Presentation

Thursday, April 7 • 3:30–5:20 pm • Chastain

Board Meeting

Thursday, April 7 • 12:30–1:20 pm • Peachtree

Committee on Sexualities and Gender Identities

Joint Panel with Committee on Multicultural Concerns and Section III

Intersectionality: Gender, Sexuality and Race—the Trifecta. Part I—Theory

Friday, April 8 • 1–2:50 pm • East Paces

Intersectionality: Gender, Sexuality and Race—the Trifecta. Part II—Clinical Applications

Friday, April 8 • 4–5:50 pm • Habersham

Board Meeting

Saturday, April 9 • 10–11:50 am • Ballroom E

Joint Reception

Co-Sponsored by Sections II, III, V, IX and the Committees on Multicultural Concerns, Sexualities and Gender Identities, Early Career Professionals and Psychoanalysis and the Community

Saturday, April 9 • 6–8 pm • Ballroom Pre Function

Early Career Professionals Committee

Panel

Fear and Loathing (and Reconciliation) : Early Career Experiences of Disillusionment

Saturday, April 9 • 10–11:50 am • Habersham

Board Meeting

Saturday, April 9 • Noon–12:50 pm • Morningside Boardroom

President's Reception for Graduate Students, Candidates and Early Career Professionals

Friday, April 8 • 6–8 pm • Buckhead I

Joint Reception

Co-Sponsored by Sections II, III, V, IX and the Committees on Multicultural Concerns, Sexualities and Gender Identities, Early Career Professionals and Psychoanalysis and the Community

Saturday, April 9 • 6–8 pm • Ballroom Pre Function

Ethics Committee

Panel

What Should We Do? Responding to Sexual Boundary Violations in Real Time

Saturday, April 9 • 4–5:50 pm • West Paces

Board Meeting

Saturday, April 9 • Noon–12:50 pm • Ballroom D

Graduate Student Committee

Panel

Psychoanalysis, Science, and Graduate Student Identity: A Discussion Regarding Competing Demands for Psychoanalytic Doctoral Students

Friday, April 8 • 4–5:50 pm • Buckhead II

Live Supervision

The Dynamics of the Supervisory Relationship: A Live Demonstration

Saturday, April 9 • 4–5:50 pm • Buckhead I

Special Workshops for Graduate Students

Workshop I: Françoise Davoine, PhD

Friday, April 8 • 3–3:50 pm • Buckhead I

Workshop II: Nancy McWilliams, PhD, ABPP

Saturday, April 9 • Noon–12:50 pm • Woodruff

Workshop III: Gideon Yago

Saturday, April 9 • 3–3:50 pm • Buckhead I

President's Reception for Graduate Students, Candidates and Early Career Professionals

Friday, April 8 • 6–8 pm • Buckhead I

Presidential Conversation Hour and Reception: An Open Conversation on Psychoanalytic Training

Sponsored by Section I and the Candidates Committees of Division 39. The event is open to anyone interested in psychoanalytic institutes and psychoanalytic training

Saturday, April 9 • 6–7:30 pm • Woodruff

Program Committee Meeting

Saturday, April 9 • 1–2:50 pm • Woodruff

Psychoanalytic Psychology Editorial Board

Friday, April 8 • Noon–12:50 pm • Tuxedo

Publications Committee

Saturday, April 9 • Noon–12:50 pm • Ballroom E

Research Committee

Panel

The Synergy Between Research and Clinical Technique in Transference Focused Psychotherapy (TFP)

Friday, April 8 • 10–11:50 am • East Paces

Board Meeting

Friday, April 8 • 7–7:50 am • Peachtree

Poster Session

Thursday, April 7 • 7 pm • Grand Ballroom

One of *U.S. News & World Report's*

"Best Hospitals" in Psychiatry

AUSTEN RIGGS CENTER

Providing an Integrated Psychiatric Continuum of Care

25 Main Street, Stockbridge, MA [855] 283.1770 WWW.AUSTENRIGGS.ORG

MEANING MATTERS

An Online Psychodynamic Community

A place to share information and thinking about psychodynamic practice, research and education.

Discussion forums | News reports
Nationwide events calendar | Resources

www.meaningmatterscommunity.org

An independent gathering place for psychodynamic thinkers across disciplines.
Hosted by the Austen Riggs Center

Visit the Routledge Booth for 20% off & free global shipping!

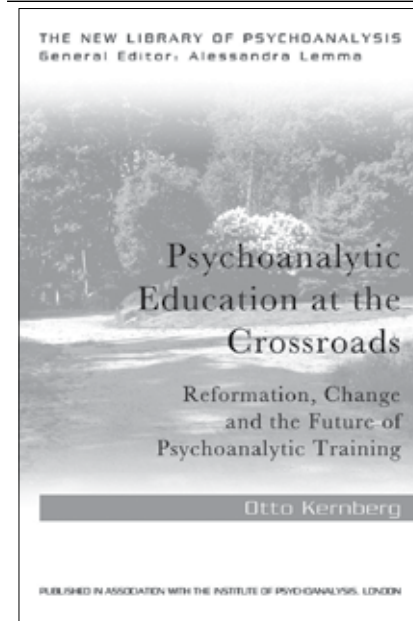

The New Library of Psychoanalysis
**Psychoanalytic Education at the
Crossroads**
Otto Kernberg

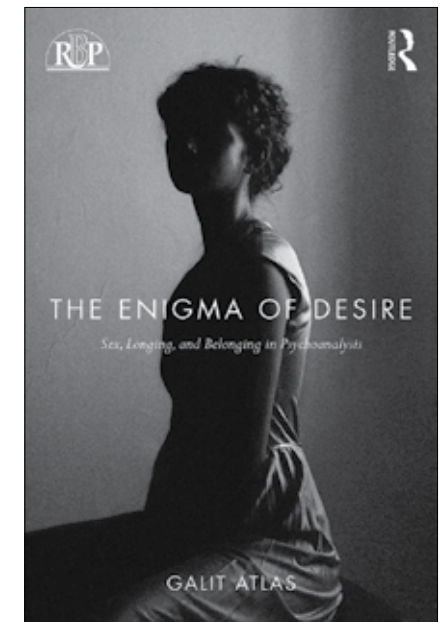

Relational Perspectives Series
The Enigma of Desire
Galit Atlas

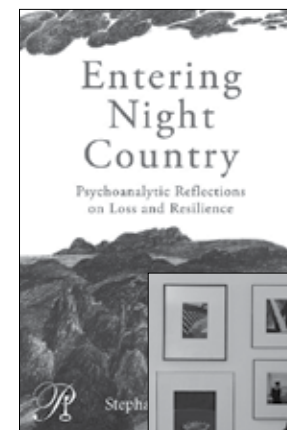

Entering Night Country
*Psychoanalysis in a New Key Book
Series*
Stephanie Brody

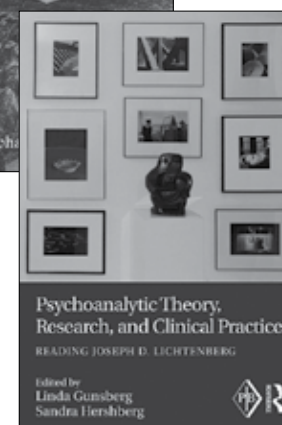

**Psychoanalytic Theory, Re-
search and Clinical Practice**
Psychoanalytic Inquiry Series
Linda Gunsberg &
Sandra Hershberg

Use code **ZRK93** online
until May 30, 2016 to
get 20% off!

 **Routledge**
Taylor & Francis Group

Routledge... think about it

www.routledge.com/mentalhealth

APA DIVISION 39 MEMBERS RECEIVE SPECIAL SUBSCRIPTION RATES TO ROUTLEDGE PSYCHOANALYSIS JOURNALS

**SUBSCRIBE
NOW**

Routledge Journals is pleased to offer members of the **American Psychological Association: Division 39 (Psychoanalysis)** special rates to 2016 print and online subscriptions of journals from our Psychoanalysis Portfolio. Email societies@tandf.co.uk to expedite your order.



Psychoanalytic Inquiry
www.tandfonline.com/HPSI
Print ISSN: 0735-1690
Online ISSN: 1940-9133
8 issues per year
Special Rate - \$90 / £56



Psychoanalytic Dialogues
www.tandfonline.com/HPSPD
Print ISSN: 1048-1885
Online ISSN: 1940-9222
6 issues per year
Special Rate - \$88 / €70



Contemporary Psychoanalysis
www.tandfonline.com/UUCP
Print ISSN: 0010-7530
Online ISSN: 2330-9091
4 issues per year
Special Rate - \$79 / £49 / €66



Studies in Gender and Sexuality
www.tandfonline.com/HSGS
Print ISSN: 1524-0657
Online ISSN: 1940-9206
4 issues per year
Special Rate - \$56



**Journal of Infant, Child,
and Adolescent Psychotherapy**
www.tandfonline.com/HICP
Print ISSN: 1528-9168
Online ISSN: 1940-9214
4 issues per year
Special Rate - \$78 / £47 / €56

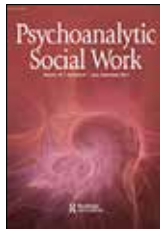

Psychoanalytic Social Work
www.tandfonline.com/WPSW
Print ISSN: 1522-8878
Online ISSN: 1522-9033
2 issues per year
Special Rate - \$40



Psychoanalytic Perspectives
www.tandfonline.com/UPPE
Print ISSN: 1551-806X
Online ISSN: 2163-6958
3 issues per year
Special Rate - \$37

ROUTLEDGE AUTHOR SERVICES

Author Services offers guidance, developments, news and ideas for authors at all stages of the publishing process. Our website offers advice and tips on preparing your article and choosing a journal, plus information on what to expect during peer review, production, and once you're published. Visit us online!

authorservices.taylorandfrancis.com



www.facebook.com/RoutledgePsychoanalysis



www.twitter.com/RoutledgeMH



HOT & BOTHERED

WEDNESDAY, APRIL 6

9 am–noon

Woodruff

Continuing Education Master Class

Perversion: To Die in Order to Live?

Yudit Jung, PhD, LCSW

9 am–noon

West Paces

Continuing Education Master Class

The Integrative Treatment of Complex Dissociative Disorders

Kathy Steele, MN, CS, APRN

1–3 pm

Habersham

Continuing Education Master Class

A Therapist's Guide to New Media: How to Promote Your Practice and Expertise Through Websites, Blogging, and Social Media

Kristi Piekiewicz, PhD

1–4 pm

Woodruff

Continuing Education Master Class

Psychoanalytic Dreamwork: The Bridge Between I and Thou

Kendle Hassinger, LPC

1–5 pm

Buckhead II

Continuing Education Master Class

The DSM-V and the Psychodynamic Diagnostic Manual—Revised

Robert M. Gordon, PhD, ABPP

HOT & BOTHERED

WEDNESDAY APRIL 6

3–5 pm

Buckhead I

Continuing Education Master Class

Starting a Practice: Let's Talk About Money (Practical Tips and Considerations)

Tanya Hess, PhD
Benjamin Rubin, PsyD
Brian Brown, PsyD
Michael R. Donnell, PsyD
Michael C. Klein, PhD
Kathryn G. White, PhD
Marilyn Charles, PhD, ABPP

6–8 pm

Ballroom CDE

Special Event

An Evening with Nancy McWilliams, PhD, ABPP

followed by a reception co-sponsored by the Atlanta Psychoanalytic Society

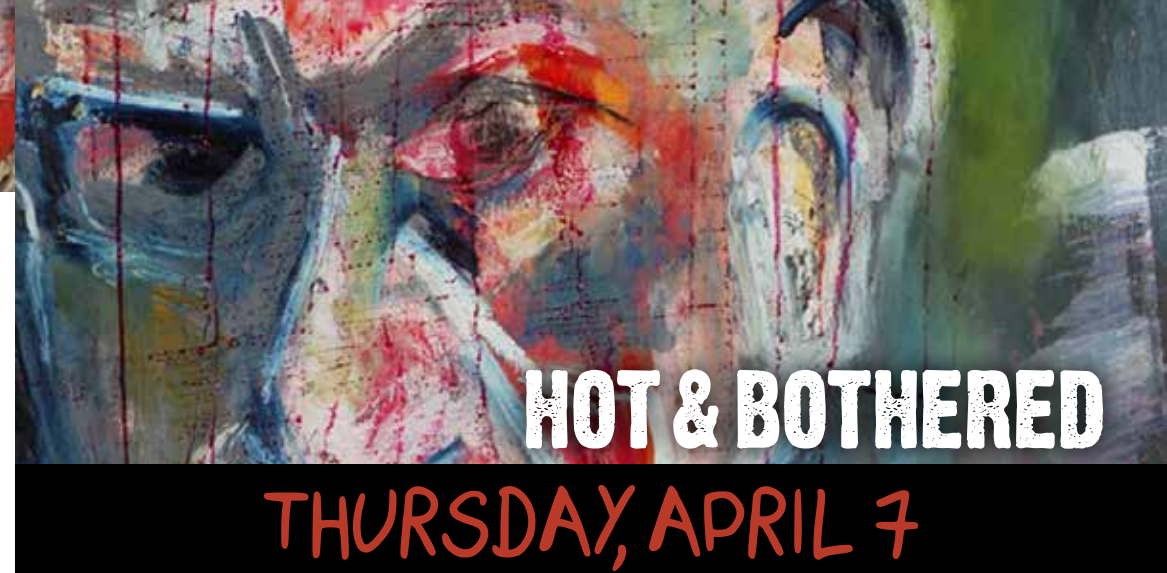

7:30–8:20 am

Ballroom Pre Function Area

Coffee and Networking

8:30 am–4:30 pm

Woodruff

Board of Directors Meeting

8:30–9:20 am

Tuxedo

Colloquy

Fire and Ice: The Vicissitudes of Engaging the Treatment Resistant Patient

Using clinical examples and research findings from work with difficult-to-treat patients, this colloquium will discuss multiple issues involving the vagaries of working with patients within the framework of psychodynamic treatment. The presenters will lead a panel discussion with the audience encouraging dialogue from everyone's clinical experience.

Steve Ackerman, PhD
Warring Minds

Stefanie L. Speanburg, PhD, LCSW
Accepting/Transcending Limits: Countertransference and Treatment Resistance

Michael Groat, PhD, MS, *discussant and chair*
Chris Fowler, PhD, *discussant*

ROWMAN & LITTLEFIELD

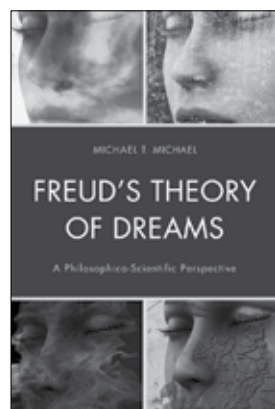

2015 • 258 pages
978-1-4422-3044-6 • \$75.00 • Cloth
978-1-4422-3045-3 • \$74.99 • eBook

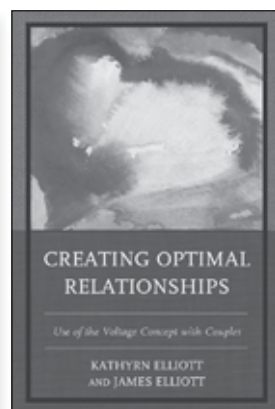

2015 • 232 pages
978-1-4422-3810-7 • \$85.00 • Cloth
978-1-4422-3811-4 • \$84.99 • eBook

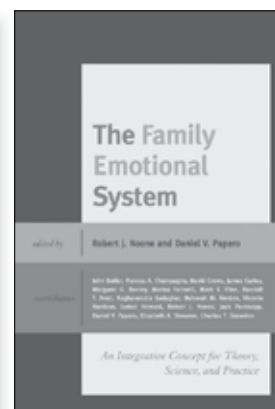

2015 • 286 pages
978-0-7391-9893-3 • \$90.00 • Cloth
978-0-7391-9894-0 • \$89.99 • eBook
Lexington Books

WWW.ROWMAN.COM | 800-462-6420



THURSDAY APRIL 7

THURSDAY APRIL 7

8:30–9:20 am

Buckhead II

Colloquy

Learning to Analyze: A Conceptual Understanding of Becoming a Psychoanalyst

Becoming a psychoanalyst is a long and arduous pursuit. The learning process itself has rarely been given scrutiny and exploration. The need to review this in a contemporary context is all the more urgent in a contemporary psychoanalytic environment that has deconstructed the nature of rules and authority in practice.

Michael Klein, PhD

8:30–10:20 am

Chastain

Steering Committee Invited Panel

TH-1 How the APA Became the Torturer's Apprentice: Ethical and Clinical Issues

Three senior members of Division 39 discuss APA's role in torture including the history and the current status of the issue. Extensive attention is also paid to the specific organizational and clinical issues that led to do what many have described as the greatest ethical scandal in psychology's history.

Bryant Welch, JD, PhD

Stephen Soldz, PhD

Steven Reisner, PhD

William A. MacGillivray, PhD, ABPP, *moderator*

8:30–10:20 am

Habersham

Committee on Psychoanalysis and Community Panel

TH-2 Conversations in Applied Psychoanalysis: Working with Populations in Crisis

Panelists and audience will engage in conversation regarding panelists' experiences working as psychologists and psychoanalysts with populations in crisis, stricken by natural disasters and war. The conversation will touch on the experience of witnessing and sharing the impact of crises and how that changes the professional perspective.

Ghislaine Boulanger, PhD

Listening with the Third Ear to Clinicians Working During Crises

Judith Roth, PhD

Solidarity and Witnessing: Reflections on Engaging in Zones of Trauma

Andrea Rihm, MA, PhD(c), *moderator*

Judith L Alpert, PhD, *co-chair*

Mary-Joan Gerson, PhD, *co-chair*

8:30–10:20 am

West Paces

Panel

TH-3 Who's Afraid of Getting Hot and Bothered? Talking With Millennials About Sex

This intermediate-level presentation will address the perplexing difficulties analysts encounter when discussing sex with their millennial-generation patients, and provide an opportunity and platform for open discussion about how to address these obstacles and increase freedom and curiosity in the clinical dyad.

Helen Fronshtein, PsyD

Eugenio A. Duarte, PhD

Andrew B. Suth, PhD

8:30–10:20 am

East Paces

Panel

TH-4 Hot and Cold: Emotional Intensity and Its Anxieties

This panel will use the metaphors of "hot" and "cold" to describe how individuals may either unleash the "heat" of their emotional intensity or cover up the vulnerability of that emotionality by "cooling down." Each of the two papers will describe the workings of one metaphor.

Frank Summers, PhD, ABPP

Feeling the Heat: Psychological Asphyxiation in the Countertransference

Peter Shabad, PhD

Being "Cool": Dampening the Vulnerability of Hope to Evade Suffering

Scott Pytluk, PhD, *moderator*

9:30–10:20 am

Tuxedo

Colloquy

The Function of Liminal Space: Psychoanalysis Between Winnicott and Lacan

Perhaps no two psychoanalysts were more different. Winnicott seems to focus on the maternal, Lacan on the paternal. Yet both spoke of an interstitial space where human subjectivity/self is born. Alain Vanier, renowned Lacanian analyst, who knows Winnicott well, discusses both approaches to this 'space.' The moderator will invite audience discussion.

Alain Vanier, MD, PhD

Mark Stafford, MA, *discussant*

Kareen R. Malone, PhD, *chair*

THURSDAY APRIL 7

THURSDAY APRIL 7

10:30–11:20 am

Chastain

Colloquy

Psychoanalysis Case Study with EEG, MMPI-2 and Rorschach Outcome Data

This colloquy will explore how neuropsychological and personality tests can provide evidence about changes that happen in the brain functioning and character structures of people who undergo psychoanalysis. A psychoanalytic case study will be discussed which included intervals of EEG, GSR, heart rate, MMPI-2, and Rorschach testings.

Nancy S. Thurston, PsyD

Psychoanalysis Case Study with EEG, MMPI-2 And Rorschach Outcome Data

Marie Hoffman, PhD

Response to Thurston: Clinical Considerations in Case Study

Robert M. Gordon, PhD, ABPP

Response to Thurston: Psychoanalytic Outcome Assessment Research

Marie Hoffman, PhD, *moderator*

10:30–11:20 am

West Paces

Colloquy

Can We Talk About How Hot it Is in Here?

The paper discusses the challenges of mutual management of the erotic transference/countertransference in an analytic treatment. The paper uses Main and Beebe's disorganized attachment dynamics and Loewald's waning of the Oedipus complex to understand the developmental process in the treatment.

Douglas R. Hansen, MSW

Karen Weisbard, PsyD, *discussant*

10:30 am–12:20 pm

Habersham

Panel

TH-5 Love, Sex, and Madness in the Lives of Women

This panel addresses madness in women's lives as it is linked to sex and romantic love. How does coming together with—and falling apart from—objects of desire hold us together and undo us? And what about these experiences is particular to women at this moment in time?

Sophia Frydman, MA, MFA

Women in Pieces: Love and Breakdown in the Writing of Doris Lessing and Elena Ferrante

Jennifer Marion, MA

Please Hurt Me: The Regulating and Dysregulating Functions of Women's Masochistic Sexual Practices

Cassie Kaufmann, PhD, *moderator*

10:30 am–12:20 pm

Tuxedo

Panel

TH-6 You're Only Old Once: Aging Within Psychoanalysis

This panel addresses issues related to aging in psychoanalysis, including the disavowal of aging bodies of patients and therapists, as well as the parallel disavowal of retirement in a field where most clinicians work significantly past typical retirement age. The goal is to maintain vitality in treatment with older adults.

Susan Klebanoff, PhD

Analyst: Terminable or Interminable? Thinking About Retirement

Heather Ferguson, LCSW

Young at Heart: Sustaining Vitality In Older Patients

Caryn Sherman-Meyer, LCSW

Help! I'm Aging and I Can't Get (It) Up!

10:30 am–12:20 pm

East Paces

Awards Committee Panel

Scholarship Award: Melanie Suchet

TH-7 Surrender, Transformation and Transcendence

This presentation will explore, both experientially and theoretically, transcendent states of consciousness, both as they occur in psychoanalysis and in mystical traditions. The interrelationship and distinguishing features of surrender, transformation and transcendence will be explored. The purpose will be to understand how the analyst's subjectivity, in the form of her state of mind, influences and shifts the relational field and how understanding transformation and transcendence may enhance our clinical work.

Jill Salberg, PhD, ABPP, *discussant*

Mamta Dadlani, PhD, *moderator*



MELANIE SUCHET is Clinical Associate Professor, NYU Postdoctoral Program in Psychotherapy and Psychoanalysis and Faculty member at the Stephen A. Mitchell Center for Relational Studies. She is an associate editor of *Psychoanalytic Dialogues* and a contributing editor of *Studies in Gender and Sexuality*. Her private practice is in Manhattan. She is the originator and co-editor of *Relational Psychoanalysis: Volume 3* dedicated to bringing to the fore newer ideas, especially political and social issues. She is co-editor of the

Routledge book series *Psyche and Soul*. She works on the edges of psychoanalysis, attempting to bring into the center what has been excluded and dissociated. Her interests also lie in the analyst's subjectivity, and specifically in the subject positions the analyst holds with respect to race, class, gender and sexuality.

THURSDAY APRIL 7

THURSDAY APRIL 7

10:30 am–12:20 pm

Buckhead II

Steering Committee Invited Panel

TH-8 Contemplative Practices and Psychoanalytic Process

The panel will address the challenges arising when contemplative practices are introduced to clinical or highly distressed populations (battered women, incarcerated populations, suicidal populations, etc). Drawing from their work, the panel will present data and discuss the challenges faced when non-clinicians teach contemplative or mindfulness practices to at-risk populations. The intersections of contemplative practice, trauma and psychotherapy will be discussed.

Brendan Ozawa-de Silva, PhD

Chikako Ozawa-de Silva, PhD

Nadine Kaslow, PhD, ABPP

Bobbi Patterson, PhD

Nancy D. Chase, PhD, LCSW, *chair*

11:30 am–12:20 pm

West Paces

Colloquy

Learning to Love, and Be Loved, by the Unlovable Patient. Repeated Rupture, Reparation, and Recalibration

Hot and Bothered is an apt description of the emotional climate that regularly infuses the treatment of a patient with a complicated diagnostic profile. Struggling for mutuality through repeated ruptures, both my patient and I have had to confront the many faces we wear in our lives and with each other.

Alison McGrath Howard, PsyD

11:30 am–12:20 pm

Chastain

Colloquy

Coming Together Through Falling Apart: Change Across Testing and Therapy

This presentation will be focused on examining the complexity of change in a depressed patient from the perspective of the psychotherapist and the testing psychologist over the course of long-term residential treatment.

Jeremy M. Ridenour, PsyD

Heather Churchill, PsyD, *moderator*

12:30–1:20 pm

West Paces

Committee on International Relations in Psychoanalytic Psychology Board Meeting

12:30–1:20 pm

Peachtree

Committee on Psychoanalysis and Health Care Board Meeting

1:30–2:20 pm

Tuxedo

Colloquy

Melanie Klein from the Inside Out: Improvisational Role Play

This experiential colloquy will offer improvisational role play of the psychoanalytic actor inhabiting the inner being of Melanie Klein. This role play will be based on psychobiographical and historical knowledge of this theorist, as well as on this theorist's contribution to the field of object relations psychoanalysis.

Susan Kavalier-Adler, PhD, ABPP

1:30–3:20 pm

Habersham

Section V Panel

TH-9 Questions Concerning Manualization: A Watershed or Waterloo?

Despite increasing numbers of empirical studies on analytic or psychodynamic treatment approaches, pressure put upon graduate programs to train, and demands by insurers to provide empirically supported treatments, there remains concern that manualized treatments are antithetical to core principles of analytic work. Panelists will discuss their perspectives on this question.

Larry Rosenberg, PhD

Introductory Comments

Barry Dauphin, PhD

The Fault Is Not In Our Manual?

Diana Diamond, PhD

Transference Focused Psychotherapy (TFP)

David Lichtenstein, PhD

Knowing and the Unknowable

Joel Weinberger, PhD

The Uses and Misuses of Manuals

Drew Westen, PhD

Twin Dangers in Clinical Case Formulation: Failure to Diagnose Disorders as Well as Dynamics Vs Diagnosing Patients to Fit Neat, Manualizable Diagnostic Categories

Larry Rosenberg, PhD, *moderator*

THURSDAY APRIL 7

THURSDAY APRIL 7

1:30–3:20 pm

West Paces

Panel

TH-10 “Nobody Puts Baby in a Corner”:

Reflections on Supervision and the Supervisee Experience

The supervisory relationship is a critical aspect of psychoanalytic clinical training yet is rarely discussed in established forums. This panel explores supervision through multiple lenses. Case material is offered to suggest a conceptualization of the supervisory relationship as dynamic and co-constructed and to spur discussion about best practices in supervision.

Navya Singh, PsyD

Supervision’s Heritage: From Pedagogia to Mutuality

Mineko Anne Legendy, BA

Geraldine Mapel, BA

Ellie Neuman-Fligelman, PhD

Negotiating Intimacy: Power, Vulnerability and Difference Within the Supervisory Space

Lauren Glick, PsyD

Amy Smith, MA

What’s Supervision Got to Do With It? How Supervision Fosters Supervisees’
Clinical Development and Interpersonal Awareness

Elizabeth Krimendahl, PsyD, *moderator*

1:30–3:20 pm

Buckhead II

Steering Committee Invited Panel

TH-11 Sex and the Couch

This panel discussion will address the question, “What Role Does Sex Play In Contemporary Psychoanalysis?” Presenters will explore the ways in which leaving sex “off the table” in our clinical conversations poses risks for patients, clinicians, and the analytic endeavor generally. This dynamic panel will productively complicate and expand participants’ understanding of erotic material.

Andrea Celenza, PhD

Vittorio Lingiardi, MD

Elizabeth Wilson, PhD

Stefanie L. Speanburg, PhD, LCSW, *chair*

1:30–3:20 pm

East Paces

Panel

TH-12 Beyond Beyond the Pleasure Principle: Impediments to Change

This panel will explore the all too common and perplexing therapeutic experiences where the therapeutic process becomes stagnated. Each paper, from different perspectives, explicates how the development and maintenance of these stalemates emphasize the contribution of parallel process between patient and analyst.

Robert E. Hooberman, PhD

Safety and Trust in the Analytic Endeavor

Linda B. Sherby, PhD

Omnipotence and Despair in the Treatment Room

Sandra Buechler, PhD

Power Struggles about Treatment and Beyond

Robert E. Hooberman, PhD, *moderator*

1:30–3:20 pm

Chastain

Panel

TH-13 Disruptive Transmissions/Reparative Acts

This panel will look at inter-generational transmissions of trauma that occur in the background of both patient and analyst. These dyads had particular vulnerabilities to enactments given the trans-generational histories and as a consequence unique capacities for healing.

Linda Jacobs, PhD

Jill Salberg, PhD, ABPP

Seth Aronson, PsyD, *discussant*

2:30–3:20 pm

Tuxedo

Colloquy

How Do Psychoanalytic Therapists Approach Cultural Competence?

Recently, scholars have emphasized sociocultural context as essential to psychoanalytic approaches. This colloquy has two central aims: 1) Present findings from a qualitative study concerning psychoanalytic clinicians’ perspectives on cultural competence; 2) Foster dialogue on how psychoanalytic practitioners conceptualize and approach issues of cultural competence in psychotherapy, and related dilemmas.

Usha Tummala-Narra, PhD, *chair*

Paul Letendre, MA

Emanuela Sarbu, MA

THURSDAY APRIL 7

THURSDAY APRIL 7

3:30–4:20 pm

Tuxedo

Colloquy

U.S. Slavery and American Whiteness: Dysregulated Memories, Disavowed Violence, and Collective Trauma

Based on over a thousand minutes of data from interviews with contemporary white Americans about their internal representations and associations to U.S. slavery, this presentation offers a glimpse into American whiteness and the intergenerational transmission of its traumatic construction.

Ryan Parker, LCSW

Elizabeth Kita, PhD, LCSW, *moderator*

3:30–5:20 pm

West Paces

Panel

TH-14 Group Sex: Hot and Bothered in Peer Group Supervision

When sexual dynamics are evoked in psychoanalytic treatment, powerful enactments develop. Peer group supervision plays a powerful role in exploring and resolving enactments if clinicians can be vulnerable and take risks within the group. Members of this peer group discuss becoming “unstuck” from sexual enactments.

Helen Quinones, PhD

Figure-Ground Dilemma: Am I Witnessing Normal Sexual Development or a Reenactment of Abuse

Alison Feit, PhD

Icy Sex: Witnessing Perverse Passion

Alan Slomowitz, PhD

Alone, A Man in a Woman's World

Allison Lee, MD

Coming of Age in Peer Group Supervision—Depolarizing Enactments and Freeing the Clinical Self

Frances V. Dillon, MSW, CSW, *moderator*

Helen Quinones, PhD, *chair*

3:30–5:20 pm

Chastain

Committee on Psychoanalysis and Health Care Panel

TH-15 The Mind and Body in Pain: Two Responses to a Case Presentation

Physical pain and health problems often leave therapists unable to integrate them into the therapeutic process. A case presentation with two discussions is used to illustrate clinical interventions that restore the mind body dialogue and preserve mind body integrity.

Carrie K. Evenden, PsyD

Case Presentation

Eric Sherman, PsyD

A Psychoanalytic Approach to Treating Chronic Pain Syndromes

Barbara Pizer, EdD, ABPP

Body Words: Creating a Relational Context for the Patient's Movement from Symptom to Speech

Judith L. Alpert, PhD, *moderator*

3:30–5:20 pm

Buckhead II

Section VIII Panel

TH-16 To Tell the Truth? The Whole Truth? And Nothing But?: Secrets and Couple Psychotherapy

In what ways do secrets and truths protect or harm intimacy in relationships? How do couple therapists deal with secrets and that which makes them difficult to disclose? Four presenters will discuss secrets, truths and deceptions between couples and how therapists deal with them in their couple work.

Deborah Wolozin, PhD

Can Some Secrets Stay Secret?

Monique Bowen, PhD

Getting to the Real by Acknowledging the Ideal

Phyllis Cohen, PsyD

To Be Perfectly Honest?

Marilyn N. Metzler, PhD, ABPP

When Your Lover is a Liar: Dealing With Betrayal in an Older Couple

Phyllis Cohen, PsyD, *moderator*

THURSDAY APRIL 7

THURSDAY APRIL 7

3:30–5:20 pm

East Paces

Section IX Panel

TH-17 Being Othered in the U.S.A.: Psychoanalytic Voices

We are exploring the experience and significance of being “othered” in our society, through the voices of three women, clinicians representing ethnic/religious groups particularly burdened by projection in the U.S.A. There will be ample time for a town hall style discussion following the presentations by our panelists.

Nadine Obeid, PhD

Between The World and Me

Daphny Dominguez Ainslie, PsyD

The Experience of Being “Othered” as a Clinician, Mother, Daughter-In-Law and Neighbor

Carnella Gordon-Brown, MSW, *discussant*

Ricardo C. Ainslie, PhD, ABPP, *moderator*

3:30–5:20 pm

Habersham

Panel

TH-18 What Healing Has to Do with Termination? Endings and Interruptions

This panel addresses links between termination and healing as elemental concepts of classical and Lacanian theory and fundamental tools of psychoanalysis. Termination is often viewed as the endpoint of analysis, synonymous with healing. We propose that termination can be the springboard for lifelong processes of growth and creativity after termination.

Vaia Tsolas, PhD

The Shadowing of the Object: Interruptions in the Analytic Process?

Glauco Maria Genga, MD

Healing as a Problem or a Challenge?

Maria Gabriella Pediconi, MA

Healing: Freudian and Lacanian Concepts and Psychoanalytic Variations

Luca Flabbi, PhD

Applications; Healing: A Process, a Tool, an Aim?

4:30–5:20 pm

Tuxedo

Colloquy

Passionate Engagement in the Research Encounter

Despite research’s perceived lack of creativity and excitement, the research encounter may indeed allow participants and the researcher to enter into a passionate engagement of the research topic, permitting a deeper and more creative understanding of the phenomenon under investigation to emerge.

Catherine H. Hicks, PhD

5:30–7 pm

Grand Ballroom

President’s Address and Awards Ceremony

President: Marilyn Charles, PhD, ABPP, *presiding*

Awards Chair: Dennis Debiak, PsyD

Award Recipients:

Leadership Award: Mary-Joan Gerson, PhD

Diversity Award: David Ramirez, PhD, ABPP

Past President’s Address: Frank Summers, PhD, ABPP

Is There a Psychoanalytic Contribution to the Problem of Mass Violence?

Awardees



MARY-JOAN GERSON is Adjunct Clinical Professor, Supervisor, and Director of the Advanced Specialization in Couple and Family Therapy at the New York University Postdoctoral Program in Psychotherapy and Psychoanalysis, as well as the Co-Chair of the Pro Bono and Activism Committee at the Institute. She is a Supervisor at the National Institute for the Psychotherapies, and is on the teaching faculty of the Mount Sinai School of Medicine. She has published many articles, and presented nationally and internationally on the integration of psychoanalysis, family systems and attachment theory, as well as a full length book, *The Embedded Self: An Integrative psychodynamic and systemic perspective on couple and family therapy* (2nd edition), Routledge, 2009. She has also written extensively on the relationship meaning of chronic illness. Mary-Joan has been active in Division 39 in multiple ways, all enormously gratifying to her. She was the Founding President of Section VIII, Couples and Family Therapy, the Founding Co-Chair of the Psychoanalysis and Health Care Committee, and the Founding Co-Chair of the Psychoanalysis and Community Committee. She served as Chair of the Awards Committee from 2011 until 2014, as well as two terms as Member-at-Large on the Board of Directors of Division 39. For the past 10 years, she has been a voluntary consultant at non-profit agencies in New York City focused on international relief and foster care. Passionate about cross-cultural travel and learning, Mary-Joan has published five books for children about the folklore of Africa, Brazil and Mexico, and was a Fulbright Specialist scholar in Namibia in 2012. She was the recipient of the Division 43 Florence Kaslow Award for International Research and Consultation in 2012. Mary-Joan is in independent practice in New York City.



DAVID RAMIREZ served as Membership Committee Chair to Division 39 presidents Lee Caligor, Morris Eagle, Jonathan Slavin, Harriette Kaley, and Marvin Hyman. He was elected Treasurer in 1998, serving on the Executive Committee with Lew Aron, Spyros Orfanos, Laurel Bass Wagner, Jonathan Slavin and Jaine Darwin until assuming the Presidency from 2005-2006. David is a native of Texas, born in San Antonio and living in Austin until his move to Philadelphia in 1983. He earned his Ph.D. at the Counseling Psychology Training Program at the University of Texas, Austin, completing his pre-doctoral internship at Temple University Medical School’s Psychiatry department. He has been Director of Swarthmore College Counseling & Psychological Services since 1994, providing psychodynamic supervision and training for psychology, social work and psychiatry interns and residents. He received his psychoanalytic training at the Philadelphia School of Psychoanalysis, a Modern Psychoanalytic institute. He is past President of the Division 39 local chapter, the Philadelphia Society for Psychoanalytic Psychology, and is currently President/Treasurer of the Philadelphia Center for Psychoanalytic Education. He holds the Diplomate in Psychoanalysis in Psychology and is a Fellow of the American Psychological Association.

HOT & BOTHERED

THURSDAY APRIL 7

7–8:30 pm

Grand Ballroom

Welcome Reception

Music by The Gary Busey Quartet (Emory Jazz Ensemble)

7 pm

Grand Ballroom

Poster Session

7:45 pm

Tuxedo

The Georgia Innocence Project (GIP)

GIP is a non profit organization dedicated to helping individuals who have been convicted of crimes they did not commit. The Project works to secure post-conviction DNA testing for inmates in Georgia and Alabama, where DNA analysis could provide guilt or innocence and adequate DNA testing was not available at trial. Joining us tonight is Melanie Hammet, who creatively combines her music and her causes. With more than a dozen recordings, her songwriting often takes on subjects that at first glance may seem non-musical. Her recent partnership with GIP resulted in the collaboration with Clarence Harrison and songwriting partner Ben Holst. Clarence's wrongful conviction, 18 year imprisonment, and 2004 exoneration by GIP serves as the blueprint for the music and performance "Life 20|20." Hammet serves as executive producer for Life Sentence, which has created unique outreach, resources, grant awards, and dollar donations for GIP. The song "(DNA) Do Not Assume" was selected as a musical theme for the Robert Redford produced 2014 CNN series, "Death Row Stories." Learn more about GIP and Hammet's work.

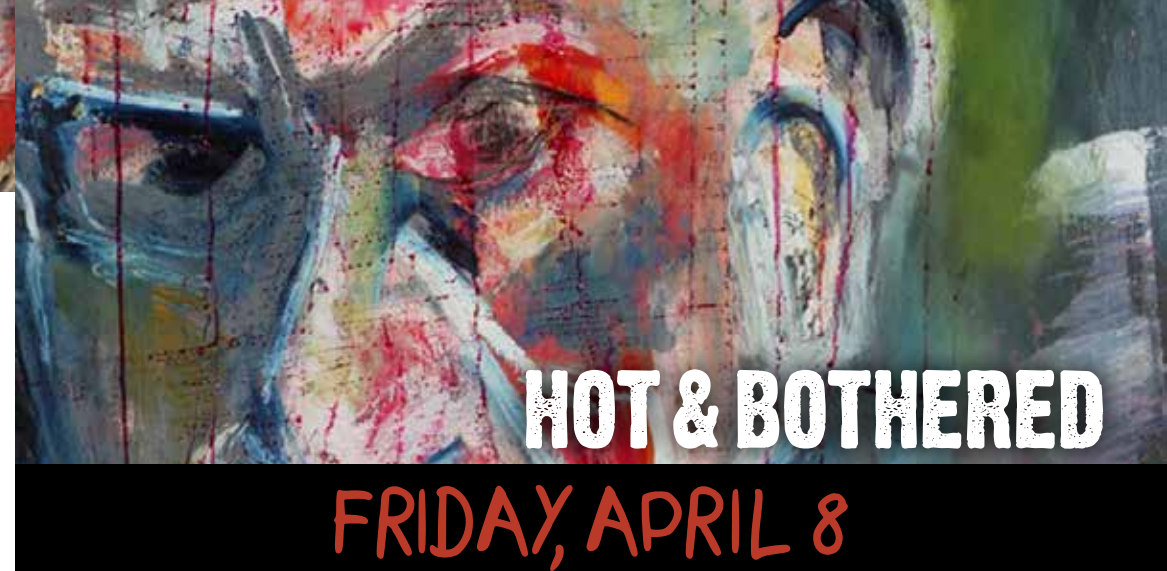

7–7:50 am

Peachtree

Research Committee Board Meeting

8–9:50 am

Ballroom A & B

FR-1 Keynote Address and Coffee

Françoise Davoine, PhD

The Failure of Memory: War, Psychosis, Racism, Sex

This presentation, introduced by Claire Nouvet, PhD, will address how the troubled individual, the psychotic, the war traumatized, etc., "carry" cultural memory repressed by the wider society and (re)present the failure of the social link. The therapist's task is to accompany the troubled person to a confrontation with and a restoration of history.

Claire Nouvet, PhD, *co-chair*

William A. MacGillivray, PhD, ABPP, *co-chair*



FRANÇOISE DAVOINE has worked as a psychoanalyst for more than 30 years at a public psychiatric hospital and in private practice along with her late husband, Jean-Max Gaudilliere. She is currently professor at the Ecole des Hautes Etudes en Science Sociales in Paris and has advanced degrees in the classics and French, and doctorates in sociology. She is a member of the International Symposium for the Psychotherapy of Schizophrenia (US branch). In the course of their work with patients in psychiatric hospitals and private practice, Françoise and Jean-Max uncovered ways in which transference and countertransference are affected by the experience of social catastrophe. Handed down from one generation to the next, the unspoken horrors of war, betrayal, dissociation, and disaster in the families of patient and analyst alike are not only revived in the therapeutic relationship, but, when understood, actually provide the keys to the healing process. Through examples from medieval carnivals and Japanese No Theater, to Wittgenstein and Hannah Arendt, to Sioux rituals in North Dakota, they have described the ways in which psychological damage is done—and undone. With her late husband, she is the author of *Wittgenstein's Folly and History Beyond Trauma*. She recently published *Mother's Folly*, currently being made into a movie.

10–10:50 am

Buckhead I

Section IV Senate Meeting

FRIDAY APRIL 8

FRIDAY APRIL 8

10–10:50 am

Woodruff

Stephen Mitchell Award

Awardee to be Announced

Elliot Jurist, PhD, PhD, *chair*

10–11:50 am

Peachtree

Committee on Psychoanalysis and the Community Board Meeting

10–11:50 am

Tuxedo

Panel

FR–2 Enduring and Working with Assaults on the Analyst's Subjectivity

These papers address demanding and assaultive dyadic entanglements. One illustrates the analyst's unobtrusive engagement in the flow of enactment that allows the emergence of a non-represented and sadistic "total situation." The second addresses the dilemma faced by the analyst working with a patient whose politics and ideology he finds objectionable.

Robert Grossmark, PhD

Enactment: The Total Situation

Steven Tublin, PhD

Negotiating the Non-Negotiable: Crossing the Political Divide While Retaining One's Moral Center

Philip Blumberg, PhD, *moderator*

10–11:50 am

Chastain

Panel

FR–3 Tensions on the Border Between Speech and Action

Lines between speech and action have troubled psychoanalysis since its inception. Manifestations of transference are moments when the tension on this border reveals itself. Using a clinical illustration as a touchstone, we consider how lines between speech and action in psychoanalysis relate to those in political and free speech discourses.

Jill Gentile, PhD

Enshrined Ambiguity: Speech in Psychoanalysis and Free Speech

David Lichtenstein, PhD

The Psychoanalytic Act: On the Boundary of Speech and Action

10–11:50 am

Buckhead II

Steering Committee Invited Panel

FR–4 Creativity and the Human Spirit: Trauma and the Healing Power of Art

Our presenters will discuss their clinical, research, and/or personal experience with artwork, their own (poetry, dance, painting) and that of others, as a potential avenue for transforming traumatic experience and for articulating inchoate meanings. Clinical experience and research on the function and meanings of art as intervention in contexts ranging from psychotherapeutic to a preschool setting in New South Wales will be brought to bear on understanding creativity as a resource for addressing various degrees of personal disruption and self depletion, including trauma, loss, and burn out.

George Hagman, MSW, LCSW

Art, Psychoanalysis and the Uses of Artwork in Clinical Practice

Marilyn Charles, PhD, ABPP

Recollection and Working Through: Symbolizing and Narrativizing Traumatic Experience

Carol M. Press, EdD

Restoration of Hope: The Creation of a Dance

Karen M. Schwartz, PhD

Slide Presentation and Talk: Painting as a Way of Making Sense and Its Relevance to Psychotherapeutic Process

Karen M. Schwartz, PhD, *chair*

10–11:50 am

West Paces

Panel

FR–5 On Poetry and Psychoanalysis: Imaginary Gardens, Real Toads...

In this panel, we will focus on some lessons psychoanalysts can learn from poetry. The title is a quote from the American poet Marianne Moore who said that poetry can give us "imaginary gardens with real toads" in them. Much the same can be said for psychoanalysis.

Henry M. Seiden, PhD, ABPP

"Imaginary Gardens, Real Toads:" Discussion of a Poem by Marianne Moore

William Fried, PhD

"Finding Out What It Really Means:" Discussion of a Poem by Billy Collins

Maureen Murphy, PhD

"Later... You Have To Be Young:" Discussion of a Poem by W.S. Merwin

Henry M. Seiden, PhD, ABPP, *moderator*

FRIDAY APRIL 8

FRIDAY APRIL 8

10–11:50 am

East Paces

Research Committee Panel

FR-6 The Synergy Between Research and Clinical Technique in Transference Focused Psychotherapy (TFP)

The panelists will focus on how research and clinical work have worked synergistically in the development of Transference Focused Psychotherapy, the first psychoanalytic, evidence based treatment for personality disorders. The focus will be on how research in reflective function, neurocognition and attachment inform clinical process and technique in TFP.

Barry Stern, PhD

How the Structured Interview for Personality Organization Informs Clinical Practice in TFP

Eric Fertuck, PhD

Synergy of Mind and Brain in Borderline Personality Disorder: Implications for the Theory and Technique of Transference Focused Psychotherapy

Kenneth N. Levy, PhD

How Evidence About Interpretative and Reflective Processes Impacts What We Know About Clinical Process

Diana Diamond, PhD, *moderator*

10–11:50 am

Habersham

Section I Panel

FR-7 Analyzing Psychoanalysis Today: Challenges in Training, Theory, Practice and Politics

Psychoanalysis today is in the midst of a period of marginalization in contrast to its preeminence decades ago. The purpose of the panel is to analyze our struggles and engage us in a discussion about how to make psychoanalysis a more relevant force both from a clinical and societal perspective.

Erika Schmidt, MSW

Training Psychoanalysts for the Future of Psychoanalysis

Nancy Burke, PhD

The Use and Abuse of Theory: On Teaching and Illusion

Laura Esikoff, MA

Rethinking Clinical Practice: Broadening the Scope and Approach to Psychoanalytic Intervention

Allan Scholom, PhD

Analyzing Evidence Based Practice: Myths and Realities

Lynne Layton, PhD, *moderator*

12–12:50 pm

Peachtree

Section III Board Meeting

12–12:50 pm

Tuxedo

Psychoanalytic Psychology Editorial Board

12–1:20 pm

Buckhead I

Scholars Reception

1–2:50 pm

West Paces

Panel

FR-8 Weathering the Storms: Supervision and Support for Therapists Working With Trauma Survivors

This panel presents a model of supervision which embraces therapists' thoughts and feelings in order to help them embrace their patients'. After introducing the model, we will view a videotape of a treatment session—dyadic work with a mother and her young child—and engage in group supervision.

Jill Bellinson, PhD

Phyllis Cohen, PhD

Andrea Remez, PhD

Shauna Balch, PsyD

Ashley Golub, PsyD

Eric Hovis, MA

Lisa Wolfe, LCSW

1–2:50 pm

Chastain

Panel

FR-9 Grey Hares

What becomes of sex in old age? Rumors of its death seem premature. We present work with patients who were able to create new avenues for sexual exploration and consider the risks and pleasures of opening to new possibilities late in life.

Sally Bjorklund, MA PsyA

Grey Hares: On Still Getting Hot and Bothered

Steven Kuchuck, LCSW

Sex and Love on the Upper East Side

Hillary Grill, LCSW, *discussant*

FRIDAY APRIL 8

FRIDAY APRIL 8

1–2:50 pm

Buckhead II

Steering Committee Invited Panel

FR–10 Strength and Tenderness: The Challenges of Masculinity in the Modern Era

This presentation will look at current psychoanalytic and neurobehavioral thinking and research on notions of maleness, masculinity, and male gender identity, with special attention paid to the social construction of male identity and depictions of fatherhood in different sub-cultures. Biological correlates of human paternal behavior related to caregiving will be surveyed. Especially pertinent to the presentations will be the contradictory messages, images, and demands with which modern males must struggle.

Mark O’Connell, PhD

Negotiating the Male Avatar: A Relational Consideration of the Meanings of Hardness, Competitiveness, Stoicism and Other Stereotypic Symbols of Masculinity

James Rilling, PhD

Biological Correlates of Individual Variation in Human Paternal Behavior

Kirkland Vaughans, PhD

Black Fatherhood, Historical Traumas, Present Anguish, Myths, Challenges, and Hope

Joyce M. Cartor, PhD, *chair*

1–2:50 pm

Habersham

Panel

FR–11 Opening Up Blocked Mourning Through “Object Survival” of Primitive Aggression

This panel offers a clinical case of the analyst’s “object survival” when facing patient’s split primitive transference primal rage, resulting in the patient becoming an interpretive/ historical subject. The two discussants will integrate this case material via two different theoretical perspectives: the British object relations and the French intersubjective approach.

Susan Kavalier-Adler, PhD, ABPP

Opening Up Blocked Mourning Through the “Object Survival” of Primitive Aggression: British Object Relations and French Intersubjective Perspectives

Eva D. Papiasvili, PhD, ABPP, *discussant*

Marilyn N. Metzl, PhD, ABPP, *discussant*

Ellen L.K. Toronto, PhD, *moderator*

1–2:50 pm

Tuxedo

Panel

FR–12 When the Parent is a Psychotherapist

To explore implications for our patients, children and ourselves of life led in the simultaneous roles of psychotherapist and parent, we will examine being a child of psychotherapists, treating children of psychotherapists, and treating parenting issues in psychotherapist patients. We will encourage attendees to comment and participate in the discussion.

Roberta Caplan, PhD

Working With College Students Whose Parent is a Psychotherapist: Treating the “Condition”

Rachel Barbanel-Fried, PsyD

Growing Up With Psychotherapy

Carolynn Maltas, PhD

Growing Up With Therapists as Parents and Treating Parents Who Are Therapists

Joyce Lowenstein, PhD, *moderator*

Roberta Caplan, PhD, *chair*

1–2:50 pm

East Paces

Committee on Multicultural Concerns, Committee on Sexualities and Gender Identities and Section III Joint Panel

FR–13 Intersectionality: Gender, Sexuality and Race—the Trifecta. Part I—Theory

This panel examines how multiple identities related to gender, sexual orientation, and race/ethnicity are related to the construction of the self, examining an intersectional approach to clinical conceptualization, highlighting relevant theory and clinical examples. In addition, the presentation summarizes relevant research findings regarding sexual fluidity for a practice-oriented psychoanalytic audience.

Lisa Diamond, PhD

Shara Sand, PsyD

Hector Adames, PsyD

Sanjay R. Nath, PhD, *co-chair*

Kristin Davisson, PsyD, *co-chair*

1–2:50 pm

Peachtree

Section V Board Meeting

FRIDAY APRIL 8

FRIDAY APRIL 8

3–3:50 pm

Book Exhibitor Area

Meet The Author

Psychoanalysis in Times of Accelerating Cultural Change: Spiritual Globalization

In this session, there will be an opportunity to discuss the recently published book with its author, Neil Altman. The book addresses the cultural and historical location of psychoanalysis across national boundaries and through time.

Neil Altman, PhD

Ricardo Ainslie, PhD, ABPP, *discussant*

3–3:50 pm

Book Exhibitor Area

Meet The Author

The One and the Many: Relational Approaches to Group Psychotherapy

Applies advances in relational psychoanalysis to the theory and practice of group psychotherapy creating a vibrant and dynamic new wave in group psychotherapy.

Robert Grossmark, PhD

3–3:50 pm

Book Exhibitor Area

Meet The Author

Feminine Law: Freud, Free Speech, and the Voice of Desire

This author explores the relationship between psychoanalytic free association and democratic free speech. It reveals how ‘feminine law’ opens an embodied space for subjective freedom and collective agency, and for the potentially disruptive but also liberating flow of desire and its symbols.

Jill Gentile, PhD

3–3:50 pm

Book Exhibitor Area

Meet The Author

Specialty Competencies in Psychoanalysis in Psychology

The author provides comprehensive coverage of what is involved in being a psychoanalyst. It is appropriate for seasoned clinicians looking to strengthen their skills in psychoanalysis, and for students looking to learn core concepts. It delineates all recent functional and foundational competencies of psychoanalytic practice. The book is part of the Series in *Specialty Competencies in Professional Psychology*.

Dolores O. Morris, PhD, ABPP

3–3:50 pm

Buckhead I

Special Workshop for Graduate Students Workshop I

Françoise Davoine, PhD

3–3:50 pm

Ballroom Pre Function Area

Psychoanalytic Fair

Join colleagues to network and learn about new programs and projects

4–5:50 pm

Chastain

Panel

FR–14 Psychotic Anxieties and Containment: Transformational Processes in Psychoanalysis and Supervision

Bion’s container contained model is extended into the psychoanalytic and supervisory relationships in which psychotic anxieties prevail. We discuss how our supervision group facilitates the ability to re-establish a secure capacity for containment, using personal associations and reverie in symbolizing experiences in the supervision triad and the analytic dyad.

Joseph Newirth, PhD

Learning to Ride a Bicycle: Procedural Learning and Supervision

Meredith Darcey, LCSW-R

Why am I So Angry? The Active and Passive Subjective Experience of the Analyst

Kristin Reale, LCSW-R

Dress Me Up In Your Love: Creativity, Compliance, and Containment

4–5:50 pm

Habersham

Committee on Multicultural Concerns, Committee on Sexualities and Gender Identities, and Section III Joint Panel

FR–15 Intersectionality: Gender, Sexuality and Race—The Trifecta. Part II: Clinical Applications

This panel features a case presentation that highlights issues of sexual fluidity, race/ethnicity, and gender and is intended to provide a narrative stimulus for the audience. Then panelists will share their own perspectives on the case and briefly describe clinical perspectives that pertain to the topic of intersectionality.

Lynne Layton, PhD

Orna Guralnik, PsyD

Jessica Chavez, PhD

Scott Pytluk, PhD, *co-chair*

Leilani Crane, PsyD, *co-chair*

FRIDAY APRIL 8

FRIDAY APRIL 8

4–5:50 pm

West Paces

Panel

FR–16 Life in the Midst of Death: Flannery O'Connor, Walker Percy and the Writing Cure

Since at least the time of Mark Twain, Southern writers have been dominant in American literature, bringing a unique perspective on the American dream of success and limitless achievement. These talks will address the specific accomplishments of two Catholic authors and discuss implications for psychoanalytic dreams of success in treatment.

Jane Tillman, MDiv, PhD, ABPP

Moral Injury and the Mysterious Object in the Intergenerational Transmission of Suicide: The Life and Writing of Walker Percy

William MacGillivray, PhD, ABPP

The Searing Insight of Grace: The Comic Vision of Flannery O'Connor

Françoise Davoine, PhD, *discussant*

4–5:50 pm

Tuxedo

Panel

FR–17 Sexual Boundary Violations: When it Is Too Hot in the Consulting Room

Mental health professionals of every theoretical orientation commit sexual boundary violations. Regardless of whether it is addressed in treatment and or whether the type of treatment utilized is designed to make use of transference, a transference-based relationship will develop in the course of treatment. The therapy process promotes unresolved transference based relationships and contribute to the patient's greater receptiveness to boundary violations.

Andrea Celenza, PhD

The False Dichotomy of Transference Love: Real or Unreal

Muriel Dimen, PhD

Beta Elements, Contagion and Stigma: The Collective Dimension of Sexual Boundary Violations

Elizabeth Goren, PhD

Sexual Boundary Violations: What's Missing in Analytic Training

Arlene (Lu) Steinberg, PsyD, *moderator and co-chair*

Judith L. Alpert, PhD, *discussant and co-chair*

4–5:50 pm

Buckhead II

Graduate Student Committee Panel

FR–18 Psychoanalysis, Science, and Graduate Student Identity: A Discussion Regarding Competing Demands for Psychoanalytic Doctoral Students

Recent developments in science have brought more sophisticated forms of quantitative research that may critique, or even support psychoanalytic concepts. How does the psychoanalytic graduate student navigate conflicting ideals of the field as philosophy, or science? Everyone is welcome to join in a town-hall style discussion regarding this important topic.

Morgun Custer, BA

Albert Pace, MA

Nancy Thurston, PsyD

Kritika Dwivedi, MA

Sean M. Fowler, MS, *moderator*

4–5:50 pm

East Paces

Committee on the Humanities and Psychoanalysis Panel

FR–19 Psychoanalysis and the Blues: Discourses on Loss and Resilience

Three authors address parallels between the forms and creative processes involved in playing the blues and psychoanalytic practice. In particular, both forms of encounter are explored as exemplars for transforming affect associated with object loss and thus, the creation of resiliency.

Steven H. Knoblauch, PhD

The Blues: A Dirge of Loss? An Anthem of Liberation? A Psychoanalytic Metaphor?

Paul Martin, PsyD

Goin' Down the Road, Bring It on Home: Loss, the Blues, and the Dialectic of Spontaneity and Form

David Lichtenstein, PhD

To Sing the Blues: Loss and Transformation

Romy Reading, PhD, *moderator*

4–5:50 pm

Peachtree

Committee on Education and Clinical Training Board Meeting

HOT & BOTHERED

FRIDAY APRIL 8

6–8 pm

East Paces

Section VIII Reception

6–8 pm

Buckhead I

President's Reception for Graduate Students, Candidates and Early Career Professionals

7–10 pm

Tuxedo

Movie Night

FR–20 *Beasts of the Southern Wild*

Director: Benh Zeitlin

Screen Play: Lucy Alibar and Benh Zeitlin

Discussant: Catherine Meeks, PhD, MSW

Dr. Meeks will provide a brief overview prior to the screening to highlight the messages which are being presented. Through captivating scenery and the multi-layered story line, audience members will be encouraged to enter into the film as if it is their dream. Attention will be paid to the symbols in the film with consideration given to the beasts and what stirs us.

Dr. Meeks is the retired Clara Carter Acree Distinguished Professor of Socio-Cultural Studies, Wesleyan College. Prior to her appointment at Wesleyan, Dr. Meeks taught African American Studies at Mercer University for 25 years. In addition to her academic career, Dr. Meeks is a community activist who directed a family resource center in a public housing facility and has won the Jimmy and Rosalyn Carter Award for Community and Campus Partnership. She currently serves on the Anti-Racism Commission and the Commission on Spiritual Growth for the Episcopal Diocese of Atlanta.

8 pm

Habersham

Section I Board Meeting



8–9:50 am

Ballroom C,D,E

Keynote Address and Coffee Gideon Yago, writer and reporter

SA–1 Hearts and Minds: The Mechanics of Contemporary Psychoanalytic and Popular Culture

This keynote will be a bi-directional conversation between contemporary psychoanalysis and popular culture. Mr. Yago pulls back the curtain to expose the role psychoanalytic consultation plays in making broadcast media. In turn, he will consult to psychoanalysts about the intrapsychic and sociocultural concerns most relevant to contemporary American audiences.

Stefanie L. Speanburg, PhD, LCSW, *chair*



GIDEON YAGO has spent 15 years as a writer and reporter in broadcast media. His documentary programming for MTV News won him an Emmy, a Peabody, and an Edward R. Murrow Award. His reporting has appeared on CBS News, CNN and PRI's *This American Life*. He also co wrote the third episode of *The Newsroom* with Aaron Sorkin, entitled, *The 112th Congress*. His favorite portrayal of a psychoanalyst is Jack Kruschen in Billy Wilder's *The Apartment*. While at MTV, he covered issues surrounding the Iraq War and its effect on young veterans. Throughout his career, he has interviewed many politicians, musicians and other celebrities including former Presidents Bush and Clinton, Senator John Kerry, former Secretary of State Colin Powell and a host of others. He now works primarily as a screenwriter. Born in Madison, Wisconsin, he grew up in Queens, New York, graduating from Columbia University. At the age of 21, during his senior year at Columbia, he had a full time position at MTV, where he worked as a writer in the News Department. Over the years, he moved into award-winning documentaries and later coverage of the aftermath of Hurricane Katrina in New Orleans and the devastating Kashmir earthquake in Pakistan and India.

10–11:50 am

Ballroom D

Section IV Open Meeting

10–11:50 am

Ballroom E

Committee on Sexualities and Gender Identities Board Meeting

SATURDAY APRIL 9

SATURDAY APRIL 9

10–11:50 am

Buckhead II

Steering Committee Invited Panel

SA-2 Passing the Torch: Present Challenges and Future Opportunities for Psychoanalytic Education and Training

Psychoanalytic learning, in the classroom or on the couch, has always been an intensely personal experience. This panel will bring together psychoanalytic scholars with many years' experience in training and education. Describing their experiences of teaching and training in diverse educational settings, the panelists will discuss with the participants and each other the goals and challenges of transmitting psychoanalytic knowledge in the 21st century.

Jack M. Barlow, PhD

Teaching and Training in an APA Accredited Clinical Psychology Training Program

Rebecca Drill, PhD

Teaching and Training and Conducting Research in a Psychodynamic Fellowship Program and Teaching Hospital

M. Gerard Fromm, PhD, ABPP

The Evolution of Psychoanalytic Training, Teaching and Research in a Long Term Residential Setting

Claire Nouvet, PhD

Psychoanalysis in Academia: A Psychoanalytic Education Must be a Two-Way Street

Joyce M. Cartor, PhD, *chair*

10–11:50 am

Tuxedo

Panel

SA-3 From Selma to Ferguson, Psychoanalytic Insights Into Contemporary Racial/Ethnic Conflict

The panel discusses constructions of race and White privilege, psychological mechanisms of "othering" in racism, and collective trauma and memory as linkages between a traumatic past and the violence of a haunted present. The presenters and audience will have time to process current events and brainstorm possible community interventions.

JoAnn Ponder, PhD

Racial Conflict and White Privilege in American Society and Clinical Practice

Ricardo Ainslie, PhD, ABPP

Contemporary Racial Violence and the Trauma of Memory

Carlotta G. Miles, MD, *discussant*

10–11:50 am

West Paces

Panel

SA-4 Fear and Loathing: Exploring Masculine Sexual Assertion and Guilt Through the Lens of Paul Thomas Anderson's Film *Magnolia*

Using Paul Thomas Anderson's 1999 film *Magnolia* as a starting point—with its unsettling depiction of a self-help guru who preys on masculine social/sexual inadequacy—this panel will explore the polarities of masculine heterosexual assertion and guilt, and how to reconcile this Janus-face for our patients and ourselves.

Laura Barbanell, EdD, ABPP

Stephen Hartman, PhD

Peter Kaufmann, PhD

Joanne Messina, LMSW

Stephanie Manes, LCSW, JD, *moderator*

10–11:50 am

East Paces

Panel

SA-5 Standing at the Crossroads: The Science of Hermeneutics and the Hermeneutics of Science

Many writers accept as undisputed that psychoanalysis is an hermeneutic discipline. But that resolution still leaves open the question of Freud's main concern—its scientific status. It also leaves open as many questions as it resolves. Join us for this roundtable exploration of how best to define psychoanalysis' yet indeterminate status.

John Auerbach, PhD

Science and Hermeneutics in Psychoanalysis: Can a Hybrid Discipline Be Kosher? Should It Be?

Elliot Jurist, PhD, PhD

Neither Either Nor Between: A Defense of Strong Pluralism

Jill Gentile, PhD

Psychoanalysis: The Natural Science of a Symbolic Species

Frank Summers, PhD, ABPP

Psychoanalysis as the Study of the Subjective in a World of Objects

Jane Tillman, MDiv, PhD, ABPP

Psychoanalysis as the Via Media of Contemporary Epistemologies

Jill Gentile, PhD, *co-chair*

John Auerbach, PhD, *co-chair*

SATURDAY APRIL 9

SATURDAY APRIL 9

10–11:50 am

Chastain

Panel

SA-6 So Sexy It Hurts: Contemporary Psychoanalytic Musings on the Erotic

Contemporary psychoanalytic theory demands that the shared intimacies of a clinical engagement be used as fuel for positive change. Focusing on the erotic, each paper will attempt to map the new contemporary erotic terrain, outlining the dangers and the necessity of the erotic inherent in a clinical encounter.

Gregory Stevens, PhD

Bumping Unconscious Uglies: An Intersubjective Ethic for Erotic Countertransference

Kimberly Prince Korobov, LPC

Finishing What We Started: Disclosure of Erotic Countertransference

Megan Kolano, PsyD

The Well-Rehearsed Waltz, the Dangerous Tango, and the Void at the Center of the Dance Floor

Dan Rose, PsyD

Kink Shaming Versus Polymorphous Complexity: Growing a Post-Oedipal Mind to Embrace Sexual Fluidity

Megan Kolano, PsyD, *moderator*

Avgi Saketopoulou, PsyD, *discussant*

10–11:50 am

Habersham

Early Career Professionals Committee Panel

SA-7 Fear and Loathing (and Reconciliation): Early Career Experiences of Disillusionment

How do early career psychologists manage disillusionment when our leaders fail us? We aspire towards greater ideals, but autonomy ushers in fear and doubt regarding our limitations, tempting us to resume dependence on authority figures. Educational settings, clinical dilemmas, and the transfer of authority from one generation are all impacted.

Dana Charatan, PsyD

Stepping Up, Stepping Off: Finding Our Place on the Conveyor Belt

Kristin Davisson, PsyD

Fall From Grace: How Disappointment in Our Professional World Informs Our Clinical Practice

Almas Merchant, PhD

From Student to Educator: Individuation and Integration in the Classroom

Paul M. Martin, PsyD, *chair*

10 am–5 pm

Peachtree

American Board and Academy of Psychoanalysis (ABAPsa)

12–12:50 pm

Ballroom E

Publications Committee Meeting

12–12:50 pm

Ballroom D

Ethics Committee Board Meeting

12–12:50 pm

Ballroom C

Section VIII Board Meeting

12–12:50 pm

Morningside Boardroom

Early Career Professionals Committee Board Meeting

12–12:50 pm

Book Exhibitor Area

Meet The Author

Humanizing Evil: Psychoanalytic, Philosophical and Clinical Perspectives

The book explores the controversies surrounding definitions of evil, and examines its various forms, from the destructive forces contained within the normal mind to the most horrific expressions observed in contemporary life. At bottom, it argues that evil is intrinsically linked to human freedom.

Ronald C. Naso, PhD, ABPP

12–12:50 pm

Book Exhibitor Area

Meet The Author

Supervision Essentials for Psychodynamic Psychotherapies

The author distills 23 years of thinking about the relational model of psychodynamic supervision and provides new content on ethical issues and working with difference. Sarnat offers a framework within which a supervisor may safely utilize her clinical skills to advance the supervisory task.

Joan Sarnat, PhD, ABPP

SATURDAY APRIL 9

SATURDAY APRIL 9

12–12:50 pm

Woodruff

Special Workshops for Graduate Students Workshop II

Nancy McWilliams, PhD, ABPP

12–1:50 pm

Buckhead I

Section IX Board Meeting

1–1:50 pm

Morningside Boardroom

Awards Committee Meeting

1–1:50 pm

Chastain

Colloquy

The Erotic Appeal of Surrender

In our contemporary culture of greater sexual equality many are surprised to find that dominance and surrender still hold such erotic power. Sexual arousal may harken back to the phenomenology of early attachment dynamics (Bowlby and Dorothy Dinnerstein); and surrender to a true self (Winnicott, Ghent). Clinical material provides illustration.

Deborah Berry, PhD

The Erotic Appeal of Surrender

Susan Krausz, CSW, BCD

Sexual Surrender: Moving Beyond the Obstacles of Trauma, A Case Presentation

1–2:50 pm

East Paces

Steering Committee Invited Panel

SA–8 Crashing the Network: Psychoanalysis and Cyberspaces

This intermediate panel presentation will explore the co-evolution of technology, psychoanalytic theory and clinical practice. When psychoanalytic psychotherapy moves online, aspects of the object's internalization take a different course than they might in in-person therapy, because of the representational qualities of time and body online. This panel will discuss perspectives on the felt sense of the cyberobject's embodiment, and compare that to the presumed sense of the object's embodiment in in-person psychotherapy.

Todd Essig, PhD

Stephen Hartman, PhD

Gillian Isaacs Russell, PhD

Ave Schwartz, LCSW

Stefanie L. Speanburg, PhD, LCSW, *chair*

1–2:50 pm

West Paces

Panel

SA–9 When the Analyst is Ill or in Crisis: Transforming Engagements

What happens when the clinician, in the words of this conference's theme, runs the risk of "falling apart"? Three analysts who had cancer will explore how their conscious choices and unconscious communications transformed the treatment, each member of the dyad, and their own capacity to cope.

Adam S. Kaplan, PhD

Man on Wire: Walking the Therapeutically Transformative Tightrope of the Analyst's Cancer

Sandra Buechler, PhD

When the Analyst Suffers Illness and Loss

Joseph Newirth, PhD

Overcoming the Shame of Cancer

1–2:50 pm

Tuxedo

Panel

SA–10 Working Through the Researcher/Clinician Divide

The divide between research and practice has intensified: researchers feel that clinicians are indifferent to their work; clinicians feel that researchers oversimplify clinical phenomena. This panel seeks to overcome the divide by exploring the clinical significance of research in three major areas: narcissism, unconscious processes and emotion regulation.

Elliot Jurist, PhD, PhD

Three Views on Emotion Regulation

Diana Diamond, PhD

Transference Focused Psychotherapy for Narcissistic Disorders: Recent Developments in Theory, Research and Treatment

Joel Weinberger, PhD

The Relevance of Recent Work on Unconscious Processes to Psychoanalysis

SATURDAY APRIL 9

SATURDAY APRIL 9

1–2:50 pm

Habersham

Committee on Education and Clinical Training Roundtable

SA-11 Fitting the Well-Rounded Program into the Square World of Accreditation

This roundtable discussion reviews the dominance of behavioural/medical approaches as a “monoculture.” Participants will be invited to discuss their perceptions within psychology as a discipline at varied levels of training (from high school through graduate training) and envision ways to challenge it on divisional and individual levels.

David L. Downing, PsyD, ABPP

Reversing Normotic Trends in Professional Education and Training

Barry Dauphin, PhD

Contemporary Challenges in Educating Students About Psychoanalytic Ethics and Possible Solutions

Thomas Barrett, PhD

The Evidence Base for Teaching Psychoanalytic Theory and Technique in Graduate Schools

Oksana Yakushko, PhD

Bothered by the Monoculture in Psychology: Re-Envisioning the Psychoanalytic Training

Jed Yalof, PsyD, ABPP

Teacher as Analyst, Analyst as Teacher: Encouraging Analytic Interest in Students

David L. Downing, PsyD, ABPP, *moderator*

1–2:50 pm

Buckhead II

Panel

SA-12 Fanning the Flames

This panel will address struggles with disenfranchised feelings, those we worry might ruin a treatment. We will consider how these affects are actually vital for therapeutic change. Drawing on Winnicott, Klein, and Attachment theorists, we will discuss weathering clinical storms, that allow us to “come together without falling apart.”

Francesca Schwartz, PhD

A Case for (of) Hate

Seth Aronson, PsyD

Love and All Its Complications

Tammy Kaminer, PhD, *discussant*

Susan Goodman, LCSW, *moderator*

2–2:50 pm

Chastain

Colloquy

Ethical Dilemmas: Ongoing Treatment and the Potentially Violent Patient

This colloquy invites participants to consider the ethical dilemmas offered in two ongoing cases. When a seriously disturbed patient presents the possibility of harming others, can the therapeutic relationship provide sufficient counterweight against serious destructive acting out or must the analyst go outside the analytic frame and seek external intervention?

Linda B. Sherby, PhD

The Ethical Dilemma: Which “Self” is the Analyst Trusting in a Dissociative Identity Disorder Patient

Donna Bentolila, PhD, LCSW

For Whom the Bells Toll: Working With Potentially Homicidal Patients

Marilyn Charles, PhD, ABPP, *moderator*

3–3:50 pm

Book Exhibitor Area

Meet The Author

The Motive for Metaphor: Brief Essays on Poetry and Psychoanalysis

This book is a collection of the columns on poetry and psychoanalysis I wrote originally for the Psychologist-Psychoanalyst and for Division/Review. I see poetry and psychoanalysis as complementary arts. The creative process in either sheds light on the creative process in the other.

Henry M. Seiden, PhD, ABPP

3–3:50 pm

Book Exhibitor Area

Meet The Author

The Business of Being Made: The Temporalities of Reproductive Technologies in Psychoanalysis and Culture

This book is the first to critically analyze reproductive technologies from a transdisciplinary perspective, integrating psychoanalytic and cultural theories. As an edited collection, it spans diverse methods to explore the troubling temporalities and generative potentialities of reproductive technologies.

Katie Gentile, PhD

SATURDAY APRIL 9

SATURDAY APRIL 9

3–3:50 pm

Chastain

A Conversation with Bert Karon: Changes in Psychoanalytic Theory and Technique

Dr. Karon will reflect on his over 50 years as a psychologist and psychoanalyst, discussing the changes and continuities in psychoanalytic theory, practice and technique throughout his distinguished career.

Bertram P. Karon, PhD, ABPP

3–3:50 pm

Buckhead I

Special Workshops for Graduate Students Workshop III

Gideon Yago, writer and reporter

3–4:50 pm

Woodruff

Committee on Multicultural Concerns Board Meeting

4–5:50 pm

Tuxedo

Panel

SA–13 Is Psychoanalysis Still Hot and Bothered? Returning Sexuality to the Psychoanalytic Conversation

The focus of this panel will be on sexuality in the powerful, brain changing interactions in the treatment process. The panel will integrate clinical presentations with recent efforts in psychoanalytic thinking to reintegrate the body, and bodily experiencing, in our understanding of the construction of the mind.

Annee Ackerman, MA

First Encounters With Erotic Desire In Treatment

Jonathan Slavin, PhD

Miki Rahmani, MA

Slow Dancing: Mind, Body, and Sexuality in a New Relational Psychoanalysis

Steven Kuchuck, LCSW, *moderator*

4–5:50 pm

Buckhead II

Panel

SA–14 Black/White Racial Binary and the Fate of Other Racial Narratives in Clinical Encounters

This panel presents a variety of clinical phenomenon concerning clinicians and patients whose racial identities fall outside of the currently dominant Black/White binary racial paradigm. The subtle pressure for bifurcation towards either black or white pole and subsequent dissociation and enactments of marginalized racial narratives will be described.

Navya Singh, PsyD

“Whose Clinic Room is This Anyway”? Negotiating the Ideas of Belonging and Alienation Within a Multiracial Treatment Space

Mili Thomas, MA

In Between Black, Brown, and White: The Impact of Cultural Assumptions in Treatments

Teresa Mendez, MSW

“My Sister Tried To Kill Me:” Enactment and Foreclosure in a Mixed Race Dyad

Kris Yi, PhD, PsyD, *discussant and chair*

Ricardo Ainslie, PhD, ABPP, *discussant*

4–5:50 pm

Buckhead I

Graduate Student Committee Panel

SA–15 The Dynamics of the Supervisory Relationship: A Live Demonstration

This panel consists of an “in vivo,” or live supervision, in which a graduate student intern will present a case with process material from a session to a senior supervisor. The supervision will be the usual 45-50 minute time of a supervisory session. This will be followed by discussion/observations from a senior clinician and a graduate student followed by discussion with the panelists and the audience. The discussion will explore the dynamics of the supervisory process and interaction with a focus on the supervisee’s learning and development.

Kritika Dwivedi, MA

Darlene Ehrenberg, PhD, ABPP

Geetali Chitre, MA

Nathan Haskell, MA

Frank E. Lawatsch, MSW, PsyD, *moderator*

SATURDAY APRIL 9

SATURDAY APRIL 9

4–5:50 pm

East Paces

Panel

SA–16 Transgressing at the Borders: Immigrant Experiences In and Outside of Psychoanalytic Encounter

Psychoanalytic, Jungian and post-colonial frameworks are used to examine complexities involving immigrants on one or both sides of the treatment. Divergent forms of immigrant experience are viewed within experiences of students and established professionals who integrate their own and their client's immigrant backgrounds within psychoanalytically focused clinical work and training.

Yasaman Mostajeran, MA

The Experience of Immigrant Iranian Therapist Working With Immigrant and Refugee Iranian Patients

Anna Lomovskaya, MA

Colonized Minds, Bothered Bodies: Culture and the Unconscious Immigrant Identities

Nadia Thalji, MA

Migration, Identity, and Change: Psychoanalytic Frameworks for Understanding an Immigrant Experience

Evelina Blodgett, MS

Language as a Symbol and a Symptom: Languaging the Other

Oksana Yakushko, PhD

Signifiers of Torture and Oppression: Cultural and Professional Reflections on Personal Meanings of Hoffman Report

Neil Altman, PhD, *discussant*

4–5:50 pm

Chastain

Committee on International Relations in Psychoanalytic Psychology Panel

SA–17 Psychoanalysis During Argentina's Dirty War: Torture, Collusion, Resistance and Their Resonance for Today

This symposium sponsored by the International Relations Committee promotes international understanding and addresses ethical challenges facing our profession today by exploring the resonance between psychoanalysis during the Argentine Dirty War and the recent struggles against the complicity of the APA with military policies which violate international law and human rights.

Nancy Hollander, PhD

Frank Summers, PhD, ABPP, *discussant*

Neal S. Rubin, PhD, ABPP, *chair*

4–4:50 pm

Habersham

Colloquy

Premature Birth: The Baby, the Doctor and the Psychoanalyst

Catherine Vanier brings Lacanian psychoanalysis to a French neonatal unit. Prematurely born infants, caught in medical technology and family guilt, require a differently aimed inscription in the Other. Engaging medical staff, parents, and babies, Vanier presents multi-leveled interventions in the baby's situation, at the foundations of the being of desire.

Catherine Vanier, PhD

Kareen R. Malone, PhD, *moderator*

4–5:50 pm

West Paces

Ethics Committee Panel/Case Study

SA–18 What Should We Do? Responding to Sexual Boundary Violations in Real Time

This intermediate panel will consist of brief presentations by two senior analysts (one an institute administrator, the other a supervisor and clinician) and a candidate each of whom explores the problem of sexual boundary violations in our community. Small group discussions.

Sue Grand, PhD

Lewis Aron, PhD, ABPP

Carina Grossmark, PhD

Joyce Slochower, PhD, ABPP, *discussant*

Scott Pytluk, PhD, *chair*

6–7:30 pm

Woodruff

Presidential Conversation Hour and Reception: An Open Conversation on Psychoanalytic Training

Sponsored by Section I and the Candidates Committees of Division 39. The event is open to anyone interested in psychoanalytic institutes and psychoanalytic training.

6–8 pm

Ballroom Pre-Function

Joint Reception

Co-sponsored by Section II, III, V, IX and Committees on Multicultural Concerns, Sexualities and Gender Identities, Psychoanalysis and the Community, and Early Career Professionals

HOT & BOTHERED

SATURDAY APRIL 9

7–10 pm

Movie Night

SA–19 Two Films and Two Discussions

The Mark of War, a documentary film, by Ricardo Ainslie, PhD, ABPP

Discussants: David Rosenblatt, PhD, Neil Altman, PhD

This film is about the lives of seven Vietnam War veterans. It is an intimate, psychological portrait of their lives before going to war, their experiences in Vietnam, and their lives since their return. The filmmaker is a psychologist/psychoanalyst and the interviews reflect that sensibility as does the structure of the film itself. The film is driven by the veterans' stories, describing their struggles to digest what they had seen, what they had lived, and what they had done in Vietnam. Using an open and reflective interview style, the film is more psychological and personal rather than historical in its treatment of the experiences of these men, some of whom he had interviewed on and off for over 10 years. The film draws us into their worlds.

Ethics and Trauma in Hannah Arendt by Margarethe Von Trotta

Discussants: Diana Diamond, PhD, Elliot Jurist, PhD, PhD, Françoise Davoine, PhD

The presentation begins with the viewing of the film, *Hannah Arendt*, by Margarethe Von Trotta, which focuses on the fierce debate that Hannah Arendt ignited over half a century ago (and that continues to this day) when she covered the trial of Adolf Eichmann. Hannah Arendt reminds us that films have become an optimal repository for images of some of the most compelling and cataclysmic events of our time—images that portray the complex and conflictual dynamics of individual lives unfolding against the often traumalogenic social and historic forces of the 20th century. The panel will lead a discussion of the film's portrayal of Hannah Arendt's interpretation of Eichmann's "inability to think," which culminates in the controversial notion of the "banality of evil." We will explore whether or not and how this can be addressed under the APA Code of Ethics, and to what extent Arendt's thinking might be relevant to the ethical failures and challenges brought up by the recent events in APA.

East Paces



8–9:50 am

Ballroom C,D,E

Keynote Address and Coffee

Nancy McWilliams, PhD, ABPP

SU–1 Psychoanalytic Reflections on Limitation: Aging, Dying, Generativity, and Renewal

Limits—and the limit of mortality in particular—makes us hot and bothered. Despite the fact that American culture is fueled by fantasies of inexhaustible resources and limitless possibility, psychoanalysis has engaged with the issue of natural limitation ever since Freud emphasized the inevitable tension between bottomless human desire and the demands of civilized life. Dr. McWilliams will explore a dilemma central to the human condition: although limitation evokes primal frustration, it also creates the conditions of Balint's "area of creativity."

William A. MacGillivray, PhD, ABPP, *chair*



NANCY MCWILLIAMS teaches at Rutgers University's Graduate School of Applied & Professional Psychology and has a private practice in Flemington, NJ. She is the author of *Psychoanalytic Diagnosis* (1994; rev. ed. 2011), *Psychoanalytic Case Formulation* (1999), and *Psychoanalytic Psychotherapy* (2004), all with Guilford Press. She is Associate Editor of the *Psychodynamic Diagnostic Manual* (2006; rev. ed. due 2016). She is a former president of the Division of Psychoanalysis (39) and is on the editorial board of *Psychoanalytic Psychology*. Her awards have included the Gradiva prize (1999), the Goethe Scholarship Award (2012), the Rosalee Weiss Award for contributions to practice (2004), the Laughlin distinguished teacher award (2007), the Hans Strupp Award for teaching, practice and writing (2014), and the Division 39 awards for both Leadership (2005) and Scholarship (2012). Dr. McWilliams is an honorary member of the American Psychoanalytic Association, the Moscow Psychoanalytic Society, and the Warsaw Scientific Association for Psychodynamic Psychotherapy. Her writings have been translated into 20 languages.

SUNDAY APRIL 10

SUNDAY APRIL 10

10–10:50 am

West Paces

Colloquy

Psychoanalysis and Executive Coaching: A Collaborative Exploration

Emory University's Psychoanalytic Institute and Goizueta Business School are engaged in a collaborative exploration of the expanding field of executive coaching, with the aim of applying psychodynamic techniques to its practice. The purpose of this colloquy is to invite the broader psychoanalytic community to join in this unique, interdisciplinary dialogue.

Derek J. O'Brien, MD

Shweta Sehgal, PhD

Stefanie L. Speanburg, PhD, LCSW, *moderator*

10 am–11:50 pm

Peachtree

American Board and Academy of Psychoanalysis (ABAPsa)

10–11:50 am

Tuxedo

Panel

SU-2 Psychoanalysis and Activism: In and Out of the Consulting Room

Psychoanalysts increasingly contribute to projects involving research and collaborative projects that emphasize community needs and activism. Brief exploration of several projects and their challenges will be followed by group discussion facilitated by the presenters, all of whom are active as clinicians, teachers, and community activists.

Jane A. Hassinger, MSW

Members of the Community: Psychoanalysis and Activism

Katie Gentile, PhD

Chasing Justice-To-Come: Community Approaches to Sexual Misconduct in Colleges and Psychoanalytic Institutes

Janice Haaken, PhD

Signifying Suffering: Caveats in the Deployment of Posttraumatic Stress Disorder in Conflict Zones

Billie Pivnick, PhD

Crossings, Dwellings, and Indwelling: Formulating Psychoanalytic Responses to Environmental and Cultural Destruction

Jane A. Hassinger, MSW, *moderator*

10–11:50 am

Chastain

Panel

Research Award Symposium

Award Recipient: **Miriam Steele, PhD**

SU-3 Attachment Theory, Reflective Functioning and Therapeutic Action

This presentation will outline the concept of reflective functioning, covering its origins, attachment theory and intergenerational longitudinal research. The clinical relevance of the concept, as a therapeutic goal, will be highlighted especially with respect to patients with traumatic backgrounds. This will be followed by comments and moderated audience discussion.

Andrew Gerber, MD, PhD, *discussant*

Kenneth N. Levy, PhD, *discussant*

Diana Diamond, PhD, *discussant*



MIRIAM STEELE is a Professor and Director of Clinical Training in Psychology at the New School for Social Research. She bridges the world of psychoanalytic thinking and clinical practice with contemporary research in child development. She trained as a child analyst at the Anna Freud Centre London and received her Ph.D. from University College London. Her research began with the study of "Intergenerational Patterns of Attachment" which embodied one of the first prospective longitudinal studies incorporating the Adult Attachment Interview and Strange Situation protocols. This work was important in initiating the concept of reflective functioning and providing empirical data to demonstrate the importance of parental states of mind in the social and emotional development of their children with a longitudinal focus on their development into adulthood. Currently, Dr. Steele is a co-investigator on a federally funded grant "Birth to Three: A Pragmatic Clinical Trial for Child Maltreatment Prevention." Her other projects include studies exploring attachment and body representations in mother-child dyads, and studies of child development in families utilizing assisted reproductive technologies.

10–11:50 am

Buckhead II

Section IV and Section II Joint Panel

SU-4 The Use and Overuse of Medications in Treatment of Children and Teens: Alternatives to Psychopharmacology

This presentation will review the overuse of psychopharmaceuticals with children. Research regarding the relative lack of efficacy of such medications will be reviewed as well as young adults who reflected upon being medicated for ADHD. A brief case presentation of child analytic treatment for ADHD will be followed by discussion.

Thomas Barrett, PhD

Robert Foltz, PsyD

Jenica Ottero, MA

HOT & BOTHERED

SUNDAY APRIL 10

10–11:50 am

East Paces

Panel

SU-5 Parenting Across the Lifespan

While we must become essential to our children as early as possible to help them create an internalized experience of being valued, we must simultaneously give up this exclusive essentialness if we want them to develop a sense of autonomy. Can we do this gracefully and how?

Diana Punales, PhD

On Being Essential: Parenting, Immigration and Acculturation

Benjamin Harris, PhD

Gardening in the Softball League: How Teachers Parent

Steve Tuber, PhD, ABPP, *moderator*

10–11:50 am

Habersham

Roundtable

Hot and Bothered Under Queer Collars: Inviting Inquiry and Exploration of (in)Visible Identities

The panel will serve as a dynamic space in which attendees can engage, connect, and reflect. Four queer presenters will share identity/embodiment experiences and invite attendees to explore their own experiences specific to holding privileged, invisible, and marginalized selves. Topics will include gender/sexual/cultural identities, size, embodiment, and projected fantasy.

Kori Bennett, PsyD

Elizabeth Clark, PsyD

Rhonda Factor, PhD

Brooke Kramer, MS

11–11:50 am

West Paces

Colloquy

The Strange Situation Experiment and the Aesthetics of Attachment

In this colloquy we watch footage of the Strange Situation Experiment and approach the experiment as art object. We consider the unusual narrative structure of the experiment and address the relationship between content, form and affect in the videos themselves, reflecting on our own aesthetic experience as viewers.

Eric J. Taggart, MA, LMFT

12–1 pm

Peachtree

Rap Up

Participants are invited to share their thoughts about the Atlanta Spring Meeting and Division goals/initiatives with the Conference Co-Chairs and the Division President and President-Elect. Let's Rap.

PRESENTERS

Annee Ackerman, MA Long Island University, Brooklyn, NY	68
Steve Ackerman, PhD Austen Riggs Center, Stockbridge, MA	33
Hector Adames, PsyD Chicago School of Professional Psychology, Chicago, IL	53
Daphny Dominguez Ainslie, PsyD Private Practice, Austin, TX	44
Ricardo C. Ainslie, PhD, ABPP University of Texas, Austin, TX	18, 44, 54, 60, 69, 72
Judith L. Alpert, PhD NYU Postdoctoral Program in Psychotherapy and Psychoanalysis, New York, NY	34, 43, 56
Neil Altman, PhD William Alanson White Institute, New York, NY	18, 54, 70, 72
Lewis Aron, PhD, ABPP NYU Postdoctoral Program in Psychotherapy and Psychoanalysis, New York, NY	71
Seth Aronson, PsyD William Alanson White Institute, New York, NY	41, 66
John Auerbach, PhD North Florida/South Georgia Veterans Health System, Gainesville, FL	61
Shauna Balch, PsyD New Alternatives for Children, New York, NY	51
Laura Barbanel, EdD, ABPP Private Practice, Brooklyn, NY	61
Rachel Barbanel-Fried, PsyD Private Practice, Newton Center, MA	53
Jack M. Barlow, PhD University of Tennessee, Knoxville, TN	17, 60

Thomas Barrett, PhD The Chicago School of Professional Psychology, Chicago, IL	66, 75	Dana Charatan, PsyD National Institute for the Psychotherapies, Boulder, CO	62
Jill Bellinson, PhD Private Practice, New York, NY	51	Marilyn Charles, PhD, ABPP Austen Riggs Center, Stockbridge, MA	13, 16, 19, 32, 45, 49, 67
Kori Bennett, PsyD Columbia University, New York, NY	76	Nancy D. Chase, PhD, LCSW Emory University Psychoanalytic Institute, Atlanta, GA	15, 38
Donna Bentolila, PhD, LCSW Southeast Florida Institute for Psychoanalysis and Psychotherapy, Boca Raton, FL	67	Jessica Chavez, PhD University of Pennsylvania Counseling and Psychological Services, Philadelphia, PA	55
Deborah Berry, PhD Private Practice, New York, NY	64	Geetali Chitre, MA Access Institute for Psychological Services, San Francisco, CA	69
Sally Bjorklund, MA, PsyA Relational Psychoanalysis and Psychotherapy, Seattle, WA	51	Heather Churchill, PsyD Austen Riggs Center, Stockbridge, MA	38
Evelina Blodgett, MS Pacifica Graduate Institute, Santa Barbara, CA	70	Elizabeth Clark, PsyD Fordham University, Bronx, NY	76
Philip Blumberg, PhD William Alanson White Institute, New York, NY	48	Phyllis Cohen, PhD Private Practice, New York, NY	51
Ghislaine Boulanger, PhD NYU Postdoctoral Program in Psychotherapy and Psychoanalysis, New York, NY	34	Phyllis Cohen, PsyD Private Practice, Wellesley, MA	43
Monique Bowen, PhD Private Practice, New York, NY	43	Leilani Crane, PsyD University of Pennsylvania, Philadelphia, PA	55
Brian Brown, PsyD Private Practice, Chicago, IL	13, 32	Morgun Custer, BA University of Tennessee, Knoxville, TN	57
Sandra Buechler, PhD William Alanson White Institute, New York, NY	41, 65	Mamta Dadlani, PhD Independent Practice and Consultation, Berkeley, CA	37
Nancy Burke, PhD Chicago Institute for Psychoanalysis, Chicago, IL	50	Meredith Darcy, LCSW-R William Allison White Institute, New York, NY	55
Roberta Caplan, PhD Brandeis University, Waltham, MA	53	Barry Dauphin, PhD University of Detroit Mercy, Detroit, MI	39, 66
Joyce M. Cartor, PhD Private Practice, Knoxville, TN	16, 17, 52, 60	Kristin Davisson, PsyD Private Practice, Chicago, IL	53, 62
Andrea Celenza, PhD Boston Psychoanalytic Society and Institute, Boston, MA	16, 40, 56	Françoise Davoine, PhD Ecole des Hauts Etudes en Sciences Sociales, Paris, France	14, 18, 20, 47, 55, 56, 72

Dennis Debiak, PsyD Institute for Relational Psychoanalysis of Philadelphia, Philadelphia, PA	19, 45	Alison Feit, PhD William Alanson White Institute, New York, NY	42
Diana Diamond, PhD City University of New York, New York, NY	18, 39, 50, 65, 72, 75	Heather Ferguson, LCSW Institute for the Psychoanalytic Study of Subjectivity, New York, NY	37
Lisa Diamond, PhD University of Utah, Salt Lake City, UT	53	Eric Fertuck, PhD Graduate Center of the City University of New York (CUNY), New York, NY	50
Frances V. Dillon, MSW, CSW Training and Research Institute for Self Psychology, New York, NY	42	Luca Flabbi, PhD University of Carolina, Chapel Hill, NC	44
Muriel Dimen, PhD NYU Postdoctoral Program in Psychotherapy and Psychoanalysis, New York, NY	56	Robert Foltz, PsyD The Chicago School of Professional Psychology, Chicago, IL	75
Michael R. Donnell, PsyD Private Practice, Austin, TX	13, 32	Chris Fowler, PhD The Menninger Clinic, Houston, TX	33
David L. Downing, PsyD, ABPP University of Indianapolis, Indianapolis, IN	66	Sean M. Fowler, MS Georgia Southern University, Chapel Hill, NC	57
Rebecca Drill, PhD Harvard Medical School, Cambridge, MA	17, 60	William Fried, PhD Private Practice, New York, NY	49
Eugenio A. Duarte, PhD William Alanson White Institute, New York, NY	35	M. Gerard Fromm, PhD, ABPP Austen Riggs Center, Stockbridge, MA	17, 60
Kritika Dwivedi, MA University of Denver, Seattle, WA	57, 69	Helen Fronshtein, PsyD William Alanson White Institute, New York, NY	35
Darlene Ehrenberg, PhD, ABPP Private Practice, New York, NY	69	Sophia Frydman, MA, MFA Derner Institute, Adelphi University, Brooklyn, NY	36
Laura Esikoff, MA Chicago Institute for Psychoanalysis, Chicago, IL	50	Glauco Maria Genga, MD Societa Amici Del Pensiero-Sigmund Freud (Sap), Milan, Italy	44
Todd Essig, PhD William Alanson White Institute, New York, NY	17, 64	Jill Gentile, PhD NYU Postdoctoral Program in Psychotherapy and Psychoanalysis, New York, NY	48, 54, 61
Carrie K. Evenden, PsyD Private Practice, San Francisco, CA	43	Katie Gentile, PhD John Jay College of Criminal Justice, New York, NY	67, 74
Rhonda Factor, PhD NYU Postdoctoral Program in Psychotherapy and Psychoanalysis, New York, NY	76	Andrew Gerber, MD, PhD Austen Riggs Center, Stockbridge, MA	75
		Mary-Joan Gerson, PhD NYU Postdoctoral Program in Psychotherapy and Psychoanalysis, New York, NY	19, 34, 45

Lauren Glick, PsyD William Alanson White Institute, New York, NY	40	Benjamin Harris, PhD City College of New York, New York, NY	76
Ashley Golub, PsyD New Alternatives for Children, New York, NY	51	Stephen Hartman, PhD Psychoanalytic Institute of Northern California, San Francisco, CA	17, 61, 64
Susan Goodman, LCSW Private Practice, New York, NY	66	Nathan Haskell, MA George Fox University, Portland, OR	69
Robert M. Gordon, PhD, ABPP The Institute for Advanced Psychological Training, Allentown, PA	12, 31, 36	Jane A. Hassinger, MSW University of Michigan, Ann Arbor, MI	74
Carnella Gordon-Brown, MSW Private Practice, San Francisco, CA	44	Kendle Hassinger, LPC Private Practice, Atlanta, GA	12, 31
Elizabeth Goren, PhD NYU Postdoctoral Program in Psychotherapy and Psychoanalysis, New York, NY	56	Tanya Hess, PhD Private Practice, Philadelphia, PA	13, 32
Sue Grand, PhD NYU Postdoctoral Program in Psychotherapy and Psychoanalysis, New York, NY	71	Catherine H. Hicks, PhD Australian Psychological Society, Sydney, Australia	44
Hillary Grill, LCSW National Institute for the Psychotherapies, New York, NY	51	Marie Hoffman, PhD Brookhaven Institute for Psychoanalysis and Christian Theology, Fogelsville, PA	36
Michael Groat, PhD, MS The Menninger Clinic, Houston, TX	33	Nancy Hollander, PhD California State University, Oakland, CA	70
Carina Grossmark, PhD Independent Practice, New York, NY	71	Robert E. Hooberman, PhD Michigan Council for Psychoanalysis and Psychotherapy, Ann Arbor, MI	41
Robert Grossmark, PhD NYU Postdoctoral Program in Psychotherapy and Psychoanalysis, New York, NY	48, 54	Eric Hovis, MA New Alternatives for Children, New York, NY	51
Orna Guralnik, PsyD Independent Practice, New York, NY	55	Alison McGrath Howard, PsyD Private Practice, Washington, DC	38
Janice Haaken, PhD Portland State University, Portland, OR	74	Linda Jacobs, PhD Long Island University, New York, NY	41
George Hagman, MSW, LCSW Training and Research Institute for Self-Psychology, Stamford, CT	16, 49	Yudit Jung, PhD, LCSW Emory University Psychoanalytic Institute, Atlanta, GA	10, 31
Douglas R. Hansen, MSW Relational Psychoanalysis and Psychotherapy Seattle, Seattle, WA	36	Elliot Jurist, PhD, PhD The City University of New York, New York, NY	18, 48, 61, 65, 72
		Tammy Kaminer, PhD William Alanson White Institute, New York, NY	66

Adam S. Kaplan, PhD Institute for the Psychoanalytic Study of Subjectivity, New York, NY	65	Steven Kuchuck, LCSW National Institute for the Psychotherapies, New York, NY	51, 68
Bertram P. Karon, PhD, ABPP Michigan Psychoanalytic Council, East Lansing, MI	68	Frank E. Lawatsch, MSW, PsyD Neurobehavioral Institute of Austin, Austin, TX	69
Nadine Kaslow, PhD, ABPP Emory University School of Medicine, Atlanta, GA	15, 38	Lynne Layton, PhD Harvard Medical School, Boston, MA	50, 55
Cassie Kaufmann, PhD NY Presbyterian—Columbia University Medical Center, New York, NY	36	Allison Lee, MD William Alanson White Institute, New York, NY	42
Peter Kaufmann, PhD Institute for the Psychoanalytic Study of Subjectivity, New York, NY	61	Mineko Anne Legendy, BA William Alanson White Institute, New York, NY	40
Susan Kavalier-Adler, PhD, ABPP Object Relations Institute for Psychotherapy and Psychoanalysis, New York, NY	39, 52	Paul Letendre, MA Johnson and Wales University, Providence, RI	41
Elizabeth Kita, PhD, LCSW Private/Public Practice, San Francisco, CA	42	Kenneth N. Levy, PhD University of Pennsylvania, University Park, PA	50, 75
Susan Klebanoff, PhD Stephen Mitchell Center, New York, NY	37	David Lichtenstein, PhD City University of New York, New York, NY	39, 48, 57
Michael C. Klein, PhD Barnard College, New York, NY	13, 32, 34	Vittorio Lingiardi, MD University of Rome, Rome, Italy	16, 40
Steven H. Knoblauch, PhD NYU Postdoctoral Program in Psychotherapy and Psychoanalysis, New York, NY	57	Anna Lomovskaya, MA Pacifica Graduate Institute, Santa Barbara, CA	70
Megan Kolano, PsyD Austen Riggs Center, Stockbridge, MA	62	Joyce Lowenstein, PhD Private Practice, Washington, DC	53
Kimberly Prince Korobov, LPC Private Practice, Carrollton, GA	62	William A. MacGillivray, PhD, ABPP Private Practice, Oak Ridge, TN	15, 34, 47, 56, 73
Brooke Kramer, MS Pacific University, Portland, OR	76	Kareen R. Malone, PhD Apres Coup Psychoanalytic Association, Atlanta, GA	35, 71
Susan Krausz, CSW, BCD New York University, New York, NY	64	Carolynn Maltas, PhD Private Practice, Cambridge, MA	53
Elizabeth Krimendahl, PsyD William Alanson White Institute, New York, NY	40	Stephanie Manes, LCSW, JD Institute for the Psychoanalytic Study of Subjectivity, New York, NY	61
		Geraldine Mapel, BA William Alanson White Institute, New York, NY	40

Jennifer Marion, MA Derner Institute, Adelphi University, San Francisco, CA	36	Joseph Newirth, PhD Derner Institute, Adelphi University, Garden City, NY	55, 65
Paul M. Martin, PsyD The Center for Grief Recovery, Chicago, IL	57, 62	Claire Nouvet, PhD Emory University, Atlanta, GA	17, 47, 60
Nancy McWilliams, PhD, ABPP Rutgers Graduate School of Applied and Professional Psychology, Piscataway, NJ	14, 18, 19, 20, 32, 64, 73	Nadine Obeid, PhD William Alanson White Institute, New York, NY	44
Catherine Meeks, PhD, MSW Atlanta, GA	18, 58	Derek J. O'Brien, MD Emory University Psychoanalytic Institute, Atlanta, GA	74
Teresa Mendez, MSW The Retreat at Sheppard Pratt, Baltimore, MD	69	Mark O'Connell, PhD Massachusetts Institute for Psychoanalysis, Chestnut Hill, MA	16, 52
Almas Merchant, PhD Brightpoint Health, Brooklyn, NY	62	Jenica Ottero, MA The Chicago School of Professional Psychology, Chicago, IL	75
Joanne Messina, LCSW Institute for the Psychoanalytic Study of Subjectivity, New York, NY	61	Brendan Ozawa-de Silva, PhD Life University, Marietta, GA	15, 38
Marilyn N. Metz, PhD, ABPP Greater Kansas City Psychoanalytic Institute, Kansas City, MO	43, 52	Chikako Ozawa-de Silva, PhD Emory University, Atlanta, GA	15, 38
Carlotta G. Miles, MD Private Practice, Washington, DC	60	Albert Pace, MA George Fox University, Newberg, OR	57
Dolores O. Morris, PhD, ABPP NYU Postdoctoral Program in Psychotherapy and Psychoanalysis, New York, NY	54	Eva D. Papiasvili, PhD, ABPP Columbia University, New York, NY	52
Yasaman Mostajeran, MA Pacifica Graduate Institute, Santa Barbara, CA	70	Ryan Parker, LCSW Community/Private Practice, Austin, TX	42
Maureen Murphy, PhD Psychoanalytic Institute of Northern California, San Francisco, CA	49	Bobbi Patterson, PhD Emory University, Atlanta, GA	15, 38
Ronald C. Naso, PhD, ABPP Independent Practice, Stamford, CT	63	Maria Gabriella Pediconi, MA University of Urbino, Urbino, Italy	44
Sanjay R. Nath, PhD Widener University, Chester, PA	53	Kristi Pikiewicz, PhD Private Practice, Boulder, CO	11, 31
Ellie Neuman-Fligelman, PhD William Alanson White Institute, New York, NY	40	Billie Pivnick, PhD William Alanson White Institute, New York, NY	74
		Barbara Pizer, EdD, ABPP Massachusetts Institute for Psychoanalysis, Boston, MA	43

JoAnn Ponder, PhD Center for Psychoanalytic Studies, Austin, TX	60	David Rosenblatt, PhD University of Texas, Austin, TX	18, 72
Carol M. Press, EdD University of California, Santa Barbara, CA	16, 49	Judith Roth, PhD City University of New York, New York, NY	34
Diana Punaless, PhD City College of New York, New York, NY	76	Benjamin Rubin, PsyD Private Practice, New York, NY	13, 32
Scott Pytluk, PhD Illinois School of Professional Psychology, Chicago, IL	35, 55, 71	Neal S. Rubin, PhD, ABPP Illinois School of Professional Psychology, Chicago, IL	70
Helen Quinones, PhD William Alanson White Institute, New York, NY	42	Gillian Isaacs Russell, PhD, NCPsyA British Psychoanalytic Council, Boulder, CO	17, 64
Miki Rahmani, MA South Jerusalem Mental Health Center, Jerusalem, Israel	68	Avgi Saketopoulou, PhD Private Practice, New York, NY	62
David Ramirez, PhD, ABPP Swarthmore College, Swarthmore, PA	19, 45	Jill Salberg, PhD, ABPP NYU Postdoctoral Program in Psychotherapy and Psychoanalysis, New York, NY	37, 41
Romy Reading, PhD Mt. Sinai Hospital Center, New York, NY	57	Shara Sand, PsyD Laguardia Community College, New York, NY	53
Kristin Reale, LCSW-R Independent Practice, New York, NY	55	Emanuela Sarbu, MA Boston College, Chestnut Hill, MA	41
Steven Reisner, PhD Private Practice, New York, NY	15, 34	Joan Sarnat, PhD, ABPP Psychoanalytic Institute of Northern California, San Francisco, CA	63
Andrea Remez, PhD Private Practice, New York, NY	51	Erika Schmidt, MSW Chicago Institute for Psychoanalysis, Chicago, IL	50
Jeremy M. Ridenour, PsyD Austen Riggs Center, Stockbridge, MA	38	Allan Scholom, PhD Chicago Institute for Psychoanalysis, Chicago, IL	50
Andrea Rihm, MA, PhD(c) Pontificia Universidad Católica de Chile, Santiago, Chile	34	Ave Schwartz, LCSW Austen Riggs Center, Stockbridge, MA	17, 64
James Rilling, PhD Emory University, Atlanta, GA	16, 52	Francesca Schwartz, PhD Speyer Legacy School, New York, NY	66
Dan Rose, PsyD Columbus State University, Columbus, GA	62	Karen M. Schwartz, PhD Emory University Psychoanalytic Institute, Atlanta, GA	16, 49
Larry Rosenberg, PhD Child Guidance Center of Southern CT, Stamford, CT	39	Shweta Sehgal, PhD Emory Goizueta Business School, Atlanta, GA	74

Henry M. Seiden, PhD, ABPP Private Practice, Forest Hills, NY	49, 67	Arlene (Lu) Steinberg, PsyD NYU Postdoctoral Program in Psychotherapy and Psychoanalysis, New York, NY	56
Peter Shabad, PhD Northwestern University Medical School, Chicago, IL	35	Barry Stern, PhD Columbia University College of Physicians and Surgeons, New York, NY	50
Linda B. Sherby, PhD Southeast Florida Institute for Psychoanalysis and Psychotherapy, Boca Raton, FL	41, 67	Gregory Stevens, PhD Kennesaw State University, Kennesaw, GA	62
Eric Sherman, PsyD Private Practice, New York, NY	43	Melanie Suchet, PhD NYU Postdoctoral Program in Psychotherapy and Psychoanalysis, New York, NY	19, 37
Caryn Sherman-Meyer, LCSW National Institute for the Psychotherapies, New York, NY	37	Frank Summers, PhD, ABPP Northwestern University, Chicago, IL	19, 35, 45, 61, 70
Navya Singh, PsyD William Alanson White Institute, New York, NY	40, 69	Andrew B. Suth, PhD Palombo Center Institute for Clinical Social Work, Chicago, IL	35
Jonathan Slavin, PhD Harvard Medical School, Newton Highlands, MA	68	Eric J. Taggart, MA, LMFT UC Davis, Davis, CA	76
Joyce Slochower, PhD, ABPP NYU Postdoctoral Program in Psychotherapy and Psychoanalysis, New York, NY	71	Nadia Thalji, MA Pacifica Graduate Institute, Santa Barbara, CA	70
Alan Slomowitz, PhD William Alanson White Institute, New York, NY	42	Mili Thomas, MA Georgia State University, Atlanta, GA	69
Amy Smith, MA William Alanson White Institute, New York, NY	40	Nancy S. Thurston, PsyD George Fox University, Newberg, OR	36, 57
Stephen Soldz, PhD Boston Graduate School of Psychoanalysis, Boston, MA	15, 34	Jane Tillman, MDiv, PhD, ABPP Austen Riggs Center, Stockton, MA	56, 61
Stefanie L. Speanburg, PhD, LCSW Emory University Psychoanalytic Institute, Atlanta, GA	16, 17, 33, 40, 59, 64, 74	Ellen L.K. Toronto, PhD Michigan Psychoanalytic Council, Ann Arbor, MI	52
Mark Stafford, MA Apres Coup Psychoanalytic Association, New York, NY	35	Vaia Tsolas, PhD Columbia University Center for Psychoanalytic Training and Research, New York, NY	44
Kathy Steele, MN, CS, APRN Metropolitan Counseling Services, Atlanta, GA	11, 31	Steve Tuber, PhD, ABPP City College of New York, New York, NY	76
Miriam Steele, PhD The New School of Social Research, New York, NY	20, 75	Steven Tublin, PhD William Alanson White Institute, New York, NY	48

Usha Tummala-Narra, PhD Boston College, Chestnut Hill, MA	41
Alain Vanier, MD, PhD Université Paris—Diderot, Paris, France	35
Catherine Vanier, PhD Après Coup Psychoanalytic Association, Paris, France	71
Kirkland Vaughans, PhD Private Practice, New York, NY	16, 52
Joel Weinberger, PhD Derner Institute, Adelphi University, Garden City, NY	39, 65
Karen Weisbard, PsyD Relational Psychoanalysis and Psychotherapy Seattle, Seattle, WA	36
Bryant Welch, JD, PhD Private Practice, Sausalito, CA	15, 34
Drew Westen, PhD Emory University, Atlanta, GA	39
Kathryn G. White, PhD Private Practice, New Haven, CT	13, 32
Elizabeth Wilson, PhD Emory University, Atlanta, GA	16, 40
Lisa Wolfe, LCSW New Alternatives for Children, New York, NY	51
Deborah Wolozin, PhD Private Practice, Natick, MA	43
Gideon Yago Writer/Reporter, New York, NY	14, 20, 59, 68
Oksana Yakushko, PhD Pacifica Graduate Institute, Carpinteria, CA	66, 70
Jed Yalof, PsyD, ABPP Immaculata University, Immaculata, PA	66
Kris Yi, PhD, PsyD Independent Practice, Pasadena, CA	69

FLOOR PLANS

Mezzanine Level

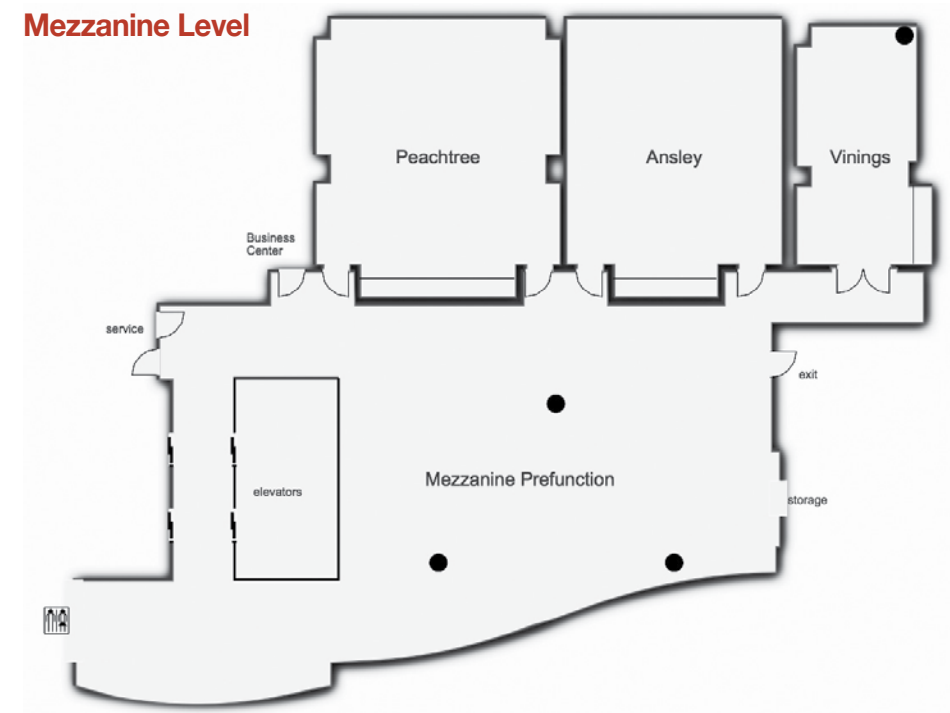

Lobby Level

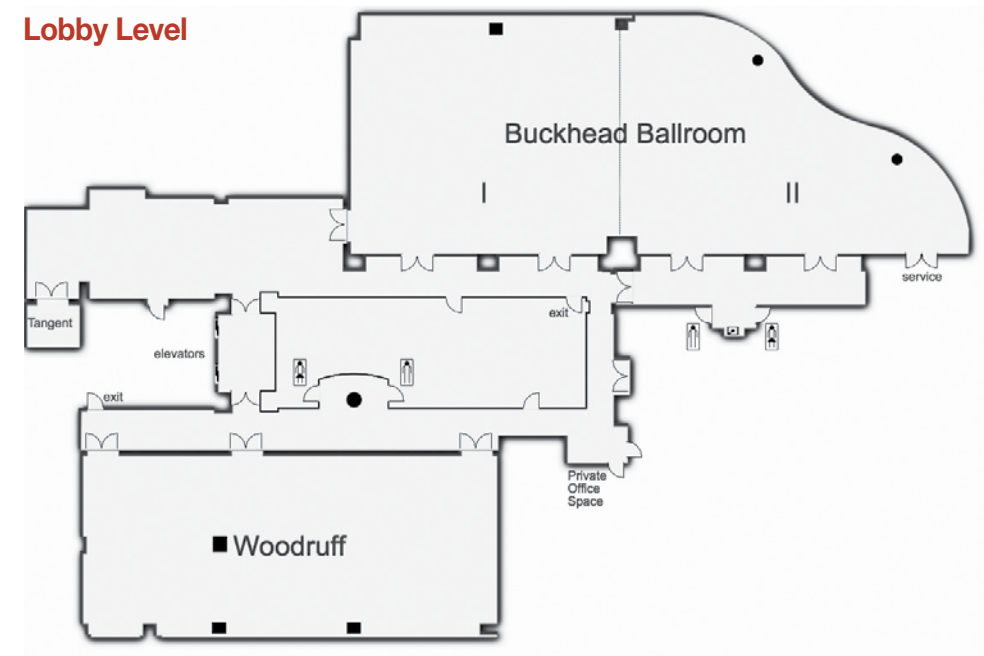

FLOOR PLANS

Fourth Floor

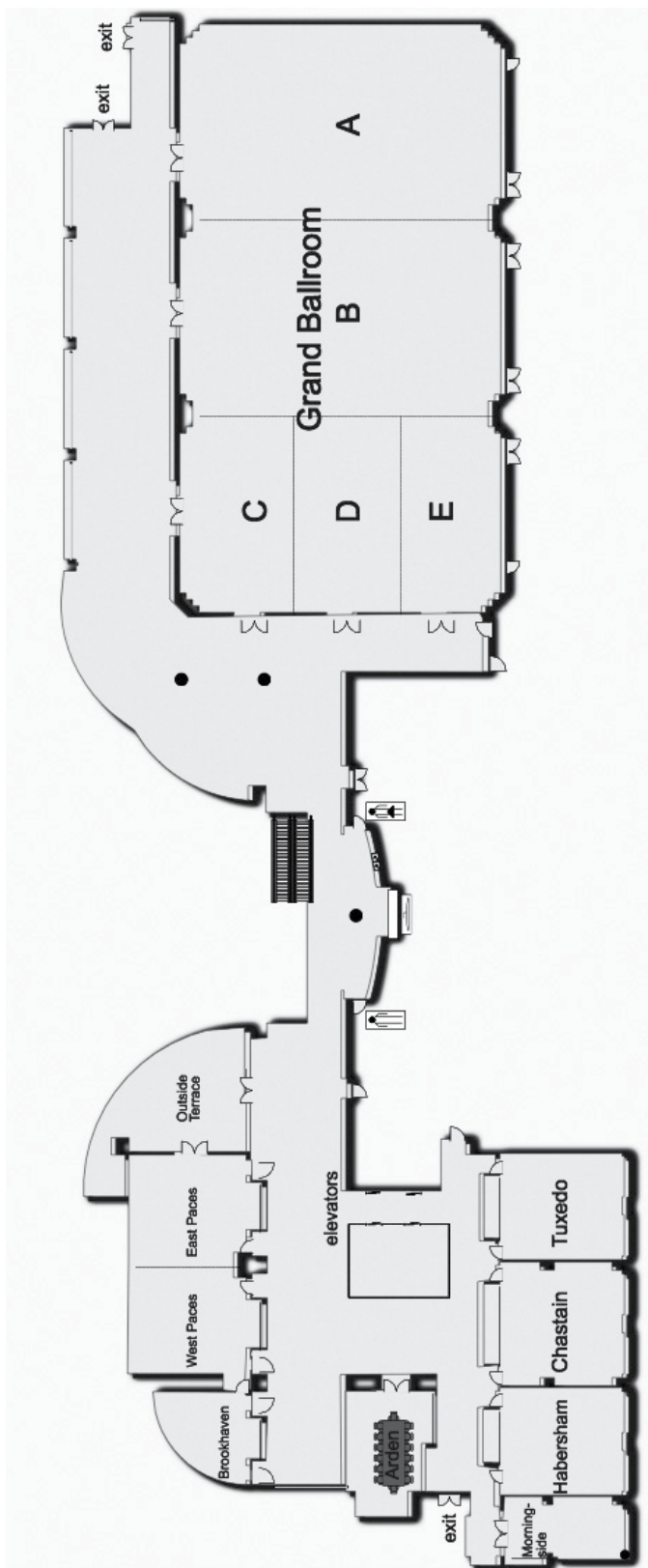

NAME (As you wish it to appear on your badge) _____ DEGREE _____

ADDRESS _____

CITY, STATE, ZIP, COUNTRY _____

PHONE _____

EMAIL _____

Date highest professional degree was received ____/____/____ (mm/yyyy)

First time attending Division 39 Spring Meeting? Yes No

Will you request CE credits for programs you attend? Yes No

Are you a member of APA? Yes No

I am registering as a 2016 Scholar

Please DO NOT include my Name and City on the list to be distributed to conference attendees

Please indicate any accessible accommodations needed _____

REGISTRATION FEES (Circle the appropriate dollar amount.)

ALL STUDENTS AND INSTITUTE CANDIDATES must submit proof of their status WITH registration. Without this proof, your registration will not be processed. See the **Registration** section in this brochure for specific proof required. **Early Bird Registration ends Jan. 15, 2016.**

	Postmarked or electronically submitted by 1/15/16	3/28/16
Member	\$375	\$425
Non-Member	\$450	\$500
<i>I want to add \$95 to my registration fee for a one-year Division 39 Membership <input type="checkbox"/></i>		
Student Member	\$ 60	\$ 70
Student Non-Member	\$ 85	\$ 95
<i>\$25 of all Student Non-Member registrations will be applied to a one-year Division 39 Membership</i>		
ECP Member (Date of Doctoral Degree April 2006 or later)	\$135	\$160
ECP Non-Member (Date of Doctoral Degree April 2006 or later)	\$175	\$190
<i>Please use \$50 of my registration fee towards Division 39 Membership <input type="checkbox"/></i>		
Institute Candidate member (Enrolled in first 5 yrs of curriculum only)	\$135	\$160
Institute Candidate Non-Member (Enrolled in first 5 yrs of curriculum only)	\$205	\$220
<i>Please use \$95 of my registration fee towards Division 39 Membership <input type="checkbox"/></i>		

FOREIGN AFFILIATES Postmarked or electronically submitted by 1/15/16 3/28/16

CURRENT DIVISION 39 MEMBERS:

Canada, Western Europe, Australia, New Zealand, Japan \$305 \$345

Other Countries: South America, Africa, Asia, Middle East \$150 \$190

NON-DIVISION 39 MEMBERS:

Canada, Western Europe, Australia, New Zealand, Japan \$330 \$370

Add \$65 to my registration fee for a one-year Division 39 Membership

I am a Student, add \$20 to my registration fee for a one-year Membership

I am an ECP, add \$35 to my registration fee for a one-year Membership

Other Countries: South America, Africa, Asia, Middle East \$175 \$200

Add \$40 to my registration fee for a one-year Division 39 Membership

I am a Student, add \$15 to my registration fee for a one-year Membership

I am an ECP, add \$30 to my registration fee for a one-year Membership

PLEASE TURN OVER

REGISTRATION FORM, PART 2

CONTINUING EDUCATION MASTER CLASSES *Please check the course(s) you wish to attend:*

9 am–12 pm

- Perversion—To Die in Order to Live? \$60
- The Integrative Treatment of Complex Dissociative Disorders \$60

1–3 pm

- A Therapist's Guide to New Media: How to Promote Your Practice and Expertise Through Websites, Blogging, and Social Media \$40
(Free to Graduate Students and Early Career Professionals who are Division 39 members)

1–4 pm

- Psychoanalytic Dreamwork: The Bridge Between I and Thou \$60

1–5 pm

- The DSM-V and the Psychodynamic Diagnostic Manual—Revised \$80

3–5 pm

- Starting a Practice: Let's Talk About Money \$40
(Practical Tips and Theoretical Considerations)
(Free to Graduate Students and Early Career Professionals who are Division 39 members)

Note: Registrations postmarked after March 25, 2016 will not be processed. DO NOT MAIL OR FAX registrations after that date. You can register onsite at the Westin Hotel beginning Wednesday, April 6. There will be \$50 added to the fee schedule for all onsite conference registrations.

APF DIVISION 39 FUND:

I would like to make a tax deductible contribution of \$ _____

TOTAL PAYMENT DUE

\$ _____

(Registrations will not be processed unless accompanied by full payment.)

REFUND POLICY Refund requests must be received in writing prior to midnight (EDT) March 15, 2016. Fees will be refunded less \$75 for processing. There will be no refunds made after March 15. Please email refund requests to Division39ATL@natalieshear.com or fax to 202-446-2965.

PAYMENT INFORMATION

The only accepted methods of payment are: Checks made payable to Division 39 APA, Visa, Mastercard or AMEX.

CARD NUMBER

EXP. DATE (MM/YY)

NAME AS IT APPEARS ON THE CARD

BILLING ADDRESS IF DIFFERENT FROM ABOVE

CITY, STATE, ZIP CODE

Return registration forms to: Natalie Shear Associates, Conference Coordinators
1000 Vermont Ave. NW, Third Floor, Washington, DC 20005. Fax forms to 202-446-2965
For Registration Questions: 800-833-1354 x 4 or HankLewis@natalieshear.com
For All Other Questions: Division39ATL@natalieshear.com or 800-833-1354

Division 39 Office

Ruth Helein-Executive Admin
2615 Amesbury Road
Winston Salem, NC 27103
(336) 768-1113 (ofc)
(877) 212-0511 (toll free)
(336) 464-2974 (fax)
Div39@namgmt.com
ruth@namgmt.com
www.division39.org

Conference Coordinators

Natalie Shear Associates
1000 Vermont Avenue NW, 3rd Floor
Washington, DC 20005
(800) 833-1354 (toll free)
(202) 833-4456 (ofc)
(202) 446-2965 (fax)
Division39ATL@natalieshear.com
natalie@natalieshear.com
www.natalieshear.com

DIVISION OF PSYCHOANALYSIS (39)
36TH ANNUAL SPRING MEETING

c/o Natalie Shear Associates
1000 Vermont Ave., NW, Third Floor
Washington, DC 20005



HOT & BOTHERED

Coming Together Without Falling Apart

APRIL 6-10, 2016

WESTIN HOTEL • ATLANTA, GEORGIA