



APRIL 22–26, 2015

**SAN FRANCISCO
PALACE HOTEL**

2014 Division 39 Board of Directors

President

Marilyn Charles, Ph.D., ABPP

Past President

Frank L. Summers, Ph.D.

Secretary

Dana Charatan, Psy.D.

Treasurer

Arlene "Lu" Steinberg, Psy.D.

APA Council Reps

Norman Abeles, Ph.D.

Laura Barbanel, Ed.D.

Leilani Crane, Psy.D.

Mary Beth Cresci, Ph.D., ABPP

Marsha D. McCary, Ph.D.

Steven Reisner, Ph.D.

Members-at-Large

Galit Atlas, Ph.D.

Jill Bellinson, Ph.D.

Jaine Darwin, Psy.D., ABPP

Dennis Debiak, Psy.D.

Diana Diamond, Ph.D.

Devon King, Ph.D.

Scott Pytluk, Ph.D.

Kris Yi, Ph.D., Psy.D.

Usha Tummala-Narra, Ph.D.

Section Representatives

Section I: K. William Fried, Ph.D.

Section II: Toni Heineman, D.M.H.

Section III: Marilyn Metz, Ph.D., ABPP

Section IV: Joseph Schaller, Psy.D.

Section V: Barry Dauphin, Ph.D.

Section VIII: Maurine Kelly, Ph.D.

Section IX: Elizabeth Goren, Ph.D.

Parliamentarian

Laurel Bass Wagner, Ph.D.

2015 Spring Meeting

Co-Chairs

Diane Ehrensaft Ph.D.
Toni Heineman, D.M.H.

Steering Committee

Tori Branch, Psy.D.
Gregory Clinton, Ph.D.
Michael Donnell, Psy.D.
Andrew Harlem, Ph.D.
Stephen Hartman, Ph.D.
Loong Kwok, Psy.D.
Bart Magee, Ph.D.
Maureen Murphy, Ph.D.
Alice Lowe Shaw, Ph.D.
Wendy von Wiederhold, Ph.D.

Proposal Reviewers

Donna Bassin, Ph.D.	Alice Lowe Shaw, Ph.D.
Jill Bellinson, Ph.D.	Steve Lugar, Psy.D.
Adam Blum, Psy.D.	Bart Magee, Ph.D.
Chris Bonovitz, Psy.D.	Norka Malberg, Psy.D.
Tori Branch, Psy.D.	Paula Mandel, Ph.D.
Gregory Clinton, Ph.D.	Tiffany McLain, MFTI
Joe Couch, Ph.D.	Maureen Murphy, Ph.D.
Michael Donnell, Psy.D.	Nadine Obeid, Ph.D.
Diane Ehrensaft, Ph.D.	Bruce Reis, Ph.D.
Jack Foehl, Ph.D.	Molly Saeger, MFT
Melissa Gold-Wiedman, Ph.D.	Beatrix Souza, Psy.D.
Orna Guralnik, Psy.D.	Diane Swirsky, Ph.D.
Andrew Harlem, Ph.D.	Usha Tummala-Narra, Ph.D.
Stephen Hartman, Ph.D.	Deborah Weisinger, Psy.D.
Jane Hassinger, MSW	Wendy Von Wiederhold, Ph.D.
Toni Heineman, D.M.H.	Thomas Zurfluh, Psy.D.
Loong Kwok, Psy.D.	

Conference Coordinators

Natalie Shear Associates

LIFE IN PSYCHOANALYSIS IN LIFE

Table of Contents

Spring Meeting Committee and Proposal Reviewers	1
Welcome	3
Division 39 Fund Inaugural Grant	4
General Conference Information	5
Registration Hours	7
Book Exhibitor Hours	7
Continuing Education Credits	8
Pre Conference Continuing Education Master Classes	10
Keynote Speakers	13
Steering Committee Invited Panels	15
Division 39 Events and Meetings	18
Division 39 Section Events	19
Section I	19
Section II	19
Section III	19
Section IV	20
Section V	20
Section VI	20
Section VIII	21
Section IX	21
Division 39 Committee Events	22
Conference Program	
Wednesday, April 22	29
Thursday, April 23	31
Friday, April 24	43
Saturday, April 25	55
Sunday, April 26	65
Index of Presenters	69-84
Hotel Floor Plans	85-86
Registration Form	87-88

Welcome

Sometimes you call a party and people come. We are excited to say that is exactly what happened when we put out an invitation earlier this year to explore your own creative excursions into the intersections of psychoanalysis and our lived experiences, in keeping with the theme chosen collectively by our steering committee for the Spring 2015 meeting, *Life in Psychoanalysis in Life*. Whether as a presenter or a participant, we look forward to coming together as an international psychoanalytic psychology community to weave together psychoanalysis as we incorporate it in our inner lives, in our consultation rooms, in the institutions we find ourselves in, in our communities, and in society at large. We thought that both these historical times and the geographical location of our 2015 spring meeting in the San Francisco Bay Area was the perfect convergence of time and place to challenge ourselves to answer the question, “How, when, where, and why do we live psychoanalysis?”

From the birth of psychoanalysis to its maturation over the past century and more, we have discovered that psychoanalysis is not just a treatment but also a way of life—that we live psychoanalysis while it lives within us. We have chosen a program for you, based on a wealth of proposed ideas from around the country and beyond, that we hope will accomplish our mission of providing scientific and clinical presentation, musing, artistic creation and conversation to enliven our minds, our relationships, and our work as we strive to use psychoanalysis to make changes in the world around us. On behalf of the steering committee and as the co-chairs of the 2015 Spring Meeting, we extend our warmest welcome in joining us in San Francisco April 22–26, 2015.

Diane Ehrensaft, Ph.D. and Toni Heineman, D.M.H.

Division **39** FUND FOR PSYCHOANALYSIS

Has Awarded Its Inaugural Grant to

The Talking Cure: Psychoanalysis in the 21st Century

A documentary film that will explore the success of psychoanalysis in the early years of this century, its steady decline, and its rich opportunities for the future

Grantees

Anne Dailey, University of Connecticut School of Law, Research Fellow, Western New England Institute for Psychoanalysis

Ann Johnson Prum, Emmy award winning producer and cinematographer, President, Coneflower Studios, a documentary film company

This grant has been made possible through your contributions.

Division 39 Fund for Psychoanalysis

Supporting programs in education, research, and service that advance the benefit and applicability of psychoanalytic principles to clinical, organizational, and social problems.

**Continue your support with a donation
or pledge today.**

Conference Information

Hotel

The Palace Hotel, 2 Montgomery Street, San Francisco, CA—Located in the heart of San Francisco's financial center, two blocks from Union Square, without a lot of hills to climb, the elegant and historic Palace Hotel is in walking distance to museums, arts center, Chinatown, theater district and more than 40 restaurants. When you have a break, head to the fourth floor for complimentary health club access to the swimming pool, sauna and fitness center. With so much to do, plan to come early and stay late.

A special room rate is available for conference attendees from Wednesday, April 22 to Sunday, April 26 at \$235 single/double plus taxes. The rate will apply 3 days before and 3 days after the conference. To book your room, type this link into your browser: <https://www.starwoodmeeting.com/StarGroupsWeb/booking/reservation?id=1402127998&key=8E350>

All reservations must be made by **March 31, 2015**. After that date, any rooms, if available, will be subject to the hotel's prevailing rate.

Registration

If you are using a credit card, you may register online at the Division 39 website (www.division39.org), or you may fax your registration to 202-446-2965.

If you are paying by check, please mail your registration form with your check. We do not accept registrations by telephone.

Note: All conference participants, including presenters, must register and pay the fee. There are no exceptions. There are no partial or day rate registrations.

When an on-line form is fully completed and "submitted," the screen changes to a message thanking you for submitting the registration. When the credit card associated with a registration has been charged, a formal confirmation of registration is emailed to the registrant. All questions regarding registration are to be directed to Natalie Shear Associates at 1-800-833-1354 x 4 or by email to Hank@natalieshear.com.

There is a \$25 processing fee for credit cards and checks that are declined, and, a \$50 on-site registration fee that is applied to everyone who has not registered in advance.

Graduate Students

All students **MUST** submit proof of current full-time student status WITH registration. Without this proof, registration cannot be processed. "Proof" is an official document that has the school logo and/or letterhead that specifically states that a student is

LIFE IN PSYCHOANALYSIS IN LIFE

enrolled full-time for the current semester or provides information (i.e., a paid bill or transcript, a letter from the registrar, etc.) that supports that enrollment. **A student ID is NOT “proof.”**

Institute Candidates

Candidates in analytic institutes who wish to register at the special fee must include with their registration form, a letter from an administrator at their institute stipulating that you are a **candidate in good standing in the first five years of your training.**

If you are mailing or faxing your registration as a student or candidate, please submit the required “proof” or “letter” with it. If you are submitting your registration online, please submit the “proof” or letter by fax to 301-986-8647 or by email to Hank@natalieshear.com.

Early Career Psychologists (ECP)

The Division offers a special registration fee to psychologists who have received their doctoral degree in April 2008 or later. Fees are listed on the Registration form.

Registration Deadline

Registrations postmarked after April 14, 2015 will not be accepted. Do NOT mail or fax registrations after April 14. Registration after April 14 is only available on-site at the conference hotel beginning Wednesday, April 22.

Refund Policy

Refund requests must be received in writing prior to April 1, 2015. Fees will be refunded less a \$75 processing fee. There will be no refunds made after April 1. Please email refund requests to Division39SF@natalieshear.com or fax to 202-446-2965.

Accessible Accommodations

Assistive Listening Devices, sign language interpreters and materials in alternative formats will be provided upon request for conference sessions. Please indicate your request on the Registration Form.

On-Site Registration

Anyone who has not registered prior to April 14, may do so on-site at the conference. There is an additional fee of \$50 for on-site registrations. There are no exceptions. Registration will be open at the Palace Hotel beginning Wednesday morning, April 22.

On-Site Check-In

Please pick up your credentials and Continuing Education materials before attending any sessions. You will need these materials for admission to conference sessions and to receive Continuing Education credits.



DIVISION OF PSYCHOANALYSIS (39)
35TH ANNUAL SPRING MEETING

Wednesday Master Classes and Conference Registration Hours

Wednesday, April 22	11 am–5 pm
Thursday, April 23	7 am–6 pm
Friday, April 24	7 am–5 pm
Saturday, April 25	7 am–4 pm
Sunday, April 26	7 am–11am

Book Exhibitors

Exhibitors at press time include Association Book Exhibit, Austen Riggs Center, Routledge and Routledge Journals, Rowman & Littlefield (formerly Jason Aronson). Please see their ads in this program. Exhibitors will be located in the Sunset Court on the Second Floor of the hotel, adjacent to a large number of meeting rooms.

Wednesday, April 22	Move In
Thursday, April 23	9 am–5 pm
Friday, April 24	9 am–6 pm
Saturday, April 25	9 am–6 pm
Sunday, April 26	9 am–1 pm

LIFE IN PSYCHOANALYSIS IN LIFE

Continuing Education Credits

The Division of Psychoanalysis is approved by the American Psychological Association to sponsor continuing education for psychologists. Division 39 maintains responsibility for these programs and their content.

Amount Of Continuing Education Available

Each 1 hour and 50 minute program is available for 1.5 CE Credits. Participants have the ability to accrue up to 21 CE Credits by attending programming throughout Thursday to Sunday. For all CE-eligible programs, there is no partial credit for attending only a portion of an eligible program.

How to Receive CE

To receive a Certificate of Attendance for any CE-eligible program, it is necessary to

1. Register for the Spring Meeting
2. Attend the entire presentation
3. Return a completed evaluation form and CE Log

Each CE-eligible program is identified by a letter/number code (i.e., TH-1, FR-3, SA-5, SU-2) indicating the day of the presentation and its order in that day's schedule. This code will match the program's listing on the Continuing Education (CE) Log, which is each participant's official record of attendance at CE-eligible programs. 50-minute programs are not available for continuing education credits; other presentations that are not available for continuing education credits are identified as such. If interested in earning continuing education credits for attending programs during the Spring Meeting, please request a Continuing Education Log at the Registration Desk. **Certificates will be emailed to participants to the address they provided when registering.**

Wednesday Master Classes

Master Classes and Spring Meeting programs are open to all mental health professionals, and participants may receive continuing education credit for attending one or more of these programs. Wednesday Master Classes require registration separate from general registration for the Spring Meeting and are offered for additional fees.

Continuing Education for Non-Psychologists

Participants from professions other than psychology should consult with their respective licensing boards regarding the acceptance of American Psychological Association-approved Certificates of Attendance as documentation of continuing education.

Description of Workshops

Complete descriptions of each Wednesday Master Class and other CE-eligible programs (title, presenter(s), learning objectives, instructional level) can be found on the Division 39 website: www.division39.org. The website will be the most complete source of information about CE-eligible programs, and participants are encouraged to check this site regularly for updates and/or additional information when making decisions about attending the Wednesday Master Classes and/or Spring Meeting programs offered from Thursday to Sunday.

Other Information About Continuing Education

Division 39 is committed to accessibility and non-discrimination in its continuing education activities and will conduct these in conformity with the American Psychological Association's Ethical Principles for Psychologists. There is no commercial support for any of the Wednesday Master Classes or Spring Meeting continuing education programs. All presenters have denied the existence of any relationships (i.e., based on program content, research, grants or other funding/support) that could be construed as conflicts of interest. Presenters of CE-eligible programs will address, whether during the program or via a list of references, the utility of the presentation content and the basis for their statements about this utility as well as the limitations and risks (common and most severe) associated with the program content. Presenters and participants are asked to honor the need for privacy and confidentiality throughout these programs. If program content becomes emotionally distressing, participants are encouraged to process these feelings during discussion periods. If participants have special needs, we will make reasonable attempts to accommodate them. Please contact Natalie Shear (natalie@natalieshear.com) with requests for accommodation. Please contact Colin Ennis (Chair of Division 39's Continuing Education Committee) at div39ce@gmail.com or 312-725-9745 for additional information about presenters, with questions and/or complaints.

LIFE IN PSYCHOANALYSIS IN LIFE

Pre Conference Continuing Education Master Classes

Wednesday, April 22, 2015 • Advance Registration Required

Workshops are open to all mental health professionals. Participants may receive continuing education credit for these events. The Division of Psychoanalysis is approved by the American Psychological Association to offer continuing education for psychologists. Division 39 maintains responsibility for the program. Upon completing an evaluation form, participants will receive certificates of attendance for each class completed. Participants may register for one or more CE master classes, independent of registering for the Spring Meeting itself. This information is also available on the Division 39 website, www.division39.org. A full description of every master class along with learning objectives and biographical information on the presenters can also be found on the Division website. **Please indicate on the registration form which sessions you will attend.**

1–4 pm

3 CE Credits, Fee: \$60

Couples on the Couch: Principles of Psychoanalytic Psychotherapy with Couples

Shelley Nathans, Ph.D. and Milton Schaefer, Ph.D.

This intermediate seminar will teach a model of Psychoanalytic Couples Psychotherapy originally developed at the Tavistock Marital Studies Institute. Utilizing Neo-Kleinian and Bionian concepts such as Projective Identification and Containment with a focus on transference and countertransference phenomena, the model explicates a way of understanding the often entrenched and deeply troubling interactions between couples. Interpretation of the ways that the couple uses each other and the therapist to both communicate and defend against primitive anxieties can be extremely useful in addressing the couples' shared unconscious phantasies. Case examples will illustrate techniques of addressing barriers to the couple's curiosity about themselves and each other which can then lead to both greater differentiation and intimacy.

1–4 pm

3 CE Credits, Fee: \$60

Make the Mountain Dance: Koans for Psychotherapists

Megan Rundel, Ph.D.

In this introductory workshop, we will explore the use of Zen koans for psychotherapists. We will begin with a short presentation on the history of koans, and describe their utility in reaching layers of the unconscious and promoting creativity and flexibility. We will then spend time meditating with koans in mind, and work together as a group to inquire into our experience with the koans. No experience with koans is necessary, but curiosity and an open mind are helpful.

1–4 pm

3 CE Credits, Fee: \$60

Writing as Coming into Being: Writing Workshop for Beginning and Experienced Writers

Annie Sweetnam, Ph.D.

This workshop is for beginning and experienced writers who are interested in writing in ways that help evoke the unconscious experiences in analytic work—forms of writing that can bring us and our clinical experience more fully into being. We will explore how writing can be also used as an aid when we are in the midst of clinical difficulties or impasses. The workshop will be a mix of reading examples, exercises that help us gain greater access to the unconscious processes, and discussion. Discussion will include looking at strategies for dealing with anxieties about both the necessary grandiosities, and the inevitable blocks involved in the writing process.

1–4 pm

3 CE Credits, Fee: \$60

On Reclaiming the Treatment of Pain Syndromes and Somatic Disorders for Psychoanalysis: A Comprehensive Exploration and Review

Marilyn Jacobs, Ph.D., ABPP, Eric Sherman, Psy.D., Lekeisha A. Sumner, Ph.D.

This interactive workshop will provide an integrated model for the psychoanalytic evaluation and treatment of patients with chronic pain, medically-unexplained symptoms and somatic distress. A historical review of how psychoanalysis has approached this area of practice beginning with Freud to the present will be outlined. The consequences for medical patients when subjective inner experiences are neglected and aggressive medical therapies are favored with the goals of psychotherapy limited to conscious control over symptoms, and stress management will be explained. The workshop will illuminate how Western-oriented science neglects cultural influences in understanding the pain experience as well as how patients from diverse backgrounds may be afforded sub-optimal psychological care. Participants will be encouraged to discuss case material.

LIFE IN PSYCHOANALYSIS IN LIFE

4:30–6:30 pm

2 CE Credits, Fee: \$40

Early Career Committee Sponsored Workshop:

The Nuances of New Beginnings: Starting Your Private Practice

Chair: Daphny LD Ainslie, Psy.D.

Presenters: Dana Charatan, Psy.D., Paul M. Martin, Psy.D., Tanya Cotler, Ph.D., Kristi Piekiewicz, Ph.D., Dan Livney, Psy.D.

Creating a niche for oneself while maintaining one's psychoanalytic framework requires some out-of-the-box thinking. Hear how others have learned to integrate their identities as therapist small-business-owner, and entrepreneur, while maintain personal relationships. This workshop covers practical aspects of establishing a specialization, traditional and non-traditional marketing, networking, private practice anxieties, along with personal and professional development.

Keynote Speakers

Friday, April 24 • 4–5:30 PM • Grand Ballroom

Dance, Psychoanalysis, and the Nitty-Gritty of Life: A Conversation with Choreographer Joe Goode



Joe Goode

Joe Goode Performance Group
Professor, Department of Theater, Dance and Performance Studies,
University of California, Berkeley

Psychoanalysis has long sought to interpret the body—the cradle of desire, the repository of trauma. We know the body speaks: the stories we tell and the meanings we make emerge from our living, moving flesh. Joe Goode personifies this knowledge. More than any contemporary choreographer, he strives to integrate dance, spoken word, music and song to tell a story of human experience. Join us as we explore Joe's art together and find inspiration for an enlivened, embodied psychoanalysis.

Saturday, April 25 • 10–11:30 AM • Grand Ballroom

Vicarious Traumatization: A Dialogue with Ghislaine Boulanger and Stephen Xenakis



Ghislaine Boulanger, Ph.D.

Ghislaine Boulanger is a psychologist and psychoanalyst in private practice in New York City and a member of the Relational faculty at New York University's Postdoctoral Program in Psychotherapy and Psychoanalysis. She is currently president and president elect of Section V, the Section for Applied Clinical Psychoanalysis of

Division 39 and on the board of Section IX of Division 39, Psychoanalysts for Social Responsibility. Previously, with Ruth Fallenbaum, she was co editor of the Section IX newsletter, *The Psychoanalytic Activist*. Since the publication of her book, *Wounded by Reality: Understanding and Treating Adult Onset Trauma*, Dr. Boulanger has taught and published extensively on the psychodynamic dilemmas facing adults who have survived violent and life threatening events, and on the consequences for the clinicians who work with them. The latter is the topic of this keynote conversation.

LIFE IN PSYCHOANALYSIS IN LIFE



Stephen Xenakis, M.D.

Brigadier General (ret.), Chief Medical Officer, MindCare Solutions, Nashville, TN

Dr. Xenakis is a psychiatrist with an active clinical and consulting practice. He is the Founder of the Center for Translational Medicine that develops treatments and conducts tests on brain related conditions affecting soldiers and veterans. He has been a senior adviser to the Department of Defense on a wide range of issues concerning the care and support to service members and their families. Retiring at the rank of brigadier general, he served 28 years in the United States Army as a medical corps officer. Dr. Xenakis has written widely on medical ethics, military medicine, and treatment of detainees, including book chapters and legal reviews and appears regularly on national radio and television. He is currently working on the clinical applications of quantitative electroencephalography (QEEG) to brain injury and neurobehavioral conditions and promoting integrative care programs for veterans. Dr. Xenakis is an Adjunct Professor at the Uniformed Services of Health Sciences of the military medical department. He is a graduate of Princeton University and the University of Maryland School of Medicine.

Ruth Fallenbaum, Ph.D., *moderator*

Steering Committee Invited Panels

Thursday, April 23, 1–2:50 pm

Twin Peaks North

The Psychoanalytic Kaleidoscope: Community, Competition, Collaboration

Psychoanalytic training can take various paths: through institutes, internship programs, independent courses, and study groups. Some paths cross, others run parallel, and others collide. How do we work together without tripping over each other? This panel will initiate a discussion on collaborating to meet a diversity of training needs in the midst of an era of increasingly behavioral graduate courses, disappearing psychoanalytic training sites, and growing competition for candidates.

Mary Margaret McClure, D.M.H.

Diane Swirsky, Ph.D.

Julie Leavitt, M.D.

Todd Troutman, Psy.D.

Greg Clinton, Ph.D., *moderator*

Toni Heineman, D.M.H., *moderator*

Thursday, April 23, 3–4:50 pm

Marina

From the Couch to the Playground: School-based Psychotherapy with Children

In the early 20th century, the first psychoanalytic treatment of a child was conducted in the child's home. Soon after, the venue was moved to the clinical office. A century later, psychoanalytic treatment has spilled into the community and across social classes and in doing so, has by necessity, extended the boundaries well beyond the confines of the consultation room. This panel explores the movement of psychoanalytic treatment into the community from the perspective of two child clinicians, operating in school based and community venues and an educator and school principal.

Michelle Baker, MFT

Sharif Okasha, Psy.D., *discussant*

Jean Roberston Principal, *discussant*

Andrew Harlem, Ph.D., *moderator*

Wendy von Wiederhold, Ph.D., *moderator*

LIFE IN PSYCHOANALYSIS IN LIFE

Friday, April 24, 10 am–12:50 pm

Twin Peaks North

Trauma and Resilience: A Viewing of Film “Sweet Dreams” and Dialogue with the Filmmaker

Exclusive film screening and interview with Academy Award winning filmmaker Lisa Fruchtman, director of “Sweet Dreams,” a portrait of struggle and resilience. The film shows a remarkable group of Rwandan women who emerge from the devastation of the genocide to create their own unique path to a future of peace and possibility.

Lisa Fruchtman, *filmmaker, director and producer of “Sweet Dreams”*

Rachael Peltz, Ph.D., *interviewer*

Alice Lowe Shaw, Ph.D., *moderator*

Friday, April 24, 2–3:50 pm

Twin Peaks North

Playing and Cyber-Reality: Emotional Development and Transitional Space Online

“Cultural experience begins with creative living first manifest in play,” wrote Winnicott. “How will we live and play creatively in a future where time and space are fungible?” wonders a psychoanalyst who walks into a bar and encounters a philosopher, a futurist, and a colleague. The tech-guy demonstrates *Ingress*, an app-based game that brings strangers together in public space. The panelists have a field day imagining how playing and reality combine in cyber-transitional space.

Matthieu de Fayet

Phillip Freeman, M.D., D.M.H.

John Hanke, MBA

Stephen Seligman, D.M.H.

Stephen Hartman, Ph.D., *moderator*

Loong Kwok, Psy.D., *moderator*

Saturday, April 25, 1–2:50 pm

Twin Peaks North

Sex, Love, and Kinship in the Twenty-First Century

The two panel series, Sex, Love, and Kinship, explores being and living in a post-millennium world that has moved beyond solely binary or dyadic categorizations in the organization of self and self and other.

In Part I, The Fate of the Dyad, the panel will consider the growing number of non-dyadic relationships in family formation, child rearing, and romance. In Part II, The Fate of the Binary, the panel will explore the challenges to and shifts in thinking about heretofore dualistic categories of gender, of coupling and parentage, of sexuality.

The increasing fluidity of the world demands a willingness to explore hard questions in the above areas. To that end, both panels will examine clinicians' experiences and roles in working with the shifting expectations and definitions patients bring to the consulting room in regards to both the dyad and the binary in areas of sex, love, and kinship, while also considering the clinical implications and life impacts these identities and choices may bring with them.

Part I: The Fate of the Dyad

Sand Chang, Ph.D.

Muriel Dimen, Ph.D.

Paola Mieli, Ph.D.

Ruth Simon, Ph.D.

Maureen Murphy, Ph.D., *moderator*

Don Romesburg, Ph.D., *moderator*

Saturday, April 25, 3–4:50 pm

Twin Peaks North

Sex, Love, and Kinship in the Twenty-First Century

Part II: The Fate of the Binary

Sheri Ashcraft, Psy.D.

Francisco Gonzalez, M.D.

Lynne Harkless, Ph.D.

Adrienne Harris, Ph.D., *discussant and presenter*

Diane Ehrensaft, Ph.D., *moderator*

Tori Branch, Psy.D., *moderator*

LIFE IN PSYCHOANALYSIS IN LIFE

Division 39 Events and Meetings

Thursday, April 23

Board of Directors Meeting

8 am–4 pm • French Parlor

President's Address and Award Ceremony

5–6:30 pm • Ralston Ballroom

Awards Chair: Mary-Joan Gerson, Ph.D.

Award Recipients:

Leadership Award: Richard Ruth, Ph.D.

Diversity Award: Usha Tummala-Narra, Ph.D.

President's Address:

Marilyn Charles, Ph.D., ABPP

The Future of Psychoanalysis

Welcome Reception

6:30–8 pm • Sunset Court

Friday, April 25

Keynote Address

4–5:30 pm • Grand Ballroom

Dance, Psychoanalysis, and the Nitty-Gritty of Life: A Conversation with Choreographer Joe Goode

Saturday, April 26

Keynote Address

10–11:30 am • Grand Ballroom

Vicarious Traumatization: A Dialogue with Ghislaine Boulanger and Stephen Xenakis

Scholarship and Research Award

12–12:50 pm • Twin Peaks North

Award Recipient: William H. Gottdiener, Ph.D.

Paper: **Psychoanalysis and Addictions**

Division 39 Section Events

Section I: Psychologist Psychoanalyst Practitioners

Invited Panel

Robert Wallerstein: Sixty-five Years at the Center of Psychoanalysis—A Film and Conversation

Thursday, April 23, 10 am–12:50 pm

Telegraph Hill

Board Meeting

Saturday, April 25, 3–5 pm

Presidio

Reception

Friday, April 24, 6–8 pm

Marina

Section II: Childhood and Adolescence

Invited Panel

Psychoanalysis in the Lives of Immigrant Children, Their Families and the Mental Health Professionals Supporting Them

Friday, April 24, 1–2:50 pm

French Parlor

Board Meeting

Friday, April 24, 10–11:50 am

Sutter Boardroom

Reception

Joint Reception Co-sponsored by Sections II, V and IX and the Committees on Multicultural Concerns, Sexualities and Gender Identities, Early Career Psychologists and Psychoanalysis and the Community

Saturday, April 25, 6:30–8:30 pm

Twin Peaks North and South

Section III: Women, Gender and Psychoanalysis

Invited Panel

Women as Objects of Exchange in Life and Psychoanalysis

Thursday, April 23, 3–4:50 pm

Sea Cliff

Board Meeting

Saturday, April 25, 8–9:50 am

Sierra

LIFE IN PSYCHOANALYSIS IN LIFE

Reception

Joint Reception co-sponsored with Section VIII

Saturday, April 25, 6–8 pm

Sea Cliff

Section IV: Local Chapters

Invited Panel

Aliveness in Psychoanalytic Supervision

Sunday, April 26, 8–9:50 am

Presidio

Senate Meeting

Friday, April 24, 8–9:50 am

Presidio

Open Meeting

Saturday, April 25, 7–8:50 am

Sea Cliff

Section V: Applied Clinical Psychoanalysis

Invited Panel

The Disappearance of Psychoanalytic Thinking from the Public Sector: Definite Problems, Possible Solutions

Friday, April 24, 8–9:50 am

French Parlor

Board Meeting

Friday, April 24, 2–3:50 pm

Sutter Boardroom

Reception

Joint Reception Co-sponsored by Sections II, V and IX and the Committees on Multicultural Concerns, Sexualities and Gender Identities, Early Career Psychologists and Psychoanalysis and the Community

Saturday, April 25, 6:30–8:30 pm

Twin Peaks North and South

Section VIII: Couple and Family Therapy and Psychoanalysis

Invited Panel

Same Sex Parenting and Sexual Fantasy Disclosure in Diverse Couples

Thursday, April 23, 1–2:50 pm

Marina

Board Meeting

Thursday, April 23, 12–12:50 pm

Sutter Boardroom

Reception

Joint Reception co-sponsored with Section III

Saturday, April 25, 6–8 pm

Sea Cliff

Section IX: Social Responsibility

Invited Panel

A New Model for Psychoanalytic Thinking and Community Practice:

A Live Presentation of Reflective Spaces/Material Places

Thursday, April 23, 10–11:50 am

Presidio

Board Meeting

Thursday, April 23, 1–2:50 pm

Telegraph Hill

Special Meeting

Friday, April 24, 8–9:50 am

Twin Peaks North

Reception

Joint Reception Co-sponsored by Sections II, V and IX and the Committees on Multicultural Concerns, Sexualities and Gender Identities, Early Career Psychologists and Psychoanalysis and the Community

Saturday, April 25, 6:30–8:30 pm

Twin Peaks North and South

LIFE IN PSYCHOANALYSIS IN LIFE

Division 39 Committee Events

American Board and Academy of Psychoanalysis (ABAPsa)

Board Meeting

Saturday, April 25, 8 am–noon; 1–4 pm

Monterey

Sunday, April 26, 8 am–noon

Montgomery

Candidate Outreach Committee

Invited Panel

The Interrelatedness of Life and Psychoanalytic Training

Sunday, April 26, 8–9:50 am

Mendocino

Candidate's Reception

Friday, April 24, 5:30–6:30 pm

Presidential Suite

Reception

President's Reception for Graduate Students, Candidates and Early Career Psychologists

Friday, April 24, 6:30–8:30 pm

Sea Cliff

Committee on Education and Clinical Training

Invited Panel

Psychoanalytic Training Opportunities in Pre-Doctoral Internships & Post-Doctoral Fellowships, 1995-2015: Opportunities & Challenges

Sunday, April 26, 8–9:50 am

Monterey

Board Meeting

Thursday, April 23, 4–4:50 pm

Sutter Boardroom

Committee on Humanities and Psychoanalysis

Invited Panel

Encountering the Beat Generation: An Interdisciplinary Discussion

Friday, April 24, 10–11:50 am

Marina

Committee on International Relations in Psychoanalytic Psychology

Invited Panel

International Psychoanalytic Outreach: A Model of Training and Intervention for the 21st Century

Sunday, April 26, 8–9:50 am

Pacific Heights

Board Meeting

Saturday, April 25, 8–9:50 am

Sonoma

Committee on Multicultural Concerns

Invited Panel

Marginalization & Trauma in the Psyche: Working with Parents and Children of Color

Friday, April 24, 8–9:50 am

Pacific Heights

Board Meeting

Saturday, April 25, 1–2:50 pm

Sea Cliff

Reception

Joint Reception Co-sponsored by Sections II, V and IX and the Committees on Multicultural Concerns, Sexualities and Gender Identities, Early Career Psychologists and Psychoanalysis and the Community

Saturday, April 25, 6:30–8:30 pm

Twin Peaks North and South

Committee on Psychoanalysis and the Community

Invited Panel

Starting at the Gate: How to Enter as a Community Psychoanalyst

Thursday, April 23, 1–2:50 pm

Pacific Heights

Board Meeting

Thursday, April 23, 3–3:50 pm

Sutter Boardroom

Reception

Joint Reception Co-sponsored by Sections II, V and IX and the Committees on Multicultural Concerns, Sexualities and Gender Identities, Early Career Psychologists and Psychoanalysis and the Community

Saturday, April 25, 6:30–8:30 pm

Twin Peaks North and South

LIFE IN PSYCHOANALYSIS IN LIFE

Committee on Psychoanalysis and Health Care

Invited Panel

The Mind and Body in Pain: Psychoanalytic Work and the Phenomenology of Suffering

Friday, April 24, 8–9:50 am

Marina

Board Meeting

Friday, April 24, 10–10:50 am

French Parlor

Committee on Sexualities and Gender Identities

Invited Panel

Kink: In the Mind and Body of the Beholder

Friday, April 24, 10–11:50 am

Telegraph Hill

Board Meeting

Saturday, April 25, 1–1:50 pm

Off site

Reception

Joint Reception Co-sponsored by Sections II, V and IX and the Committees on Multicultural Concerns, Sexualities and Gender Identities, Early Career Psychologists and Psychoanalysis and the Community

Saturday, April 25, 6:30–8:30 pm

Twin Peaks North and South

Early Career Psychologists Committee

Invited Panel

Developing an Analytic Identity: Does Psychoanalysis Need to Become One's Life?

Saturday, April 25, 8–9:50 am

Telegraph Hill

Board Meeting

Thursday, April 23, 12–12:50 pm

Sea Cliff

Reception

President's Reception for Graduate Students, Candidates and Early Career Psychologists

Friday, April 24, 6:30–8:30 pm

Sea Cliff

Reception

Joint Reception Co-sponsored by Sections II, V and IX and the Committees on Multicultural Concerns, Sexualities and Gender Identities, Early Career Psychologists and Psychoanalysis and the Community

Saturday, April 25, 6:30–8:30 pm

Twin Peaks North and South

Ethics Committee

Invited Panel

It's Time We Talked: Personal Encounters with Sexual Boundary Violations

Thursday, April 23, 8–9:50 am

Sea Cliff

Board Meeting

Saturday, April 25, 11:30 am–noon

Sonoma

Graduate Student Committee

Invited Panel Live Supervision

Thursday, April 23, 3–4:50 pm

Telegraph Hill

Invited Panel

What Would Freud Do? Navigating the Psychoanalytic Superego in Training

Sunday, April 26, 8–9:50 am

Marina

Special Workshops for Graduate Students

Workshop I: Joe Goode

Friday, April 24, 5:30–6:15 pm

Presidio

Workshop II: Ghislaine Boulanger, Ph.D. and Stephen Xenakis, M.D.

Saturday, April 25, 11:30–Noon

Grand Ballroom

Reception

President's Reception for Graduate Students, Candidates and Early Career Psychologists

Friday, April 24, 6:30–8:30 pm

Sea Cliff

Program Committee

Sunday, April 26, 8–9:50 am

Grant Boardroom

Psychoanalytic Psychology Editorial Board

Sunday, April 26, 9–10:30 am

Sierra

Publications Committee

Sunday, April 26, 7:30–8:50 am

Sierra

LIFE IN PSYCHOANALYSIS IN LIFE

Research Committee

Invited Panel

What We Learn About Analysis from Outcomes and Follow-up from Both Sides of the Atlantic

Friday, April 24, 1–2:50 pm

Telegraph Hill

Scientific Poster Presentations

Thursday, April 23, 6:30–8 pm

Sunset Court

Spirituality Committee

Thursday, April 23, 12–12:50 pm

Twin Peaks North

Wiki Project

Saturday, April 25, 7:30–9 am

Twin Peaks South



A U.S. News and World Report
TOP TEN “Best Hospital”

AUSTEN RIGGS CENTER

INTEGRATED PSYCHIATRIC CONTINUUM OF CARE

25 Main Street, Stockbridge, MA • [855] 283.1770 • www.austenriggs.org

MEMBERS OF APA DIVISION 39 RECEIVE SPECIAL SUBSCRIPTION RATES TO ROUTLEDGE PSYCHOANALYSIS JOURNALS

**SUBSCRIBE
TODAY**

Routledge Journals is pleased to offer members of the **American Psychological Association: Division 39 (Psychoanalysis)** special rates to 2015 Print and Online subscriptions of journals from our Psychoanalysis Portfolio. Email societies@tandf.co.uk to expedite your order.

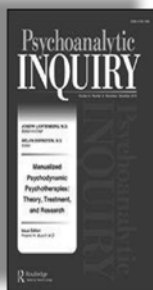

Psychoanalytic Inquiry
www.tandfonline.com/HPSI
Print ISSN: 0735-1690
Online ISSN: 1940-9133
8 issues per year
Special Rate - US \$90



Psychoanalytic Dialogues
www.tandfonline.com/HPSPD
Print ISSN: 1048-1885
Online ISSN: 1940-9222
6 issues per year
Special Rate - US \$88

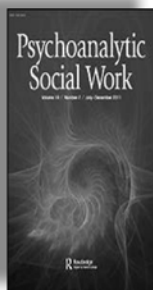

Psychoanalytic Social Work
www.tandfonline.com/WPSW
Print ISSN: 1522-8878
Online ISSN: 1522-9033
2 issues per year
Special Rate - US \$80



Contemporary Psychoanalysis
www.tandfonline.com/UUCP
Print ISSN: 0010-7530
Online ISSN: 2330-9091
4 issues per year
Special Rate - US \$79



**Journal of Infant, Child,
and Adolescent Psychotherapy**
www.tandfonline.com/HICP
Print ISSN: 1528-9168
Online ISSN: 1940-9214
4 issues per year
Special Rate - US \$78



Studies in Gender and Sexuality
www.tandfonline.com/HSGS
Print ISSN: 1524-0657
Online ISSN: 1940-9206
4 issues per year
Special Rate - US \$56



Psychoanalytic Perspectives
www.tandfonline.com/UPPE
Print ISSN: 1551-806X
Online ISSN: 2163-6958
3 issues per year
Special Rate - US \$37



**LIKE ROUTLEDGE PSYCHOANALYSIS
ON FACEBOOK**

Become a fan of Routledge Psychoanalysis on Facebook and receive the latest information on new publications and upcoming events.

www.facebook.com/RoutledgePsychoanalysis

Visit the Routledge Booth for 20% off & free global shipping!

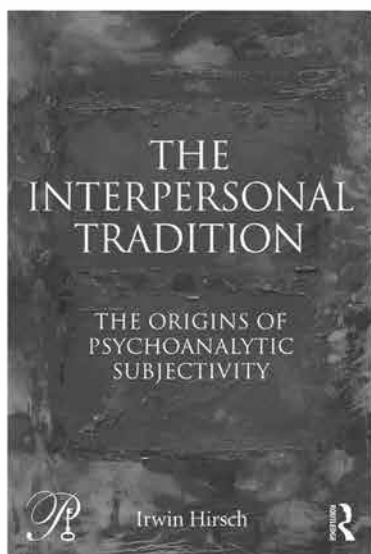

The Interpersonal Tradition
September 2014
Irwin Hirsch

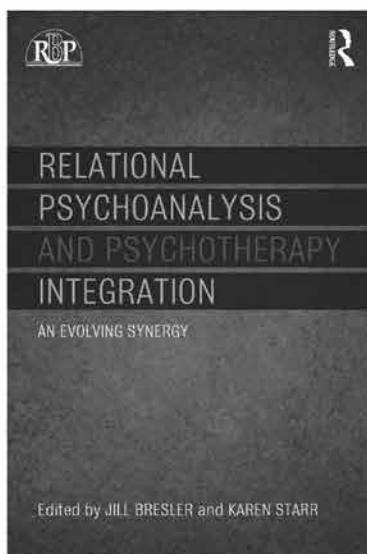

Relational Psychoanalysis and
Psychotherapy Integration
March 2015
Jill Bresler & Karen E. Starr

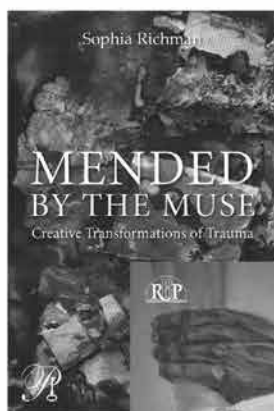

Mended by the Muse
April 2014
Sophia Richman

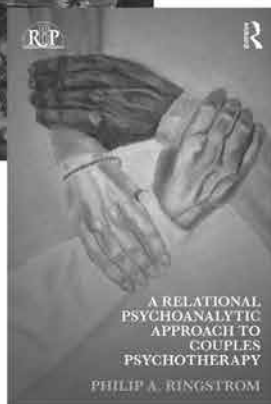

A Relational Psychoanalytic
Approach to
Couples Psychotherapy
March 2014
Philip Ringstrom

Use code **URK61** online
until May 25, 2015 to
get 20% off!

LIFE IN PSYCHOANALYSIS IN LIFE

WEDNESDAY APRIL 22

1–4 pm

Sea Cliff

Continuing Education Master Class

Couples on the Couch: Principles of Psychoanalytic Psychotherapy with Couples

Shelley Nathans, Ph.D.

Milton Schaefer, Ph.D.

1–4 pm

Marina

Continuing Education Master Class

Make the Mountains Dance: Koans for Psychotherapists

Megan Rundel, Ph.D.

1–4 pm

Presidio

Continuing Education Master Class

Writing as Coming into Being: Writing Workshop for Beginning and Experienced Writers

Annie Sweetnam, Ph.D.

1–4 pm

French Parlor

Continuing Education Master Class

On Reclaiming the Treatment of Pain Syndromes and Somatic Disorders for Psychoanalysis: A Comprehensive Exploration and Review

Marilyn Jacobs, Ph.D., ABPP

Eric Sherman, Psy.D.

Lekeisha A. Sumner, Ph.D.

LIFE IN PSYCHOANALYSIS IN LIFE

WEDNESDAY APRIL 22

4:30–6:30 pm

Marina

Early Career Committee Sponsored Workshop

The Nuances of New Beginnings: Starting Your Private Practice

Daphny LD Ainslie, Psy.D., *chair*

Dana Charatan, Psy.D.

Paul M. Martin, Psy.D.

Tanya Cotler, Ph.D.

Kristi Pikiewicz, Ph.D.

Dan Livney, Psy.D.

COMBAT PAPER EXHIBIT

Use of Art in Working on Trauma, Loss, Moral Injury

Combat paper exhibit originated when Iraq veteran Drew Cameron cut off his military uniform, shredded, pulped it, and turned it into paper. The handmade paper consists of fragments of war experience.

See this unique and moving exhibit on the Second Floor of the Palace Hotel in Sunset Court.

LIFE IN PSYCHOANALYSIS IN LIFE

THURSDAY APRIL 23

8 am–4pm

French Parlor

Board of Directors Meeting

8–8:50 am

Sutter Boardroom

Colloquy

When an Analyst Lies: False Empathy and its Therapeutic Complexities

When do we lie to protect our patients? When do we lie to protect ourselves? How do we distinguish lying from moments of bracketed subjectivity? This paper will discuss the analyst's gestures of false empathy and deliberate inauthenticity as it lives and functions within the analytic field.

Michelle Shubin, LCSW, BCD

8–9:50 am

Marina

Panel

TH-1 Reproductive Choices: The Intersections of Culture and Women's Lives

This panel integrates research and clinical work at the intersections of culture and women's lives in terms of reproductive options and choices. We will pose crucial questions about the place of cultural values in psychoanalytic practice while exploring these complex choices in women's lives.

Katie Gentile, Ph.D.

The Business of Being Made with Assisted Reproductive Technologies

Rebecca Harrington, LCSW

Childfree Living: Choice vs Circumstance in the Analytic Dyad

Jane Hassinger, MSW

No Baby Without a Mother: Abortion Providers' Attitudes about Their Work

Katie Gentile, Ph.D., *moderator*

LIFE IN PSYCHOANALYSIS IN LIFE

THURSDAY APRIL 23

8–9:50 am

Pacific Heights

Panel

TH-2 Failed Societal Mentalizations of Boys and Young Men Across Racial Lines: Ferguson and Beyond

This panel explores mentalization issues as they effect views of white and black boys throughout the culture. The panel explores the intersection between masculinity, race and mentalization. We look at schools, police departments and in our own field of psychoanalysis.

Warren Spielberg, Ph.D.

Schools and Black Boys: Reciprocal Difficulties in Mentalization

Kirkland Vaughans, Ph.D.

The Police and Black Boys: A Dangerous Inability to Mentalize

William Pollack, Ph.D.

Societal Falure to Mentalize and Mirror a Sense of Healthy Boyhood

Norka Malberg, Ph.D., *discussant*

8–9:50 am

Presidio

Panel

TH-3 Manifesto Fest

Manifesto Fest is a celebration of speaking with love and passion about psychoanalysis to a general audience. Seven panelists will read their manifestos and have a lively exchange with the audience (bring your own!) Manifestos make the obvious public, something psychoanalysis needs to do more.

Esther Sperber, M.S., AAD

From Excite to Insight

Robert Stolorow, Ph.D., Ph.D., ABPP

Grasping Emotional Trauma, Individual and Collective

Tracy D. Morgan, LCSW-R, MPhil

Tiffany McLain, MFTI

Lynne Layton, Ph.D.

Will Braun, Psy.D.

Jill Gentile, Ph.D., *moderator*

8–9:50 am

Sea Cliff

Ethics Committee Invited Panel

TH-18 It's Time We Talked: Personal Encounters with Sexual Boundary Violations

Brief presentations by a senior analyst, candidate, and institute graduate, each exploring the problem of sexual boundary violations in our community. Break out groups will be encouraged to address the community's experience of and response to these violations.

Charles L. Amrhein, Psy.D.

Nancy Crown, Ph.D.

Richard Ruth, Ph.D.

Joyce Slochower, Ph.D., ABPP, *chair*

Elizabeth Goren, Ph.D., *moderator*

9–9:50 am

Sutter Boardroom

Colloquy

Close Analysis of an Excerpt from a Videotaped Supervisory Hour

A supervisory pair invites the audience to view a 15-minute excerpt from a videotape of one of our supervisory hours, in order to identify what makes possible the transition from relational disconnection and “as if” teaching and learning, to connection and authentic teaching and learning.

Joan E. Sarnat, Ph.D., *moderator*

Alexandra Lee, MA, *discussant*

10–11:50 am

Sea Cliff

Panel

TH-4 He Changed My Life!: Freud's Transformative Single Consultation with Margarethe W

This program will describe a newly discovered, dramatic consultation Freud had with an 18-year-old woman. The account raises many questions about analytic technique and authority. Panelists and audience will engage in an interactive discussion of this striking clinical presentation.

Jonathan Slavin, Ph.D.

He Wanted to Learn Something About Me: From Authority to Liberation in Psychoanalytic Work

Steven Kuchuck, LCSW

Analyst in Wonderland: Mapping Freud's Rabbit Hole

Mia Medina, Psy.D.

The Gaze: Mutual Recognition in Freud's Transformative Session

Karen Rosica, Psy.D.

Unsettling, Upsetting and Undoing: The Real Therapeutic Action

Miki Rahmani, MA, *moderator*

LIFE IN PSYCHOANALYSIS IN LIFE

THURSDAY APRIL 23

10–11:50 am

Marina

Panel

TH-5 Brain Camp: A Novel Intervention When a Parent is Ill

A panel presentation discussing a new weekend camp for families where one parent has a brain tumor. The camp is a transitional space for family members to begin to mentalize their experience, deepen bonds, and articulate individual and family strengths to get them through this difficult time.

Abigail L. Marks Ph.D., *presenter and moderator*

Molly Saeger, MFT

Louise Brodie, MFT

Judy Patt Smoker, MSW

10–11:50 am

Pacific Heights

Panel

TH-6 The Moral Third In Psychic and Social Extremity

A dialogue between psychoanalysis and critical social theory relating recognition and denial on the individual level to collective trauma on the social level. By conceiving reparation as connection to a “moral third,” we envision an alternative to the oedipal fantasy that “only one can live.”

Jessica Benjamin, Ph.D.

“Only One Can Live,” Fear of Harming, Need for Repair, in a World where the Third Fails

Celia Brickman, Ph.D.

The Law of Bare Life

Rachel McKay, Ph.D., *moderator*

10–11:50 am

Presidio

Section IX Invited Panel

TH-7 A New Model for Psychoanalytic Thinking and Community Practice: A Live Presentation of Reflective Spaces/Material Places

Join us for a discussion about and experience of Reflective Spaces/Material Places (RS/MP), a thriving Bay Area group that arose at the intersection of psychoanalytic thinking and community mental health practice.

Alice Lowe Shaw, Ph.D.

Elizabeth Kita, Ph.D., LCSW

Mia Maturen, MA

Ryan Parker, Ph.D., LCSW

Francisco Gonzalez, M.D.

Rachael Peltz, Ph.D., *chair*

10 am–12:50 pm

Telegraph Hill

Section I Invited Panel

TH-8 Robert Wallerstein: Sixty-five Years at the Center of Psychoanalysis—A Film and Conversation

In Shelley Nathan's full-length documentary, Robert Wallerstein speaks eloquently of his personal trajectory and the roles he played in the history and politics of psychoanalytic institutions, theory-building, education, and clinical work. His vivid accounts of people, places, intrigues, and controversies give depth and perspective to his thoughts on the present and future of psychoanalytic life. Following the film, the panelists and Dr. Wallerstein will comment further on these themes.

Robert Wallerstein, M.D.

Shelley Nathans, Ph.D.

Stephen Seligman, D.M.H.

Helen Gediman, Ph.D., ABPP

Nancy McWilliams, Ph.D., ABPP

Jane Kupersmidt, Ph.D., *chair and moderator*

12–12:50 pm

Marina

Meet the Author

A Relational Psychoanalytic Approach to Couples Psychotherapy

Philip A. Ringstrom, Ph.D., Psy.D.

This book is premised upon three themes: 1) actualization of self experience in an intimate relationship, 2) capacity for mutual recognition, and 3) "relationship having a mind of its own." This model of conjoint treatment articulates Six Steps wedding theory and practice, steps that function non-linearly as practice guidelines rather than stepwise rules.

12–12:50 pm

Pacific Heights

Meet the Author

Early Encounters with Children and Adolescents: Beginning Psychodynamic Therapists' First Cases

Steven Tuber, Ph.D.

This edited volume includes reports of first long-term clinical cases by graduate students from a psychodynamically informed doctoral clinical psychology program. Each depicted their work with an eye toward their own process of development as the case unfolded.

LIFE IN PSYCHOANALYSIS IN LIFE

THURSDAY APRIL 23

12–12:50 pm

Presidio

Meet the Author

Traumatic Ruptures: Abandonment and Betrayal in the Analytic Relationship

Robin A. Deutsch, Ph.D.

Analyst death, patient suicide and sexual boundary violation disrupt the stability and cohesion of the analytic frame. In *Traumatic Ruptures* an international range of contributors present first-person accounts of their experiences of betrayal and abandonment in the analytic relationship.

12–12:50 pm

Twin Peaks North

Spirituality Committee

12–12:50 pm

Twin Peaks South

Division 39 Fund—Inaugural Grant Recipient

The Talking Cure: Psychoanalysis in the 21st Century

A documentary film that will explore the success of psychoanalysis in the early years of this century, its steady decline, and its rich opportunities for the future.

Professor Anne Dailey, University of Connecticut School of Law, Research Fellow, Western New England Institute for Psychoanalysis

Ann Johnson Prum, Emmy award winning producer and cinematographer, President, Coneflower Studios, a documentary film company

12–12:50 pm

Sutter Boardroom

Section VIII Board Meeting

12–12:50 pm

Sea Cliff

Early Career Psychologists Board Meeting

1–2:50 pm

Telegraph Hill

Section IX Board Meeting

1–2:50 pm

Presidio

Panel

TH-9 Life as a Female Monster

This panel explores issues in female identity and embodiment through the figure of the monster as it appears in film, literature, and clinical case vignettes.

Jenny Marion, MA

Barbara McLeod, MA

Clara Hungr, MA

Life as a Female Monster

Sophia Frydman, MA

Cassie Kaufmann, Ph.D.

Living in This Skin: Monstrous Female Embodiments

Karen Lombardi, Ph.D., *moderator*

1–2:50 pm

Twin Peaks North

Steering Committee Invited Panel

TH-10 The Psychoanalytic Kaleidoscope: Community, Competition, Collaboration

Psychoanalytic training can take various paths: through institutes, internship programs, independent courses, and study groups. Some paths cross, others run parallel, and others collide. How do we work together without tripping over each other? This panel will initiate a discussion on collaborating to meet a diversity of training needs in the midst of an era of increasingly behavioral graduate courses, disappearing psychoanalytic training sites, and growing competition for candidates.

Mary Margaret McClure, D.M.H.

Spanning Decades: Evolution of Psychoanalytic Training in San Francisco

Diane Swirsky, Ph.D.

Outside the Walls: Education and Community Alongside the Institute

Julie Leavitt, M.D.

Bridging Institutional Cultures: Pluralism in the Bay Area's Expanded Psychoanalytic Community

Todd Troutman, Psy.D.

The New Kids on the Block: Training for New Therapists

Greg Clinton, Ph.D., *moderator*

Toni Heineman, D.M.H., *moderator*

LIFE IN PSYCHOANALYSIS IN LIFE

THURSDAY APRIL 23

1–2:50 pm

Marina

Section VIII Invited Panel

TH-11 Same Sex Parenting and Sexual Fantasy Disclosure in Diverse Couples

Two research papers are presented, one exploring disclosure of sexual fantasies in interaction with intimacy in LGBT and heterosexual relationships; the second exploring conscious/unconscious elements in perceived discrepancies in parent-child relationships in gay male parent families equally sharing childcare responsibility.

Shelly Goldklank, Ph.D.

Luis Nobrega, MA, LLM

You, Me, and Fantasy: The Impact of Sharing Sexual Fantasies on Intimacy in Committed Relationships

Emily Seidel, Psy.D.

Queering the Psychoanalytic Family: Same-sex Parents, Role Differentiation, and Psychoanalytic Theories of Maternal and Paternal Functions

Shelley Nathans, Ph.D., *moderator*

Diane Ehrensaft, Ph.D., *discussant*

Suzanne Iasenza, Ph.D., *discussant*

1–2:50 pm

Pacific Heights

Committee on Psychoanalysis and the Community Invited Panel

TH-12 Starting at the Gate: How to Enter as a Community Psychoanalyst

Many contemporary psychoanalysts are bringing their analytic perspective and clinical skills to community based settings. This type of work demands to re-think what is essentially psychoanalytic. Panelists will discuss their work with communities, their entrance to the setting and roles.

Ricardo Ainslie, Ph.D., ABPP

How to Enter a Traumatized Community: My Experience as a Psychoanalyst Attempting to Engage Residents in a Town Ravaged by a Hate Crime

Jane Hassinger, MSW

Building Sustainable Interdisciplinary Collaborations for Building Mental Health Services in Democratic Republic of Congo: A Role for the Community-Based Psychoanalyst

Helen DeVinney, Psy.D.

Serving Marginalized Populations in a Training Clinic: Finding a Postdoctoral Fellowship with a Focus on Training Clinicians in Community-Based Work

Judith Alpert, Ph.D., *co-chair*

Mary-Joan Gerson, Ph.D., *co-chair*

1–2:50 pm

Sea Cliff

Panel

TH-13 White-Washed: The Lived Experience of Trainees of Color in a Psychoanalytic Training Program

This panel will explore the lived experiences of trainees of color as they pursue a profession in psychoanalytic psychology. Suggestions for how analytical institutes could better address and integrate racial and cultural conundrums within their training program will be discussed.

Omyda Hernandez, Ph.D.

Dare to Speak: Negotiating Ethnic and Racial Micro-Aggressions Within the Supervisory Relationship

Gregory Desierto, Psy.D.

Sitting Together, But Not Eating Together: Cultural Conundrums in Group Process

Maneesh Saini, MA

Is it Privilege or Just Personal? A Person of Color's Struggles for Self Expression in a Psychoanalytic Workgroup

Geetali Chitre, MA

More Than a Token: Professional Identity Development in Training Groups as a Person of Color Trainee

Omyda Hernandez, Ph.D., *moderator*

3–3:50 pm

Sutter Boardroom

Committee on Psychoanalysis and the Community Board Meeting

3–3:50 pm

Presidio

Colloquy

Disability, Deviance, and Our Vulnerability

In this presentation I discuss main themes in the Disability Studies literature, suggest reasons for the absence of these ideas in the psychoanalytic literature, and discuss how our own vulnerability as “Temporarily Able Bodied” individuals causes us to turn away from theorizing disability.

Christina Emanuel, Psy.D.

LIFE IN PSYCHOANALYSIS IN LIFE

THURSDAY APRIL 23

3–4:50 pm

Sea Cliff

Section III Invited Panel

TH-14 Women as Objects of Exchange in Life and Psychoanalysis

Women as Objects of Exchange in Life and Psychoanalysis: Hook-Ups, Sex Slaves, Nannies, Maids, and Analysts This intermediate-level panel will explore our social progress since the 1970s, when feminists denounced the concept of women as objects of exchange and instead urged them to own their bodies and speak their minds.

Doris Silverman, Ph.D.

A Revolutionary Call About Female Sexuality

Adrienne Harris, Ph.D.

The Trafficking of Persons

Carlotta Miles, M.D.

Perspectives on Assumed Female Subservience: The Nanny, the Maid, the Docile Wife, the Female Psychoanalyst

Steven Botticelli, Ph.D.

Women, Psychoanalysis and the Provision of Care

Ellen Toronto, Ph.D.

The Evolution of Women in Division 39

Diana Diamond, Ph.D., *chair*

JoAnn Ponder, Ph.D., *moderator*

3–4:50 pm

Pacific Heights

Panel

TH-15 Disavowed Cultural Trauma (Anti-Semitism/The Third Reich): Reverberations In Psychoanalytic Life

This panel examines unprocessed elements in Freud's reaction to anti-Semitism during his lifetime and compromising moral behaviors of some psychoanalysts under the Third Reich. It hopes to engage the audience in a dialogue, registering history and pondering implications.

Kris Yi, Ph.D., Psy.D.

Freud's Cultural Decontextualization and the Ethnic Minority Patient

Arlene (Lu) Steinberg, Psy.D.

WW2's Absent Witness: Psychoanalysis and the Disavowal of Real Life Traumatic Experience and of History

Kris Yi, Ph.D., Psy.D., *chair*

Jill Salberg, Ph.D., *discussant*

3–4:50 pm

Telegraph Hill

Graduate Student Committee Invited Panel

TH-16 Graduate Student Committee Live Supervision

The panel will consist of an “in vivo” or live supervision in which a graduate student intern will present a case to a senior supervisor, with a specific focus on diversity issues. The 45-50 minute supervisory session will be followed by panelist and audience discussion.

Jason M. Thompson, MS, *moderator*
Mahima Muralidharan, Psy.D.
Ashley Carreras, MS
Anna Zozulinsky, MS

3–4:50 pm

Marina

Steering Committee Invited Panel

TH-17 From the Couch to the Playground: School-based Psychotherapy with Children

In the early 20th century, the first psychoanalytic treatment of a child was conducted in the child’s home. Soon after, the venue was moved to the clinical office. A century later, psychoanalytic treatment has spilled into the community and across social classes and in doing so, has by necessity, extended the boundaries well beyond the confines of the consultation room. This panel explores the movement of psychoanalytic treatment into the community from the perspective of two child clinicians, operating in school based and community venues and an educator and school principal.

Michelle Baker, MFT
Sharif Okasha, Psy.D., *discussant*
Jean Roberston, Principal, *discussant*
Andrew Harlem, Ph.D., *moderator*
Wendy von Wiederhold, Ph.D., *moderator*

4–4:50 pm

Presidio

Combat Paper Exhibit

Use of Art in Working on Trauma, Loss, Moral Injury

Combat paper exhibit originated when Iraq veteran Drew Cameron cut off his military uniform, shredded, pulped it, and turned it into paper. The handmade paper consists of fragments of war experience. See this unique and moving exhibit on the Second Floor of the Palace Hotel in Sunset Court..

Donna Bassin, Ph.D., mental health/research advisor for Combat Paper, NJ
Drew Cameron, creator of the Combat Paper Project

4–4:50 pm

Sutter Boardroom

Committee on Education and Clinical Training Board Meeting

LIFE IN PSYCHOANALYSIS IN LIFE

THURSDAY APRIL 23

5–6:30 pm

Ralston Ballroom

President's Address and Awards Ceremony

Awards Chair: Mary-Joan Gerson, Ph.D.

Award Recipients:

Leadership Award: Richard Ruth, Ph.D.

Diversity Award: Usha Tummala-Narra, Ph.D.

President's Address: Marilyn Charles, Ph.D., ABPP

The Future of Psychoanalysis

Awardees



Richard Ruth, Ph.D., ABPP, is associate professor of clinical psychology and director of clinical training at the psychodynamically oriented Psy.D. program at The George Washington University and on the steering committee of the Child and Adolescent Psychotherapy Program at the Washington School of Psychiatry. A clinical psychologist, a psychoanalyst, a family therapist, and a neuropsychologist, he has served Division 39 as an APA Council representative and in other capacities. His publications have addressed trauma, disability, cross-cultural, and LGBT issues. Dr. Ruth is proud to be part of the first generation of legally married gay men, and deeply honored to receive an award from the Division he has come to love.



Usha Tummala-Narra, Ph.D. is an Associate Professor in the Department of Counseling, Developmental and Educational Psychology at Boston College. She is also in Independent Practice in Cambridge, MA, and a Teaching Associate at the Cambridge Health Alliance. She served as the Founding Director of the Asian Mental Health Program at Cambridge Health Alliance, and the Co-Director of the Trauma and Loss Program at Georgetown University Hospital. She has presented nationally and published peer reviewed journal articles and book chapters on the topics of immigration, ethnic minority issues, trauma, and psychoanalytic psychotherapy. She is a recipient of the Collaborative Fellows Grant from the Lynch School of Education at Boston College. Her research focuses on the experiences of race and immigration among youth and adults, and on the experience of traumatic stress among immigrant communities. She is the recipient of the American Psychological Association Division 39 2013 Johanna Tabin Book Proposal Prize, and her book concerning culturally informed practice from a psychoanalytic perspective is forthcoming. Dr. Tummala-Narra has served as the chair of the Multicultural Concerns Committee for Division 39 (Psychoanalysis), as a member of the Committee on Ethnic Minority Affairs (CEMA) in the American Psychological Association, and as a member of the APA Presidential Task Force on Immigration. She is currently Member-at-Large on the Board of Directors of APA Division 39.

6:30–8 pm

Sunset Court

Welcome Reception

LIFE IN PSYCHOANALYSIS IN LIFE

ADDENDUM

FRIDAY, APRIL 24,

10–11:50 am

Telegraph Hill

Committee on Sexualities and Gender Identities Invited Panel

Kink: In the Mind and Body of the Beholder

Kink sexual practices are typically considered unconventional means of heightening intimacy. Some distinguish “kind” from “fetishism,” defining the former as enhancing intimacy, and the latter as replacing it. Definitions of kink vary widely. The panelists explore kink from a non-pathologizing perspective, addressing briefly the theoretical and clinical and identifying important countertransference issues.

Jackson Taylor, M.A.

Romy Reading, Ph.D.

Muriel Dimen, Ph.D.

Avgi Saketopoulou, Psy.D.

Scott D. Pytluk, Ph.D., *co chair*

Shara Sand, Psy.D., *co chair*

LIFE IN PSYCHOANALYSIS IN LIFE

FRIDAY APRIL 24

8–8:50 am

Telegraph Hill

Colloquy

The Subjective Experience of Time, and Time as an Internal Object, in Psychoanalysis, Argentine Tango, and in Life

This presentation focuses on experiences of time subjectively emerging in visceral, cognitive, emotional dimensions of internal worlds. Examples of clinical work and Argentine tango are used, along with a guided meditative visualization.

Susan Kavalier-Adler, Ph.D., ABPP, D.Litt.

8–9:50 am

Twin Peaks North

Section IX Special Meeting

8–9:50 am

Presidio

Section IV Senate Meeting

8–9:50 am

Marina

Committee on Psychoanalysis and Healthcare Invited Panel

FR-1 The Mind and Body in Pain: Psychoanalytic Work and the Phenomenology of Suffering

This symposium explores the experience of pain in the work of the psychoanalytic therapist. A history of psychosomatic psychoanalytic practice will be followed by case presentations detailing psychoanalytic work with patients with both physical and emotional pain.

Marilyn Jacobs, Ph.D., ABPP

The Phenomenology of Suffering: Treating the Mind and Body in Pain

Ruth Livingston, Ph.D.

The Most Painful Pain

Maureen Murphy, Ph.D.

The Body Pays: Somatic Consequences of Multiple Traumas

Judith Alpert, Ph.D., *moderator*

LIFE IN PSYCHOANALYSIS IN LIFE

FRIDAY APRIL 24

8–9:50 am

French Parlor

Section V Invited Panel

FR-2 The Disappearance of Psychoanalytic Thinking from the Public Sector: Definite Problems, Possible Solutions

This panel will explore the current professional climate and propose a training initiative intended to assess and reassert the value of psychoanalytically oriented theory, research, supervision, and practice, particularly for public sector facilities.

Larry Rosenberg, Ph.D.

The Disappearance of Psychoanalytic Thinking from the Public Sector: Definite Problems, Possible Solutions

Diana Diamond, Ph.D.

A Psychoanalyst's Reflections on Working in a Manualized Treatment

Barry Dauphin, Ph.D.

Maintaining a Psychodynamic Focus in a University Setting

Stephanie Creeksbaum Psy.D.

A Fish Out of Water: A Psychodynamic Student in a Non-Psychodynamic World

Ghislaine Boulanger, Ph.D., *moderator*

8–9:50 am

Pacific Heights

Committee on Multicultural Concerns Invited Panel

FR-3 Marginalization & Trauma in the Psyche: Working with Parents and Children of Color

This panel explores two related themes of parenting for people of color and the crises of children of color, especially black boys in contemporary America. This panel is geared towards audience participation and dialogue on psychodynamics of class and race and treatment considerations.

Alicia Lieberman, Ph.D.

“Ghost in the Nursery”: Trauma-Informed Therapy for Parents and Children of Color

Kirkland Vaughans, Ph.D.

Is Psychoanalysis Relevant to the Crises of Black Boys?

Kris Yi, Ph.D., Psy.D., *chair*

Norka Malberg, Psy.D., *discussant*

Ricardo Ainslie, Ph.D., ABPP, *discussant*

8–9:50 am

Sea Cliff

Panel

FR-4 Taking It to the Streets: Psychoanalysis Alive and Kicking, Yo!

This discussion panel invites audience members to join the presenters in ethnography of sorts: research into the sophisticated use of psychoanalytic concepts in popular culture and grass roots mental health interventions.

Stephen Hartman, Ph.D.

Panti Bliss: Gender Discombobulator/Accidental Psychoanalyst

Elizabeth Kita, Ph.D., LCSW

Perpetrators and Perpetuators / Mr. Poorbear Me

9–9:50 am

Telegraph Hill

Colloquy

Winnicott's Search for the Life that Feels Real

We explore Winnicott's theory of true and false self, how it emerged from his own life, and its relevance to our work with our patients and to our own lives.

James W. Anderson, Ph.D.

Lucy Freund, Ph.D., *moderator*

Joyce Slochower, Ph.D., ABPP, *discussant*

10–10:50 am

French Parlor

Committee on Psychoanalysis and Health Care Board Meeting

10–11:50 am

Sutter Boardroom

Section II Board Meeting

10–11:50 am

Sea Cliff

Panel

FR-5 Unanalyzed Life: Cultural and Developmental Issues That an Analyst Rarely Notices

Panelist will present short vignettes, from our own lives or those of our patients, in which cultural issues of Real Life that are rarely considered in analysis played a part. Then we will invite participants and audience to discuss ways the treatment might evolve should these aspects be analyzed.

Jill Bellinson, Ph.D.

Karen Rosica, Psy.D.

Lawrence Zelnick, Psy.D.

LIFE IN PSYCHOANALYSIS IN LIFE

FRIDAY APRIL 24

10–11:50 am

Marina

Committee on Humanities and Psychoanalysis Invited Panel

FR-6 Encountering the Beat Generation: An Interdisciplinary Discussion

Arguably, the “home” of the Beat Generation was San Francisco. This panel, taking place in San Francisco as it does, will focus on the meaning the Beats had and still have in American culture and society. The discussants include professors of literature and philosophy as well as psychoanalysts.

Jonah Raskin, Ph.D.

Psychoanalyzing the Beats

Emillee Kutash, Psy.D., Ph.D.

In the Presence of Absence: And the Beat Goes On

K. William Fried, Ph.D.

Personal Encounters with the Beat Generation

Henry M. Seiden, Ph.D., ABPP, *moderator and discussant*

10–11:50 am

Presidio

Panel

FR-7 Screen Shots: The Digital Life—How it Transforms Psychoanalytic Process in Children and Adolescents

“Screens” have transformed the lives of our child and adolescent patients, both outside and in the consulting room. This panel will explore the ways in which treatment has changed and remains the same in the digital world.

Seth M. Aronson, Psy.D.

Can You See the Real Me?

Susan Goodman, LCSW

Boundaries and Bridges: Expanding the Frame

Tammy Kaminer, Ph.D.

Protecting Transitional Space in a Digital World (or Why My Teddy Bear Won't Surf the Net)

Norka Malberg, Psy.D.

Beyond the Screen: Technology and the Child Psychoanalytic Frame

Seth M. Aronson, Psy.D., *moderator*

10–11:50 am

Pacific Heights

Panel

FR-8 Psychoanalysis Dead Alive: The Impact of Death Anxiety on Theory and Practice

A group of four early career clinicians come together to think about the way our focus on life is a response to the current and pervasive anxieties about the death of psychoanalysis. Taking into account notions of unconsciousness, we explore the fundamental paradox of the dead alive in our field.

Loong W. Kwok, Psy.D., *presenter and moderator*
Willow Banks, MA
Daniel Butler, MA
Mia Maturen, MA

10 am–12:50 pm

Twin Peaks North

Steering Committee Invited Panel

FR-9 Trauma and Resilience: A Viewing of Film “Sweet Dreams” and Dialogue with the Filmmaker

Exclusive film screening and interview with Academy Award winning filmmaker Lisa Fruchtman, director of “Sweet Dreams,” a portrait of struggle and resilience. The film shows a remarkable group of Rwandan women who emerge from the devastation of the genocide to create their own unique path to a future of peace and possibility.

Lisa Fruchtman, *filmmaker, director and producer of “Sweet Dreams”*
Rachael Peltz, Ph.D., *interviewer*
Alice Lowe Shaw, Ph.D., *moderator*

12–1:30 pm

Ralston Ballroom

Scholars Reception

12–12:50 pm

French Parlor

Meet the Author

Screen Relations: The Limits of Computer-Mediated Psychoanalysis and Psychotherapy

Gillian Isaacs Russell, Ph.D.

Synthesizing the fields of informatics, neuroscience, communication studies, infant development and psychoanalysis, the author draws on her own clinical experience of mediated treatments and an extensive ethnographic study to explore the limits of technologically-mediated treatment.

LIFE IN PSYCHOANALYSIS IN LIFE

FRIDAY APRIL 24

12–12:50 pm

Telegraph Hill

Meet the Author

Underworlds: Philosophies of the Unconscious from Psychoanalysis to Metaphysics

Jon Mills, Psy.D., Ph.D., ABPP

The first book of its kind to provide a detailed analysis of the history of the unconscious... from the underworlds of Greek and Egyptian mythology to psychoanalysis and metaphysics, this is a unique study of differing philosophies of the unconscious.

12–12:50 pm

Presidio

Meet the Author

Structure and Spontaneity in Clinical Prose: A Writer's Guide for Psychoanalysts and Psychotherapists (Routledge, 2015)

Suzi Naiburg, Ph.D., LICSW

This is an “extended writing seminar” that has been field tested in more than fifty clinical writing workshops for new and experienced writers. It is the culmination of twenty years of teaching, coaching, and editing combined with my passion for literature, my respect for what words can do, and my training as a literary critic and psychoanalyst.

12–12:50 pm

Sea Cliff

Meet the Author

Loneliness in Philosophy, Psychology and Literature

Ben L. Mijuskovic, Ph.D.

Where behaviorism claims that loneliness is caused by external conditions—environmental cultural, situational, and even chemical imbalances in the brain, and is therefore transient and avoidable; by contrast, I contend that it is innate because it is constituted by the intrinsic activities and structures of self-consciousness, and therefore permanent and unavoidable.

12–12:50 pm

Twin Peaks South

Meet the Author

The Stories We Live: Life, Literature, and Psychoanalysis

Marilyn Charles, Ph.D., ABPP

Sandra Ullman, Ph.D., *moderator*

Literature explores the deeper questions that face us all. This volume uses material from literature alongside clinical work as a way of highlighting salient issues and developmental passages that can be understood, explored, and worked through from a psychoanalytic perspective.

12–12:50 pm

Marina

Meet the Author

The Interpersonal Tradition: The Origins of Psychoanalytic Subjectivity

Irwin Hirsch, Ph.D.

The author will trace the origins of the shift in psychoanalysis from a model of analyst as objective scientist to one of the analyst as inherently subjective other.

12–12:50 pm

Sutter Boardroom

Psychoanalytic Psychology

Meet the New Editors

Elliot Jurist, Ph.D., Ph.D., *editor Psychoanalytic Psychology*

This noon salon is an opportunity to meet and welcome the new editors working with Elliot Jurist, Editor: Kevin Meehan and Johanna Malone, Associate Editors, and Lutz Wittmann, International Editor. The editors will answer questions about their interests and their hopes for the future of the Journal, discuss how to publish in the Journal, and entertain any ideas or feedback from the attendees about the Journal.

12–12:50 pm

Pacific Heights

Meet the Author

Micro-Trauma: A Psychoanalytic Understanding of Cumulative Psychic Injury

Margaret Crastnopol, Ph.D.

Until now, psychoanalysis has explained such negative influences in broad strokes, using general concepts like psychosexual urges, narcissistic needs, and separation-individuation aims, among others. This fresh approach identifies certain specific patterns of injurious relating that cause damage in predictable ways; how these destructive processes can be identified, stopped in their tracks, and replaced by a healthier way of functioning.

1–1:50 pm

Twin Peaks North

Colloquy

Montage in Film and on the Couch: What We Learn from Cinema

Similarities between film montage and functions of a psychoanalyst in the therapeutic session are addressed. Clinical examples are given, along with visual examples from film, advertisements and news images aimed at creating particular thoughts, images, sentiments.

Albert J. Brok, Ph.D.

Montage in Film and the Analytic Session

K. William Fried, Ph.D.

Ellen Gussaroff, Ph.D.

LIFE IN PSYCHOANALYSIS IN LIFE

FRIDAY APRIL 24

1–1:50 pm

Twin Peaks South

Colloquy

Winnicott Goes Viral: Transitional Space in Viral YouTube Baby Videos

Charlie Bit my Finger! Using a detailed analysis of viral baby and toddler videos, posted by parents and publicly found on YouTube, the interplay between two distinct types of transitional phenomena will be proposed. Case examples will be provided to demonstrate the clinical use of those ideas.

Orit Weksler, MA, MFT

Gary Whitmer, LCSW, *discussant*

1–2:50 pm

Sea Cliff

Accreditation Council for Psychoanalytic Education (ACPE)

Accreditation Inside Out: How the Accreditation Process Works for Psychoanalytic Programs and Site Visit Volunteers

This is a training session for institutes interested in applying for accreditation.

Sheila Hafter Gray, M.D.

1–2:50 pm

Telegraph Hill

Research Committee Invited Panel

FR-10 What We Learn About Analysis from Outcomes and Follow-Ups from Both Sides of the Atlantic

Outcomes from a long-term Finnish study of psychoanalyses, and from a study of 24 fully recorded American cases from the Psychoanalytic Research Consortium, plus follow-up information from those patients who continue intermittent work after their analyses, often for many years, will serve as sparks for discussion and contributions from participants of the panel and the audience.

Sherwood Waldron, M.D.

“A Long Tail”: Psychotherapy for Years after Analysis

Francesco Gazzillo, Ph.D.

Early Indicators of Psychoanalytic Outcome

Erkki Heinonen, Ph.D.

Therapists’ Characteristics as Predictors of Outcome

Sherwood Waldron, M.D., *moderator*

1–2:50 pm

French Parlor

Section II Invited Panel

FR-11 Psychoanalysis in the Lives of Immigrant Children, Their Families and the Mental Health Professionals Supporting Them

Panelists explore the experience of psychodynamic psychologists working with immigrant children and families, from multiple lenses (developmental, clinical and cultural), stimulating a dialogue highlighting importance of integration, value of clinical formulation, and occurrence of parallel process occurring during this work.

Norka T. Malberg, Psy.D.

Psychoanalysis in the Lives of Immigrant Children, Their Families and the Mental Health Professionals Supporting Them

Alicia Lieberman, Ph.D.

The Stories We Hold: Vicarious Traumatization in Clinical Practice and Supervision

Vilma Reyes, Psy.D.

Building Bridges: A Community Based Intervention with Latina Mothers

Chuntao German Cheung, Psy.D.

Learning to Speak Chinese Right... Again

Mary Margaret McClure, D.M.H.

Psychoanalytically Informed Consultation in the Trenches

Norka T. Malberg, Psy.D., *moderator*

1–2:50 pm

Presidio

Panel

FR-12 Janus-Faced: The Destructive and Protective Potentials of Shame and Shamelessness

This panel will explore the destructive and constructive aspects of shame and shamelessness as they play out both in our professional lives with patients and in our own personal lives.

Margaret Crastnopol, Ph.D.

On “Cruising to be Bruised”—The Compulsion to Re-shame Oneself

Peter Shabad, Ph.D.

“Every Profound Spirit Needs a Mask”: Shame Exposure and its Cover-Up

Sandra Buechler, Ph.D.

’Tis the Gift to be Simple: Humility, Shame, and Shamelessness

Nancy McWilliams, Ph.D., ABPP, *moderator*

LIFE IN PSYCHOANALYSIS IN LIFE

FRIDAY APRIL 24

1–2:50 pm

Pacific Heights

Panel

FR-13 Breathing New Life Into Psychoanalysis Through Community-Based Research

This panel brings together three psychoanalysts to discuss their community-based, research projects. As the panelists dialogue with each other and the audience, they will demonstrate how participatory action research methods can expand the life of psychoanalysis through community involvement.

Katie Gentile, Ph.D.

A Perfect Union? Participatory Action Research, Psychoanalytic Engagement and Affect Theory

Jane Hassinger, MSW

Women On Purpose: Psychoanalytically-informed Participatory Action Research with Communities of South African Papermakers

Michael O’Loughlin, Ph.D.

Developing a Participatory Action Research Approach to Characterizing Chronic Psychiatric Suffering in the Lives of Patients

Katie Gentile, Ph.D., *moderator*

2–3:50 pm

Twin Peaks North

Steering Committee Invited Panel

FR-14 Playing and Cyber-Reality: Emotional Development and Transitional Space Online

“Cultural experience begins with creative living first manifest in play,” wrote Winnicott. “How will we live and play creatively in a future where time and space are fungible?” wonders a psychoanalyst who walks into a bar and encounters a philosopher, a futurist, and a colleague. The tech-guy demonstrates *Ingress*, an app-based game that brings strangers together in public space. The panelists have a field day imagining how playing and reality combine in cyber-transitional space.

Matthieu de Fayet

Phillip Freeman, M.D., D.M.H.

John Hanke, MBA

Stephen Seligman, D.M.H.

Stephen Hartman, Ph.D., *moderator*

Loong Kwok, Psy.D., *moderator*

2–3:50 pm

Sutter Boardroom

Section V Board Meeting

3–3:50 pm

French Parlor

Colloquy

From the Trenches to the Margins: Psychoanalysis and War Trauma, History and Current Prospects

This Colloquy uses the hundredth anniversary of World War I to explore a century of psychoanalytic response to war trauma. One presentation focuses on the origins of this intersection in World War I, while the second examines current psychoanalytic approaches to war in the VA system.

Ania Wertz, Psy.D.

Learning from Experience in the Great War: Wilfred Bion and William Alanson White

Susan Maxwell, Psy.D.

Group Experience and Dissociative Trauma: New Prospects for the Psychoanalytic Treatment of War Trauma

3–3:50 pm

Pacific Heights

Colloquy

The Experience of Uncertainty: What the Film “Doubt” Can Teach Us About Psychoanalysis

Through watching and discussing a brief series of key scenes from the 2008 film *Doubt*, this paper/colloquy will explore a perennial dialectic and question in psychoanalysis, as well as life—namely, how it is we come to understand tolerate and reconcile disparate realities and experiences.

David D. Kemmerer, Ph.D.

3–3:50 pm

Presidio

Colloquy

Moving the Metaphor of Dance: Bringing Creative Embodiment to Life!

At the intersection of dance as a metaphor and dancing in life, is a creative psychophysical movement process and opportunity available for mobilizing somatic countertransference. Pioneer into your body’s resonance by advancing into felt and unfelt tensions to access muscle memory and wisdom.

Nancy Goldov, Psy.D.

Beth Kalish-Weiss, Ph.D., *discussant*

3–3:50 pm

Marina

Stephen Mitchell Award Presentation

Theoretical Diversity and Pluralism in Psychoanalysis: Change, Challenges and Benefits

Celeste Birkhofer

Elliot Jurist, Ph.D., Ph.D., *chair*

LIFE IN PSYCHOANALYSIS IN LIFE

FRIDAY APRIL 24

3–3:50 pm

Sea Cliff

Colloquy

Embodying Desire in a Gendered World: The Gendering of Desire in Life and Psychoanalysis

We form identifications with important others' ways of embodying desire. Identifications with desire intersect with identifications with gender as we construct ourselves as subjects of both. Clinical and personal illustrations will be provided and audience discussion will be encouraged.

Lynne Harkless, Ph.D.

4–5:30 pm

Grand Ballroom

Keynote Address

FR-15 Dance, Psychoanalysis, and the Nitty-Gritty of Life: A Conversation with Choreographer Joe Goode



Joe Goode

Joe Goode Performance Group
Professor, Department of Theater, Dance and Performance Studies,
University of California, Berkeley

Psychoanalysis has long sought to interpret the body—the cradle of desire, the repository of trauma. We know the body speaks: the stories we tell and the meanings we make emerge from our living, moving flesh. Joe Goode personifies this knowledge. More than any contemporary choreographer, he strives to integrate dance, spoken word, music and song to tell a story of human experience. Join us as we explore Joe's art together and find inspiration for an enlivened, embodied psychoanalysis.

Bart Magee, Ph.D., *moderator*

5:30–6:15 pm

Presidio

Graduate Students Workshop I

Joe Goode

5:30–6:30 pm

Presidential Suite

Candidates Reception

6–8 pm

Marina

Reception Section I

6:30–8:30 pm

Sea Cliff

President's Reception for Graduate Students, Candidates and Early Career Psychologists

LIFE IN PSYCHOANALYSIS IN LIFE

SATURDAY APRIL 25

7–8:50 am

Sea Cliff

Section IV Open Meeting

7:30–9 am

Twin Peaks South

Division 39 Wiki Project

Help improve psychoanalytic information on Wikipedia! Join the co-chairs for coffee and discussion about how you can help as an Article Editor and/or a Content Consultant. Graduate students and faculty are especially encouraged to attend.

Lewis Aron, Ph.D., ABPP
Ari Pizer, MMT

8–9:50 am

Sierra

Section III Board Meeting

8 am–noon; 1–4 pm

Monterey

American Board and Academy of Psychoanalysis (ABAPsa) Board Meeting

8–9:50 am

Presidio

Panel

SA-4 A Weave of Words: Writing Psychoanalysis, Writing Fiction

What sort of writing is psychoanalytic writing? What is the relation between the analyst's writing voice and the voice(s) in the session? Two writers engage each other and their work: a novelist familiar with psychoanalysis, a psychoanalyst with an interdisciplinary background.

Anne Germanacos, MFA
Muriel Dimen, Ph.D.
Toni Heineman, D.M.H., *moderator*

LIFE IN PSYCHOANALYSIS IN LIFE

SATURDAY APRIL 25

8–9:50 am

Pacific Heights

Panel

SA-1 Mothering the Mother: Encounters with the Real and Ideal

Our four panelists practice both as psychoanalytically-oriented psychotherapists and as educators at hospital-based postpartum programs for new mothers. Our dual roles compel us to think about what new mothers need, and the psychotherapeutic techniques that most effectively meet their needs.

Daphne de Marneffe, Ph.D.

Therapeutic Action and New Motherhood: What is Most Helpful to New Mothers?

Meg Earls, Psy.D.

Institutional Programming for New Mothers: When the “Idealized Mother” Collapses the Space for Women’s Real Needs

Juli Fraga, Psy.D.

Maternal Holding & Containment in the Group Setting

Leigh Lyndon, Psy.D.

Am I Good Enough?—Managing Anxieties in Mothers and as Clinicians

Mary Margaret McClure, D.M.H., *moderator and discussant*

8–9:50 am

Marina

Panel

SA-2 An Ojibwe Transman’s Journey: A Culturally Rooted Transformation

I met Tirz as a lesbian, he then transitioned to Giizhig. His Native American identification with two-spiritness was a uniquely important part of his transition. There will be a case presented and a discussion/performance by a Mohawk ethnomusicologist, and 2 analytic clinicians, 1 a transman.

Shara Sand, Psy.D.

An Ojibwe Transman’s Journey: A Culturally Rooted Transformation

Kellen Grayson, Psy.D.

Open Discussion of Transgender Factors and Psychoanalytic Models

Dawn Avery, Ph.D.

Open Discussion of Native American Traditions and Performance Video

Sandra Kiersky, Ph.D.

Open Discussion of Psychoanalytic Aspects of the Clinical Material

8–9:50 am

Telegraph Hill

Early Career Psychologists Committee Invited Panel

SA-3 Developing an Analytic Identity: Does Psychoanalysis Need to Become One's Life?

This Early Career Committee panel will focus on developing an analytic identity as an early career person joining the field. Specifically, we will take up questions about whether or not psychoanalysis needs to “become your life” when identifying as a psychoanalytically-oriented professional.

Stephen Lugar, Psy.D.

Whose Life is it Anyway? Unpacking Analytic Connections as an Early Career Clinician

Dan Livney, Psy.D.

The Sorcerer's Apprentice, Darth Vader, and Other (More Favorable) Forms of Psychoanalytic Fathering

Tiffany McLain, MFTI

Doing Away with the “Analytic Ideal”: One Clinician's Dalliances Within the Margins of Psychoanalysis

Trisha A. Ready, Ph.D., *moderator*

8–9:50 am

Twin Peaks North

Panel

SA-5 The Psychoanalysis of Everyday Life—Groceries, Parenting, Virtuality, and Reverie

How does psychoanalytic theory live and breathe outside the consulting room? Virtual space, the vicissitudes of parenting, the mundane reverie of a moment, and breakfast cereals will fall under the psychoanalytic gaze in exploration of growth potential and expansion of subjectivity.

Gregory Stevens, Ph.D.

Dreaming New Days: Transforming the Mundane Through Interpreting Everyday Reverie

Kimberly Korobov, MA, MDiv

Partnering as Parents: The Truth-Event of Love in the Contentious Life of Family

Megan Kolano, Psy.D.

Fantasy and Desire in the Simulacrum

Dan Rose, Psy.D.

Frosted Flakes and Orphans of The Real: Castration and the Psychoanalytic Character

Megan Kolano, Psy.D., *moderator*

LIFE IN PSYCHOANALYSIS IN LIFE

SATURDAY APRIL 25

10 –11:30 am

Grand Ballroom

Keynote Address

SA-6 Vicarious Traumatization: A Dialogue with Ghislaine Boulanger and Stephen Xenakis



Ghislaine Boulanger, Ph.D.

Ghislaine Boulanger is a psychologist and psychoanalyst in private practice in New York City and a member of the Relational faculty at New York University's Postdoctoral Program in Psychotherapy and Psychoanalysis. She is currently president and president elect of Section V, the Section for Applied Clinical Psychoanalysis of Division 39 and on the board of Section IX of Division 39, Psychoanalysts for Social Responsibility. Previously, with Ruth Fallenbaum, she was co editor of the Section IX newsletter, *The Psychoanalytic Activist*. Since the publication of her book, *Wounded by Reality: Understanding and Treating Adult Onset Trauma*, Dr. Boulanger has taught and published extensively on the psychodynamic dilemmas facing adults who have survived violent and life threatening events, and on the consequences for the clinicians who work with them. The latter is the topic of this keynote conversation.



Stephen Xenakis, M.D.

Brigadier General (ret.), Chief Medical Officer, MindCare Solutions, Nashville, TN

Dr. Xenakis is a psychiatrist with an active clinical and consulting practice. He is the Founder of the Center for Translational Medicine that develops treatments and conducts tests on brain related conditions affecting soldiers and veterans. He has been a senior adviser to the Department of Defense on a wide range of issues concerning the care and support to service members and their families. Retiring at the rank of brigadier general, he served 28 years in the United States Army as a medical corps officer. Dr. Xenakis has written widely on medical ethics, military medicine, and treatment of detainees, including book chapters and legal reviews and appears regularly on national radio and television. He is currently working on the clinical applications of quantitative electroencephalography (QEEG) to brain injury and neurobehavioral conditions and promoting integrative care programs for veterans. Dr. Xenakis is an Adjunct Professor at the Uniformed Services of Health Sciences of the military medical department. He is a graduate of Princeton University and the University of Maryland School of Medicine.

Ruth Fallenbaum, Ph.D., *moderator*

11:30 am–noon

Grand Ballroom

Graduate Student Workshop II

Ghislaine Boulanger, Ph.D. and Stephen Xenakis, M.D.

12–12:50 pm

Twin Peaks North

Scholarship and Research Award

Recipient: **William H. Gottdiener, Ph.D.**

Paper: **Psychoanalysis and Addiction**



William H. Gottdiener, Ph.D., is a tenured full professor of psychology at John Jay College of Criminal Justice of the City University of New York (CUNY) and director of training of the college's clinical psychology doctoral program and the addiction studies program. Dr. Gottdiener received his Ph.D. in clinical psychology in 2000 from The New School for Social

Research in New York and subsequently completed a postdoctoral fellowship in substance abuse research funded by the National Institute on Drug Abuse. He has published over 35 articles and book chapters and is the recipient of research grants from the National Institute on Drug Abuse, CUNY, and the Far Fund. He is on the editorial boards of *Psychoanalytic Psychology*, the *Journal of the American Psychoanalytic Association*, and *Addiction Research and Theory*. Dr. Gottdiener has been a visiting scholar at The Austen Riggs Center and St. Luke's-Roosevelt Medical Center in New York City. He is also the recipient of awards for teaching excellence and student mentoring. He is an APA Fellow in the divisions of psychoanalysis, addictions, and general psychology; a Fellow of the International Psychoanalytic Association and an active member of the American Psychoanalytic Association. His research interests focus on personality and psychodynamic factors that contribute to the development, maintenance, and treatment of substance use disorders. Last, he maintains a private practice in individual psychotherapy, psychoanalysis, psychological assessment, and clinical supervision.

Awards Committee Chair: Mary-Joan Gerson, Ph.D.

1–1:50 pm

Off site

Committee on Sexualities and Gender Identities Board Meeting

LIFE IN PSYCHOANALYSIS IN LIFE

SATURDAY APRIL 25

1–2:50 pm

Pacific Heights

Panel

SA-7 Illness in Life, Illness in Treatment: Differences Between Patients and Therapists in Thinking about Patient Illness

Different understanding about ostensibly objective illness states afford opportunities to explore often unconscious beliefs about illness, care, pain, and cure.

Jay Crosby, Ph.D.

Brian Smith, Ph.D.

Nirav Soni, Ph.D.

Joseph Newirth, Ph.D., *moderator*

1–2:50 pm

Presidio

Panel

SA-8 When the Personal is Professional: Love, Work, and the Spaces in Between

This panel and roundtable will explore the impact of the psychoanalyst's life experience and psychology on the treatment. Senior analysts will present brief papers, followed by a roundtable discussion and audience Q and A.

Steven Kuchuck, LCSW

On the Psychoanalyst's Subjectivity: Introduction to the Panel

Irwin Hirsch, Ph.D.

The Person of the Analyst and the Impact on Analytic Process

Joyce Slochower, Ph.D., ABPP

Analytic Authenticity: Its Impact and its Underbelly

Kenneth Frank, Ph.D.

On Developing a Willingness to Become Known

Galit Atlas, Ph.D.

Sex, Love, and Other Journeys

Sally Bjorklund, MA

From War to Reconciliation: Making the Personal Professional

Hillary Grill, LCSW

Our Fathers, Our Selves

Steven Kuchuck, LCSW, *moderator*

1–2:50 pm

Sea Cliff

Committee on Multicultural Concerns Board Meeting

1–2:50 pm

Telegraph Hill

Panel

SA-9 The Creative Pulse and the Great Wound

The relationship between trauma and creativity has been underexplored. The presenters will overview selective psychoanalytic theories of creativity and offer a new relational perspective on the creative process. Dissociation and witnessing are core concepts in this new view.

Spyros D. Orfanos, Ph.D., ABPP

Recycling Medea: A Composer's Story

Sophia Richman, Ph.D., ABPP

Mended by the Muse: A Painter's Story

1–2:50 pm

Marina

Panel

SA-10 From Science to Aesthetics: The Poetic in Psychoanalysis

Four early career clinicians will offer their reflections on the various ways in which the poetic abides at the core of the psychoanalytic project. The discussant, a published poet and psychoanalyst, will offer her insights on the poetic basis of the psychoanalytic encounter.

Jason Butler, Ph.D.

The Inhumanity of Measurement: A Critique of Natural Science Psychology

Stéphanie Gay Moss, M.A.

Absences in the Poetic Field: Listening to Paul Verlaine's "Mon Reve Familier"

Clara Brandt, MA

The Precarious Pleasures of Words: Linguistic and Sensory Aliveness in the Therapeutic Dyad

Daniel Greely Butler, MA

Elements of Silence: Affect, Sensorium and Bataillian Poetics in the Clinical Setting

Alice Jones, M.D., *discussant and moderator*

LIFE IN PSYCHOANALYSIS IN LIFE

SATURDAY APRIL 25

1–2:50 pm

Twin Peaks North

Steering Committee Invited Panel

Sex, Love, and Kinship in the Twenty-First Century

The two panel series, Sex, Love, and Kinship, explores being and living in a post-millennium world that has moved beyond solely binary or dyadic categorizations in the organization of self and self and other.

In Part I, The Fate of the Dyad, the panel will consider the growing number of non-dyadic relationships in family formation, child rearing, and romance. In Part II, The Fate of the Binary, the panel will explore the challenges to and shifts in thinking about heretofore dualistic categories of gender, of coupling and parentage, of sexuality.

The increasing fluidity of the world demands a willingness to explore hard questions in the above areas. To that end, both panels will examine clinicians' experiences and roles in working with the shifting expectations and definitions patients bring to the consulting room in regards to both the dyad and the binary in areas of sex, love, and kinship, while also considering the clinical implications and life impacts these identities and choices may bring with them.

SA-11 Part I: The Fate of the Dyad

Sand Chang, Ph.D.

Muriel Dimen, Ph.D.

Paola Mieli, Ph.D.

Ruth Simon, Ph.D.

Maureen Murphy, Ph.D., *moderator*

Don Romesburg, Ph.D., *moderator*

3–4:50 pm

Twin Peaks North

Steering Committee Invited Panel

Sex, Love, and Kinship in the Twenty-First Century

SA-12 Part II: The Fate of the Binary

Sheri Ashcraft, Psy.D.

Francisco Gonzalez, M.D.

Lynne Harkless, Ph.D.

Adrienne Harris, Ph.D., *discussant and presenter*

Diane Ehrensaft, Ph.D., *moderator*

Tori Branch, Psy.D., *moderator*

3–4:50 pm

Marina

Panel

SA-16 Phases of a Psychoanalytic Career

The panel addresses the challenges of a psychoanalytic career. We explore the struggles and self doubts of beginning analysts, establishing a practice. Then we look at the middle years with their opportunities to create an analytic voice, and their potential regrets. Finally, we discuss approaches to retirement.

Megan Poe, M.D.

Living the Questions: The Early Years

Sandra Buechler, Ph.D.

Henry James' Middle Years and My Own

Donna Orange, Ph.D.

An Analyst Retires: Lessons in Clinical Humility

3–4:50 pm

Pacific Heights

Panel

SA-13 Psychoanalyzing While Arab: On Terror and Apparition

The panel presents personal accounts of two Arab/Lebanese psychoanalytic clinicians and largely unexplored professional and personal predicaments as they process various meaning-making struggles related to their Arabness within the field of psychoanalysis and their life.

Lara Sheehi, Psy.D.

The Terrorist In Me

Nadine Obeid, Ph.D.

Whose Terror Is It?

Lynne Layton, Ph.D., *discussant*

3–4:50 pm

Sea Cliff

Panel

SA-14 Existential Philosophy and Psychoanalysis: A Roundtable Discussion

This presentation is a roundtable discussion among three analysts who use existential philosophy in their psychoanalytic work. Each from a somewhat different perspective, they will discuss how existential concepts inform their view of psychoanalysis and their therapeutic approach.

Frank L. Summers, Ph.D., ABPP

Robert Stolorow, Ph.D., Ph.D., ABPP

Carlo Strenger, Ph.D.

LIFE IN PSYCHOANALYSIS IN LIFE

SATURDAY APRIL 25

3–4:50 pm

Telegraph Hill

Panel

SA-15 Working with Pre-Symbolic Patients in the Autistic Contiguous Position

This panel describes the struggles of a small supervision group confronting issues of shame and trust in work with pre-symbolic patients who often use their bodies to find physical limits-including self-inflicted harm and extreme sexual encounters with multiple partners, which typically gives them a sense of calm, rather than pain, displeasure, or horror.

Meredith Darcy, LCSW-R

Watch Me, Hold Me, Love Me: Please Be My Second Skin

Kristin Reale, MSW

Desperate Measures: Sex, Terror and the Body in the Autistic Contiguous Position

Joseph Newirth, Ph.D., ABPP

Working with Pre-Symbolic Patients in the Autistic Contiguous Position:
The Development of Trust

Joseph Newirth, Ph.D., ABPP, *moderator*

6–8 pm

Sea Cliff

Reception

Joint Reception Co-sponsored by Sections III and VIII

6:30–8:30 pm

Twin Peaks North and South

Reception

Joint Reception Co-sponsored by Sections II, V and IX and the Committees on Multicultural Concerns, Sexualities and Gender Identities, Early Career Psychologists and Psychoanalysis and the Community

LIFE IN PSYCHOANALYSIS IN LIFE

SUNDAY APRIL 26

7:30–8:50 am

Sierra

Publications Committee Meeting

8–9:50 am

Grant Boardroom

Program Committee Meeting

8 am–noon

Montgomery

American Board and Academy of Psychoanalysis (ABAPsa) Board Meeting Continued

8–9:50 am

Pacific Heights

Committee on International Relations in Psychoanalytic Psychology Invited Panel **SU-6 International Psychoanalytic Outreach: A Model of Training and Intervention for the 21st Century**

Presentations detail experiences of two psychoanalytic clinicians who have constructed models of intervention within internationally based care-delivery settings related to trauma from social violence and dislocation, with emphasis on mental health professionals, educators and child care workers.

Marilyn Charles, Ph.D., ABPP

Caring for the Caregivers: A Model for Supporting Therapeutic Interventions in Other Countries

Monisha C. Nayar-Akhtar, Ph.D.

The Exporting of Psychoanalytic Ideas to a Developing Country and Region: A Work In Progress

Adrienne E. Harris, Ph.D., *discussant*

LIFE IN PSYCHOANALYSIS IN LIFE

SUNDAY APRIL 26

8–9:50 am

Marina

Graduate Student Committee Invited Panel

SU-1 What Would Freud Do? Navigating the Psychoanalytic Superego in Training

A round-table discussion featuring graduate students in a candid reflection upon their personal encounters with the psychoanalytic superego, the thoughts and feelings such encounters have evoked, and the implications of these experiences for graduate students' professional development.

Omyda Hernandez, Ph.D.

Shannon Carter, MS

Vivian Dent, Ph.D.

Frank E. Lawatsch, MSW, MPsy, *moderator*

8–9:50 am

Mendocino

Candidate Outreach Committee Invited Panel

SU-2 The Interrelatedness of Life and Psychoanalytic Training

This panel seeks to explore the impact of psychoanalytic training on the clinician's life, as well as the impact of the clinician's life on the training process. Presentations will be given by both current candidates and seasoned psychoanalysts.

Ricardo Rieppi, Ph.D., ABPP

Transcendent Education Through Psychoanalytic Training and Fatherhood

Lisa Harris, Ph.D.

Well... How Did I Get Here? Finding Myself in Psychoanalytic Training

Kirkland Vaughans, Ph.D.

Trials and Tribulations of Training: Reflections on Becoming a Psychoanalyst of Color

Ricardo Rieppi, Ph.D., ABPP, *moderator*

Samuel Gerson, Ph.D., *discussant*

8–9:50 am

Presidio

Section IV Invited Panel

SU-7 Aliveness in Psychoanalytic Supervision

Nancy McWilliams and David Ramirez will discuss the structural elements inherent in facilitating a vibrant supervisory experience. Early career supervisors face particular challenges relating to discovering and facilitating a supervisory style that produces an experience of aliveness, particularly in situations where the patients' clinical material closely intersects the personal concerns of the supervisee.

Nancy McWilliams, Ph.D., ABPP

David E Ramirez, Ph.D., ABPP, *moderator*

8–9:50 am

Telegraph Hill

Panel

SU-3 Queering the Maternal Body

The work presented in this panel aims to bridge gender-destabilizing trends in psychoanalysis with the work of queer theorists whose concepts have been inspired by similar foundational concepts in psychoanalysis in order to “queer” the maternal body.

Jessica Chavez, MA

Reprofuturity and the (Potentially) Reproductive Body: Possibilities for Low-Income Women

Jessica A. Joseph, MA

(Re)Embodying the Lactating Body

Jessica Chavez MA, *moderator*

8–9:50 am

Monterey

Committee on Education and Clinical Training Invited Panel

SU-4 Psychoanalytical Training Opportunities in Pre-Doctoral Internships & Post-Doctoral Fellowships, 1995-2015: Opportunities & Challenges

The symposium will consist of a brief history of the present Survey as follows: National Surveys of Psychoanalytic Training undertaken in 1995—1996 with a replication undertaken in 2005. The latest replication builds on the previous two with additional questions and also surveys post-doctoral fellowships for the first time.

Sarah Mulder, MA

Natalie Sergent, MA

David I. Downing, Psy.D., ABPP, *presenter and moderator*

9–10:30 am

Sierra

Psychoanalytic Psychology Editorial Board

LIFE IN PSYCHOANALYSIS IN LIFE

SUNDAY APRIL 26

10–11:50 am

Sea Cliff

Panel

SU-5 Playing with Psychoanalysis in Life: An Intergenerational Play About Mothering

This presentation is a play—an imaginary meeting of five generations of matriarchs from one family. They explore and expose the intergenerational transmission of disavowed affects but then begin to change when they tell each other their dreams. Audience reflection/commentary very welcome.

Leanne Domash, Ph.D.

Elizabeth Ochoa, Ph.D.

Rachel Shapiro, BA

Arlene (Lu) Steinberg, Psy.D.

Betty Hellman, Ph.D.

Presenters

Daphny LD Ainslie, Psy.D Private Practice, Austin, TX	12, 30
Ricardo Ainslie, Ph.D., ABPP University of Texas at Austin, Austin, TX	38, 44
Judith Alpert, Ph.D. NYU Postdoctoral Program in Psychotherapy and Psychoanalysis, New York, NY	38, 43
Charles L. Amrhein, Psy.D. Private Practice, New York, NY	33
James W. Anderson, Ph.D. Northwestern University, Chicago, IL	45
Lewis Aron, Ph.D., ABPP NYU Postdoctoral Program in Psychotherapy and Psychoanalysis, New York, NY	55
Seth M. Aronson, Psy.D. William Alanson White Institute, New York, NY	46
Sheri Ashcraft, Psy.D. Private Practice, Coral Gables, FL	17, 62
Galit Atlas, Ph.D. NYU Postdoctoral Program in Psychotherapy and Psychoanalysis, New York, NY	60
Dawn Avery, Ph.D. Montgomery College, Bethesda, MD	56
Michelle Baker, M.F.T. Psychiatric Alternatives & Wellness Center, San Francisco, CA	15, 41
Willow Banks, M.A. NCSPP, San Francisco, CA	47
Donna Bassin, Ph.D. NYU Postdoctoral Program in Psychotherapy and Psychoanalysis, New York, NY	41

LIFE IN PSYCHOANALYSIS IN LIFE

Jill Bellinson, Ph.D. William Alanson White Institute, New York, NY	45
Jessica Benjamin, Ph.D. NYU Postdoctoral Program in Psychotherapy and Psychoanalysis, New York, NY	34
Sally Bjorklund, M.A. Relational Psychotherapy and Psychoanalysis Seattle, Seattle, WA	60
Steven Botticelli, Ph.D. NYU Postdoctoral Program in Psychotherapy and Psychoanalysis, New York, NY	40
Ghislaine Boulanger, Ph.D. NYU Postdoctoral Program in Psychotherapy and Psychoanalysis, New York, NY	13, 44, 58
Tori Branch, Psy.D. Private Practice, San Francisco, CA	17, 62
Clara Brandt, M.A. Wright Institute, Berkeley, CA	61
Will Braun, Psy. D. New York Psychoanalytic Institute, New York, NY	32
Celia Brickman, Ph.D. Center for Religion & Psychotherapy of Chicago, Chicago, IL	34
Louise Brodie, M.F.T. Private Practice, San Francisco, CA	34
Albert J. Brok, Ph.D. Derner Institute, New York, NY	49
Sandra Buechler, Ph.D. William Alanson White Institute, New York, NY	51, 63
Daniel Butler, M.A. Access Institute for Psychological Services, San Francisco, CA	47, 61
Jason Butler, Ph.D. JFK University, Oakland, CA	61
Drew Cameron Combat Paper Project	41

DIVISION OF PSYCHOANALYSIS (39)
35TH ANNUAL SPRING MEETING

Ashley Carreras, MS Nova Southeastern University, Intensive Psychodynamic Clinic, Fort Lauderdale, FL	41
Shannon Carter, MS Norwich University, Northfield, VT	66
Sand Chang, Ph.D. Kaiser Permanente, Oakland, CA	17, 62
Dana Charatan, Psy.D. Private Practice, Boulder, CO	12, 30
Marilyn Charles, Ph.D., ABPP Austen Riggs Center, Stockbridge, MA	18, 42, 48, 65
Jessica Chavez, M.A. The New School for Social Research, New York, NY	67
Chuntao German Cheung, Psy.D. Private Practice, San Francisco, CA	51
Geetali Chitre, M.A. Access Institute for Psychological Services, San Fransisco, CA	39
Gregory Clinton, Ph.D. Private Practice, San Francisco, CA	15, 37
Tanya Cotler, Ph.D. Private Practice, Toronto, Ontario	12, 30
Margaret Crastnopol, Ph.D. Seattle Psychoanalytic Society and Institute, Seattle, WA	49, 51
Stephanie Creekspaum, Psy.D. Intermountain Health Primary Children's Center for Counseling, Salt Lake City, UT	44
Jay Crosby, Ph.D. New York University School of Medicine, New York, NY	60
Nancy Crown, Ph.D. Private Practice, New York, NY	33
Meredith Darcy, LCSW-R William Alanson White Institute, New York, NY	64
Barry Dauphin, Ph.D. University of Detroit-Mercy, Detroit, MI	44

LIFE IN PSYCHOANALYSIS IN LIFE

Matthieu de Fayet Niantic Labs@Google, San Francisco, CA	16, 52
Daphne de Marneffe, Ph.D. California Pacific Medical Center, San Francisco, CA	55
Vivian Dent, Ph.D. Private Practice, San Francisco, CA	66
Gregory Desierto, Psy.D. Psychological Services Center, Oakland, CA	39
Robin A. Deutsch, Ph.D. San Francisco Center for Psychoanalysis, San Francisco, CA	36
Helen DeVinney, Psy.D. Professional Psychology Program, The George Washington University, Washington, DC	38
Diana Diamond, Ph.D. NYU Postdoctoral Program in Psychotherapy and Psychoanalysis, New York, NY	40, 44
Muriel Dimen, Ph.D. NYU Postdoctoral Program in Psychotherapy and Psychoanalysis, New York, NY	17, 57, 62
Leanne Domash, Ph.D. NYU Postdoctoral Program in Psychotherapy and Psychoanalysis, New York, NY	68
David L. Downing, Psy.D., ABPP University of Indianapolis, School of Psychological Sciences, Indianapolis, IN	67
Meg Earls, Psy.D. California Pacific Medical Center, San Francisco, CA	55
Diane Ehrensaft, Ph.D. University of California San Francisco, San Francisco, CA	17, 38, 62
Christina Emanuel, Psy.D. Institute of Contemporary Psychoanalysis, Los Angeles, CA	39
Ruth Fallenbaum, Ph.D. Survivors International, San Francisco, CA	58

DIVISION OF PSYCHOANALYSIS (39)
35TH ANNUAL SPRING MEETING

Juli Fraga, Psy.D. University of California San Francisco, San Francisco, CA	55
Kenneth Frank, Ph.D. National Institute for the Psychotherapies, New York, NY	60
Phillip Freeman, M.D., D.M.H. Boston Psychoanalytic Society and Institute, Newton, MA	16, 52
Lucy Freund, Ph.D. Northwestern University, Chicago, IL	45
K. William Fried, Ph.D. Institute for Psychoanalytic Training and Research, New York, NY	46, 49
Lisa Fruchtman Producer, Director, Filmmaker, New York, NY	16, 47
Sophia Frydman, M.A., MFA Adelphi University, Garden City, NY	37
Francesco Gazzillo, Ph.D. Sapienza University, Rome, Italy	50
Helen Gediman, Ph.D., ABPP Contemporary Freudian Society, New York, NY	35
Jill Gentile, Ph.D. NYU Postdoctoral Program in Psychotherapy and Psychoanalysis, New York, NY	32
Katie Gentile, Ph.D. John Jay College of Criminal Justice, New York, NY	31, 52
Anne Germanacos, MFA San Francisco, CA	57
Mary-Joan Gerson, Ph.D. NYU Postdoctoral Program in Psychotherapy and Psychoanalysis, New York, NY	18, 38, 42, 59
Samuel Gerson, Ph.D. Alliant International University, San Francisco, CA	66
Shelly Goldklank, Ph.D. Yeshiva University, New York, NY	38

LIFE IN PSYCHOANALYSIS IN LIFE

Nancy B. Goldov, Psy.D. Antioch University, Seattle, WA	33
Francisco Gonzalez, M.D. Psychoanalytic Institute of Northern California, San Francisco, CA	17, 34, 62
Joe Goode University of California, San Francisco, CA	13, 54
Susan Goodman, LCSW Child First, Shelton, CT	46
Elizabeth Goren, Ph.D. NYU Postdoctoral Program in Psychotherapy and Psychoanalysis, New York, NY	33
William H. Gottdiener, Ph.D. John Jay College of Criminal Justice, New York, NY	18, 59
Kellen Grayson, Psy.D. Stat Program West Coast Children's Clinic, Oakland, CA	56
Hillary Grill, LCSW National Institute for the Psychotherapies, New York, NY	60
Ellen Gussaroff, Ph.D. Training Institute for Mental Health, New York, NY	49
John Hanke, MBA Niantic Labs@Google, Sacramento, CA	16, 52
Lynne Harkless, Ph.D. Florida Psychoanalytic Institute, Miami, FL	17, 54, 62
Andrew Harlem, Ph.D. California Institute of Integral Studies, Oakland, CA	15, 41
Rebecca Harrington, LCSW Psychoanalytic Psychotherapy Study Center, New York, NY	31
Adrienne Harris, Ph.D. NYU Postdoctoral Program in Psychotherapy and Psychoanalysis, New York, NY	17, 40, 62, 65
Lisa Harris, Ph.D. NYU Postdoctoral Program in Psychotherapy and Psychoanalysis, New York, NY	66



DIVISION OF PSYCHOANALYSIS (39)
35TH ANNUAL SPRING MEETING

Stephen Hartman, Ph.D. Psychoanalytic Institute of Northern California, San Francisco, CA	16, 45, 52
Jane Hassinger, M.S.W. University of Michigan, Ann Arbor, MI	31, 38, 52
Toni Heineman, D.M.H. A Home Within, San Francisco, CA	15, 37, 57
Erkki Heinonen, Ph.D. Helsinki University, Helsinki	50
Betty Hellman, Ph.D. Private Practice, New York, NY	68
Omyda Hernandez, Ph.D. Access Institute of Psychological Services, San Francisco, CA	39, 66
Irwin Hirsch, Ph.D. NYU Postdoctoral Program in Psychotherapy and Psychoanalysis, New York, NY	49, 60
Clara Hungr, M.A. Adelphi University, Garden City, NY	37
Suzanne Iasenza, Ph.D. Institute for Contemporary Psychotherapy and Psychoanalysis, New York, NY	38
Marilyn Jacobs, Ph.D., ABPP UCLA Dept. of Psychiatry and Biobehavioral Sciences, Los Angeles, CA	11, 29, 43
Alice Jones, M.D. San Francisco Center for Psychoanalysis, San Francisco, CA	61
Jessica A. Joseph, M.A. The New School for Social Research, New York, NY	67
Elliot Jurist, Ph.D., Ph.D. City University of New York, New York, NY	49
Beth Kalish-Weiss, Ph.D. Los Angeles Institute and Society for Psychoanalytic Studies, Hollywood Hills, CA	53
Tammy Kaminer, Ph.D. William Alanson White Institute, New York, NY	46

LIFE IN PSYCHOANALYSIS IN LIFE

Cassie Kaufmann, Ph.D. Adelphi University, Garden City, NY	37
Susan Kavalier-Adler, Ph.D., ABPP, D.Litt. Object Relations Institute for Psychotherapy and Psychoanalysis, New York, NY	43
David D. Kemmerer, Ph.D. Massachusetts Institute for Psychoanalysis, Cambridge, MA	53
Sandra Kiersky, Ph.D. Institute for the Psychoanalytic Study of Subjectivity, Santa Fe, NM	56
Elizabeth Kita, Ph.D., LCSW Reflective Spaces/Material Places (RSMP), San Francisco, CA	34, 45
Megan Kolano, Psy.D. Austen Riggs Center, Stockbridge, MA	57
Kimberly Korobov, M.A., MDiv Columbus State University, Columbus, GA	57
Steven Kuchuck, LCSW National Institute for the Psychotherapies, New York, NY	33, 60
Jane Kupersmidt, Ph.D. National Psychological Association for Psychoanalysis, New York, NY	35
Emillee Kutash, Psy.D., Ph.D. St. Joseph's College, East Hampton, NY	46
Loong W. Kwok, Psy.D. Richmond Area Multi Services, San Francisco, CA	16, 47, 52
Frank E. Lawatsch, M.S.W., MPsy Access Institute for Psychological Services, San Francisco, CA	66
Lynne Layton, Ph.D. Massachusetts Institute for Psychoanalysis, Brookline, MA	32, 63
Julie Leavitt, M.D. Psychoanalytic Institute of Northern California, San Francisco, CA	15, 37
Alexandra Lee, M.A. The Wright Institute, Berkeley, CA	33
Alicia Lieberman, Ph.D. University of California San Francisco, San Francisco, CA	44, 51

DIVISION OF PSYCHOANALYSIS (39)
35TH ANNUAL SPRING MEETING

Ruth Livingston, Ph.D. William Alanson White Institute, New York, NY	43
Dan Livney, Psy.D. Project Transition, Philadelphia, PA	12, 30, 56
Karen Lombardi, Ph.D. Adelphi University, Garden City, NY	37
Stephen Lugar, Psy.D. Access Institute for Psychological Services, San Francisco, CA	56
Leigh Lyndon, Psy.D. California Pacific Medical Center, San Francisco, CA	55
Bart Magee, Ph.D. Access Institute for Psychological Services, San Francisco, CA	54
Norka Malberg, Psy.D. Yale Child Study Center, New Haven, CT	32, 44, 46, 51
Jenny Marion, M.A. Adelphi University, Garden City, NY	37
Abigail L. Marks, Ph.D. Milton Marks Neuro-Oncology Family Camp, San Francisco, CA	34
Paul M. Martin, Psy.D. Private Practice, Chicago, IL	12, 30
Mia Maturen, M.A. RSMP, San Francisco, CA	34, 47
Susan Maxwell, Psy.D. Veterans Affairs, San Francisco, CA	53
Mary Margaret McClure, D.M.H. San Francisco Center for Psychoanalysis, San Francisco, CA	15, 37, 51, 55
Rachel McKay, Ph.D. Institute for Relational Psychoanalysis of Philadelphia, Philadelphia, PA	34
Tiffany McLain, M.F.T.I Northern California Society for Psychoanalytic Psychology, San Francisco, CA	32, 56
Barbara McLeod, M.A. Adelphi University, Garden City, NY	37

LIFE IN PSYCHOANALYSIS IN LIFE

Nancy McWilliams, Ph.D., ABPP Rutgers Graduate School of Applied & Professional Psychology, Piscataway, NJ	35, 37, 51, 66
Mia Medina, Psy.D. Bahcesehir University, Istanbul, Turkey	33
Paola Mieli, Ph.D. Après-Coup Psychoanalytic Association, New York, NY	17, 62
Ben L. Mijuskovic, Ph.D. California State University at Dominguez Hills, Carson, CA	48
Carlotta Miles, M.D. Private Practice, Washington, DC	40
Jon Mills, Psy.D., Ph.D., ABPP Adler Graduate Professional School, Toronto, ON, Canada	48
Tracy D. Morgan, LCSW-R, MPhil Das Unbehagen, Society for Modern Psychoanalysis, New York, NY	32
Stéphanie Gay Moss, M.A. Wright Institute, Berkeley, CA	61
Sarah Mulder, M.A. University of Indianapolis, School of Psychological Sciences, indianapolis, IN	67
Mahima Muralidharan, Psy.D. Access Institute for Psychological Services, San Francisco, CA	41
Maureen Murphy, Ph.D. Psychoanalytic Institute of Northern California, San Francisco, CA	17, 43, 62
Suzi Naiburg, Ph.D., LICSW Massachusetts Institute for Psychoanalysis, Boston, MA	48
Shelley Nathans, Ph.D. Northern California Society for Psychoanalytic Psychology, San Francisco, CA	10, 29, 35, 38
Monisha C. Nayar-Akhtar, Ph.D. Psychoanalytic Center of Philadelphia, Philadelphia, PA	65
Joseph Newirth, Ph.D. The Derner Institute, Adelphi University, Garden City, NY	60, 64
Luis Nobrega, M.A., LLM Yeshiva University, New York, NY	38

DIVISION OF PSYCHOANALYSIS (39)
35TH ANNUAL SPRING MEETING

Nadine Obeid, Ph.D. William Alanson White Institute, New York City, NY	63
Elizabeth Ochoa, Ph.D. Mt. Sinai Beth Israel, New York, NY	68
Sharif Okasha, Psy.D. Richmond Area Multi Services, San Francisco, CA	15, 41
Michael O'Loughlin, Ph.D. Adelphi University, New York, NY	52
Donna Orange, Ph.D. Institute for the Psychoanalytic Study of Subjectivity, Claremont, CA	63
Spyros D. Orfanos, Ph.D., ABPP NYU Postdoctoral Program in Psychotherapy and Psychoanalysis, New York, NY	61
Ryan Parker, Ph.D., LCSW A Better Way, San Francisco, CA	34
Rachael Peltz, Ph.D. Psychoanalytic Institute of Northern California, San Francisco, CA	16, 34, 47
Kristi Pikiewicz, Ph.D. Private Practice, Boulder, CO	12, 30
Ari Pizer, MMT Widener University, Chester, PA	55
Megan Poe, M.D. William Alanson White Institute, New York, NY	63
William Pollack, Ph.D. Harvard Medical School, Cambridge, MA	32
JoAnn Ponder, Ph.D. Center for Psychoanalytic Studies, Austin, TX	40
Miki Rahmani, M.A. South Jerusalem Mental Health Center, Jerusalem, Israel	33
David E. Ramirez, Ph.D., ABPP Swarthmore College, Philadelphia, PA	66
Jonah Raskin, Ph.D. Sonoma State University, Santa Rosa, CA	46

LIFE IN PSYCHOANALYSIS IN LIFE

Trisha A. Ready, Ph.D. Fairfax Hospital, Seattle, WA	56
Kristin Reale, M.S.W. Private Practice, New York, NY	64
Vilma Reyes, Psy.D. University of California San Francisco, San Francisco, CA	51
Sophia Richman, Ph.D., ABPP NYU Postdoctoral Program in Psychotherapy and Psychoanalysis, New York, NY	61
Ricardo Rieppi, Ph.D., ABPP NYU Postdoctoral Program in Psychotherapy and Psychoanalysis, New York, NY	66
Philip A. Ringstrom, Ph.D., Psy.D. Institute of Contemporary Psychoanalysis, Los Angeles, CA	35
Jean Roberston Principal, Glen Park School, San Francisco, CA	15, 41
Don Romesburg, Ph.D. Sonoma State University, San Francisco, CA	17, 62
Dan Rose, Psy.D. Columbus State University, Columbus, GA	57
Larry Rosenberg, Ph.D. Private Practice, Stamford, CT	44
Karen Rosica, Psy.D. University of Colorado Health Sciences Center, Denver, CO	33, 45
Megan Rundel, Ph.D. Private Practice, Oakland, CA	11, 29
Gillian Isaacs Russell, Ph.D. British Psychoanalytic Council, Boulder, CO	47
Richard Ruth, Ph.D. The George Washington University, Washington, DC	18, 33, 42
Molly Saeger, M.F.T. Private Practice, San Francisco, CA	34

DIVISION OF PSYCHOANALYSIS (39)
35TH ANNUAL SPRING MEETING

Maneesh Saini, M.A. Access Institute for Psychological Services, San Fransisco, CA	39
Jill Salberg, Ph.D. NYU Postdoctoral Program in Psychotherapy and Psychoanalysis, New York, NY	40
Shara Sand, Psy.D. LaGuardia Community College, New York, NY	56
Joan E. Sarnat, Ph.D. Psychoanalytic Institute of Northern California, San Francisco, CA	33
Milton Schaefer, Ph.D. San Francisco Center for Psychoanalysis, San Francisco, CA	10, 29
Emily Seidel, Psy.D. Psychoanalytic Institute of Northern California, San Francisco, CA	38
Henry M. Seiden, Ph.D., ABPP Private Practice, Forest Hills, NY	46
Stephen Seligman, D.M.H. Department of Psychiatry, University of California San Francisco, San Francisco, CA	16, 35, 52
Natalie Sergent, M.A. University of Indianapolis, School of Psychological Sciences, Indianapolis, IN	67
Peter Shabad, Ph.D. Northwestern University Medical School, Chicago, IL	51
Rachel Shapiro, BA California Instiute for Integral Studies, San Francisco, CA	68
Alice Lowe Shaw, Ph.D. Psychoanalytic Institute of Northern California, San Francisco, CA	16, 34, 47
Lara Sheehi, Psy.D. SC Dept. of Health and Human Services, Williamsburg, VA	63
Eric Sherman, Psy.D. Private Practice, New York, NY	11, 29
Michelle Shubin, LCSW, BCD Psychoanalytic Psychotherapy Study Center, New York, NY	31

LIFE IN PSYCHOANALYSIS IN LIFE

Doris Silverman, Ph.D. NYU Postdoctoral Program in Psychotherapy and Psychoanalysis, New York, NY	40
Ruth Simon, Ph.D. Access Institute for Psychological Services, San Francisco, CA	17, 62
Jonathan Slavin, Ph.D. Harvard Medical School at Cambridge Health Alliance, Cambridge, MA	33
Joyce Slochower, Ph.D., ABPP NYU Postdoctoral Program in Psychotherapy and Psychoanalysis, New York, NY	33, 45, 60
Brian E. Smith, Ph.D. Montefiore Medical Center, Bronx, NY	60
Judy Patt Smoker, M.S.W. University of California San Francisco, San Francisco, CA	34
Nirav Soni, Ph.D. Private Practice, New York, NY	60
Esther Sperber, MsAAD Studio ST Architects, New York, NY	32
Warren Spielberg, Ph.D. The New School for Public Engagement, New York, NY	32
Arlene (Lu) Steinberg, Psy.D. Teachers College, Columbia University, New York, NY	40, 68
Gregory Stevens, Ph.D. University of Tennessee at Chattanooga, Chattanooga, TN	57
Robert Stolorow, Ph.D., ABPP Los Angeles Institute for Contemporary Psychoanalysis, Los Angeles, CA	32, 63
Carlo Strenger, Ph.D. Tel Aviv University, Tel Aviv, Israel	63
Frank L. Summers, Ph.D. Feinberg School of Medicine, Northwestern University, Chicago, IL	63
Lekeisha A. Sumner, Ph.D. CSPP Alliant University, Los Angeles, CA	11, 29



DIVISION OF PSYCHOANALYSIS (39)
35TH ANNUAL SPRING MEETING

Annie Sweetnam, Ph.D. Private Practice, Berkeley, CA	11, 29
Diane Swirsky, Ph.D. Northern California Society for Psychoanalytic Psychology, San Francisco, CA	15, 37
Jason M. Thompson, MS Palo Alto University, Palo Alto, CA	41
Ellen Toronto, Ph.D. Private Practice, Ann Arbor, MI	40
Todd Troutman, Psy.D. Access Institute for Psychological Services, San Francisco, CA	15, 37
Steven Tuber, Ph.D. City University of New York, New York, NY	35
Usha Tummala-Narra, Ph.D. Boston College, Chestnut Hill, MA	18, 42
Sandra Ullman, Ph.D. Chicago Center for Psychoanalysis, Chicago, IL	48
Kirkland Vaughans, Ph.D. NYU Postdoctoral Program in Psychotherapy and Psychoanalysis, New York, NY	32, 44, 66
Robert Wallerstein, M.D. San Francisco Center for Psychoanalysis, San Francisco, CA	35
Wendy von Wiederhold, Ph.D. A Home Within, San Francisco, CA	15, 41
Sherwood Waldron, M.D. Psychoanalytic Research Consortium, New York, NY	50
Orit Weksler, M.A., M.F.T. A Home Within, Berkeley, CA	50
Ania Wertz, Psy.D. Private Practice, San Francisco, CA	53
Gary Whitmer, LCSW Private Practice, Berkeley, CA	50

LIFE IN PSYCHOANALYSIS IN LIFE

Stephen Xenakis, M.D. Brigadier General (ret.), Chief Medical Officer, MindCare Solutions, Nashville, TN	14, 58
Kris Yi, Ph.D., Psy.D. Private Practice, Pasadena, CA	40, 44
Lawrence Zelnick, Psy.D. NYU Postdoctoral Program in Psychotherapy and Psychoanalysis, New York, NY	45
Anna Zozulinsky, MS Palo Alto University, Palo Alto, CA	41

Floor Plans

Mezzanine Level

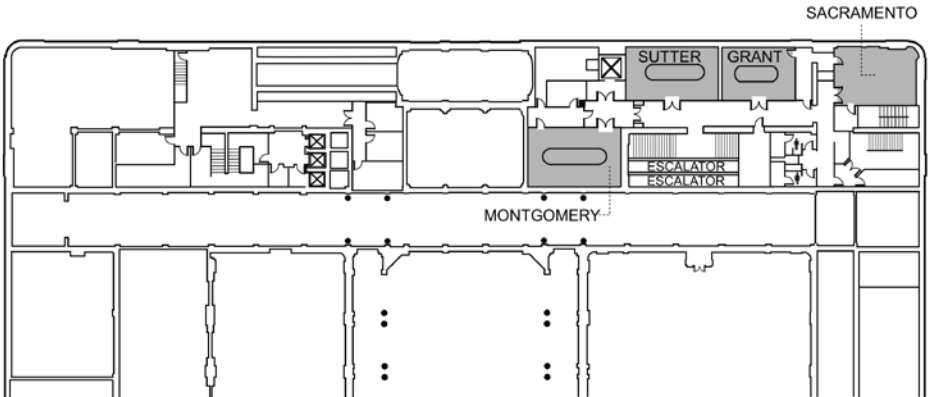

First Floor

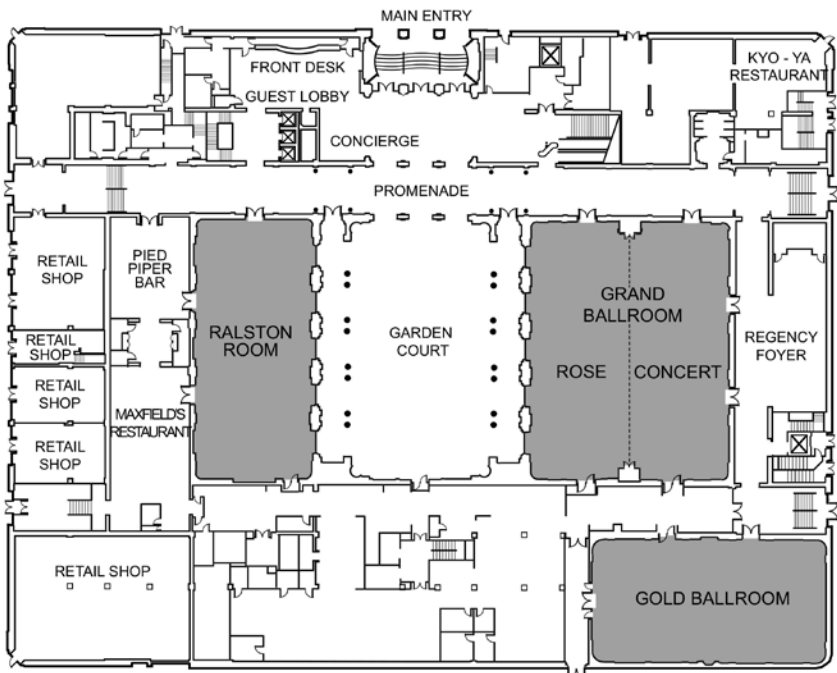

LIFE IN PSYCHOANALYSIS IN LIFE

Floor Plans

Second Floor

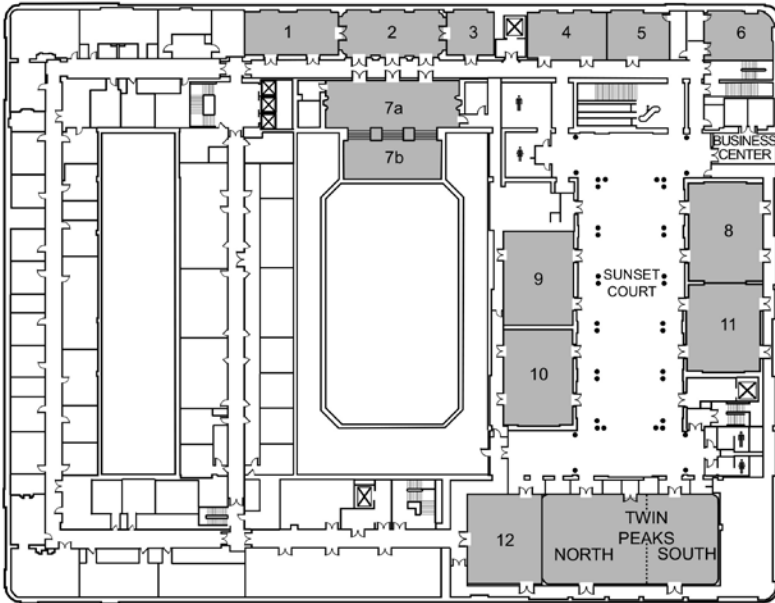

1. MENDOCINO
2. CALIFORNIA PARLOR
3. SIERRA
4. NAPA
5. SONOMA
6. MONTEREY
- 7a. FRENCH PARLOR UPPER
- 7b. FRENCH PARLOR LOWER
8. SEA CLIFF
9. MARINA
10. PRESIDIO
11. PACIFIC HEIGHTS
12. TELEGRAPH HILL

REGISTRATION FORM, PART 1

NAME (As you wish it to appear on your badge) _____ DEGREE _____

ADDRESS _____

CITY, STATE, ZIP, COUNTRY _____

PHONE _____ FAX _____

EMAIL _____

Date highest professional degree was received ____/____/____ (mm/yyyy)

First time attending Division 39 Spring Meeting? Yes No

Will you request CE credits for programs you attend? Yes No

Please indicate any accessible accommodations needed _____

REGISTRATION FEES (Circle the appropriate dollar amount.)

ALL STUDENTS AND INSTITUTE CANDIDATES must submit proof of their status with registration. Without this proof, your registration will not be processed. See the **Registration** section in this brochure for specific proof required. **Early Bird Registration ends Jan. 16, 2015**

	Postmarked or electronically submitted by 1/16/15	4/14/15
Member	\$350	\$400
Non-Member	\$425	\$475
Student Member	\$ 60	\$ 70
Student Non-Member*	\$ 85	\$ 95
ECP Member (Date of Doctoral Degree April 2008 or later)	\$125	\$150
ECP Non-Member (Date of Doctoral Degree April 2008 or later)**	\$165	\$180
Institute Candidate member (Enrolled in first 5 yrs of curriculum only)	\$125	\$150
Institute Candidate Non-Member (Enrolled in first 5 yrs of curriculum only)***	\$195	\$210

*\$25 of all Student Non-Member registrations will be applied to a one-year Division 39 Membership

I want to add \$95 to my registration fee for a one-year Division 39 Membership

**Please use \$50 of my ECP registration fee towards Division 39 Membership

***Please use \$95 of my IC registration fee towards Division 39 Membership

FOREIGN AFFILIATES Postmarked or electronically submitted by 1/16/15 4/14/15

CURRENT DIVISION 39 MEMBERS:

Canada, Western Europe, Australia, New Zealand, Japan \$280 \$320

Other Countries: South America, Africa, Asia, Middle East \$140 \$180

NON-DIVISION 39 MEMBERS:

Canada, Western Europe, Australia, New Zealand, Japan* \$305 \$345

Other Countries: South America, Africa, Asia, Middle East* \$165 \$190

*Please use USD \$65 of my registration fee towards Division 39 membership

PLEASE TURN OVER

REGISTRATION FORM, PART 2

CONTINUING EDUCATION MASTER CLASSES *Please check the course(s) you wish to attend:*

Session I: 1–4 pm

- | | |
|--|------|
| <input type="checkbox"/> Couples on the Couch | \$60 |
| <input type="checkbox"/> Make the Mountain Dance | \$60 |
| <input type="checkbox"/> Writing as Coming into Being | \$60 |
| <input type="checkbox"/> On Reclaiming the Treatment of Pain Syndromes | \$60 |

Session II: 4:30–6:30 pm

- | | |
|---|------|
| <input type="checkbox"/> The Nuances of New Beginnings—ECP Workshop | \$40 |
|---|------|

(This workshop is free to students and Early Career Professionals who are members of Division 39)

Note: Registrations postmarked after April 14, 2015 will be returned. DO NOT MAIL OR FAX registrations after that date. You can register onsite at the Palace Hotel beginning Wednesday, April 22. There will be an additional \$50 added to the above fee schedule for all onsite registrations.

APF DIVISION 39 FUND:

I would like to make a tax deductible contribution of \$ _____

TOTAL PAYMENT DUE \$ _____

(Registrations will not be processed unless accompanied by full payment.)

REFUND POLICY Refund requests must be received in writing prior to April 1, 2015.

Fees will be refunded less a \$75 processing fee. There will be no refunds made after April 1. Please email refund requests to Division39SF@natalieshear.com or fax to 202-446-2965.

PAYMENT INFORMATION *(These are the only accepted methods of payment.)*

- Check made payable to Division 39, APA Visa Mastercard

CARD NUMBER

EXP. DATE (MM/YY)

NAME AS IT APPEARS ON THE CARD

BILLING ADDRESS IF DIFFERENT FROM ABOVE

CITY, STATE, ZIP CODE

Return registration forms to: Natalie Shear Associates, Conference Coordinators
1000 Vermont Ave. NW, Third Floor, Washington, DC 20005. Fax forms to 202-446-2965

For Registration Questions: 800-833-1354 x 4 or Hank@natalieshear.com

For All Other Questions: Division39SF@natalieshear.com or 800-833-1354

Division 39 Office

Ruth Helein-Executive Admin
2615 Amesbury Road
Winston Salem, NC 27103
(336) 768-1113 (ofc)
(877) 212-0511 (toll free)
(336) 464-2974 (fax)
Div39@namgmt.com
ruth@namgmt.com
www.division39.org

Conference Coordinators

Natalie Shear Associates
1000 Vermont Avenue NW, 3rd Floor
Washington, DC 20005
(800) 833-1354 (toll free)
(202) 833-4456 (ofc)
(202) 446-2965 (fax)
Division39SF@natalieshear.com
natalie@natalieshear.com
www.natalieshear.com

Division of Psychoanalysis (39)
35th Annual Spring Meeting
c/o Natalie Shear Associates
1000 Vermont Avenue NW, Third Floor
Washington, DC 20005

