

emotional conflict • conflict of interest • conflicting motives • interpersonal conflict • the experience of conflict • conflict in context • conflict avoidance • conflict, rupture and repair • conflict in technique • conflict and culture • conflicting values • sitting with conflict • conflicted desire • construction/deconstruction of conflict • conflict and hope • conflict of the self • social conflict • “inner” conflict • conflicting needs • conflicted analyst • conflicts in psychoanalytic training • family conflict • conflicting developmental paths • political conflict • gender conflict • conflicts in aging • conflicting boundaries • marital conflict • conflicts within and between theories • the politics of conflict • working with conflict • foreign and domestic conflicts • sexually conflicted • conflict representations • clinical conflict • conflicting narratives • neighborhood conflicts • fear of conflict • conflicting parties • conflict and capitalism • conflicting visions • in conflict • conflict between ideals, ambitions and desire • conflicts of adolescence • financial conflicts • conflicts of development • conflicting intentions • historical conflicts • conflicts in agency • conflict and war • conflicted states • conflict between theory and practice • spiritual conflict • relational conflict • conflicts and others • exploring conflict • conflict and diaspora • conflicting dreams • work conflicts • conflict in attachment • conflict and research • personality conflict • generational conflicts • military conflict • conflicting thoughts • conflict of interpretation • conflicting treatments • transference-countertransference conflicts • conflict resolution • conflict in psychoanalytic supervision • oedipal conflict • conflicted.

2014 Division 39 Board of Directors

President

Frank L. Summers, Ph.D., ABPP

President Elect

Marilyn Charles, Ph.D., ABPP

Past President

William MacGillivray, Ph.D., ABPP

Secretary

Dana Castellano, Psy.D.

Treasurer

Arlene Steinberg, Psy.D.

APA Council Reps

Norman Abeles, Ph.D.

Laura Barbanel, Ed.D.

Leilani S. Crane, Ph.D.

Mary Beth Cresci, Ph.D., ABPP

David L. Downing, Psy.D., ABPP

Marsha D. McCary, Ph.D.

Members-at-Large

Jill Bellinson, Ph.D.

Jaine L. Darwin, Psy.D., ABPP

Dennis Debiak, Psy.D.

Diana Diamond, Ph.D.

Devon King, Ph.D.

Ernesto Mujica, Ph.D.

Scott Pytluk, Ph.D.

Kris Yi, Ph.D., Psy.D.

Usha Tummala-Narra, Ph.D.

Section Representatives

Section I: K. William Fried, Ph.D.

Section II: JoAnn Ponder, Ph.D.

Section III: Marilyn Metz, Ph.D., ABPP

Section IV: Joseph Schaller, Psy.D.

Section V: Barry Dauphin, Ph.D.

Section VIII: Maurine Kelly, Ph.D.

Section IX: Elizabeth Goren, Ph.D.

Parliamentarian

Laurel Bass Wagner, Ph.D.

2014 Spring Meeting

Co-Chairs

J.P. Chevront, Psy.D.
William D. Lubart, Ph.D.

Steering Committee

Jill Bellinson, Ph.D.
Arthur A. Gray, Ph.D.
Adam Kaplan, Ph.D.
Jeanette Sawyer-Cohen, Ph.D.
Scott Quasha, Psy.D.

Proposal Reviewers

Daphny Ainslie, Psy.D.
Mildred Antonelli, Ph.D.
Laura Barbanel, Ed.D., ABPP
Phillip Bennet, Ph.D.
Albert Brok, Ph.D.
Brian Brown, Psy.D.
Dana L. Castellano, Psy.D.
Marilyn Charles, Ph.D., ABPP
Leilani S. Crane, Psy.D.
Mary Beth Cresci, Ph.D., ABPP
Jaine L. Darwin, Psy.D., ABPP
Dennis Debiak, Psy.D.
Jennifer Durham-Fowler, Ph.D.
Colin F. Ennis, Psy.D.
Heather Ferguson, M.S.
Helen Gediman, Ph.D.
Jill Gentile, Ph.D.
William Gottdiener, Ph.D.
Jackie Gotthold, Psy.D.
Rebecca Harrington, L.C.S.W.
Jane Hassinger, M.S.W.

Jenny Kaufmann, Ph.D.
Dan Livney, Psy.D.
William MacGillivray, Ph.D., ABPP
Hilary Maddux, LCSW
Norka T. Malberg, Psy.D.
Paul Martin, Psy.D.
Marsha McCary, Ph.D.
Sarah Mendelsohn, L.C.S.W.
Judy Roth, Ph.D.
Richard Ruth, Ph.D.
Joseph G. Schaller, Psy.D.
Burton Seidler, Ph.D.
Stephen Shainbart, Ph.D.
Lotte Smith-Hansen, Ph.D.
Dori Sorter, Ph.D.
Arlene Lu Steinberg, Psy.D.
Cidna Valentin, M.Phil
Samantha Winokur, Psy.D.
Nicholas Wood, Psy.D.
Stefan Zicht, Psy.D.

Table of Contents

Spring Meeting Committee and Proposal Reviewers	1
Welcome	3
General Conference Information	5
Registration Hours	7
Book Exhibitor Hours	7
Continuing Education Credits	8
Pre Conference Continuing Education Master Classes	10
Keynote: Kimberlyn Leary, Ph.D.	13
Keynote: Eric Klinenberg, Ph.D.	13
Special Events (Opening and Closing)	14
Steering Committee Invited Conversations	15
Division 39 Events and Meetings	18
Division 39 Section Events	20
Section I	20
Section II	20
Section III	20
Section IV	21
Section V	21
Section VI	22
Section VIII	22
Section IX	23
Division 39 Committee Events	24
Poster Session Presenters	30
Conference Program	
Wednesday, April 23	37
Thursday, April 24	39
Friday, April 25	53
Saturday, April 26	65
Sunday, April 27	79
Index of Presenters	87-107
Hotel Floor Plans	109-110
Registration Form	111-112

Welcome

Dear Colleagues:

It is our pleasure to welcome you to New York and to the 34th Annual Spring Meeting of Division 39.

Conflict is located at every layer of our experience—whether conceptualized within the structural or topographic models, intersubjectively determined emotional experience, the impact and constrictions of social norms and social traditions, or governments, spiritual beliefs, nations, and between factions of psychoanalysts.

Conflict is a foundation of individual suffering, familial in-fighting, membership and alienation, violence and war; while equally fundamental to clarification, contextualization, negotiation, illumination, celebration of differences, resolution and peace.

It is with these ideas in mind that we have put together our program. We invite you to reconsider conflict at all levels of experience. We envisioned and encouraged programming that promotes free-form dialogue and looks to create space for open discussion, disagreement, and clarification. We expect conflict in this environment to move past disagreement, toward a more complete understanding of one another's perspectives and a warm affiliation as companion clinicians and scholars interested in—and committed to—psychoanalysis.

To this end, we have included a **conference lounge**—a comfortable space to gather, interact, rest and reflect in the Central Park East room of the conference space. Here, everyday, you can lounge on comfortable chairs and couches with colleagues old and new, browse publications from our booksellers, and attend **Meet the Author** sessions. Informal, daily “Talk With Your Mouth Full” gatherings are planned during lunch where you can engage conference faculty in informal conversation.

Our invited **keynote** speakers come to us from within and outside of psychoanalysis. On Friday, **Dr. Kimberlyn Leary**, Associate Professor of Psychology in Psychiatry, Harvard Medical School, will speak “On the Arts of Conflict and Confligere (‘Striking Together’),” in which she will describe “natural” leaders and conscious and unconscious processes effective in working in and through organizations. On Saturday, **Dr. Eric Klinenberg**, Professor of Sociology, New York University, will present “Developmental Conflict? Going Solo: The Extraordinary Rise and

Surprising Appeal of Living Alone.” Running counter to conventional wisdom and some versions of developmental theory, he will introduce us to his research showing that those who do not partner or marry are hardly unhappy, disengaged, or necessarily troubled.

From the **Master Classes** and **Opening Event** panel on Wednesday, through the **Closing Event** panel midday Sunday, the conference schedule is rich in conflict, interaction, and opportunity for affiliation. We hope that you feel engaged and reluctant to miss a moment of the program. But do! You will be steps from Times Square and Central Park, and a short subway or cab ride to museums, restaurants, neighborhoods and locals, and we encourage those of you visiting New York to experience the warm and enriching conflicts to be found wandering among over 8 million residents and 20 million metro area neighbors.

On behalf of our hard-working Steering Committee and the Board of Directors of Division 39, we welcome you to the Spring Meeting and wish you warm, informative, engaged and affiliative conflict.

Sincerely,
Co-chairs 2014 Division 39 Spring Meeting



J.P. Chevront, Psy.D.



William D. Lubart, Ph.D.

Conference Information

Hotel

The Sheraton New York Times Square Hotel, 811 Seventh Avenue at 53rd Street, New York, NY has undergone a renovation since the last time the Division met there in 2011. Meeting space now sports new décor and improved lighting everywhere. Located between Central Park and Times Square in the center of the city, the Sheraton's new interior makes it a great meeting venue.

Division attendees can take advantage of the special room rate of \$299 single/double plus tax. Reservations can be made by copying and pasting the following link into your web browser: <https://www.starwoodmeeting.com/Book/APASpringMeeting>. All reservations must be made on or before **April 1, 2014**. Reservations made after this date cannot be guaranteed at the same rate.

Registration

Register online at the Division 39 website, www.division39.org. If you are using a credit card, you may fax your registration to 202-446-2965. If you are paying by check, please mail your registration form with your check. **We do not accept phone registrations.**

Note: All conference participants, including presenters, must register and pay the fee. There are no exceptions. There are no partial or day rate registrations.

Confirmation is emailed to each individual registrant. All questions regarding registration are to be directed to Natalie Shear Associates at 1 800-833-1354 x 4 or by email to Division39NY@natalieshear.com. There is a \$25 processing fee for credit cards and checks that are rejected, and, a \$50 onsite registration fee that is applied to everyone who has not registered in advance.

Graduate Students

All students **MUST** submit proof of their current full-time (student) status **WITH** registration. Without this proof, the registration will not be processed. “Proof” is an official document that has the school logo and/or letterhead that specifically states that you are enrolled full-time for the current semester or provides information (i.e., a paid bill or transcript, a letter from the registrar, etc.) that supports that enrollment. A student ID is NOT “proof.”

Institute Candidates

Candidates in analytic institutes who wish to register at the special fee must include with their registration form, a letter from an administrator at their Institute stipulating that you are a candidate in good standing in the first five years of your training.

If you are mailing or faxing your registration as a student or candidate, please submit the required "proof/letter" with it. If you are submitting your registration online, please submit the letter by fax to 202-446-2965 or by email to Hank@natalieshear.com.

Early Career Psychologists (ECP)

The Division offers a special registration fee to psychologists who have received their doctoral degree in April 2007 or later. Fees are listed on the Registration Form online at www.division39.org.

Registration Deadline

Registrations postmarked after April 16, 2014 will be returned. Do not mail or fax registrations after April 16. Registration after April 16 is only available on site at the conference hotel.

Refund Policy

Refund requests must be received in writing prior to April 1, 2014. Fees will be refunded less a \$75 processing fee. There will be no refunds made after April 1. Please email refund requests to Division39NY@natalieshear.com or fax to 202-446-2965.

Accessible Accommodations

Assistive Listening Devices, sign language interpreters and materials in alternate formats will be provided upon request for conference sessions. Please indicate your request on the Registration Form.

On-Site Registration

Anyone who has not registered prior to April 16, may do so on-site at the conference. There is an additional fee of \$50 for on-site registrations. There are no exceptions. All registration will take place on the second floor of the hotel in the Metropolitan Foyer. Please pick up your credentials and Continuing Education materials before attending any sessions. You will need these materials to receive Continuing Education credits.

Wednesday Master Classes and Conference Registration Hours

Wednesday, April 23	10:30 am-5:30 pm
Thursday, April 24	7:00 am-6:00 pm
Friday, April 25	7:00 am-5:00 pm
Saturday, April 26	7:00 am-5:00 pm
Sunday, April 27	7:00 am-11:00 am

Book Exhibitors

Exhibitors at press time include Association Book Exhibit, Austen Riggs Center, Karnac, Routledge and Routledge Journals. Please see their ads in this program. Exhibitors will be located in the Conference Lounge in Central Park East on the second floor of the hotel. Meet the Author sessions will also be held in that room.

Wednesday, April 23	Exhibitors Move In
Thursday, April 24	9:00 am-5:00 pm
Friday, April 25	8:00 am-6:00 pm
Saturday, April 26	8:00 am-5:00 pm
Sunday, April 27	9:00 am-Noon

Continuing Education Credits

The Division of Psychoanalysis is approved by the American Psychological Association to sponsor continuing education for psychologists. Division 39 maintains responsibility for these programs and their content.

Master Classes and Spring Meeting programs are open to all mental health professionals, and participants may receive continuing education credit for attending one or more of these programs. Wednesday Master Classes require registration separate from general registration for the Spring Meeting and are offered for additional fees. Participants from professions other than psychology should consult with their respective licensing boards regarding the acceptance of American Psychological Association-approved Certificates of Attendance as documentation of continuing education.

Complete descriptions of each Wednesday Master Class and other CE-eligible programs (title, presenter(s), learning objectives, instructional level) can be found on the Division 39 website: www.division39.org. The website will be the most complete source of information about CE-eligible programs, and participants are encouraged to check this site regularly for updates and/or additional information when making decisions about attending the Wednesday Master Classes and/or Spring Meeting programs offered from Thursday to Sunday.

For all CE-eligible programs, there is no partial credit for attending only a portion of an eligible program. To receive a Certificate of Attendance for any CE-eligible program, it is necessary to register for the Spring Meeting, have your badge scanned at the start of the program, attend the entire presentation, have your badge scanned at the conclusion of the program and return a completed evaluation form along with your log to the conference registration desk before you leave the conference. Instructions about any additional procedures will be posted on the Division 39 website (www.division39.org) and will be available at the Conference Registration Desk.

Each CE-eligible program is identified by a letter/number code (i.e., TH-1, FR-3, SA-5, SU-2) indicating the day of the presentation and its order in that day's schedule. This code will match the program's listing on the Continuing Education (CE) Log, which is each participant's official record of attendance at CE-eligible programs. Fifty-minute programs are not available for continuing education credits; other presentations that are not available for continuing education credits are identified as such. If interested in earning continuing education credits for

attending programs during the Spring Meeting, please request a Continuing Education Log at the Registration Desk.

Division 39 is committed to accessibility and non-discrimination in its continuing education activities and will conduct these in conformity with the American Psychological Association's Ethical Principles for Psychologists. There is no commercial support for any of the Wednesday Master Classes or Spring Meeting continuing education programs. All presenters have denied the existence of any relationships (i.e., based on program content, research, grants or other funding/support) that could be construed as conflicts of interest. Presenters of CE-eligible programs will address, whether during the program or via a list of references, the utility of the presentation content and the basis for their statement about this utility as well as the limitations and risks (common and most severe) associated with the program content. Presenters and participants are asked to honor the need for privacy and confidentiality throughout these programs. If program content becomes emotionally distressing, participants are encouraged to process these feelings during discussion periods. If participants have special needs, we will make reasonable attempts to accommodate them. Please contact Natalie Shear (natalie@natalieshear.com) with requests for accommodation. **Please contact Dr. Colin Ennis (chair of the Division 39's Continuing Education Committee) at div39ce@gmail.com or at the Registration Desk during the meeting itself for additional information about presenters, with questions and/or problems.**

Pre Conference Continuing Education Master Classes

Wednesday, April 23, 2014 • Advance Registration Required

Workshops are open to all mental health professionals. Participants will receive continuing education credit for these events. The Division of Psychoanalysis is approved by the American Psychological Association to offer continuing education for psychologists. Division 39 maintains responsibility for the program. Upon completing an evaluation form, participants will receive certificates of attendance for each class completed. Participants may register for one or more CE master classes, independent of registering for the Spring Meeting itself. This information is also available on the Division 39 website, www.division39.org. A full description of every master class along with learning objectives and biographical information on the presenters can also be found on the Division website. Please indicate on the registration form which sessions you will attend.

Introduction to Negotiation

Kimberlyn Leary, Ph.D., ABPP

12 Noon–3:15 PM • 3 credits • \$60

Room: Liberty 3

This workshop will teach participants the basic principles of resolving, managing, and transforming conflicts through negotiation. Although negotiation is sometimes still thought of as a “zero-sum” game in which the winner takes all, contemporary approaches stress that conflict is often a social process in which the people in dispute shape the nature of the problem by the way they talk about it, as well as by how they interact with one another. This workshop will be interactive and will include simulation exercises.

Presenting... Creating an Effective Presentation, from Proposal to Performance

Jill Bellinson, Ph.D.

12 Noon–3:15 PM • 3 credits • \$60

Room: Liberty 5

Presenting is an art, related to but different from the skill of writing a good paper. This workshop will describe and practice the art of presenting. It will include writing a proposal that is likely to be accepted by conference reviewers, composing a coherent address that will be understandable and informative to the audience, and

performing a talk in a manner that will catch and hold the interest of attendees. Workshop participants will have the opportunity to practice their art and improve their skills.

Controversies and Techniques in Treating Transgender Children and Adolescents

Jack Drescher, M.D.

Scott Quasha, Psy.D.

12 Noon–3:15 PM • 3 credits • \$60

Room: Liberty 4

This workshop will provide attendees with a review of sexual and gender minority terms used in work with transgender youth. A history of gender dysphoria, its current name in the DSM-5, will be discussed, along with its relation to the forthcoming ICD-11. Attendees will gain knowledge of controversies that transgender children and adolescents experience regularly within their home and school environments. An in depth look at best practices for working with transgender youth in a clinical setting will also be presented.

Starting a Practice: The How-To's of Setting Up a Psychodynamic Psychotherapy Practice (or Things They Never Taught You In Graduate School)

Devon King, Ph.D.

Tanya Hess, Ph.D.

Kristi Piekiewicz, Ph.D.

Paul Martin, Psy.D.

Brenda Lovegrove Lepisto, Psy.D.

Marilyn Charles, Ph.D., ABPP, Discussant

3:30 PM–5:00 PM • 1.5 credits • \$30

Room: Liberty 3

- From Business Cards to Liability Insurance and Everything in Between: How to Manage the Paper Side of your Private Practice
- Fill Your Practice—Using Social Media and Other Online Resources
- Providing Treatment and Collecting Money: Conflicts in Establishing a Financially Successful Practice
- Communication with Patients & Professionals: Business, Service, or Both?
- Preparing a Practice Will: Providing for Your Patients When You Can't

This workshop is free to students and Early Career Professionals who are members of Division 39.

Sexual Conflict in Couples: Discrepant Desires and Lost Attractions

Suzanne lasenza, Ph.D.

3:30 PM–6:45 PM • 3 credits • \$60

Room: Liberty 5

Some of the most challenging clinical moments for couples and therapists are when couples reveal discrepant sexual desire or an absence of sexual attraction. Attraction may be described as something that was once present but lost, something that never existed, or as a difficult struggle to manage feelings of physical disgust. Unlike sexual desire that may wax or wane depending on intrapsychic, interpersonal, developmental, or environmental factors, sexual attraction is often experienced as fixed and unchangeable. This workshop will discuss theory and techniques to help couples discover the sources of and solutions to discrepant desires and/or lost attractions that create internal or external conflict.

Working Multiculturally as a Psychoanalytic Practitioner

Usha Tummala-Narra, Ph.D.

3:30 PM–6:45 PM • 3 credits • \$60

Room: Riverside Ballroom

This workshop offers a framework that supports an understanding of individual, interpersonal and contextual factors as interrelated and critically important to psychoanalytic psychotherapy with individuals from diverse sociocultural backgrounds, including individuals from minority and majority backgrounds (e.g. racial and ethnic minorities, Whites, LGBT, heterosexual, lower income, middle class). Clinical material will be discussed with the aim of highlighting multiplicity of cultural experience of the client and the therapist and its implications for the therapeutic relationship.

Keynote Speakers

Friday, April 25 • 4–5:30 PM • Metropolitan Ballroom



On the Arts of Conflict and Confligere ('Striking Together')

Kimberlyn Leary, Ph.D., ABPP

Chief Psychologist, Cambridge Health Alliance, Associate Professor of Psychology in Psychiatry, Harvard Medical School

Effective leaders—those with authority or “natural” leaders without titles—typically orchestrate and manage conflict to create options that allow purposeful work to proceed. Followers, in turn, exert subtle pressures that alter the leader’s agenda. Thus, negotiation processes consciously and unconsciously enter into the practice of leadership and working in and through organizations. Dr. Leary will explore current changes in the health care milieu through the lens of conflict and negotiation.

Saturday, April 26 • 10–11:30 AM • Metropolitan Ballroom



Developmental Conflict? Going Solo: The Extraordinary Rise and Surprising Appeal of Living Alone

Eric Klinenberg, Ph.D.

Professor of Sociology and Director of the Institute for Public Knowledge, New York University

Exploring the contemporary world in which more than 33 million people live alone, Professor Klinenberg offers a conflicting argument to social scientists who interpret the spike in solo living as a sign of atomization and narcissism; he sees it as a result of our newfound social security and reinvigorated urban life. He emphasizes that living alone, being alone, and feeling isolated are three distinct conditions, and examines the causes as well as the surprising consequences of this dramatic social change.

Opening Event

Wednesday, April 23 • 8:00 PM–9:30 PM
Riverside Ballroom

Conflict in the Consulting Room: If It's Not Resistance, What Is It?

Frank L. Summers, Ph.D., ABPP
Joyce Slochower, Ph.D.
Peter Shabad, Ph.D.

Traditionally, when the agendas of the analyst and patient were in conflict, the patient was viewed as “resistant” to treatment. With the erosion of the epistemological position of the analyst as the “knower” and the patient as the “known,” the concept of resistance has fallen into disuse. Today, how do we conceptualize the patient’s rejection of the analyst’s understanding? This panel will open our conference with a stimulating discussion of critical issues derived from this therapeutic dilemma.

Closing Event

Sunday, April 27 • 11:00 AM–1:00 PM
Metropolitian Ballroom

Beyond Conflict: Psychoanalysts Reflect on The Good Life

Sandra Buechler, Ph.D.
Nancy McWilliams, Ph.D., ABPP
Jeffrey B Rubin, Ph.D.

We close the conference in which we’ve been focusing on the conflictual by thinking past conflict, to how psychoanalysis may contribute to a well-lived life. Beyond our traditional focus on conflicts and illness, do we as analysts recognize our internalized visions of psychological health? Do we, or should we, help patients to achieve optimal psychological well being and their flourishing? These three analysts will talk amongst themselves and with the audience about these questions.

Steering Committee Invited Conversations

Thursday, April 24 • 10–11:50 AM
Empire Ballroom East

Improvisations: Maintaining Attachment During Conflictual Moments in Treatment

Pamela Moller Kareman
Beatrice Beebe, Ph.D.
Spyros D. Orfanos, Ph.D., ABPP

In challenging, conflictual moments in treatment, improvisation can maintain the attachment between patient and therapist in ways that are transforming for the patient. Pamela Moller Kareman will talk about the significance of Meisner improvisation in theater, with two actors demonstrating this type of improvisation. Beatrice Beebe will demonstrate the significance of nonverbal communication in maintaining attachments and discuss the way these type of communication are embodied in the Meisner improvisations. Spyros Orfanos will discuss the merits of the formulation presented.

Friday, April 25 • 10–11:50 AM
Empire Ballroom East

Homosexuality, Psychoanalysis, and America: Conflict Revolution and Resolution?

Henry Abelove, Ph.D.
Philip Cushman, Ph.D.
Lynne Layton, Ph.D.

Over 30 years ago, Henry Abelove had difficulty finding a publisher for his paper “Freud, Male Homosexuality, and the Americans,” a work now recognized as a prescient critique that located then-held theoretical prejudices about homosexuality in interactions among culture, history, and theory. This panel invites Dr. Abelove to reflect publicly on his paper for the first time among psychoanalysts, and enlists Philip Cushman and Lynne Layton—both forward-thinking cultural critics and scholars—to consider his scholarship and subsequent changes in psychoanalysis and America, with an eye to cultural and historical contexts.

Friday, April 25 • 1–2:50 PM

Empire Ballroom East

Sitting with Conflict: Affect Tolerance and Disorders of Self-Care

Christine Anzieu-Premmereur, M.D., Ph.D.

Ann Slocum McEaney, Ph.D., ABPP

Andrew Tatarsky, Ph.D.

Panelists will explore Henry Krystal's view that traumatic failures in early object relations contribute to an inability to tolerate conflict, which is reflected in addictive behavior such as substance abuse and eating disorders. These disorders of self-care contain multiple meanings and functions; for example, eating disordered symptoms can be understood as a way to simplify the frightening complexities of the relational world. Using clinical vignettes, panelists will explore the therapeutic implications of these formulations and debate whether it is necessary to integrate techniques like mindfulness into psychodynamic treatment.

Saturday, April 26 • 1–2:50 PM

Empire Ballroom East

Sexual Boundary Violations: A Problem of the Group

Muriel Dimen, Ph.D.

in conversation with William D. Lubart, Ph.D.

Muriel Dimen will present her latest work on sexual boundary violations in psychoanalytic treatment, asserting that it is time to move on from our habitual reactive response upon discovering that sexual boundary violations are in our midst, but rather to consider them a shared dilemma—a problem of the group. Drawing on psychoanalysis, anthropology, social theory, and ethnomethodology, she will illuminate the dilemma these violations cause for analysts: a three-way split between silence, moral panic, and witch hunts.

Saturday, April 26 • 4–5:50 PM

Empire Ballroom East

“We Need to Talk”: Addressing Conflicts in our Relationship with the Medical Model

Ivan Bresgi, Ph.D.

Irwin Z. Hoffman, Ph.D.

Nancy McWilliams, Ph.D., ABPP

Donna Orange, Ph.D., Psy.D.

Jeremy Safran, Ph.D.

While psychoanalysis has evolved and transformed over the course of its history, its relationship with medically-infused thought and practice continues. Minds differ on whether a conflict between psychoanalysis and the medical model exists and, if it does, the exact nature of the problematic issues. This panel will be roundtable discussion exploring the nature and nuances of this ongoing relationship.

Division 39 Events and Meetings

Thursday, April 24

Board of Directors Meeting

8 AM–3 PM
Riverside Ballroom

Scholars Reception

3–4:15 PM
Central Park West

Scientific Award

4:30–5:20 PM
Metropolitan East
Award Recipient: Elliot Jurist, Ph.D., Ph.D.
Paper: **Mentalizing Conflict**

President's Address and Award Ceremony

5:30–6:50 PM
Metropolitan East

Awards Chair: Mary-Joan Gerson, Ph.D.

Award Recipients:

Leadership Award: Marsha McCary, Ph.D.
Diversity Award: Dolores Morris, Ph.D., ABPP

President's Address

Frank L. Summers, Ph.D., ABPP

Psychoanalysis and the Just Society

Welcome Reception

7–8:30 PM
Metropolitan West and Central Park
Featuring the music of the Ken Barish Jazz Quintet

Friday, April 25

Keynote Address

4–5:30 pm
Metropolitan Ballroom
Kimberlyn Leary, Ph.D.

On the Arts of Conflict and Confligere (“Striking Together”)

Saturday, April 26

Keynote Address

10–11:30 AM
Metropolitan Ballroom
Eric Klinenberg, Ph.D.

Developmental Conflict: Going Solo: The Extraordinary Rise and Surprising Appeal of Living Alone

Division 39 Section Events

Section I: Psychologist Psychoanalyst Practitioners

Invited Panel

Resentment as Cover Story: A Dialogue on Hidden Structures of Conflict

Friday, April 25, 1–2:50 PM

Lenox Ballroom

Board Meeting

Saturday, April 26, 4–6 PM

Park 1

Reception

Friday, April 25, 6–8 PM

Riverside Ballroom

Section II: Childhood and Adolescence

Invited Panel Co-sponsored with Committee on Multicultural Concerns

The Conflicting Role of the Juvenile and Welfare Systems in Caring for the Most Vulnerable Amongst Us

Saturday, April 26, 4–5:50 PM

Lenox Ballroom

Board Meeting

Saturday, April 26, 11:30 AM–12:50 PM

Park 2

Reception

Joint Reception with Section VIII

Saturday, April 26, 6–8 PM

Riverside Ballroom and Suite

Section III: Women, Gender and Psychoanalysis

Invited Panel

Lean In, Lean Out, or Stuck in the Middle? Inner Conflicts and External Realities for Women in the Workforce and in Treatment

Friday, April 25, 10–11:50 AM

Empire Ballroom West

Conversation Hour (Following Section III Panel)

Lean In, Lean Out, or Stuck in the Middle? Inner Conflicts and External Realities for Women in the Workforce and in Treatment

Friday, April 25, Noon–12:50 PM

Empire Ballroom West

Board Meeting

Sunday, April 27, 8–10 AM

Madison 3

Section IV: Local Chapters

Invited Panel

Conflict and Collision: Good Intentions and Hard Realities in Therapy with Foster Care Youth

Sunday, April 27, 8–9:50 AM

Liberty 5

Senate Meeting

Friday, April 25, 7–8:50 AM

Madison 3

Open Meeting

Saturday, April 26, 8–9:50 AM

Park 4

Section V: Applied Clinical Psychoanalysis

Invited Panel

Flexibility and Frame: Conflicts in the Application of Psychoanalytic Practices and Techniques in Extreme Circumstances

Saturday, April 26, 1–2:50 PM

Liberty 3

Board Meeting

Saturday, April 26, 3–5:00 PM

Park 5

Reception

Joint Reception co-sponsored by The Psychoanalytic Network (Section IX, Section V, Committee on Psychoanalysis and the Community, Committee on Multicultural Concerns and Committee on Sexualities and Gender Identities)

Saturday, April 26, 6:30–8:30 PM

Metropolitan Ballroom West

Section VI: Psychoanalytic Research Society

Invited Panel

How Findings from Clinical Research Enrich our Practice

Friday, April 25, 10–11:50 AM

Liberty 1 and 2

Scientific Poster Session

Thursday, April 24, 6:30–8 PM

Metropolitan Ballroom

Section VIII: Couple and Family Therapy and Psychoanalysis

Invited Panel

Trauma & Truth Seeking: A Play Reading & Discussion of 'The Great God Pan'

Thursday, April 24, 10–11:50 AM

Liberty 3

Conversation Hour

Trauma & Truth Seeking Part II: A Play Reading & Discussion of 'The Great God Pan'

Thursday, April 24, Noon–12:50 PM

Liberty 3

Board Meeting

Sunday, April 27, 9–11 AM

Madison 2

Reception

Joint Reception co-sponsored with Section II

Saturday, April 26, 6–8 PM

Riverside Ballroom and Suite

Section IX: Social Responsibility

Invited Panel

Racial Dialogues: Rupture and Repair

Thursday, April 24, 1–2:50 PM

Liberty 5

Board Meeting

Thursday, April 24, 3–5 PM

Liberty 1 and 2

Special Meeting

Thursday, April 24, 8–9:50 AM

Park 1

Reception

Joint Reception co-sponsored by The Psychoanalytic Network (Section IX, Section V, Committee on Psychoanalysis and the Community, Committee on Multicultural Concerns and Committee on Sexualities and Gender Identities)

Saturday, April 26, 6:30–8:30 PM

Metropolitan Ballroom West

Division 39 Committee Events

American Board and Academy of Psychoanalysis (ABAPsa)

Board Meeting

Saturday, April 26, 8 AM–Noon
Park 5

Archives Task Force

Friday, April 25, 10 AM–Noon
Madison 5

Awards Committee

Friday, April 25, Noon–12:50 PM
Liberty 4

Candidate Outreach Committee

Invited Panel

Growing Pains, Growing Gains: Conflicts and Pleasures of Psychoanalytic
Candidacy

Saturday, April 26, 1–2:50 PM
Liberty 5

Board Meeting

Saturday, April 26, 5–6:00 PM
Park 2

Reception

Friday, April 25, 5:30–6:30 PM
Presidential Suite

President's Reception for Candidates, Graduate Students and Early Career Psychologists

Friday, April 25, 6:30–8:30 PM
Empire Ballroom

Committee on Education and Training

Invited Panel

Psychoanalytically-Oriented Research & Practice: Is There Conflict?

Thursday, April 24, 8–9:50 AM
Liberty 4

Board Meeting

Thursday, April 24, 4–5 PM
Park 1

Committee on Humanities and Psychoanalysis

Invited Panel

Tapping the Intuitive: Play, Creativity, and Conflict in the Theater Space—
An Interactive Experience for Psychoanalysts

Friday, April 25, 8–9:50 AM
Liberty 1 and 2

Committee on Infant Mental Health

Invited Panel

Distress, Discrepancy and Conflict in the Origins of Disorganized Attachment

Thursday, April 24, 8–9:50 AM
Liberty 1 and 2

Committee on International Relations in Psychoanalytic Psychology

Invited Panel

Is Psychoanalysis also a Spiritual Discipline?

Saturday, April 26, 8–9:50 AM
Liberty 5

Board Meeting

Saturday, April 26, 11:30 AM–12:50 PM
Park 4

Committee on Multicultural Concerns

Invited Panel Co-sponsored with Section II

The Conflicting Role of the Juvenile and Welfare Systems in Caring for the Most
Vulnerable Amongst Us

Saturday, April 26, 4–5:50 PM
Lenox Ballroom

Invited Panel

Conflict Avoidance within Psychoanalysis: A Collaborative Discussion

Sunday, April 27, 8–9:50 AM

Lenox Ballroom

Board Meeting

Friday, April 25, 2–3:50 PM

Carnegie Suite West

Reception

Joint Reception co-sponsored by The Psychoanalytic Network (Section IX, Section V, Committee on Psychoanalysis and the Community, Committee on Multicultural Concerns and Committee on Sexualities and Gender Identities)

Saturday, April 26, 6:30–8:30 PM

Metropolitan Ballroom West

Committee on Psychoanalysis and the Community

Invited Panel

Psychoanalysts in Action: The Influence of Psychoanalysis Beyond the Consulting Room

Friday, April 25, 10–11:50 AM

Riverside Suite

Conversation Hour

Caring for the Caregivers

Friday, April 25, Noon–12:50 PM

Riverside Suite

Board Meeting

Thursday, April 24, Noon–12:50 PM

Park 1

Reception

Joint Reception co-sponsored by The Psychoanalytic Network (Section IX, Section V, Committee on Psychoanalysis and the Community, Committee on Multicultural Concerns and Committee on Sexualities and Gender Identities)

Saturday, April 26, 6:30–8:30 PM

Metropolitan Ballroom West

Committee on Psychoanalysis and Health Care

Invited Panel

The Dying Parent: Conflicts in the Analyst's Life and Work

Saturday, April 26, 8–9:50 AM

Liberty 4

Board Meeting

Saturday, April 26, 11:30 AM–12:50 PM

Liberty 4

Committee on Sexualities and Gender Identities

Invited Panel

From Hiding to Priding: Intergenerational Queer Perspectives on Sexuality and Gender Conflicts in Training and Supervision

Friday, April 25, 1–2:50 PM

Liberty 5

Board Meeting

Saturday, April 26, 11:30 AM–12:50 PM

Park 3

Reception

Joint Reception co-sponsored by The Psychoanalytic Network (Section IX, Section V, Committee on Psychoanalysis and the Community, Committee on Multicultural Concerns and Committee on Sexualities and Gender Identities)

Saturday, April 26, 6:30–8:30 PM

Metropolitan Ballroom West

Early Career Psychologists Committee

Invited Panel

Engendering Our Voices: How Sexual and Gender Identity Shape the Early Career Experience

Saturday, April 26, 4–5:50 PM

Liberty 1 and 2

Board Meeting

Saturday, April 26, 11:30 AM–12:50 PM

Liberty 1 and 2

Reception

President's Reception for Early Career Psychologists, Graduate Students and Candidates

Friday, April 25, 6:30–8:30 PM

Empire Ballroom

Ethics Committee

Invited Panel

Sexual Boundary Violations: Causes and Effects

Friday, April 25, 1–2:50 PM

Liberty 4

Board Meeting

Friday, April 25, Noon–1:00 PM

Madison 4

Graduate Student Committee

Invited Panel

The Dynamics of the Supervisory Relationship: A Live Demonstration

Saturday, April 26, 8–9:50 AM

Lenox Ballroom

Invited Panel

The Digital Age (Like, Text, Post, Share) Comes to Treatment: Clinical Dilemmas, Conflicts and Opportunities

Saturday, April 26, 1–2:50 PM

Madison 1

Special Workshops for Graduate Students

Workshop I: Kimberlyn Leary, Ph.D.

Friday, April 25, 3–3:50 PM

Metropolitan Ballroom

Workshop II: Eric Klinenberg, Ph.D.

Friday, April 25, 11:45 AM–12:50 PM

Lenox Ballroom

Reception

President's Reception for Graduate Students, Candidates and Early Career Psychologists

Friday, April 25, 6:30–8:30 PM

Empire Ballroom

Program Committee

TBA

Psychoanalytic Psychology Editorial Board

Sunday, April 27, 9–10:30 AM

Madison 1

Publications Committee

Sunday, April 27, 7:30–8:50 AM

Madison 1

Poster Session Presenters

Conflicts: Indigenous Videos, Anthropology and Psychoanalysis

Erika Thomas, Ph.D.

FLSH Lille University Catholique, Lille, France

A Theoretical Study of the Basic Schizoid Condition

Teo Weingrill Araujo, Ph.D.

University of São Paulo, São Paulo, Brasil

Psychoanalytic and Neuroscience Perspectives of Borderline Personality Disorder: An Integration

Alex Smith, MFA, M.Psy.

George Washington University, Washington, DC

The Role of Emotion Regulation and Peer Social Support on the Relationship between Death and later Internalizing and Externalizing Problems

Megan M. Jensen, M.A.

University of the Pacific, Stockton, CA

An Exploratory Analysis of Reflective Functioning in Parents Involved in the Child Welfare System

Sarah R. Heilman, M.A.

Adelphi University, Garden City, NY

Cheryl Arbitelli-McAuliffe, Ph.D., LMSW

Adelphi University, Garden City, NY

Laura DeRose, Ph.D.

Adelphi University, Garden City, NY

Marcy Safyer, LCSW-R, MSW

Adelphi University, Garden City, NY

The Role of Maladaptive Defense Styles in Alcohol Use Disorders and Impulsiveness

Skultip Sirikantraporn, Psy.D.

Alliant-California School of Professional Psychology, San Diego, CA

William Gottdiener, Ph.D.

John Jay College of Criminal Justice, New York, NY

Changes in Thought Measured by New Matrix of Psychic Experience

Sophia Frydman, M.A.

Derner Institute, Adelphi University, Brooklyn, NY

Towards a New Understanding of Countertransference: An Inquiry into Countertransference Reactions in Community Mental Health

David A. Cushman, M.A.

Wright Institute, Berkeley, CA

The Impact of Defensive Style and Religious Coping on Trauma and Substance Use

Tracy A. Prout, Ph.D.

John Jay College of Criminal Justice, New York, NY

William Gottdiener, Ph.D.

Ferkauf Graduate School of Psychology, Bronx, NY

Pregnancy, Motherhood, and Career: Negotiating Maternal Desires and Professional Ambition

Leigh G. Lyndon, Psy.D.

Wright Institute, Berkeley, CA

Femininity and Resistance in Mother-Daughter Differentiation Processes

Victoria Sliva, M.A.

The New School for Social Research, New York, NY

Artifacts and Identity in a Military Psychotherapeutic Setting

Paul Daanen, M.Sc

Dept. of Behavioral Health, Madigan Army Medical Center, Tacoma, WA

Jackie Hammelman, M.S.

Dept. of Behavioral Health, Madigan Army Medical Center, Tacoma, WA

Jeremy Noble, M.A.

Dept. of Behavioral Health, Madigan Army Medical Center, Tacoma, WA

The Effect of Subliminal Psychodynamic Activation on Implicit Racial Bias

Philip J. Bender, B.A.

Adelphi University, Garden City, NY

Joel Weinberger, Ph.D.

Adelphi University, Garden City, NY

Psychic Ossification: An Investigation of Autistic and Traumatic Memories

Philip T Van Zile IV

The Derner Institute, Adelphi University, Garden City, NY

Interaction Structures and Clinical Outcomes in the Psychodynamic Treatment of a Child with Asperger's Disorder Across Two Therapists

Laura Athey-Lloyd, Psy.D.

Long Island University, C.W. Post, Brookville, NY

Intimacy in Witnessing: A Qualitative Analysis of Psychotherapists' Experiences Bearing Witness

Stacey M. Boyer, MA

Widener University Institute for Graduate Clinical Psychology, Chester, PA

Investigating the Conflictive Self: Philosophical Underpinnings of an Authenticity Psychometric

Morgun Custer, B.A.

University of Tennessee at Knoxville, Knoxville, TN

Transference Dreams of Graduate Students: A Phenomenological Analysis

Elizabeth L. Schewe, M.A.

Pacifica Graduate Institute, Carpinteria, CA

Who Falls Through the Clinical Cracks: Exploring Under-served Populations and Mental Health Services

Megan A. Nesbitt, M.Psy.

The George Washington University, Washington, DC

Elizabeth Bowen, M.A.

The George Washington University, Washington, DC

Cheri Marmarosh, Ph.D.

The George Washington University, Washington, DC

Crystal Taylor, M.S.

The George Washington University, Washington, DC

The Subjective Experience of Adolescents in Residential Milieu Therapy at Bettelheim's Orthogenic School

Elizabeth Scholom

Adelphi University, Garden City, NY

Psychoanalytic Theory and Transgender Lived Experience: Conflicting Realities

Rhonda J. Factor, Ph.D.

NYU Postdoctoral Program, New York, NY

When a Man Loves a Beer: Gender Differences in Attitudes Toward Substance Use

Masha Borovikova, M.A., M.F.A.

Adelphi University, Garden City, NY

Betrayal Trauma Predicts Dimensions of Pathological Narcissism

Matthew M. Yalch, M.A.

Michigan State University, East Lansing, MI

Alytia A. Levendosky, Ph.D.

Michigan State University, East Lansing, MI

The Rise and Fall of Psychic Conflict: A Corpus-Based Exploratory Study of Psychoanalytic Literature

Loren Dent, M.A.

New School for Social Research / Beth Israel Hospital, New York, NY

Christopher Christian, Ph.D.

New School for Social Research / Beth Israel Hospital, New York, NY

Racial Conflict: The Impasse of White Privilege in a "Color-Blind" World and Unconscious Racial Bias

Shannon Carter, M.S.

Pacific University, Portland

Comparing Defense Styles Using Two Measures: Using Online Research for Psychodynamic Properties

Andrea S. Rodrigues, M.A.

CUNY Graduate Center/John Jay College of Criminal Justice, New York, NY

Psychological Parentification and Fear of Intimacy

Christine Ahn, Ph.D.

Sogang University, Seoul, Korea

Hyunsu Jeon, M.A.

Sogang University, Seoul, Korea

Investigating Maternal Intrusiveness as Risk Factors for Psychological Adjustment

Christine Ahn, Ph.D.

Sogang University, Seoul, Korea

Sungeun Baek, M. A.

Sogang University, Seoul, Korea

Routledge Psychoanalysis Journals

As one of the leading publishers of Psychoanalysis literature, Routledge publishes an extensive and diverse range of journals, bringing together the best research on all aspects of Psychoanalysis and related fields.

For more information on each of the journals in our Psychoanalysis collection, visit the Routledge Psychoanalysis Arena:

www.routledgejournalhealth.com/Psychoanalysis



New to
Routledge
in 2014!

Contemporary Psychoanalysis
Editors-in-Chief: Don Greif, PhD and
Ruth H. Livingston, PhD
www.tandfonline.com/UUCP



Psychoanalytic Perspectives
Editors-in-Chief: Steven Kuchuck, LCSW
and Deborah Pines, LCSW
www.tandfonline.com/UPPE



Psychoanalytic Inquiry
Editor-in-Chief: Joseph Lichtenberg, MD
Editor: Melvin Bornstein, MD
www.tandfonline.com/HPSI



Psychoanalytic Dialogues
Editors: Anthony Bass, PhD,
Hazel Ipp, PhD, and
Stephen Seligman, DMH
www.tandfonline.com/HPSD

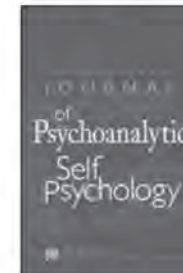

**International Journal of
Psychoanalytic Self Psychology**
Editors: William J. Coburn, PhD, PsyD
and Roger Frie, PhD, PsyD, RPsych
www.tandfonline.com/HPSD



**Journal of Infant, Child, and
Adolescent Psychotherapy**
Editor: Susan Warshaw, PhD
www.tandfonline.com/HICP



Studies in Gender and Sexuality
Editor: Muriel Dimen, PhD
www.tandfonline.com/HSGS

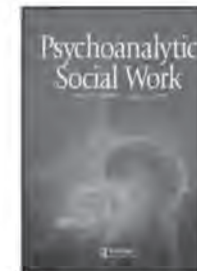

Psychoanalytic Social Work
Editor-in-Chief:
Jerrold R. Brandell, PhD, BCD
www.tandfonline.com/WPSW

Routledge Psychoanalysis is Now on Facebook!
www.facebook.com/RoutledgePsychoanalysis

20% Discount with this flyer

Order online using discount code **MRK83**

NEW & FORTHCOMING titles from Routledge

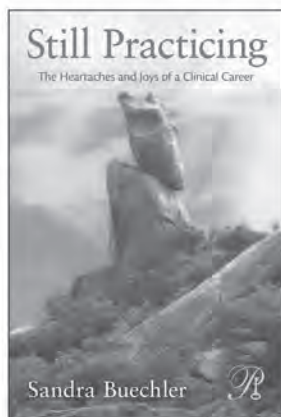
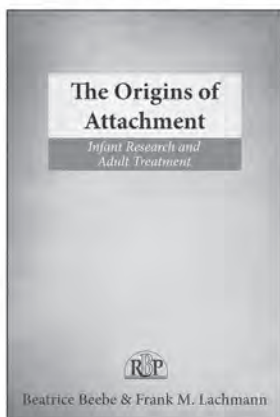
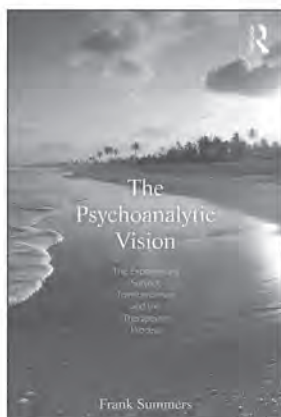
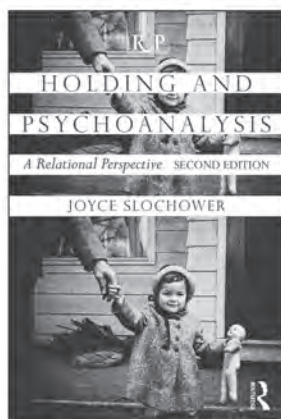
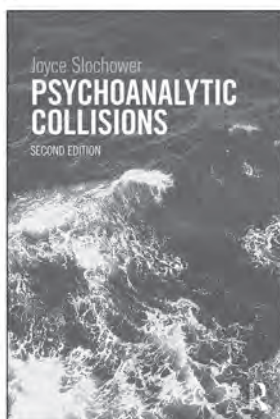
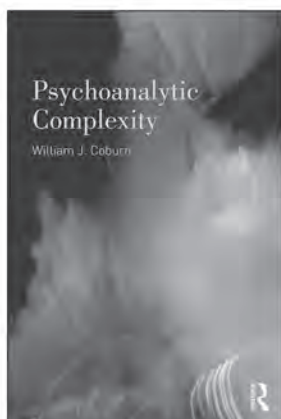
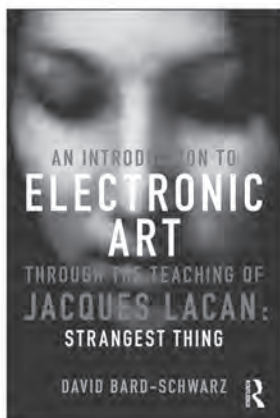
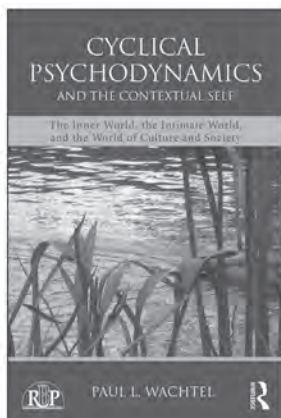

Routledge
Taylor & Francis Group

www.routledgejournalhealth.com

conflict

WEDNESDAY APRIL 23

12–3:15 PM

Liberty 3

Continuing Education Master Classes

Introduction to Negotiation

Kimberlyn Leary, Ph.D., ABPP, *presenter*

12–3:15 PM

Liberty 5

Continuing Education Master Classes

Presenting...Creating an Effective Presentation, from Proposal to Performance

Jill Bellinson, Ph.D., *presenter*

12–3:15 PM

Liberty 4

Continuing Education Master Classes

Controversies and Techniques in Treating Transgender Children and Adolescents

Jack Drescher, M.D., *presenter*

Scott Quasha, Psy.D., *presenter*

3:30–5 PM

Liberty 3

Continuing Education Master Classes

Starting a Practice: The How-To's of Setting Up a Psychodynamic Psychotherapy Practice (or Things They Never Taught You In Graduate School)

Devon King, Ph.D., *presenter*

Tanya Hess, Ph.D., *presenter*

Kristi Pikiewicz, Ph.D., *presenter*

Paul Martin, Psy.D., *presenter*

Brenda Lovegrove Lepisto, Psy.D., *presenter*

Marilyn Charles, Ph.D., ABPP *discussant*

WEDNESDAY APRIL 23

3:30–6:45 PM

Liberty 5

Continuing Education Master Classes

Sexual Conflict in Couples: Discrepant Desires and Lost Attractions

Suzanne lasenza, Ph.D., *presenter*

3:30–6:45 PM

Riverside Ballroom

Continuing Education Master Classes

Working Multiculturally as a Psychoanalytic Practitioner

Usha Tummala-Narra, Ph.D., *presenter*

8–9:30 PM

Riverside Ballroom

Opening Event

Conflict in the Consulting Room: If it's not Resistance, What is it?

Frank L. Summers, Ph.D., ABPP

Joyce Slochower, Ph.D., ABPP

Peter Shabad, Ph.D.

KARNAC BOOKS
PUBLISHING FOR THE MIND

Please visit our stand in the exhibition area for a comprehensive selection of new and classic psychoanalytical titles, or to talk to our representatives about publishing your book with Karnac.

www.karnacbooks.com

conflict

THURSDAY APRIL 24

8–9:50 AM

Empire East

Panel

TH-1 Who Is That in the Mirror? The Conflicted Self and the Shaming Eye of Self-Consciousness

Margaret Crastnopol, Ph.D.

Like Flies in a Saucer of Milk: Conflicting Efforts to Vanquish Shame

Sandra Buechler, Ph.D.

Will I Still Be Me? Conflicts Between Aging and the “Good Me”

Peter Shabad, Ph.D.

Divided Against Oneself: The Petrifying Eye of Self-Consciousness and Inaction

Dodi Goldman, Ph.D., *moderator*

8–9:50 AM

Lenox Ballroom

Panel

TH-2 Revisiting Searles: Conflict and Mutual Change in the Analytic Relationship

Heather Ferguson, L.C.S.W.

Welcome the Messenger: Non-Conscious Conflict in the Analytic Dyad

Sarah Mendelsohn, L.C.S.W.

Beyond Mutual Healing: Conflict and Aloneness in the Analytic Relationship

Adrienne E. Harris, Ph.D., *discussant*

Malcolm Slavin, Ph.D., *discussant*

THURSDAY APRIL 24

8–9:50 AM

Liberty 1 and 2

Committee on Infant Mental Health

TH-3 Distress, Discrepancy and Conflict in the Origins of Disorganized Attachment

Beatrice Beebe, Ph.D.

8–9:50 AM

Liberty 3

Panel

TH-4 The Fate of Bad-Analyst Feelings: Imagination and Emotional Thinking Within a Context of Conflict

Noelle Burton, Psy.D.

Deep Diving: Using the Therapist's Imagination to Move From Conflict at the Surface to the Development of Reflective Functioning

Christopher Bonovitz, Psy.D.

Developing an Inner Space for Imagination: The Analyst's Conflict Between Deadness & Aliveness

Steven Cooper, Ph.D., *moderator*

8–9:50 AM

Liberty 4

Committee on Education and Training Panel

TH-5 Psychoanalytically-Oriented Research & Practice: Is There Conflict?

Robert F. Bornstein, Ph.D.

Toward a Firmer Foundation for Psychoanalytic Practice

William H. Gottdiener, Ph.D.

Toward a Unified Psychoanalysis

Jeremy D. Safran, Ph.D.

Rethinking the Nature of the Relationship Between Psychoanalysis & Empirical Research

David I. Downing, Psy.D., ABPP, *moderator*

8–9:50 AM

Liberty 5

Panel

TH-6 “Kids! What the Devil’s Wrong with These Kids Today?!” Emerging Adults, Millennial Narcissists, the “Me Generation,” Failures to Launch, and What Young, Psychoanalytically-Oriented Clinicians Have to Say About Them

Laura Athey-Lloyd, Psy.D.

Dana Goren, Ph.D.

Exploration or Procrastination: The Impact of Early Relational Conflicts on Emerging Adults

Hillary Lewin Tuvia, Ph.D.

Dafna Fuchs, Ph.D.

The Capacity to Be Alone in the Era of Social Networks

Erin Jeanette, Ph.D.

Young Adults and the Ways We Talk About Them: Normalizing, Pathologizing and the Lost Space of Social Critique

Steven Tuber, Ph.D., *discussant*

8–9:50 AM

Park 1

Section IX Special Meeting

8 AM–3 PM

Riverside Ballroom

Board of Directors Meeting

10–11:50 AM

Empire East

Steering Committee Invited Conversation

TH-7 Improvisations: Maintaining Attachment During Conflictual Moments in Treatment

Arthur A. Gray, Ph.D.

Pamela Moller Kareman

Beatrice A. Beebe, Ph.D.

Embodying Nonverbal Communication: Insights from Infant Research

Spyros D. Orfanos, Ph.D., ABPP, *discussant*

Arthur A. Gray, Ph.D., *chair and moderator*

10–11:50 AM

Empire West

Panel

TH-8 Dreaming as an Illustration of Relational Conflict

Sheldon Itzkowitz, Ph.D., ABPP

Dissociated Relational Conflict: Encounters with Dream Characters Caught in the Act

Elizabeth Howell, Ph.D.

Dreams as a Window Into Psychic Structure and the Unconscious: How Hidden Conflict Among Dissociated Self-States Emerges in Dream Work

Judith Alpert, Ph.D.

Complexity Upon Complexity Upon Complexity: Many Dreamers, Many Witnesses, Many Associations

Judith Alpert, Ph.D., *moderator*

Sheldon Itzkowitz, Ph.D., ABPP, *moderator*

10–11:50 AM

Lenox Ballroom

Panel

TH-9 Men and Infertility: The Silent Conflict

Philip A. Ringstrom, Ph.D., Psy.D.

Male Infertility: “Between the Doer and the Can’t Do”—A Tortured Conflict

Galit Atlas, Ph.D.

Male Infertility: A Silent Struggle

Steven Kuchuck, L.C.S.W., *moderator*

10–11:50 AM

Liberty 1 and 2

Panel

TH-10 The Youth Shall Seek Vision: Leveraging the Therapeutic Relationship with Emerging Adults

Jill Putterman, Ph.D., *discussant*

Dreams & Illusions: Working with Young Adults

Judy Roth, Ph.D. P, *moderator*

Engaging the Topographies of Bicultural Young Adults

10–11:50 AM

Liberty 3

Section VIII Panel

TH-11 Trauma & Truth Seeking: A Play Reading & Discussion of ‘The Great God Pan’

Robert Schulte, M.S.W.

John Dluhy, M.D.

Mary Dluhy, M.S.W.

Kavita Avula, Psy.D.

Yavar Moghimi, M.D.

Rob Williams, L.I.C.S.W.

Liz Marsh, L.I.C.S.W.

Rosemary Segalla, Ph.D.

Mary-Joan Gerson, Ph.D., *chair and moderator*

10–11:50 PM

Liberty 4

Panel

TH-12 Generational Conflicts: When Secrets Continue to Haunt

Jill Salberg, Ph.D.

Ghostly Trauma Transmissions: When Theories Collide

Ruth Lijtmaer, Ph.D.

The Secret Box

Sue Grand, Ph.D., *moderator*

10–11:50 AM

Liberty 5

Panel

TH-13 Baring Outer Conflicts and Bearing Inner Conflicts: Revenge and Forgiveness Among Lesbian, Gay, and Bisexual Individuals and Perpetrators of Hate

Scott D. Pytluk, Ph.D.

Notes on Revenge and Forgiveness in the Lives of Gay Men

Stephen Wanhg, M.F.A.

Victims, Perpetrators and Witnesses in Conflict

Neil E. Altman, Ph.D., *discussant*

12–12:50 PM

Various Rooms

Talk With Your Mouth Full

12–12:50 PM

Park 1

Committee on Psychoanalysis and the Community Board Meeting

1–1:50 PM

Park 2

Colloquy

I Think, Therefore I Am Not Alone: The Emergence of Obsessional Thinking in Treatment

Amy Joelson, L.C.S.W.

Ruth Burtman, Ph.D., *discussant*

1–1:50 PM

Park 3

Colloquy

Conflict in the Psychic Development of Twins

Ruth Simon, Ph.D.

There is No Such Thing as a Baby: A Discussion

1–1:50 PM

Park 1

Colloquy

Reverberating Conflict in the Clinician and the Clinic: How Group Consultation Can Transform the Institutional Enactment of Trauma and Despair

Leeann Borton Harvey, Ph.D.

1–1:50 PM

Central Park East

Meet the Author

Traumatic Narcissism: Relational Systems of Subjugation

Daniel Shaw, L.C.S.W.

1–1:50 PM

Central Park East

Meet the Author

Understanding and Coping with Failure: Psychoanalytic Perspectives

Rebecca C. Curtis, Ph.D.

1–1:50 PM

Central Park East

Meet the Author

Treating Trauma: Relationship-Based Psychotherapy for Children, Adolescents, and Young Adults

Toni V. Heinemen, D.M.H.

1–1:50 PM

Central Park East

Meet the Author

Mutuality, Recognition and the Self

Christine C. Keiffer, Ph.D., ABPP

1–1:50 PM

Central Park East

Meet the Author

Clinical Implications of the Psychoanalyst's Life Experience

Steven Kuchuck, L.C.S.W.

1–2:50 PM

Empire West

Panel

TH-14 Conflicting Views on the Female Body in Psychoanalytic Treatment: A Case Presentation and Three Reactions

Susan Kolod, Ph.D.

Rosemary Balsam, M.D.

Leon Hoffman, M.D.

Megan Poe, M.D., *case presenter*

1–2:50 PM

Empire East

Panel

TH-15 Courage, Conflict, and Mastery in the Practice of Psychoanalytically-Oriented Psychotherapy

Barry Farber, Ph.D.

What Clinical Situations Require Courage? Perceptions of Beginning Psychotherapists

Valery Hazanov, M.Phil

OK, Thanks: Reflections on Therapeutic Courage in Work With a Psychotic Patient

Jesse D. Geller, Ph.D.

Courage in the Psychotherapist

Phillip Blumberg, Ph.D., *moderator*

1–2:50 PM

Lenox Ballroom

Panel

TH-16 Looking Forward to the Psychic Future: Conflict and Creativity in Enactment

Lewis Aron, Ph.D., ABPP

Galit Atlas, Ph.D.

Memories From the Future: The Prospective Function of Enactment

Sophia Richman, Ph.D., ABPP

Spyros D. Orfanos, Ph.D., ABPP

The Future Ain't What it Used to Be: On Encactments, Stalking, and Art

1–2:50 PM

Liberty 3

Panel

TH-17 Sparks Can Fly! Conflict, Integration, Growth: The Heart of Adolescent Treatment

Jacqueline Gotthold, Psy.D.

Treating Adolescents' Conflict: Theirs or Ours

Susi Federici-Nebbiosi, Ph.D., *moderator*

Shelley Doctors, Ph.D., *discussant*

1–2:50 PM

Liberty 4

Panel

TH-18 Cultural Conflict as Enactment: Identification and Working Through

Mamta B. Dadlani, Ph.D., *moderator*

Matthew LeRoy, Psy.D.

1–2:50 PM

Liberty 5

Section IX Panel

TH-19 Racial Dialogues: Rupture and Repair

Sue Grand, Ph.D.

Skin Memories: Race, Love and Loss

Janice Gump, Ph.D.

What Must Be Done for the Ghosts' Demise

Kimberlyn Leary, Ph.D., ABPP

Contextualizing Culture

Jill Salberg, Ph.D., *moderator*

1–2:50 PM

Park 4

Panel

TH-20 Do the Privileged Experience Conflict? Thoughts on the Participation of Privileged Individuals in Multicultural Discourse

Almas Merchant, Ph.D.

Paul Martin, Psy.D.

Nina K. Thomas, Ph.D., ABPP

2–2:50 PM

Park 1

Colloquy

When Individual and Couples Therapies Collide: Enactment, Dissociation and Reconciliation

Stacy Malin, Ph.D.

Elizabeth Ochoa, Ph.D.

2–2:50 PM

Park 2

Colloquy

Animals: The Life and Work of Vamik Volkan

Molly S. Castelloe, Ph.D.

2–2:50 PM

Park 3

Colloquy

Avoiding Intrapsychic Conflict About the Animals We Choose to Eat

Stephen Shainbart, Ph.D.

Millions of Americans Dissociating at Once: How We Avoid Experiencing Distress About the Animals We Eat Daily

2–2:50 PM

Central Park East

Meet the Author

Keeping Couples in Treatment: Working from Surface to Depth

Carl Bagnini, M.S.W.

2–2:50 PM

Central Park East

Meet the Author

A Relational Psychoanalytic Approach to Couples Psychotherapy

Philip A. Ringstrom, Ph.D., Psy.D.

2–2:50 PM

Central Park East

Meet the Author

The Embodied Analyst: From Freud and Reich to Relationality

Jon Sletvold, Psy.D., *author*
Adrienne E. Harris, Ph.D., *editor/presenter*

2–2:50 PM

Central Park East

Meet the Author

Body-States: Interpersonal and Relational Perspectives on the Treatment of Eating Disorders

Jean Petrucelli, Ph.D.

2–2:50 PM

Central Park East

Meet the Author

The Klein-Winnicott Dialectic: Transformative Metapsychology and Interactive Clinical Theory

Susan Kavalier-Adler, Ph.D., ABPP, D.Litt

3–3:50 PM

Central Park East

Meet the Author

Contemporary Psychoanalysis and the Legacy of the Third Reich: History, Memory, Tradition

Emily A. Kuriloff, Psy.D.

3–3:50 PM

Central Park East

Meet the Author

Daydreams and the Function of Fantasy

Meta J. Regis, Ph.D.

3–3:50 PM

Central Park East

Meet the Author

Emotional Communication: Countertransference Analysis and the Use of Feeling in Psychoanalytic Technique

Paul Geltner, D.S.W.

3–3:50 PM

Central Park East

Meet the Author

Still Practicing: The Heartaches and Joys of a Clinical Career

Sandra Buechler, Ph.D.

3–3:50 PM

Central Park East

Meet the Author

Infant Research and Neuroscience at Work in Psychotherapy

Judith Rustin, L.C.S.W.

3–5 PM

Liberty 1

Section IX Board Meeting

3–4:15 PM

Central Park West

Division Scholars Reception

4–5 PM

Park 1

Committee on Education and Training Board Meeting

4:30–5:20 PM

Metropolitan East

Scientific Award

Award Recipient: Elliot Jurist, Ph.D., Ph.D.

Mentalizing Conflict



Elliot Jurist, Ph.D., Ph.D. is Professor of Psychology and Philosophy and served as the Director of the Clinical Psychology Doctoral Program at the City University of New York from 2004–2013. He is the author of *Beyond Hegel and Nietzsche: Philosophy, Culture and Agency* (MIT Press, 2000) and co-author of *Affect Regulation, Mentalization and the Development of the Self* (Other Press, 2002), the latter of which has been translated into five languages and won two book prizes. He is also the co-editor of *Mind to Mind: Infant Research, Neuroscience, and Psychoanalysis* (Other Press, 2008) and author of numerous articles and reviews. His research interests concern mentalization and the role of emotions and emotion regulation in psychotherapy. Since 2008, he is the Editor of *Psychoanalytic Psychology*. He is the editor of a new book series, *Psychoanalysis and Psychological Science*, from Guilford Publications, and author of a forthcoming book, *Mentalized Affectivity*, from the same publisher.

5:30–6:50 PM

Metropolitan Ballroom

President's Address and Award Ceremony

Awards Chair: Mary-Joan Gerson, Ph.D.

Award Recipients

Leadership Award: Marsha McCary, Ph.D.

Diversity Award: Dolores Morris, Ph.D., ABPP

President's Address: Frank L. Summers, Ph.D., ABPP

Psychoanalysis and the Just Society

Awardees



Marsha McCary, Ph.D.

Marsha McCary is in independent practice in Austin, TX. She offers a broad range of therapeutic service to adults and couples, and provides supervision and consultation to other mental health professionals and graduate students. She has a Ph.D. in clinical psychology, University of Texas at Austin, and postdoctoral certification from British Object Relations, Couples and Family Track, and the Washington DC School of Psychiatry. Previous positions include Adjunct Assistant Professor, Department of Psychology, University of Texas at Austin, and Consulting Psychologist, Substance Abuse Treatment Center, Faulkner Center, Austin, TX. Her earlier career involved statistical programming and database management, with a BA and an MA in mathematics. Marsha has been active in her Division 39 professional home in many ways. She currently serves on APA Council representing Division 39. She served six years as treasurer of the Division, and three years as member-at-large. As treasurer she also oversaw the development of an accurate, sortable database that allowed interface with APA and tracking of membership statistics. She has led the development of and chairs the Division 39 Charitable Fund. She is a founding member of her local chapter, the Austin Society for Psychoanalytic Psychology and has held the offices of President and Treasurer of both the local chapter and the Capital Area Psychological Association and Section IV, Local Chapters. She has been a member of the Austin-Travis County Mental Health Policy Advisory Committee, the lone psychologist member.



Dolores Morris, Ph.D., ABPP

Dolores Morris, Ph.D., ABPP is a psychologist psychoanalyst, graduate of the NYU Postdoctoral Program in Psychotherapy and Psychoanalysis and supervisor in the Interpersonal Humanistic Orientation. She is a member of the Admission's Committee and the Committee on Ethnicity, Race, Culture, Class and Language. She is a past member of the Progression and Recruitment Committees and past president of the graduate society. She serves on the Board of Trustees of the American Board of Professional Psychology (ABPP) representing the specialization of psychoanalysis and is the speciality's National Chair of Examinations. She is a former member of the Division 39 Board and representative to the Council of Representatives of APA. She received the first award from Division 39 Multicultural Concerns Committee in April of 2011 for advancement of multicultural issues. She served two terms as Representative to the APA Council for the Division. She is a fellow of the Divisions of Psychoanalysis, Clinical Psychology and Independent Practice of the American Psychological Association. Dr. Morris served on New York State Board for Psychology and was its co-chair for six years. She is a founding member of the Divisions of Psychologist-Psychoanalyst and Culture, Race and Ethnicity of the New York State Association and the Eastern Region of the Association of Black Psychologists. Dr. Morris is co-author (with Rafael Javier and William Herron) of Specialty Competencies in Psychoanalysis in Psychology, one of the volumes of Specialty Competencies in Professional Psychology Series to be published by Oxford University Press. She is in independent practice in New York City.

7–8:30 PM

Metropolitan Ballroom West

Opening Welcome Reception

Featuring the Music of the Ken Barish Jazz Quintet

7–8:30 PM

Metropolitan Ballroom West

Scientific Poster Presentations



NEW YORK UNIVERSITY

NYU Postdoctoral Program in Psychotherapy & Psychoanalysis

The NYU Postdoctoral Program in Psychotherapy and Psychoanalysis ("Postdoc") invites you to pursue advanced psychoanalytic education.

Study with our internationally acclaimed faculty and join a dynamic community of scholars and clinicians dedicated to preserving the best of the past while moving psychoanalytic theory and practice into the future.

"Postdoc" is actively recruiting a diverse student population and limited funding is available.

"Postdoc" wishes to congratulate the 23 members of our faculty who are among the 100 international authors honored by Psychoanalytic Electronic Publishing ("PEP") with the "PEP Author Prize" for 2012.

Our congratulations to the following Postdoc faculty:

Lewis Aron
 Beatrice Beebe
 Jessica Benjamin
 Martin S Bergmann
 Emanuel Berman
 Mark J Blechner
 Philip M Bromberg
 Ken Corbett
 Jody Messler Davies
 Muriel Dimen
 Darlene B Ehrenberg

Michael Eigen
 James Fosshage
 Jay Greenberg
 Adrienne Harris
 Irwin Hirsch
 Irwin Z Hoffman
 Frank Lachman
 Kimberlyn Leary
 Donna M Orange
 Stephen Seligman
 Joyce Slochower
 Donnel Stern

Lewis Aron, Ph.D.
Director

Spyros D. Orfanos, Ph.D.
Clinic Director

For more information about Postdoc, visit our website:
<http://postdocpsychoanalytic.as.nyu.edu/page/home>

conflict

FRIDAY APRIL 25

7–8:50 AM

Madison 3

Section IV Senate Meeting

8–9:50 AM

Empire East

Panel

FR-1 The Unconscious: A Panel Discussion

Jody Davies, Ph.D.

The Unconscious: A Relational Perspective

Richard Lasky, Ph.D., ABPP

The Unconscious: A Contemporary Freudian Perspective

Donnel Stern, Ph.D.

The Unconscious: An Interpersonal/Relational Perspective

Kenneth Feiner, Psy.D., *moderator*

Amy Cooney, Ph.D., *moderator*

8–9:50 AM

Empire West

Panel

FR-2 Trauma Begets Trauma: The Aftermath of an Analyst's Suicide, A Case Presentation

Laurel B. Wagner, Ph.D.

Grief, Dissociation and Conflict in the Therapeutic Dyad: A Case Presentation

Ghislaine Boulanger, Ph.D.

Reversing a Lifetime of Betrayal: Response to Laurel Wagner's Case

Phillip Blumberg, Ph.D., *moderator*

FRIDAY APRIL 25

8–9:50 AM

Lenox Ballroom

Roundtable Discussion Panel

FR-3 History of a Conflict: The Lawsuit Against the American Psychoanalytic Association

Bryant L. Welch, J.D., Ph.D.
Helen Desmond, Ph.D., ABPP
Arnold Z. Schneider, Ph.D., ABPP
Nathan Stockhamer, Ph.D., ABPP, *discussant*
Marilyn Jacobs, Ph.D., ABPP, *chair*
William A. MacGillivray, Ph.D., ABPP, *moderator*

8–9:50 AM

Riverside Suite

Panel

FR-4 Conflict-Free and Securely Attached: Fostering Attachment and Reflective Functioning While Reducing Conflict in Training and Treatment Models

Roanne Barnett, Ph.D.
Jill Bellinson, Ph.D.
Phyllis M. Cohen, Ph.D.
Andrea Remez, Ph.D.
Rachel Edelman, M.A.
Ashley Golub, Psy.D.
Eric Hovis, M.A.
Amy Pacifici, L.C.S.W.
Yadira Santillan, L.M.S.W.
Lisa Wolfe, L.C.S.W.

8–9:50 AM

Liberty 3

Panel

FR-5 My Analyst Told Me I Was Right Out of My Head: Normativity and Transgression in Psychoanalysis

Joseph W. Newirth, Ph.D., ABPP
From Frankenstein to Zombies: Culture and the Evolving Unconscious

Karen Lombardi, Ph.D.
Instead of One Head, I've Got Two (And You Know, Two Heads are Better Than One)

Michael O'Loughlin, Ph.D.
Reclaiming the Ghosts of Psychoanalysis Past

Joseph W. Newirth, Ph.D., ABPP, *moderator*

8–9:50 AM

Liberty 1 and 2

Committee on Humanities and Psychoanalysis Panel

FR-6 Tapping the Intuitive: Play, Creativity, and Conflict in the Theater Space: An Interactive Experience for Psychoanalysts

Steve Marsh, M.F.A.
Heather-Ayn Indelicato, Psy.D.
Henry M. Seiden, Ph.D., ABPP, *moderator*

8–9:50 AM

Liberty 4

Panel

FR-7 Dilemmas in Bearing Witness: Psychotherapist and Supervisor Experiences of Witnessing

Stacey Boyer, M.A.
The Intimacy in Witnessing: Psychoanalytic Psychotherapists' Internal Dilemmas When Bearing Witness

Courtney Slater, Ph.D.
The Sanctity of Witnessing: Conflicts in Bearing Witness from a Spiritual Perspective

Jane Widseth, Ph.D.
Bearing Witness in the Fabric of College Student Psychotherapy

Dennis Debiak, Psy.D.
Bearing Witness in the Supervisory Relationship

8–9:50 AM

Liberty 5

Panel

FR-8 Conflict Between Fantasy and Reality: A Patient and Therapist Talk About Psychotherapy and Schizophrenia

Monica Carsky, Ph.D., *chair*
Schizophrenia and Psychoanalytic Psychotherapy: From the Outside In

Sarah Rand, M.S.
Schizophrenia and Psychoanalytic Psychotherapy: From the Inside Out

Diana Diamond, Ph.D., *discussant*

10–11:50 AM

Empire East

Steering Committee Invited Conversation

FR-9 Homosexuality, Psychoanalysis, and America: Conflict Revolution and Resolution?

Henry Abelove, Ph.D.

Philip Cushman, Ph.D.

Lynne Layton, Ph.D.

J.P. Chevront, Psy.D., *chair and moderator*

10–11:50 AM

Empire West

Section III Panel

FR-10 Lean In, Lean Out, or Stuck in the Middle? Inner Conflicts and External Realities for Women in the Work Force and in Treatment

Sheila Tobias, M.A.

The Long View in a Historical Context

Nancy Chodorow, Ph.D.

Work and Mothering: Cultural and Psychological Defenses and Desires

Amy Richards, B.A.

Perspectives from Young Women and the Third Wave of Feminism

Diana Diamond, Ph.D.

Leaning In Versus Opting Out: Conflicting Ideologies and Intrapsychic Conflicts

Harriet Wrye, Ph.D.

Living in the Fourth Wave of Feminism

Diana Diamond, Ph.D., *moderator*

10–11:50 AM

Lenox Ballroom

Panel

FR-11 Conflict in the Lives and Treatment of Attachment-Disordered Children

Virginia M. Shiller, Ph.D.

Dyadic Treatment with a Boy Afraid to Love

Norka T. Malberg, Psy.D.

Jeremy and His Teddy Bear: On Working Analytically with a Disorganized-Attached Child

Miriam Steele, Ph.D., *moderator*

10–11:50 AM

Riverside Suite

Committee on Psychoanalysis and the Community Panel

FR-12 Psychoanalysts in Action: The Influence of Psychoanalysis Beyond the Consulting Room

Donna Bassin, Ph.D.

From Bystander to Witness: Psychoanalytic Contributions to a Veterans Community

Barry Cohen, Ph.D.

Work Fit for a Psychoanalyst: Mental Health Evaluations of Political Refugees Seeking Asylum

Toni V. Heineman, D.M.H.

Deborah Luepnitz, Ph.D.

Mary-Joan Gerson, Ph.D., *chair and moderator*

Judith Alpert, Ph.D., *chair and moderator*

10–11:50 AM

Liberty 1 and 2

Section VI Panel

FR-13 How Findings from Clinical Research Enrich our Practices

Sherwood Waldron, M.D.

Lissa Weinstein, Ph.D.

Steven Axelrod, Ph.D.

Karl Stukenberg, Ph.D.

10–11:50 AM

Liberty 3

Panel

FR-14 What Happens to Psychoanalytic Work in Non-Cosmopolitan Spaces?

Lara Sheehi, Psy.D.

The Conflict of Orthodoxy in a Non-Orthodox Treatment

Maxine Nwigwe, Psy.D.

Cheating on Psychoanalysis: A Non-Clinical Perspective

Monisha Nayar-Akhtar, Ph.D., *discussant*

Christine C. Kieffer, Ph.D., ABPP, *chair*

FRIDAY APRIL 25

FRIDAY APRIL 25

10–11:50 AM

Liberty 4

Panel

FR-15 Collisions Between Cultures and Techniques

Lisa Lyons, Ph.D.

Dreaming in Chinese: Psychoanalysis Across Culture, Language, Time, and Space

Kayoko Hayashi-Bonniecuelle, Psy.D.

Practicing Psychotherapy in Japan and in the United States

Yael Caspi, Sc.D.

Claiming The “Unclaimed Experience”

Ghislaine Boulanger, Ph.D., *chair*

Naoto Kawabata, Ph.D., *discussant*

Usha Tummala-Narra, Ph.D., *discussant*

10–11:50 AM

Liberty 5

Panel

FR-16 The Trauma of Treating Trauma: Conflicts Between Empathic Attunement and Self-Preservation

Jill Bellinson, Ph.D.

Ouch! I am a Trauma Therapist

Richard B. Gartner, Ph.D.

Trauma and Countertrauma: On Being Simply Human

10 AM–12 PM

Madison 5

Archives Task Force Meeting

12–12:50 PM

Various Rooms

Talk With Your Mouth Full

12–12:50 PM

Madison 4

Ethics Committee Board Meeting

12–12:50 PM

Liberty 4

Awards Committee Meeting

1–1:50 PM

Central Park East

Meet the Author

Psychological Testing That Matters

Anthony D. Bram, Ph.D.

Mary Jo Peebles, Ph.D.

1–1:50 PM

Central Park East

Meet the Author

Love and Loss in Life and in Treatment

Linda B. Sherby, Ph.D.

1–1:50 PM

Central Park East

Meet the Author

Family Entanglement: Unraveling the Knots and Finding Joy in the Parent-Child Journey

Ellen L. K. Toronto, Ph.D.

1–1:50 PM

Central Park East

Meet the Author

Mended by the Muse: Creative Transformations of Trauma

Sophia Richman, Ph.D., ABPP

1–1:50 PM

Central Park East

Meet the Author

The Psychology of African American Boys and Adolescents, Two Volumes

Warren Spielberg, Ph.D.

1–2:50 PM

Empire East

Steering Committee Invited Conversation

FR-17 Sitting with Conflict: Affect Tolerance and Disorders of Self-Care

Christine Anzieu-Premmereur, M.D., Ph.D.

Anne Slocum McEneaney, Ph.D., ABPP

Andrew Tatarsky, Ph.D.

Jeanette Sawyer Cohen, Ph.D., *chair and moderator*

FRIDAY APRIL 25

1-2:50 PM

Empire West

Panel

FR-18 **The Conflicted Nature of Desire: Perspectives and Controversies**

Steven Knoblauch, Ph.D.

Desire, Conflict, Symbol and Body: Theoretical Limits and Potentials

Lissa Weinstein, Ph.D.

From Need to the Paradox Of Desire

Frank L. Summers, Ph.D., ABPP

The Nature of Desire: An Object Relations Viewpoint

David Lichtenstein, Ph.D.

Desire and The Formation of the Unconscious

Elliot Jurist, Ph.D., Ph.D.

Desire and Mentalization

Diana Diamond, Ph.D., *moderator*

1-2:50 PM

Liberty 1 and 2

Panel

FR-19 **Short Circuits: Between the Social and the Intrapsychic In Contemporary Culture**

Jay Crosby, Ph.D.

Trauma and the Polysemy of Identity in the Digital Age

Brian Smith, Ph.D.

Conflicts in Beliefs About Autism

Nirav Soni, Ph.D.

On the Antisocial Tendency

Joseph W. Newirth, Ph.D., ABPP, *moderator*

1-2:50 PM

Lenox Ballroom

Section I Panel

FR-20 **Resentment as Cover Story: A Dialogue on Hidden Structures of Conflict**

Gemma Marangoni Ainslie, Ph.D., ABPP

Adrienne E. Harris, Ph.D.

Donald Moss, M.D.

Jane Kupersmidt, Ph.D., *chair*

1-2:50 PM

Riverside Suite

Panel

FR-21 **Childhood Sexual Abuse and Conflicts: The Traumatic Sequelae**

Jeremy M. Ridenour, Psy.D.

Pathological Caretaking: Changing Object Relations for Adult Survivors of Childhood Sexual Abuse

Kiera Boyle, Psy.D.

Conflict and Transference/Countertransference with a Sexual Abuse Victim and Perpetrator

Helen Devinney, Psy.D.

Building the Glass Menagerie: When Reenacting Trauma-as-Perpetrator Shatters Identity

Sonia Kahn, Psy.D.

Traumatic Entitlement in Sexual Abuse Survivors: Implications for Treatment

1-2:50 PM

Liberty 3

Panel

FR-22 **When Process Makes the Difference: Managing Conflict in Graduate Clinical Training**

Annee Ackerman, M.A.

Debra Wolkenfeld, M.A.

Rachel Goldstein, M.A.

Heshan Fernandez, M.A.

Mary Beth Cull, M.A.

Stephanie Hundt, M.A.

Brian Jo, M.A.

Anita Herron, Ph.D., *moderator*

Lawrence Zelnick, Psy.D., *chair*

1-2:50 PM

Liberty 4

Ethics Committee Panel

FR-23 **Sexual Boundary Violations: Causes and Effects**

Andrea Celenza, Ph.D.

Lessons Learned On and About the Couch: Sexual Boundary Violations in Contemporary Practice

Joyce Slochower, Ph.D., ABPP

Don't Tell Anyone

Sue Grand, Ph.D., *moderator*

Jane G. Tillman, Ph.D., ABPP, *chair*

1–2:50 PM

Liberty 5

Committee on Sexualities and Gender Identities Panel

FR- 24 From Hiding to Priding: Intergenerational Queer Perspectives on Sexuality and Gender Conflicts in Training and Supervision

Shara Sand, Psy.D.
Regina Hund, Psy.D.
Sandra Kiersky, Ph.D.
Elizabeth Clark, Psy.D.
Scott Pytluk, Ph.D., *chair*

2–2:50 PM

Central Park East

Meet the Author

The Play Within the Play: The Enacted Dimension of Psychoanalytic Process

Gil Katz, Ph.D.

2–2:50 PM

Central Park East

Meet the Author

Metaphor and Fields: Common Ground, Common Language and the Future of Psychoanalysis

S. Montana Katz, Ph.D.

2–2:50 PM

Central Park East

Meet the Author

Living With Depression

Deborah Serani, Psy.D.

2–2:50 PM

Central Park East

Meet the Author

Healing in the Wake of Parental Loss

Phyllis M. Cohen, Ph.D.
K. Mark Sossin, Ph.D.
Richard Ruth, Ph.D.

2–2:50 PM

Central Park East

Meet the Author

Christianity and Psychoanalysis: A New Conversation

Earl Bland, Psy.D.
Brad D. Strawn, Ph.D.

2–3:50 PM

Carnegie Suite West

Committee on Multicultural Concerns Board Meeting

3–3:50 PM

Central Park East

Coffee Hour

3–3:50 PM

Metropolitan Ballroom

Graduate Students Workshop I

Kimberlyn Leary, Ph.D., ABPP

4–5:30 PM

Metropolitan Ballroom

Keynote Address



Kimberlyn Leary, Ph.D., ABPP

Chief Psychologist, Cambridge Health Alliance,
Associate Professor of Psychology in Psychiatry,
Harvard Medical School

FR-25 On the Arts of Conflict and Confligere ('Striking Together')

This keynote address will explore change in the health care milieu through the lens of conflict and negotiation. Effective leaders, those with authority or “natural” leaders without titles, typically orchestrate and manage conflict to create options that allow purposeful work to proceed. Often, this requires stakeholders in an organization or a community to accept significant losses in exchange for genuine progress. Followers, in turn, exert subtle pressures that alter the leader’s agenda. Thus, negotiation processes consciously and unconsciously enter into the practice of leadership and working in and through organizations.

FRIDAY APRIL 25

5:30–6:30 PM

Presidential Suite

Candidates Reception

6–8 PM

Riverside Ballroom/Suite

Reception Section I

6:30–8:30 PM

Empire Ballroom

President's Reception for Graduate Students, Early Career Psychologists and Candidates

Future Division 39 Spring Meetings

2015

April 22–28

Sheraton Palace Hotel, San Francisco, CA

2016

April 6–10

The Westin Buckhead, Atlanta, GA

2017

April 25–30

Sheraton Times Square Hotel, New York, NY

conflict

SATURDAY APRIL 26

8–8:50 AM

Park 2

Colloquy

Racial Group Conflict in Higher Education

Elisa J. Lee, M.A.
Virtue Sankoh, B.A.

8–9:50 AM

Park 4

Section IV Open Meeting

8 AM–12 PM

Park 5

**American Board and Academy of Psychoanalysis (ABAPsa)
Board Meeting**

8–9:50 AM

Empire East

Panel

SA-1 Memory Matters: A Clinical Exploration of Memory and Mind

Jonathan Slavin, Ph.D.
If Someone Is There: On Finding and Having One's Own Mind

Jill Gentile, Ph.D.
On Mattering, Materiality, and "Transitional Memory"

Linda Luz-Alterman, Ph.D., *discussant*
Meaning, Memory and Mattering in the Construction of the Mind

8–9:50 AM

Empire West

Panel

SA-2 Psychoanalysis: Towards an End to the Religious Wars: A Roundtable

Joseph Cambray, Ph.D.

Jungian Analysis in the 21st Century

Marilyn Charles, Ph.D., ABPP

Contributions from Klein and Bion to Contemporary Practice

Paul Lippmann, Ph.D.

An Interpersonal Psychoanalytic Perspective for the Post-Human World

Lewis Aron, Ph.D., ABPP

Relational Psychoanalysis: The Relational/Interactive Matrix In Clinical Psychoanalysis

Nancy McWilliams, Ph.D., ABPP

Integrative Psychoanalytic Therapy: Fitting Theory to Patient and Not Vice Versa

Deborah Luepnitz, Ph.D.

What We Talk About When We Talk About Lacan

Marilyn Charles, Ph.D., ABPP, *moderator*

8–9:50 AM

Lenox Ballroom

Graduate Student Committee Panel

SA-3 The Dynamics of the Supervisory Relationship: A Live Demonstration

Ken Corbett, Ph.D., *supervisor*

Mia Maturen, M.A., *supervisee*

Diane Ehrensaft, Ph.D., *discussant*

Stefania Pifer, M.A., *discussant*

Frank Lawatsch, M.S.W., *moderator and chair*

8–9:50 AM

Liberty 1 and 2

Panel

SA-4 Treating Defensive Omnipotence: How a Validating Context Shifts Conflict

Jenny K. Kaufmann, Ph.D.

Owning Dissociated Dependency Needs

Evelyn Hartman, Ph.D.

Tolerating His Vulnerability—First at Age Ten, Then at Fifty

Peter Kaufmann, Ph.D., *moderator*

8–9:50 AM

Liberty 3

Panel

SA-5 Oedipus in Conflict: Cultural Spells, Seductive Consents, and Constructive Resistance

Orna Guralnik, Psy.D.

The Spell of The Sphinx

Avgi Saketopoulou, Psy.D.

The Mythology of Consent: A Double-Take On the Oedipal Conflict

Francisco Gonzalez, M.D., *moderator*

Resisting Oedipus

8–9:50 AM

Liberty 4

Committee on Psychoanalysis and Health Care Panel

SA-6 The Dying Parent: Conflicts in the Analyst's Life and Work

Judith Alpert, Ph.D.

Telling and Witnessing Before Death

Mary-Joan Gerson, Ph.D.

Death of a Parent: Openings at an Ending

Ruth Livingston, Ph.D.

Attunement and Atonement: The Death of My Parents, the Change in My Practice

Judith Albert, Ph.D., *moderator*

8–9:50 AM

Liberty 5

Committee on International Relations in Psychoanalytic Psychology Panel

SA-7 Is Psychoanalysis Also a Spiritual Discipline?

Sudhir Kakar, Ph.D.

Is Psychoanalysis Also a Spiritual Discipline?

Ann Pellegrini, Ph.D.

Enchanted to Meet You

Kenneth I. Reich, Ed.D., *moderator*

Moona Chaudhry, Psy.D., *discussant*

8–9:50 AM

Park 1

Panel

SA-8 Conflict and Trauma Underlying Christian Fundamentalism: Historical Discoveries, Clinical Approaches

Marie T. Hoffman, Ph.D.

Newly Discovered Evidence of Christian Fundamentalism's Conflicted and Traumatic History

Lowell W. Hoffman, Ph.D.

Clinical Work with Patients Affected by Christian Fundamentalism's Conflicts

Earl Bland, Psy.D., *discussant*

Gina Yu, M.A., *moderator*

8–9:50 AM

Park 3

Panel

SA-9 Conflict: Keep It a Secret: What Our Patients Don't Tell Us

Mary Libbey, Ph.D.

Arthur Fox, Ph.D.

Carina Grossmark, Ph.D.

Margery Kalb, Psy.D., *moderator and discussant*

9–9:50 AM

Park 2

Colloquy

Sexuality: Comparing French and American Views on Sexuality

Morris Eagle, Ph.D., ABPP

Conflict Between Infantile Sexuality and Object Love In French Psychoanalysis

Doris K. Silverman, Ph.D.

Laplanche, A French Analyst's Views on the Significance of Infantile Sexuality

Stephen Portugues, Ph.D., *moderator*

10–11:30 AM

Metropolitan

Keynote Address



Eric Klinenberg, Ph.D.

Professor of Sociology and Director of the Institute for Public Knowledge, New York University

SA-10 Developmental Conflict? Going Solo: The Extraordinary Rise and Surprising Appeal of Living Alone

Exploring the contemporary world in which more than 33 million people live alone, Professor Klinenberg offers a conflicting argument to social scientists who interpret the spike in solo living as a sign of atomization and narcissism; he sees it as a result of our newfound social security and reinvigorated urban life. He emphasizes that living alone, being alone, and feeling isolated are three distinct conditions, and examines the causes as well as the surprising consequences of this dramatic social change.

11:30 AM–12:50 PM

Park 4

Committee on International Relations in Psychoanalytic Psychology Board Meeting

11:30 AM–12:50 PM

Park 2

Section II Board Meeting

11:30 AM–12:50 PM

Park 3

Committee on Sexualities and Gender Identities Board Meeting

11:30 AM–12:50 PM

Liberty 4

Committee on Psychoanalysis and Health Care Board Meeting

11:30 AM–12:50 PM

Liberty 1 and 2

Early Career Psychologists Committee Board Meeting

SATURDAY APRIL 26

11:45 AM–12:50 PM

Lenox Ballroom

Graduate Students Workshop II

Eric Klinenberg, Ph.D.

12–12:50 PM

Various Rooms

Talk With Your Mouth Full

1–1:50 PM

Park 2

Colloquy

Psychogaming: Conflict, Morality, and Potential Space

Alexander Kriss, M.A.

1–1:50 PM

Park 1

Colloquy

When Marital Conflict Takes Center Stage in Individual Therapy

Steven Demby, Ph.D.

1–2:50 PM

Empire East

Steering Committee Invited Conversation

SA- 11 Sexual Boundary Violations: A Problem of the Group

Muriel Dimen, Ph.D.

Shame and Excitement: Sexual Boundary Violations, Contagion, Moral Panic
in conversation with William D. Lubart, Ph.D.

1–2:50 PM

Lenox Ballroom

Panel

SA-12 Childfree by Choice

Sandra Kiersky, Ph.D.

Moving Violations: The Pressure to Reproduce

Katie Gentile, Ph.D.

Living Childfree Within a Culture of Reprofuturity

Rebecca Harrington, L.C.S.W.

The Childfree Analyst: Clinical Considerations and Implications

Ruth Burtman, Ph.D.

Contrasts in Conducting Treatment While Childfree and Not

Rebecca Harrington, L.C.S.W., *moderator*

1–2:50 PM

Liberty 1 and 2

Panel

SA-13 Intra-Psychic Conflict and Collective Trauma: Mediations Between the Analytic and Cultural-Historical Fields

Orna Guralnik, Psy.D.

The Lives of Others: The Dissociative Spell of History

Eyal Rozmarin, Ph.D.

To Be Is to Betray: On the Conflicts of Living in History

Stephen Seligman, D.M.H.

Discussion: Clinical Process and Forms of Socialization in the Psychoanalytic Field

Orna Guralnik, Psy.D., *moderator*

Stephen Seligman, D.M.H., *discussant*

1–2:50 PM

Liberty 3

Section V Panel

SA-14 Flexibility and Frame: Conflicts in the Application of Psychoanalytic Practices and Techniques in Extreme Circumstances

Heather-Ayn Indelicato, Psy.D.

Working with Emerging Medical Professionals: Status, Desire, and Suffering

Judy Roth, Ph.D.

Zooming In and Radiating Out: From Testimonies, to Human Rights Advocacy, to a Field of Radical Conviction

Susan Kraemer, Ph.D. and Zina Steinberg, Ed.D.

Holding and Holding On: Psychoanalysts Consulting in the NICU

K. Mark Sossin, Ph.D.

Parent-Infant/Toddler Consultations in the Wake of Sudden Parent-Loss: Psychoanalytically Informed Close Observation and Video-Feedback

Lynne Kwalwasser, Ph.D.

Applying Psychoanalytic Techniques in Extreme Circumstances

Maureen O'Reilly, Ph.D.

The Psychoanalyst as Therapist and Consultant in the World of Modern Medicine

Heather-Ayn Indelicato, Psy.D., *moderator*

1–2:50 PM

Empire West

Panel

SA-15 Situating Conflict in Our Theories of Therapeutic Action

Morris Eagle, Ph.D., ABPP
James Fosshage, Ph.D.
Steven Cooper, Ph.D.
Christopher Christian, Ph.D., *moderator*

1–2:50 PM

Liberty 4

Panel

SA-16 See, Hear, and Feel the Bodies in the Room: (Re-) Recognizing Dyadic Collisions of Psyche and Soma

Johanna C. Malone, Ph.D.
Engaging Patients with Body Dysmorphic Disorder: In the Waters of Somatic Siren Songs

Kate Roy Sullivan, Ph.D.
Essential Surrendering in Embodied Countertransference

Marina Kovarsky, L.I.C.S.W.
Bodies in Conflict: Revisiting the Kleinian Perspective on the Treatment of Somatic Manifestations of Early Trauma

Patricia Ann Harney, Ph.D., *moderator and discussant*

1–2:50 PM

Liberty 5

Candidate Outreach Committee

SA-17 Growing Pains, Growing Gains: Conflicts and Pleasures of Psychoanalytic Candidacy

Dana L. Castellano, Psy.D.
Ricardo Rieppi, Ph.D.
Avgi Saketopoulou, Psy.D.
Natalia Yangarber-Hicks, Ph.D.
Paul Lippmann, Ph.D., *discussant*
Jonathan Eger, Psy.D., *chair*

1–2:50 PM

Madison 1

Graduate Student Committee Panel

The Digital Age (Like, Text, Post, Share) Comes to Treatment: Clinical Dilemmas, Conflicts and Opportunities

Jeremy Mintz, M.A.
Omyda Hernandez
Stephen Hartman, Ph.D.
Danille Drake, Ph.D.
Bart Magee, Ph.D.

1–2:50 PM

Park 3

Panel

SA-18 First Cases: The Conflicts Inherent in Beginning as a Child Therapist

Steven Tuber, Ph.D.
First Cases: The Conflicts Inherent in Beginning as a Child Therapist

Elizabeth Freidin-Baumann, Ph.D.
Use of a Projective Test in Psychodynamic Play Therapy

Kira Boesch, B.A.
Becoming Real Together: The Parallel Discovery of Authenticity In a Traumatized Child and First-Time Therapist

Mougeh Yasai, Ph.D.
D's Divided Heart: A Beginning Therapist's Perspectives on the Treatment of an Adolescent Girl

Steven Tuber, Ph.D., *moderator*

1–2:50 PM

Park 4

Panel

SA-19 Conflicts in Clinical Practice: Taking the Transference (And Counter-Transference)

Cristina Antonucci, M.A.
Moments of Paradox for the New Clinician: Continually Thrown Out of the Nest

Melissa Casee Kalman, M.Psy.
"I Love And I Hate, Is That Safe?": A Young Adult's Relational Conflict

Alexandra Mattern-Roggelin, M.S.
Creativity, Polarity, and Conflict: The Unmasking of a Burlesque Persona

Montana Queler, L.M.H.C.
Walking the Termination Tightrope: Balancing in the Crosswinds of Agency Demands and Client Care

Devon C. King, Ph.D., *moderator*

SATURDAY APRIL 26

2–2:50 PM

Park 1

Colloquy

Ships Passing? Conflicting Cultures of Psychoanalysis In Practice and the Academy

Michael E. Shulman, Ph.D.

2–2:50 PM

Park 2

Colloquy

International Analytical Work: Conflicts And Surprises Crossing The Border

Anna Kudiyarova, Ph.D.

Conflicts and Experiences In the U.S. and Kazakhstan

Charles Bonerbo, M.S.W.

Conflicts And Experiences Teaching In Kazakhstan

Albert Brok, Ph.D.

International Analytic Work: A Process of Finding and Discovering

Albert Brok, Ph.D., *moderator*

3–3:50 PM

Central Park East

Coffee Hour

3–5 PM

Park 5

Section V Board Meeting

4–5:50 PM

Empire East

Steering Committee Invited Conversation

SA-20 “We Need to Talk”: Addressing Conflicts in our Relationship with the Medical Model

Ivan Bresgi, Ph.D.

Irwin Z. Hoffman, Ph.D.

Nancy McWilliams, Ph.D., ABPP

Donna Orange, Ph.D., Psy.D.

Jeremy Safran, Ph.D.

Adam S. Kaplan, Ph.D., *chair and moderator*

4–5:50 PM

Empire West

Panel

SA-21 Power Conflicts in the Analytic Dyad and Beyond

Frank L. Summers, Ph.D., ABPP

Conflict and Power in the Analytic Dyad

Kris Yi, Ph.D., Psy.D.

Projective Identification—Whose Internal Conflict Does It Get Rid Of?

Nancy Hollander, Ph.D.

Power Dynamics and Conflicted States of Mind

4–5:50 PM

Liberty 3

Panel

SA-22 At Odds with Psychoanalysis? Reconciling the Work of David Foster Wallace with Psychoanalysis

Dennis Plant, Ph.D.

Infinite Jest: The Conflicted Heart and Mind of the Addict

Lucinda Ballantyne, L.I.C.S.W.

Wallace, Winnicott and the Necessity of Conflict

Malcolm Slavin, Ph.D., *discussant*

4–5:50 PM

Lenox Ballroom

Co-sponsored by Section II and Committee on Multicultural Concerns

SA-23 The Conflicting Role of the Juvenile and Welfare Systems in Caring for the Most Vulnerable Amongst Us

Norka T. Malberg, Psy.D.

In the Best Interest of the Child in the Trenches

Daphne Donahue, L.C.S.W.

Looking at the Child Welfare System from Multiple Lenses

Nell Bernstein, B.A.

Burning Down the House: Re-imagining Juvenile Justice

Almas Merchant, Ph.D. and Jan Hassan Butera, M.A.

The Conflicting Role of the United States Juvenile Justice System

Toni V. Heineman, D.M.H.

A Relationship Based Approach to the Work with Foster Children and Those Who Care for Them

Norka T. Malberg, Psy.D., *moderator*

4–5:50 PM

Liberty 1 and 2

Early Career Psychologists Committee Panel

SA-24 Engendering Our Voices: How Sexual and Gender Identity Shape the Early Career Experience

Dana L. Castellano, Psy.D.
The Production of Mothering

Stephen Lugar, Psy.D.
Multiple Selves, Multiple Roles: How Conflicting Gender and Sexual Identities Impact the Early Career Experience

Colin F. Ennis, Psy.D.
Out and Proud: Anonymity and Professional Identity

Trisha Ready, Ph.D.
Closets and Claustrophobia

Heather-Ayn Indelicato, Psy.D., *moderator*

4–5:50 PM

Liberty 4

Panel

SA-25 Psychoanalytical Explorations of Intrapsychic Trauma in Boys and Young Men: Collisions

William Pollack, Ph.D.
Normative Male Development as a Psychic Abandonment Trauma for Boys

Warren Spielberg, Ph.D.
Mentalization in African American Boys: Results from the Brotherman Study

Kirkland Vaughans, Ph.D.
Intergenerational Transmission of Trauma in the African American Community

Annie Lee Jones, Ph.D., *moderator*
Barbra Zuck Locker, Ph.D., ABPP, *discussant*

4–5:50 PM

Liberty 5

Panel

SA-26 Money Conflicts In Psychoanalysis

Elliot M. Adler, Ph.D., ABPP
Love, Sex and Money: The Unholy Trinity

Janet Zuckerman, Ph.D.
“Put Your Mouth Where Your Money Is”: From Enactment to Mutual Recognition

Ramona Segreti, L.C.S.W.
Time Is Money—Or Is It?: A Sadomasochistic Stalemate

Elliot M. Adler, Ph.D., ABPP, *discussant*

4–6 PM

Park 1

Section 1 Board Meeting

5–6 PM

Park 2

Candidate Outreach Committee Board Meeting

6–8 PM

Riverside Ballroom and Suite

Reception Section II and Section VIII

6:30–8:30 PM

Metropolitan Ballroom West

Joint Reception co-sponsored by The Psychoanalytic Network (Section IX, Section V, Committee on Psychoanalysis and the Community, Committee on Multicultural Concerns and Committee on Sexualities and Gender Identities)



TherapyNotes

Online Practice Management for Psychologists and Mental Health Professionals



11:30AM Appt with Kyle

Remember books he borrowed

12:00PM Appt with Susan

Remember books he borrowed

Create a Progress Note for your appointment on 9/29.

Scheduling & To Do Lists

Streamline your practice management and workflow. Past appointments are automatically added to your To Do List. Sync your calendar to your iPhone. Great multi-clinician scheduling features.

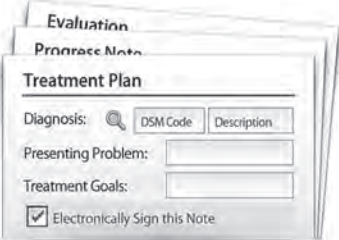

Patient Notes & EMR

Our form-based system makes it easy to keep up with your notes. Templates were designed specifically for mental health and therapists. Also upload any files to your patient records.

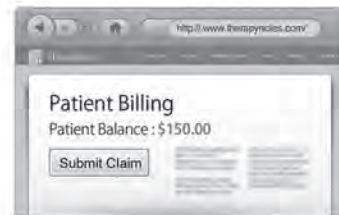

Electronic Billing

Easily submit claims electronically with TherapyNotes EDI! Track balances, view revenue reports, and generate CMS forms, superbills, and patient statements all from within TherapyNotes.



Now With Appointment Reminders

- Automatic text, phone, and email reminders
- Reduce no shows and decrease expenses

...AND MANY MORE FEATURES!

Special Offer!

Just For NYC
Psychology Convention
Attendees!

Sign Up And Receive Your First

2 Months Free!

Promo Code: NYC3913

Deal expires 7/1/2014

View Features and Sign Up Today at
www.TherapyNotes.com



conflict

SUNDAY APRIL 27

7:30-9 AM

Madison 1

Publication Committee

8-10 AM

Madison 3

Section III Board Meeting

8-9:50 AM

Empire East

Panel

SU-1 In Conflict: Analytic Self-Interest, Analytic Desire, and the Analytic Ideal

Irwin Hirsch, Ph.D.

Conflict Between the Analyst's & Patient's Self-Interest & Desires: Looking Back on a "Failed" Treatment

Joyce Slochower, Ph.D., ABPP

On a Collision Course: The Analyst's Self-Interest & The Analytic Ideal

Christopher Bonovitz, Psy.D., *moderator*

8-9:50 AM

Empire West

Panel

SU-2 Intergenerational Conflict in Analytic Identity and Practice

Stephen Hartman, Ph.D.

Muriel Dimen, Ph.D.

Stephen Lugar, Psy.D.

SUNDAY APRIL 24

8–9:50 AM

Lenox Ballroom

Committee on Multicultural Concerns Panel

SU-3 Conflict Avoidance Within Psychoanalysis: A Collaborative Discussion

Dennis Debiak, Psy.D.

“That’s So (Historically) Gay!” How Marginalizing and Pathologizing LGBTQ Individuals Has Contributed to Relational Tensions in Psychoanalytic Psychology

Diane Ehrensaft, Ph.D.

Gender Angst: Dis-ease When Boys Will Not Be Boys and Girls Will Not Be Girls

Jane Hassinger, M.S.W.

Dangertalk: Why Do We Avoid Real Conversation About Widespread Assaults Against Women’s Reproductive Freedoms in the United States and Why is This a Problem for the Psychoanalytic Community?

Kori Bennett, Psy.D.

Are You Seeing This? Navigating Cultural Projections and Conflicts Within Multiple Systems

Leilani S. Crane, Psy.D.

The Silencing of Racial Microaggressions

Leilani S. Crane, Psy.D., *chair and moderator*

8–9:50 AM

Liberty 3

Panel

SU-4 Conflict and Complexity in Work with the Orthodox Jewish Community

Laura Barbanel, Ed.D., ABPP

Conflict and Complexities in Work with the Orthodox Jewish Community

Hindie Klein, Psy.D.

Boundary Conflicts in the Orthodox Jewish Community

Andrew Klafter, M.D.

Psychoanalytic Treatment, Religion and Suppression

Laura Barbanel, Ed.D., ABPP, *moderator*

Lewis Aron, Ph.D., ABPP, *discussant*

8–10:50 AM

Liberty 1 and 2

ABPP

SU-5 Becoming a Board Certified Analyst, Mentor, Examiner for ABPP

This workshop will introduce the entire individualized performance examination process to licensed psychologists who may want to apply for certification and board certified psychologists who wish to serve as mentors and/or examiners.

Dolores Morris, Ph.D. ABPP

Stanton Marlan, Ph.D., ABPP

Ron Naso, Ph.D., ABPP

8–9:50 AM

Liberty 4

Panel

SU-6 When Holding & Containment Falter: High Conflict Moments in Teaching, Training, & Administering Graduate Psychology Programs

David L. Downing, Psy.D., ABPP

Program Accreditation as Conflictual Moment: Impingement, Regression, Containing, & Holding

Marc I. Lubin, Ph.D.

The Problematic Student and the Conflicted Clinical Faculty

Jed A. Yalof, Psy.D., ABPP

The Conflicted Hold In Program Management

8–9:50 AM

Liberty 5

Section IV Panel

SU-7 Conflict and Collision: Good Intentions and Hard Realities in Therapy with Foster Care Youth

Deborah Offner, Ph.D.

When the Honeymoon Ends: The Repetition of Original Trauma in Foster Care

Miriam Alkon, Psy.D.

Tokens, Trans-passes and Transference: Varieties of Therapeutic Action in Analytic Treatment of Foster Youth

Joseph G. Schaller, Psy.D., *moderator*

Johnny Madrid, B.A., *discussant*

SUNDAY APRIL 24

9–11 AM Madison 1
Psychoanalytic Psychology Editorial Board

9–11 AM Madison 2
Section VIII Board Meeting

10–10:50 AM Empire East
Colloquy
Conflict in Psychoanalytic Training
Sandra Buechler, Ph.D.

10–10:50 AM Empire West
Colloquy
Are Psychoanalysts Conflict Avoidant? Thoughts About Needing to Be the “Good Mother”
Karen J. Maroda, Ph.D., ABPP

10–10:50 AM Lenox Ballroom
Stephen Mitchell Award
Recipient: Adam K. Blum, Psy.D.
This Must Be the Place: Thinking Psychological Life with Music
Elliot Jurist, Ph.D., Ph.D., *chair*

10–10:50 AM Liberty 3
Colloquy
Arranged Marriage vs Continuing an Affair vs Becoming a Guru
Alan Roland, Ph.D.
Nancy McWilliams, Ph.D., ABPP, *moderator*

10–10:50 AM Liberty 4
Colloquy
Psychoanalysis and Culture Wars: Is It Wise to Pathologize Conservatives?
David Anderegg, Ph.D.

10–10:50 AM Liberty 5
Colloquy
Don't Inhabit Me with Your Desiring Eyes—Intersubjectivity and Teen Texting
Megan M. Kolano, M.A.

11-12:50 AM Metropolitan East
Closing Event
SU-8 Beyond Conflict: Psychoanalysts Reflect on the Good Life
Sandra Buechler, Ph.D.
Jeffrey B. Rubin, Ph.D.
Nancy McWilliams, Ph.D., ABPP
William D. Lubart, Ph.D., *chair and moderator*

WSPPP WESTCHESTER CENTER FOR THE STUDY OF PSYCHOANALYSIS & PSYCHOTHERAPY

Professional Education Is A Lifelong Process

- Four-Year Psychoanalytic Training Program
- Two-Year Adult Psychotherapy Training Program
- Two-Year Child and Adolescent Psychotherapy Training Program
- One-Year Couples Psychotherapy Training Program
- One-Year Supervisory Training Program

Financial Aid Available to All Candidates as needed

- Psychotherapy Service (Sliding Scale)

Chartered by the Regents of the University of the State of New York in 1974, WCSPP provides training in psychoanalysis and psychotherapy across a range of contemporary psychoanalytic approaches.

WCSPP, 468 Rosedale Avenue, White Plains, NY 10605

Please call for a brochure and information about our next Open House: **914-997-7500**
www.wcspp.org

**The Division of Psychoanalysis
of the New York State Psychological Association
is pleased to welcome
APA Division 39 to New York City
and to sponsor the Opening Night Reception.**

The NYSPA Division of Psychoanalysis was founded in 2004, one of the first such divisions within a state psychological organization. The mission of the division is to enhance the understanding and advancement of psychoanalytic theories, treatment approaches, research, legislative, political and other professional concerns. The Division provides a supportive, collegial statewide community, providing a voice for psychoanalysis within the New York State Psychological community. The Division fosters inter-institute collaboration and educational programs that explore therapeutic, scholarly, educational, research, public service and diversity issues from psychoanalytic perspectives.

Our Division provides a dynamic and supportive context for psychologists and doctoral students who have an interest in psychoanalysis. It has a growing membership of 400+, with members from diverse analytic training programs in New York State—making us one of the largest Divisions of NYSPA.

If you are a psychoanalyst or a friend of psychoanalysis in New York State, please take the opportunity to join us as a member of NYSPA's Division of Psychoanalysis. Please call NYSPA Central Office at (800)-732-3933 to join.

A U.S. News and World Report
TOP TEN “Best Hospital”



AUSTEN RIGGS CENTER

Psychiatric Hospital and Residential Treatment Center

25 Main Street, Stockbridge, MA • 855-283-1770 • AUSTENRIGGS.ORG

there is more than one way

Relational Theory
~
Modern Analytic
~
Object Relations
~
Contemporary Freudian
~
Self Psychology
~
Intersubjectivity

Explore our full- and part-time 3-year, 4-year, and license-qualifying programs in psychoanalysis and psychoanalytic psychotherapy at our **Spring Open Houses**:

Friday, March 7, 2014 at 7:00PM

Sunday, April 27, 2014 at 1:00PM

More information can be found
at PPSC.ORG

The Psychoanalytic Psychotherapy Study Center is pleased to announce that you can now take individual courses to enhance your knowledge in the field of substance abuse, acquire an advanced certificate in addictions coursework with the completion of a 4-course module, and/or renew CASAC credits

through our new

ADVANCED PSYCHODYNAMIC ADDICTIONS TREATMENT TRAINING PROGRAM

Rolling admissions
are now open for courses
beginning **January 4, 2014!**

More information on this exciting
new program can be found at
PPSC.ORG/APAT



Psychoanalytic
Psychotherapy
Study
Center

(212)633-9162 | WWW.PPSC.ORG | PPSC@ATT.NET
80 Fifth Avenue | Suite 903A | New York, NY 10011

PPSC does not discriminate on the basis of race, color, religion, sex, sexual preference, national or ethnic origin, or analytic orientation in the administration of its admissions and educational policies.



THE INSTITUTE FOR EXPRESSIVE ANALYSIS

The Institute for Expressive Analysis (IEA) is a New York State License qualifying program that offers training in psychoanalysis. IEA places a particular emphasis on the integration of psychotherapy and psychoanalysis with the creative process.

The curriculum provides diverse theoretical approaches including:

- *Object Relations*
- *Self-Psychology*
- *Relational Psychoanalysis*
- *Jungian*
- *Contemporary Freudian theory*

Training focuses on both verbal and nonverbal aspects of treatment and is applicable for both private practice and institutional settings.

IEA's program promotes the development of therapeutic artistry by providing a solid clinical base along with exposure to creative currents in contemporary psychoanalysis.

IEA offers a personal, intimate training atmosphere based on the belief that every analyst must find her/his own therapeutic metaphor, style, and way of integrating the many dimensions of training.

IEA's consultation center is also available for low-fee psychotherapy referrals.

Presenters

Henry Abelove, Ph.D. Wesleyan University (emeritus), Middletown, CT	56
Annee Ackerman, M.A. Long Island University, Brooklyn, NY	61
Elliot M. Adler, Ph.D., ABPP Westchester Center for the Study of Psychoanalysis and Psychotherapy, White Plains, NY	77
Gemma Marangoni Ainslie, Ph.D., ABPP Center for Psychoanalytic Studies, Austin, TX	60
Miriam Alkon, Psy.D. Independent Practice, Brooklyn, NY	81
Judith Alpert, Ph.D. NYU Postdoctoral Program In Psychotherapy & Psychoanalysis, New York, NY	42, 57, 67
Neil E. Altman, Ph.D. William Alanson White Institute, New York, NY	43
David Anderegg, Ph.D. Bennington College, Bennington, VT	83
Cristina Antonucci, M.A. Illinois School of Professional Psychology, Baltimore, MD	73
Christine Anzieu-Premmereur, M.D., Ph.D. Columbia University, New York, NY	59
Lewis Aron, Ph.D., ABPP NYU Postdoctoral Program in Psychotherapy & Psychoanalysis, New York, NY	46, 66, 80
Laura Athey-Lloyd, Psy.D. William Alanson White Institute, New York, NY	41
Galit Atlas, Ph.D. NYU Postdoctoral Program in Psychotherapy & Psychoanalysis, New York, NY	42, 46
Kavita Avula, Psy.D. Red Well Theater Group, Washington, DC	43

Steven Axelrod, Ph.D. The Boswell Group, New York, NY	57	Christopher Bonovitz, Psy.D. William Alanson White Institute, New York, NY	40, 79
Carl Bagnini, M.S.W. International Psychotherapy Institute, Chevy Chase, MD	47	Robert F. Bornstein, Ph.D. Adelphi University, Garden City, NY	40
Lucinda Ballantyne, L.I.C.S.W. Massachusetts Institute for Psychoanalysis, Boston, MA	75	Ghislaine Boulanger, Ph.D. NYU Postdoctoral Program in Psychotherapy & Psychoanalysis, New York, NY	53, 58
Rosemary Balsam, M.D. New England Institute of Psychoanalysis, New Haven, CT	45	Stacey Boyer, M.A. Widener University Institute for Graduate Clinical Psychology, Chester, PA	55
Laura Barbanel, Ed.D., ABPP Manhattan Institute for Psychoanalysis, New York, NY	80	Kiera Boyle, Psy.D. Institute of Living/Hartford Hospital, Hartford, CT	61
Roanne Barnett, Ph.D. Private Practice, New York, NY	54	Anthony D. Bram, Ph.D. Harvard Medical School, Lexington, MA	59
Donna Bassin, Ph.D. NYU Postdoctoral Program In Psychotherapy & Psychoanalysis, New York, NY	57	Ivan Bresgi, Ph.D. New York Presbyterian Hospital, New York, NY	74
Beatrice Beebe, Ph.D. Columbia University College of Physicians and Surgeons, New York, NY	40, 41	Albert Brok, Ph.D. Training Institute for Mental Health, New York, NY	74
Jill Bellinson, Ph.D. William Alanson White Institute, New York, NY	37, 54, 58	Sandra Buechler, Ph.D. William Alanson White Institute, New York, NY	39, 49, 82, 83
Kori Bennett, Psy.D. University of Indianapolis, Indianapolis, IN	80	Ruth Burtman Ph.D. Institute for the Psychoanalytic Study of Subjectivity, New York, NY	44, 70
Nell Bernstein, B.A. Freelance Journalist and Author, San Francisco, CA	75	Noelle Burton, Psy.D. Institute for Relational Psychoanalysis of Philadelphia, Narberth, PA	40
Earl Bland, Psy.D. SEPTT, Overland Park, KS	63, 68	Jan Hassan Butera, M.A. SCO Family Services/Close to Home, Queens, NY	75
Adam K. Blum, Psy.D. California Pacific Medical Center, San Francisco, CA	82	Joseph Cambray, Ph.D. International Association for Analytic Psychology, Providence, RI	66
Phillip Blumberg, Ph.D. William Alanson White Institute, New York, NY	45, 53	Monica Carsky, Ph.D. NYU Postdoctoral Program in Psychotherapy & Psychoanalysis, New York, NY	55
Kira Boesch, B.A. City University of New York, New York, NY	73	Yael Caspi, Sc.D. Rambam Health Care Center, Haifa, Israel	58
Charles Bonerbo, M.S.W. Training Institute for Mental Health, New York, NY	74	Dana L. Castellano, Psy.D. National Institute for the Psychotherapies, Boulder, CO	72, 76

Molly S. Castelloe, Ph.D. Institute of Expressive Analysis, New York, NY	47	Jay Crosby, Ph.D. New York University School of Medicine, New York, NY	60
Andrea Celenza, Ph.D. Boston Psychoanalytic Society and Institute, Boston, MA	61	Mary Beth Cull, M.A. Long Island University, Brooklyn, NY	61
Marilyn Charles, Ph.D., ABPP Austen Riggs Center, Stockbridge, MA	37, 66	Rebecca C. Curtis, Ph.D. William Alanson White Institute, New York, NY	44
Moona Chaudhry, Psy.D. Private Practice, Washington, DC	67	Philip Cushman, Ph.D. Antioch University, Seattle, WA	56
J.P. Chevront, Psy.D. Institute for the Psychoanalytic Study of Subjectivity, New York, NY	56	Mamta B. Dadlani, Ph.D. University of Massachusetts, Amherst, MA	46
Nancy Chodorow, Ph.D. Harvard University, Cambridge Health Alliance, Cambridge, MA	56	Jody Davies, Ph.D. NYU Postdoctoral Program in Psychotherapy & Psychoanalysis, New York, NY	53
Christopher Christian, Ph.D. New School for Social Research, New York, NY	72	Dennis Debiak, Psy.D. Institute for Relational Psychoanalysis of Philadelphia, Philadelphia, PA	55, 80
Elizabeth Clark, Psy.D. University of Illinois at Chicago Counseling Center, Chicago, IL	62	Steven Demby, Ph.D. Contemporary Freudian Society, New York, NY	70
Barry Cohen, Ph.D. NYU Postdoctoral Program in Psychotherapy & Psychoanalysis, New York, NY	57	Helen Desmond, Ph.D., ABPP New Center for Psychoanalysis, Los Angeles, CA	54
Jeanette Sawyer Cohen, Ph.D. Columbia University, New York, NY	59	Helen Deviney, Psy.D. The George Washington University, Washington, DC	61
Phyllis M. Cohen, Ph.D. New York Institute for Psychotherapy Training, Brooklyn, NY	54, 62	Diana Diamond, Ph.D. City University of New York, New York, NY	55, 56, 60
Amy Cooney, Ph.D. The Stephen Mitchell Center, New York, NY	53	Muriel Dimen, Ph.D. NYU Postdoctoral Program in Psychotherapy & Psychoanalysis, New York, NY	70, 79
Steven Cooper, Ph.D. Harvard Medical School, Cambridge, MA	40, 72	John Dluhy, M.D. Private Practice, Washington, DC	43
Ken Corbett, Ph.D. NYU Postdoctoral Program in Psychotherapy & Psychoanalysis, New York, NY	66	Mary Dluhy, M.S.W. Private Practice, Washington, DC	43
Leilani S. Crane, Psy.D. University of Pennsylvania, Counseling & Psychological Services, Philadelphia, PA	80	Shelley Doctors, Ph.D. International Association for Psychoanalytic Self Psychology, New York, NY	46
Margaret Crastnopol, Ph.D. Seattle Psychoanalytic Society and Institute, Seattle, WA	39	Daphne Donahue, L.C.S.W. Middlesex Hospital, Middletown, CT	75

David L. Downing, Psy.D., ABPP University of Indianapolis, School of Psychological Sciences, Indianapolis, IN	40, 81	Elizabeth Freidin-Baumann, Ph.D. Harvard Medical School, Belmont, MA	73
Danille Drake, Ph.D. The George Washington University, Washington, DC	73	Dafna Fuchs, Ph.D. William Alanson White Institute, New York, NY	41
Jack Drescher, M.D. New York Medical College, Valhalla, NY	37	Richard B. Gartner, Ph.D. William Alanson White Institute, New York, NY	58
Morris Eagle, Ph.D., ABPP Derner Institute, Adelphi University, Garden City, NY	68, 72	Jesse D. Geller, Ph.D. Teachers College, Columbia University, New York, NY	45
Rachel Edelman, M.A. New Alternatives for Children, New York, NY	54	Paul Geltner, D.S.W. Psychoanalytic Psychotherapy Study Center, New York, NY	48
Jonathan Eger, Psy.D. NYU Postdoctoral Program in Psychotherapy & Psychoanalysis, New York, NY	72	Jill Gentile, Ph.D. NYU Postdoctoral Program in Psychotherapy & Psychoanalysis, New York, NY	65
Diane Ehrensaft, Ph.D. Private Practice, Oakland, CA	66, 80	Katie Gentile, Ph.D. John Jay College of Criminal Justice, New York, NY	70
Colin F. Ennis, Psy.D. The Chicago School of Professional Psychology, Chicago, IL	76	Mary-Joan Gerson, Ph.D. NYU Postdoctoral Program in Psychotherapy & Psychoanalysis, New York, NY	43, 50, 57, 67
Barry Farber, Ph.D. Teachers College, Columbia University, New York, NY	45	Dodi Goldman, Ph.D. William Alanson White Institute, New York, NY	39
Susi Federici-Nebbiosi, Ph.D. International Association for Relational Psychoanalysis & Psychotherapy, Rome, Italy	46	Rachel Goldstein, M.A. Long Island University, Brooklyn, NY	61
Kenneth Feiner, Psy.D. NYU Postdoctoral Program in Psychotherapy & Psychoanalysis, New York, NY	53	Ashley Golub, Psy.D. New Alternatives for Children, New York, NY	54
Heather Ferguson, M.S. Institute for the Psychoanalytic Study of Subjectivity, New York, NY	39	Francisco Gonzalez, M.D. Psychoanalytic Institute of Northern California, San Francisco, CA	67
Heshan Fernandez, M.A. Long Island University, Brooklyn, NY	61	Dana Goren, Ph.D. William Alanson White Institute, New York, NY	41
James Fosshage, Ph.D. National Institute for the Psychotherapies, New York, NY	72	William H. Gottdiener, Ph.D. Psychology Department, John Jay College of Criminal Justice, New York, NY	40
Arthur Fox, Ph.D. NYU Postdoctoral Program in Psychotherapy & Psychoanalysis, New York, NY	68	Jacqueline Gotthold, Psy.D. Institute for Psychoanalytic Study of Subjectivity, New York, NY	46
		Sue Grand, Ph.D. NYU Postdoctoral Program in Psychotherapy & Psychoanalysis, New York, NY	43, 46, 61

Arthur A. Gray, Ph.D. Institute for the Psychoanalytic Study of Subjectivity, New York, NY	41	Anita Herron, Ph.D. NYU Postdoctoral Program in Psychotherapy & Psychoanalysis, New York, NY	61
Carina Grossmark, Ph.D. NYU Postdoctoral Program in Psychotherapy & Psychoanalysis, New York, NY	68	Tanya Hess, Ph.D. Philadelphia VA Medical Center, Philadelphia, PA	37
Janice Gump, Ph.D. Institute for Contemporary Psychotherapy and Psychoanalysis, Washington, DC	46	Irwin Hirsch, Ph.D. NYU Postdoctoral Program in Psychotherapy & Psychoanalysis, New York, NY	79
Orna Guralnik, Psy.D. NYU Postdoctoral Program in Psychotherapy & Psychoanalysis, New York, NY	67, 71	Marie T. Hoffman, Ph.D. NYU Postdoctoral Program in Psychotherapy & Psychoanalysis, New York, NY	68
Patricia Ann Harney, Ph.D. Cambridge Health Alliance, Harvard Medical School, Cambridge, MA	72	Lowell W. Hoffman, Ph.D. Society for Exploration of Psychoanalytic Therapies and Theology, Fogelsville, PA	68
Rebecca Harrington, L.C.S.W. Psychoanalytic Psychotherapy Study Center, New York, NY	70	Irwin Z. Hoffman, Ph.D. Chicago Center for Psychoanalysis, Chicago, IL	74
Adrienne E. Harris, Ph.D. NYU Postdoctoral Program in Psychotherapy & Psychoanalysis, New York, NY	39, 48, 60	Leon Hoffman, M.D. New York Psychoanalytic Institute, New York, NY	45
Evelyn Hartman, Ph.D. William Alanson White Institute, New York, NY	66	Nancy Hollander, Ph.D. Psychoanalytic Institute of Northern California, San Francisco, CA	75
Stephen Hartman, Ph.D. Psychoanalytic Institute of Northern California, San Francisco, CA	73, 79	Eric Hovis, M.A. New Alternatives for Children, New York, NY	54
Leeann Borton Harvey, Ph.D. Private Practice, Walnut Creek, CA	44	Elizabeth Howell, Ph.D. NYU Postdoctoral Program in Psychotherapy & Psychoanalysis, New York, NY	42
Jane Hassinger, M.S.W. University of Michigan, Ann Arbor, MI	80	Regina Hund, Psy.D. Pace University Counseling Center, New York, NY	62
Kayoko Hayashi-Bonniecuelle, Psy.D. Sophia University Counseling Center, Tokyo, Japan	58	Stephanie Hundt, M.A. Long Island University, Brooklyn, NY	61
Valery Hazanov, M.Phil. Teachers College, Columbia University, New York, NY	45	Suzanne Iasenza, Ph.D. Institute for Contemporary Psychotherapy and Psychoanalysis, New York, NY	38
Toni V. Heineman, D.M.H. A Home Within, San Francisco, CA	45, 57, 75	Heather-Ayn Indelicato, Psy.D. Stony Brook University, Stony Brook, NY	55, 71, 76
Omyda Hernandez Access Institute, San Francisco, CA	73	Sheldon Itzkowitz, Ph.D., ABPP NYU Postdoctoral Program in Psychotherapy & Psychoanalysis, New York, NY	42

Marilyn Jacobs, Ph.D., ABPP Private Practice, Los Angeles, CA	54	Naoto Kawabata, Ph.D. Kayoto Institute for Psychoanalysis & Psychotherapy, Kayoto, Japan	58
Erin Jeanette, Ph.D. William Alanson White Institute, New York, NY	41	Christine C. Kieffer, Ph.D., ABPP Chicago Institute For Psychoanalysis, Chicago, IL	45, 57
Brian Jo, M.A. Long Island University, Brooklyn, NY	61	Sandra Kiersky, Ph.D. Institute for the Psychoanalytic Study of Subjectivity, New York, NY	62, 70
Amy Joelson, L.C.S.W. Institute for the Psychoanalytic Study of Subjectivity, New York, NY	44	Devon C. King, Ph.D. The George Washington University, Washington, DC	37, 73
Annie Lee Jones, Ph.D. Private Practice, New York, NY	76	Andrew Klafter, M.D. Cincinnati Psychoanalytic Institute, Cincinnati, OH	80
Elliot Jurist, Ph.D., Ph.D. City University of New York, New York, NY	49, 60, 82	Hindie Klein, Psy.D. Ohel Children's Home and Family Services, New York, NY	80
Sonia Kahn, Psy.D. The George Washington University, Washington, DC	61	Eric Klinenberg, Ph.D. Institute for Public Knowledge, New York University, New York, NY	69, 70
Sudhir Kakar, Ph.D. International Psychoanalytic Association, Goa, India	67	Steven Knoblauch, Ph.D. NYU Postdoctoral Program in Psychotherapy & Psychoanalysis, New York, NY	60
Margery Kalb, Psy.D. NYU Postdoctoral Program in Psychotherapy & Psychoanalysis, New York, NY	68	Megan M. Kolano, M.A. The Chicago School of Professional Psychology, Chicago, IL	83
Melissa Casee Kalman, M.Psy. The George Washington University, Washington, DC	73	Susan Kolod, Ph.D. William Alanson White Institute, New York, NY	45
Adam S. Kaplan, Ph.D. Institute for the Psychoanalytic Study of Subjectivity, New York, NY	74	Marina Kovarsky, L.I.C.S.W. Massachusetts Institute for Psychoanalysis, Boston, MA	72
Gil Katz, Ph.D. NYU Postdoctoral Program in Psychotherapy & Psychoanalysis, New York, NY	62	Susan Kraemer, Ph.D. College of Physicians and Surgeons, Columbia University, New York, NY	71
S. Montana Katz, Ph.D. National Psychological Association for Psychoanalysis, New York, NY	62	Alexander Kriss, M.A. The New School for Social Research, New York, NY	70
Jenny K. Kaufmann, Ph.D. William Alanson White Institute, New York, NY	66	Steven Kuchuck, L.C.S.W. National Institute for the Psychotherapies, New York, NY	42, 45
Peter Kaufmann, Ph.D. Institute for the Psychoanalytic Study of Subjectivity, New York, NY	66	Anna Kudyarova, Ph.D. Psychoanalytic Institute of Central Asia, Almaty, Kazakhstan	74
Susan Kavalier-Adler, Ph.D., ABPP, D.Litt. Object Relations Institute for Psychotherapy and Psychoanalysis, New York, NY	48	Jane Kupersmidt, Ph.D. National Psychological Association for Psychoanalysis, New York, NY	60

Emily A. Kuriloff, Psy.D. William Alanson White Institute, New York, NY	48	Barbra Zuck Locker, Ph.D., ABPP NYU Postdoctoral Program in Psychotherapy & Psychoanalysis, New York, NY	76
Lynne Kwalwasser, Ph.D. NYU Postdoctoral Program in Psychotherapy & Psychoanalysis, New York, NY	71	Karen Lombardi, Ph.D. Adelphi University, Garden City, NY	54
Richard Lasky, Ph.D., ABPP NYU Postdoctoral Program in Psychotherapy & Psychoanalysis, New York, NY	53	William D. Lubart, Ph.D. William Alanson White Institute, New York, NY	70, 83
Frank Lawatsch, M.S.W. Access Institute, San Francisco, CA	66	Marc I. Lubin, Ph.D. Argosy University/Orange County, Santa Ana, CA	81
Lynne Layton, Ph.D. Massachusetts Institute for Psychoanalysis, Boston, MA	56	Deborah Luepnitz, Ph.D. University of Pennsylvania School of Medicine, Philadelphia, PA	57, 66
Kimberlyn Leary, Ph.D., ABPP Harvard University, Cambridge, MA	37, 46, 63	Stephen R. Lugar, Psy.D. Private Practice, San Francisco, CA	76, 79
Elisa J. Lee, M.A. City University of New York, New York, NY	65	Linda Luz-Alterman, Ph.D. Massachusetts Institute for Psychoanalysis, Cambridge, MA	65
Brenda Lovegrove Lepisto, Psy.D. Michigan State University, Hurley Medical Center, East Lansing, MI	37	Lisa Lyons, Ph.D. Stephen Mitchell Center, New York, NY	58
Matthew LeRoy, Psy.D. University of Pennsylvania, Philadelphia, PA	46	William A. MacGillivray, Ph.D., ABPP University of Tennessee, Knoxville, TN	54
Hillary Lewin Tuvia, Ph.D. William Alanson White Institute, New York, NY	41	Johnny Madrid, B.A. A Home Within, Los Angeles, CA	81
Mary Libbey, Ph.D. NYU Postdoctoral Program in Psychotherapy & Psychoanalysis, New York, NY	68	Bart Magee, Ph.D. Access Institute, San Francisco, CA	73
David Lichtenstein, Ph.D. Apres-Coup Psychoanalytic Association, New York, NY	60	Norka T. Malberg, Psy.D. Yale University, New Haven, CT	56, 75
Ruth Lijtmaer, Ph.D. Center for Psychotherapy and Psychoanalysis of New Jersey, Ridgewood, NJ	43	Stacy Malin, Ph.D. NYU Postdoctoral Program in Psychotherapy & Psychoanalysis, New York, NY	47
Paul Lippmann, Ph.D. William Alanson White Institute, New York, NY	66, 72	Johanna C. Malone, Ph.D. Massachusetts General Hospital, Harvard Medical School, Boston, MA	72
Ruth Livingston, Ph.D. William Alanson White Institute, New York, NY	67	Stanton Marlan, Ph.D., ABPP Inter-Regional Society of Jungian Analysts, Pittsburgh, PA	81
		Karen J. Maroda, Ph.D., ABPP Medical College of Wisconsin, Milwaukee, WI	82

Steve Marsh, B.A. Stony Brook University, Stony Brook, NY	55	Joseph W. Newirth, Ph.D., ABPP The Derner Institute, Adelphi University, Garden City, NY	54, 60
Liz Marsh, L.I.C.S.W. Red Well Theater Group, Washington, DC	43	Maxine Nwigwe, Psy.D. SUNY College at Old Westbury, New York, NY	57
Paul Martin, Psy.D. The Center for Grief Recovery, Chicago, IL	37, 47	Elizabeth Ochoa, Ph.D. Beth Israel Medical Center, New York, NY	47
Alexandra Mattern-Roggelin, M.S. The George Washington University, Washington, DC	73	Deborah Offner, Ph.D. Independent Practice, Boston, MA	81
Mia Maturen, M.A. Access Institute, San Francisco, CA	66	Michael O'Loughlin, Ph.D. Adelphi University, Garden City, NY	54
Marsha McCary, Ph.D. Private Practice, Austin TX	50	Donna Orange, Ph.D. Psy.D. Institute for the Psychoanalytic Study of Subjectivity, New York, NY	74
Nancy McWilliams, Ph.D., ABPP Rutgers Graduate School of Applied & Professional Psychology, Piscataway, NJ	66, 74, 82, 83	Maureen O'Reilly, Ph.D. Columbia University College of Physicians and Surgeons, New York, NY	71
Sarah Mendelsohn, L.C.S.W. Institute for the Psychoanalytic Study of Subjectivity, New York, NY	39	Spyros Orfanos, Ph.D., ABPP NYU Postdoctoral Program in Psychotherapy & Psychoanalysis, New York, NY	41, 46
Almas Merchant, Ph.D. SCO Family Services/Close to Home Program, New York, NY	47, 75	Amy Pacifici, L.C.S.W. New Alternatives for Children, New York, NY	54
Jeremy Mintz, M.A. Access Institute, San Francisco, CA	73	Mary Jo Peebles, Ph.D. Bethesda, MD	59
Yavar Moghimi, M.D. Red Well Theater Group, Washington, DC	43	Ann Pellegrini, Ph.D. New York University, New York, NY	67
Pamela Moller Kareman Neighborhood Playhouse School of the Theater, New York, NY	41	Jean Petrucelli, Ph.D. William Alanson White Institute, New York, NY	48
Dolores Morris, Ph.D. ABPP NYU Postdoctoral Program in Psychotherapy & Psychoanalysis, New York, NY	50, 51, 81	Stefania Pifer, M.A. The Wright Institute, Berkeley, CA	66
Donald Moss, M.D. Institute for Psychoanalytic Education, NYU Medical Center, New York, NY	60	Kristi Pikiewicz, Ph.D. Independent Practice, Boulder, CO	37
Ron Naso, Ph.D., ABPP Independent Practice, Stamford, CT	81	Dennis Plant, Ph.D. Massachusetts Institute for Psychoanalysis, Cambridge, MA	75
Monisha Nayar-Akhtar, Ph.D. Psychoanalytic Center of Philadelphia, Philadelphia, PA	57	Megan Poe, M.D. William Alanson White Institute, New York, NY	45

William Pollack, Ph.D. Harvard Medical School, Boston, MA	76	Alan Roland, Ph.D. National Psychological Association for Psychoanalysis, New York, NY	82
Stephen Portugues, Ph.D. New Center for Psychoanalysis, Los Angeles, CA	68	Judy Roth, Ph.D. City University of New York, NY	42, 71
Jill Putterman, Ph.D. Department of Psychiatry, Lenox Hill Hospital, New York, NY	42	Eyal Rozmarin, Ph.D. NYU Postdoctoral Program in Psychotherapy & Psychoanalysis, New York, NY	71
Scott D. Pytluk, Ph.D. Illinois School of Professional Psychology, Argosy University, Chicago, IL	43, 62	Jeffrey B. Rubin, Ph.D. Private Practice, Bedford, NY	83
Scott Quasha, Psy.D. Private Practice, New York, NY	37	Judith Rustin, L.C.S.W. Institute for the Psychoanalytic Study of Subjectivity, New York, NY	49
Montana Queler, L.M.H.C. Adelphi University, New York, NY	73	Richard Ruth, Ph.D. The George Washington University, Washington, DC	62
Sarah Rand, M.S. The March of Dimes, White Plains, NY	55	Jeremy Safran, Ph.D. New School for Social Research, New York, NY	40, 74
Trisha Ready, Ph.D. Fairfax Hospital, Seattle, WA	76	Avgi Saketopoulou, Psy.D. NYU Postdoctoral Program in Psychotherapy & Psychoanalysis, New York, NY	67, 72
Meta J. Regis, Ph.D. Stella Maris College, Sydney, Australia	48	Jill Salberg, Ph.D. NYU Postdoctoral Program in Psychotherapy & Psychoanalysis, New York, NY	43, 46
Kenneth I. Reich, Ed.D. Private Practice, Cambridge, MA	67	Shara Sand, Psy.D. LaGuardia Community College, New York, NY	62
Andrea Remez, Ph.D. National Institute for the Psychotherapies, New York, NY	54	Virtue Sankoh, B.A. City University of New York, New York, NY	65
Amy Richards, B.A. Soapbox Inc: Speakers Who Speak Out, New York, NY	56	Yadira Santillan, L.M.S.W. New Alternatives for Children, New York, NY	54
Sophia Richman, Ph.D., ABPP NYU Postdoctoral Program in Psychotherapy & Psychoanalysis, New York, NY	46, 59	Joseph G. Schaller, Psy.D. Widener University, Philadelphia, PA	81
Jeremy M. Ridenour, Psy.D. Austen Riggs Center, Stockbridge, MA	61	Arnold Z. Schneider, Ph.D., ABPP Tampa Bay Psychoanalytic Institute, Tampa, FL	54
Ricardo Rieppi, Ph.D. NYU Postdoctoral Program in Psychotherapy & Psychoanalysis, New York, NY	72	Robert Schulte, M.S.W. Red Well Theater Group, Washington, DC	43
Philip A. Ringstrom, Ph.D., Psy.D. Institute of Contemporary Psychoanalysis, Los Angeles, CA	42, 47	Rosemary Segalla, Ph.D. Red Well Theater Group, Washington, DC	43

Ramona Segreti, L.C.S.W. The Westchester Center for the Study of Psychoanalysis and Psychotherapy, White Plains, NY	77	Jon Sletvold, Psy.D. Norwegian Character Analytic Institute, Oslo, Norway	48
Henry M. Seiden, Ph.D., ABPP Private Practice, Forest Hills, NY	55	Joyce Slochower, Ph.D., ABPP NYU Postdoctoral Program in Psychotherapy & Psychoanalysis, New York, NY	38, 61, 79
Stephen Seligman, D.M.H. Department of Psychiatry, University of California, San Francisco, CA	71	Anne Slocum McEneaney, Ph.D., ABPP New York University, New York, NY	59
Deborah Serani, Psy.D. Derner Institute, Adelphi University, Smithtown, NY	62	Brian Smith, Ph.D. Montefiore Medical Center, Bronx, NY	60
Peter Shabad, Ph.D. Feinberg School of Medicine, Northwestern University, Chicago, IL	38, 39	Nirav Soni, Ph.D. Private Practice, New York, NY	60
Stephen Shainbart, Ph.D. William Alanson White Institute, New York, NY	47	K. Mark Sossin, Ph.D. Pace University, New Hyde Park, NY	62, 71
Daniel Shaw, L.C.S.W. National Institute for the Psychotherapies, New York, NY	44	Warren Spielberg, Ph.D. The New School for Public Engagement, New York, NY	59, 76
Lara Sheehi, Psy.D. University of South Carolina, Columbia, SC	57	Miriam Steele, Ph.D. The New School, New York, NY	56
Linda B. Sherby, Ph.D. Private Practice, Boca Raton, FL	59	Zina Steinberg, Ed.D. Columbia University College of Physicians and Surgeons, New York, NY	71
Virginia M. Shiller, Ph.D. Yale Child Study Center, New Haven, CT	56	Donnel Stern, Ph.D. NYU Postdoctoral Program in Psychotherapy & Psychoanalysis, New York, NY	53
Michael E. Shulman, Ph.D. University of Michigan, Ann Arbor, MI	74	Nathan Stockhamer, Ph.D., ABPP William Alanson White Institute, New York, NY	54
Doris K. Silverman, Ph.D. NYU Postdoctoral Program in Psychotherapy & Psychoanalysis, New York, NY	68	Brad D. Strawn, Ph.D. Fuller Theological Seminary, Pasadena, CA	63
Ruth Simon, Ph.D. Access Institute, San Francisco, CA	44	Karl Stukenberg, Ph.D. Xavier University, Cincinnati, OH	57
Courtney Slater, Ph.D. Widener University Institute of Graduate Clinical Psychology, Chester, PA	55	Kate Roy Sullivan, Ph.D. Massachusetts Institute for Psychoanalysis, Boston, MA	72
Jonathan Slavin, Ph.D. Harvard Medical School at Cambridge Health Alliance, Cambridge, MA	65	Frank L. Summers, Ph.D., ABPP Feinberg School of Medicine, Northwestern University, Chicago, IL	38, 50, 60, 75
Malcolm Slavin, Ph.D. Massachusetts Institute for Psychoanalysis, Cambridge, MA	39, 75	Andrew Tatarsky, Ph.D. The Center for Optimal Living, New York, NY	59

Nina K. Thomas, Ph.D., ABPP NYU Postdoctoral Program in Psychotherapy & Psychoanalysis, New York, NY	47	Harriet Wrye, Ph.D. Los Angeles Institute and Society for Psychoanalytic Studies, Los Angeles, CA	56
Jane G. Tillman, Ph.D., ABPP Austen Riggs Center, Stockbridge, MA	61	Jed A. Yalof, Psy.D., ABPP Immaculata University, Department of Graduate Psychology, Haverford, PA	81
Sheila Tobias, M.A. Independent Consultant, Tucson, AZ	56	Natalia Yangarber-Hicks, Ph.D. Chicago Center for Psychoanalysis, Chicago, IL	72
Ellen L. K. Toronto, Ph.D. Private Practice, Ann Arbor, MI	59	Mougeh Yasai, Ph.D. Center for Psychological and Interpersonal Development, New York, NY	73
Steven Tuber, Ph.D. City University of New York, New York, NY	41, 73	Kris Yi, Ph.D., Psy.D. Los Angeles Institute for Contemporary Psychoanalysis, Los Angeles, CA	75
Usha Tummala-Narra, Ph.D. Boston College, Chestnut Hill, MA	38, 58	Gina Yu, M.A. Society for Exploration of Psychoanalytic Therapies and Theology, Fogelsville, PA	68
Kirkland Vaughans, Ph.D. Adelphi University, New York, NY	76	Lawrence Zelnick, Psy.D. NYU Postdoctoral Program in Psychotherapy & Psychoanalysis, New York, NY	61
Laurel B. Wagner, Ph.D. University of Texas Southwestern Medical Center, Dallas, TX	53	Janet Zuckerman, Ph.D. The Westchester Center for the Study of Psychoanalysis and Psychotherapy, White Plains, NY	77
Sherwood Waldron, M.D. Psychoanalytic Research Consortium, New York, NY	57		
Stephen Wangh, M.F.A. New York University, New York, NY	43		
Lissa Weinstein, Ph.D. City University of New York, New York, NY	57, 60		
Bryant L. Welch, J.D., Ph.D. California Institute for Integral Studies, San Francisco, CA	54		
Jane Widseth, Ph.D. Haverford College Counseling and Psychological Services, Haverford, PA	55		
Rob Williams, L.I.C.S.W. Red Well Theater Group, Washington, DC	43		
Lisa Wolfe, L.C.S.W. New Alternatives for Children, New York, NY	54		
Debra Wolkenfeld, M.A. Long Island University, Brooklyn, NY	61		

PARENT INFANT PSYCHOTHERAPY TRAINING PROGRAM OF COLUMBIA UNIVERSITY



The Parent-Infant Psychotherapy Program (PIP) is a two to three-year clinical training program in parent-infant psychotherapy offered by the Columbia University Center for Psychoanalytic Training and Research. The PIP program provides a comprehensive training in relationally based and psychoanalytically informed parent-infant psychotherapy. The program is unique in bringing together applicants from diverse backgrounds: psychiatrists, psychologists, social workers, occupational therapists, pediatricians, and psychoanalysts.

This in-depth training includes advanced didactic course work, infant observation, clinical placements, and supervision by members of the Columbia Psychoanalytic Center faculty. The goals of the program are to enhance the clinician's theoretical understanding of the complex developmental and dynamic aspects involved in infant mental health and early childhood psychopathology and parenting, and to develop clinical expertise in dyadic and triadic psychotherapy techniques that support optimal parenting, infant development, and parent-infant relations.

The PIP curriculum covers the trajectory of normative and pathological child development from infancy to three years of age. It includes the study of infancy and infant mental health, infant research, psychotherapeutic interventions for infants and their parents.

FOR FURTHER INFORMATION, PLEASE CONTACT:
Christine Anzieu-Premmereur, M.D. canzieu@gmail.com

Division **39** FUND FOR PSYCHOANALYSIS

Express your passion for the psychoanalytic perspective by making a pledge or donation to our own Division 39 Fund. The mission of the Fund is to support programs in education, research, and service consistent with psychoanalytic principles. The formal mission statement and pledge form can be found at our website, division39.org. Join your colleagues and make a pledge or donation today.

Floor Plans

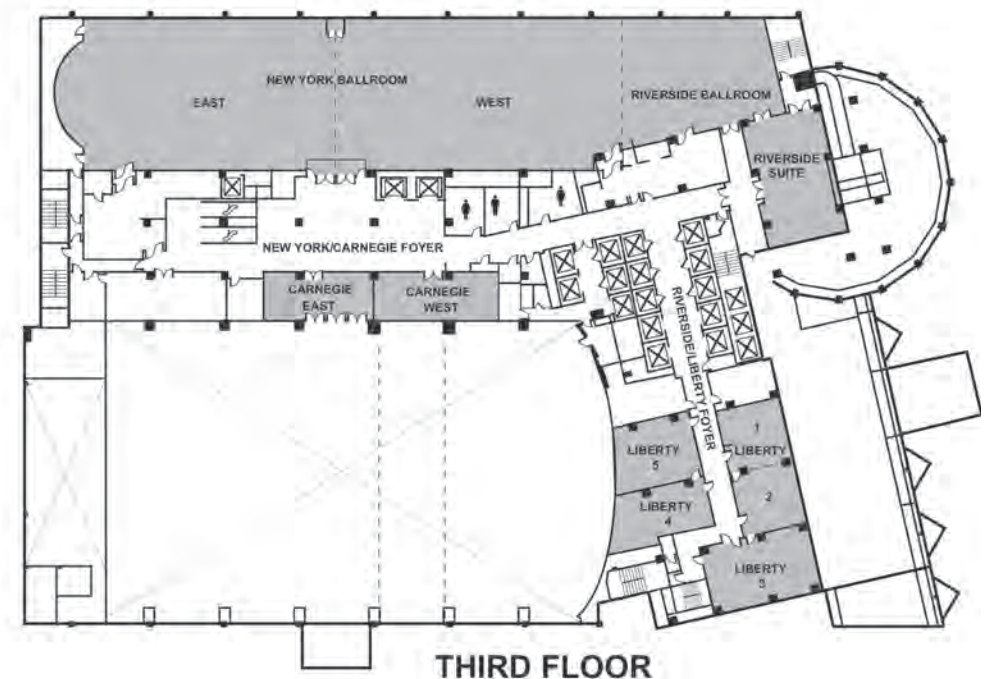
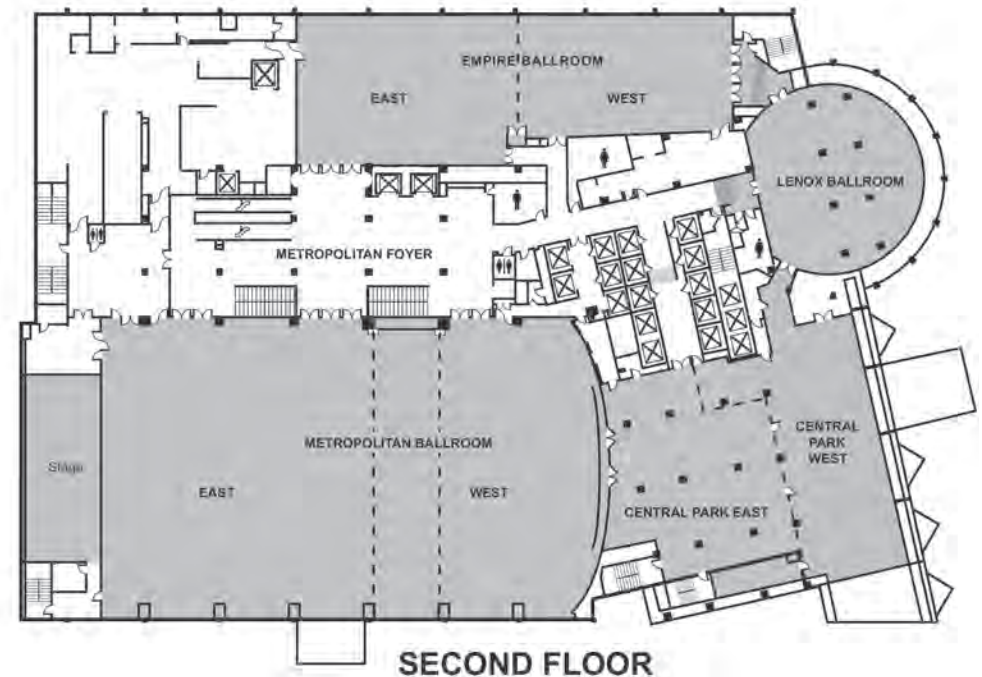

Floor Plans

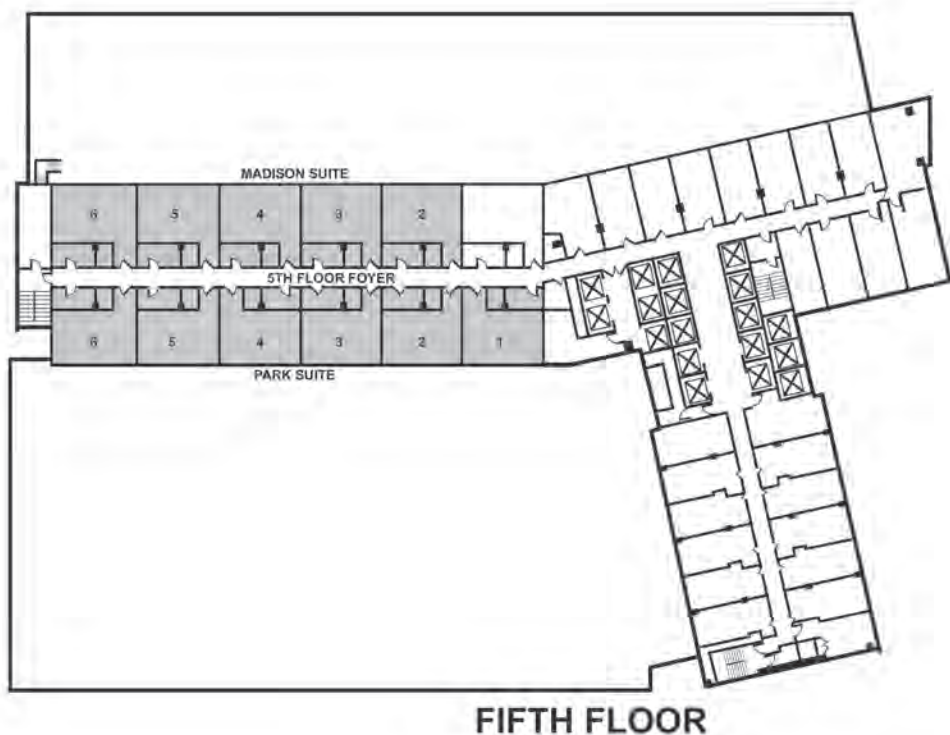

Registration Form, Part 1

NAME (As you wish it to appear on your badge) _____ DEGREE _____

ADDRESS _____

CITY, STATE, ZIP, COUNTRY _____

PHONE _____ FAX _____

EMAIL _____

Date highest professional degree was received ____/____/____ (mm/yyyy)

First time attending Division 39 Spring Meeting? Yes No

Will you request CE credits for programs you attend? Yes No

Are you a member of APA? Yes No

Please indicate any accessible accommodations _____

Registration Fees *(Circle the appropriate dollar amount.)*

ALL STUDENTS AND INSTITUTE CANDIDATES must submit proof of their status with registration. Without this proof, your registration will not be processed. See the Registration section in this brochure for specific proof required. **Early Bird Registration ends January 14, 2014.**

	Postmarked or electronically submitted by 1/14/14	4/16/14
Member	\$325	\$375
Non-Member	\$375	\$425
Student Member	\$ 60	\$ 70
Student Non-Member*	\$ 85	\$ 95
ECP Member (Date of Doctoral Degree April 2007 or later)	\$125	\$150
ECP Non-Member* (Date of Doctoral Degree April 2007 or later)**	\$165	\$180
Institute Candidate Member (Enrolled in first 5 yrs of curriculum only)	\$125	\$150
Institute Candidate Non-Member (Enrolled in first 5 yrs of curriculum only)***	\$195	\$210

*\$25 of all Student Non-Member registrations will be applied to a one-year Division 39 Membership

**Please use \$50 of my registration fee towards Division 39 Membership

***Please use \$95 of my registration fee towards Division 39 Membership

FOREIGN AFFILIATES Postmarked or electronically submitted by 1/14/14 4/16/14
CURRENT DIVISION 39 MEMBERS:

Canada, Western Europe, Australia, New Zealand, Japan	\$280	\$320
Other Countries: South America, Africa, Asia, Middle East	\$140	\$180

NON-DIVISION 39 MEMBERS:

Canada, Western Europe, Australia, New Zealand, Japan [#]	\$305	\$345
Other Countries: South America, Africa, Asia, Middle East [#]	\$165	\$190

[#]Please use USD \$45 of my registration fee towards Division 39 membership

Registration Form, Part 2

Continuing Education Master Classes *Please check the course(s) you wish to attend:*

Session: 12 noon–3:15 pm

- | | |
|---|------|
| <input type="checkbox"/> Introduction to Negotiation | \$60 |
| <input type="checkbox"/> Presenting... Creating an Effective Presentation, from Proposal to Performance | \$60 |
| <input type="checkbox"/> Controversies and Techniques in Treating Transgender Children and Adolescents | \$60 |

Session: 3:30 pm–5:00 pm

- | | |
|--|------|
| <input type="checkbox"/> Starting a Practice: The How-To's of Setting Up a Psychodynamic Psychotherapy Practice
<small>(or Things They Never Taught You In Graduate School)</small> | \$30 |
|--|------|
- This workshop is free to students and Early Career Professionals who are members of Division 39.*

Session: 3:30 pm–6:45 pm

- | | |
|--|------|
| <input type="checkbox"/> Sexual Conflict in Couples: Discrepant Desires and Lost Attractions | \$60 |
| <input type="checkbox"/> Working Multiculturally as a Psychoanalytic Practitioner | \$60 |

Note: Registrations postmarked after April 16, 2014 will be returned. DO NOT mail or fax registrations after that date. You can register onsite at the New York Sheraton beginning Wednesday, April 23. There will be an additional \$50 added to the above fee schedule for all onsite registrations.

APF Division 39 Fund:

I would like to make a tax deductible contribution of \$ _____

Total Payment Due

\$ _____
(Registrations will not be processed unless accompanied by full payment.)

Payment Information *(These are the only accepted methods of payment.)*

- Check made payable to Division 39, APA Visa Mastercard

_____|_____|_____|_____|_____| _____|_____|_____|_____|_____| _____|_____|_____|_____|_____|
CARD NUMBER EXP. DATE (MM/YY)

NAME AS IT APPEARS ON THE CARD

BILLING ADDRESS IF DIFFERENT FROM ABOVE

CITY, STATE, ZIP CODE

Return registration forms to: Natalie Shear Associates, Conference Coordinators, 1101 14th Street NW, Suite 1200, Washington, DC 20005. Fax forms to 202-446-2965.

For registration questions: 800-833-1354 x4 or 202 833-4456x4

For all other questions: Division39NewYork@natalieshear.com or 800-833-1354x1

Division 39 Office

Ruth Helein, Executive Admin
215 Amesbury Road
Winston Salem, NC 2103
(336) 768-1113 (o)
(877) 212-0511 (toll free)
(336) 464-2974 (fax)
div39@namgmt.com
ruth@namgmt.com

Website

www.division39.org

Conference Coordinators

Natalie Shear Associates
1101 14th Street NW, Suite 1200
Washington, DC 2000
(800) 833-1354 (toll free)
(202) 833-4456 (o)
(202) 446-2965 (fax)
Division39NY@natalieshear.com
natalie@natalieshear.com
www.natalieshear.com

c/o Natalie Shear Associates
1101 14th Street, NW, Suite 1200
Washington, DC 20005

conflict

division of psychoanalysis (39)
34th annual spring meeting
april 23–27, 2014 • new york, ny